



MARK WILLIAMS  
COMMISSIONER

A.G. 'SPUD' WOODWARD  
DIRECTOR

NOV 16 2017

Zachery Marsh  
Resource and Land Consultants  
41 Park of Commerce Drive, Suite 303  
Savannah, GA 31405

**RE: Letter of Permission (LOP), Replacement and Maintenance of Existing Culvert and Bank Stabilization, Concord Road Drainage Improvements, Betz Creek, Chatham County, Georgia**

Dear Mr. Marsh:

This Letter of Permission (LOP) is in response to your request submitted on behalf of Chatham County Engineering for improvements to existing infrastructure along the Concord Road drainage corridor. The request includes the replacement of the existing 6ft. X 5ft. box culvert, associated headwalls, maintenance of existing rip rap, and excavation of the existing open channel drainage area. The project will begin no sooner than 15 days from the date of this letter and be completed within 6 months of this letter's issuance.

Based on plans provided by the agent and on information gathered during a site visit by Coastal Resource Division (CRD) staff, the proposed project will not result in additional encroachment into jurisdictional coastal marshlands as defined by the Coastal Marshlands Protection Act of 1970 (CMPA). Sediment, vegetation and debris excavated seaward of the existing culvert from the Concord Road drainage corridor will be loaded into landside trucks for transport to an upland disposal area. There will be no new permanent impacts to jurisdictional coastal marshlands from the proposed project or from the associated construction activity.

The Department authorizes the maintenance, replacement, and excavation as depicted in the attached description provided all Best Management Practices (BMPs) are used to prevent any erosion and sedimentation at the site and to protect Coastal Marshlands. During maintenance, equipment, materials, or debris may not be placed in, disposed of, or stored in marsh jurisdictional areas. Any damage to the marsh vegetation that has not recovered naturally during the next growing season will be repaired by a method acceptable to the Department.

This authorization does not relieve you from obtaining any other required federal, state, or local permits. Tidal water bottoms and marshlands of coastal Georgia are public trust lands controlled by the State, except for such lands where a validated Crown Grant or State Grant exists.

NOV 16 2017

Please feel free to contact Deb Barreiro at 912.266.3695 if you have any questions regarding this or any other authorizations.

Sincerely,

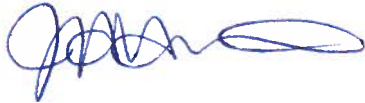

Jill Andrews  
Chief, Coastal Management Section

Enclosures: Project Drawings & Description

cc: Sherell Reinhardt USACE

Bill Nicholson  
Chatham County Department of Engineering  
P.O. Box 8161  
Savannah, GA 31412-7818

LOP20170058

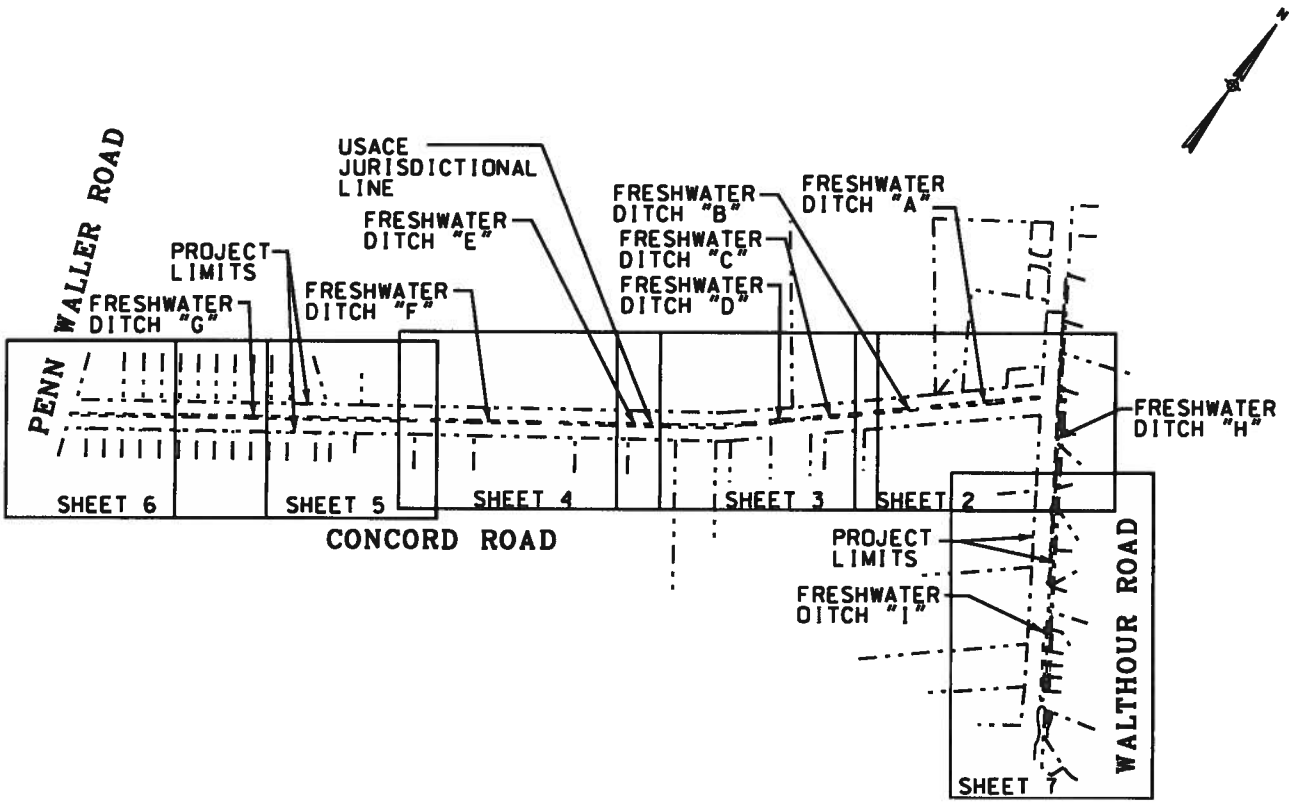

NOTE:  
 ALL FRESHWATER DITCH AREA DEPICTED ON THIS SURVEY IS SUBJECT TO THE JURISDICTION OF THE USACE.  
 ALL SALTWATER DITCH AREA DEPICTED ON THIS SURVEY IS SUBJECT TO THE JURISDICTION OF THE USACE AND GADNR-CRD.

**HUSSEY GAY BELL**  
 — Established 1958 —

LEGEND / IMPACTS	
DITCH FILL AREA	
DITCH EXCAVATION	

**DRAINAGE DITCH IMPACT EXHIBIT**  
 FOR  
**CONCORD ROAD**  
**DRAINAGE IMPROVEMENTS**  
 DATE: APRIL 3, 2017      SCALE: 1"=600'  
 SHEET 1 OF 9

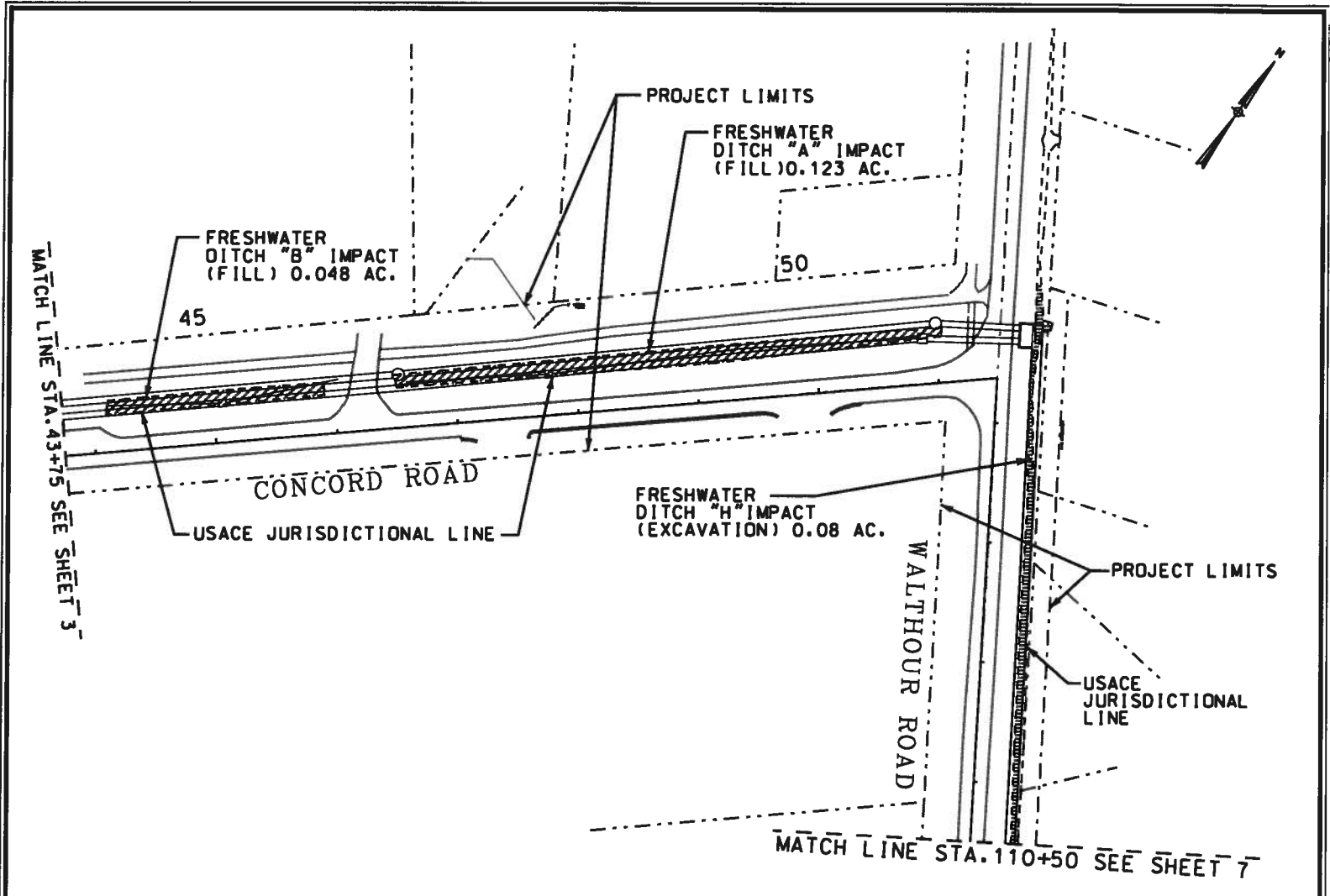

**HUSSEY GAY BELL**  
*Established 1958*

LEGEND / IMPACTS	
DITCH FILL AREA	
DITCH EXCAVATION	

**DRAINAGE DITCH IMPACT EXHIBIT**  
 FOR  
**CONCORD ROAD**  
**DRAINAGE IMPROVEMENTS**  
 DATE: APRIL 3, 2017      SCALE: 1"=100'  
 SHEET 2 OF 9

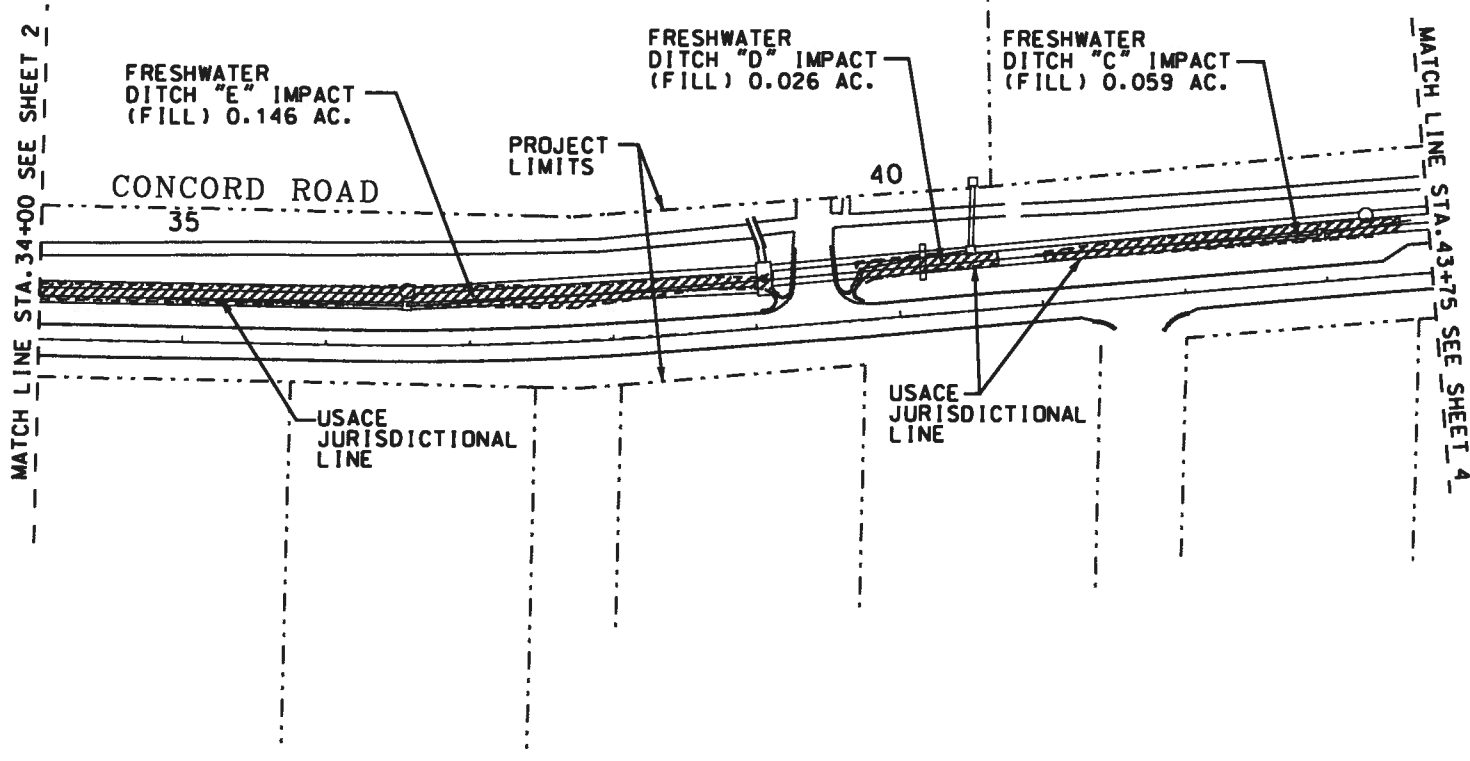

**HUSSEY GAY BELL**  
*Established 1958*

LEGEND / IMPACTS	
DITCH FILL AREA	
DITCH EXCAVATION	

**DRAINAGE DITCH IMPACT EXHIBIT**  
 FOR  
**CONCORD ROAD**  
**DRAINAGE IMPROVEMENTS**  
 DATE: APRIL 3, 2017 SCALE: 1"=100'  
 SHEET 3 OF 8

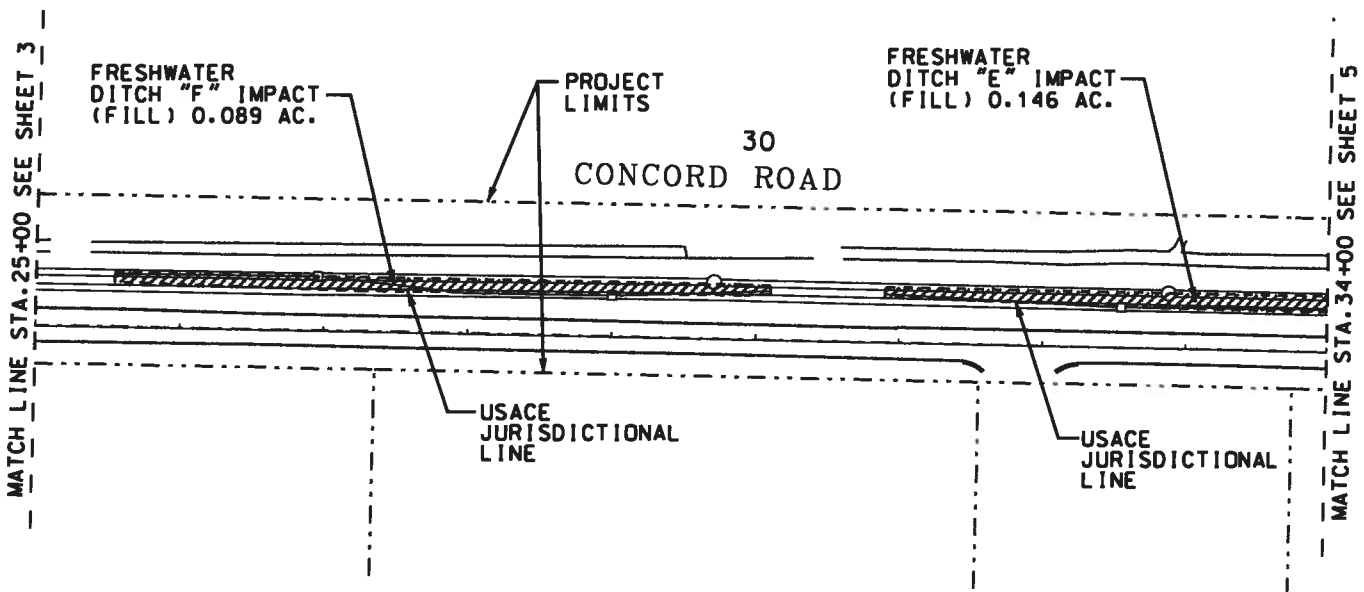

**HUSSEY GAY BELL**  
*Established 1958*

LEGEND / IMPACTS	
DITCH FILL AREA	
DITCH EXCAVATION	

**DRAINAGE DITCH IMPACT EXHIBIT**  
 FOR  
**CONCORD ROAD**  
**DRAINAGE IMPROVEMENTS**  
 DATE: APRIL 3, 2017      SCALE: 1"=100'  
 SHEET 4 OF 8

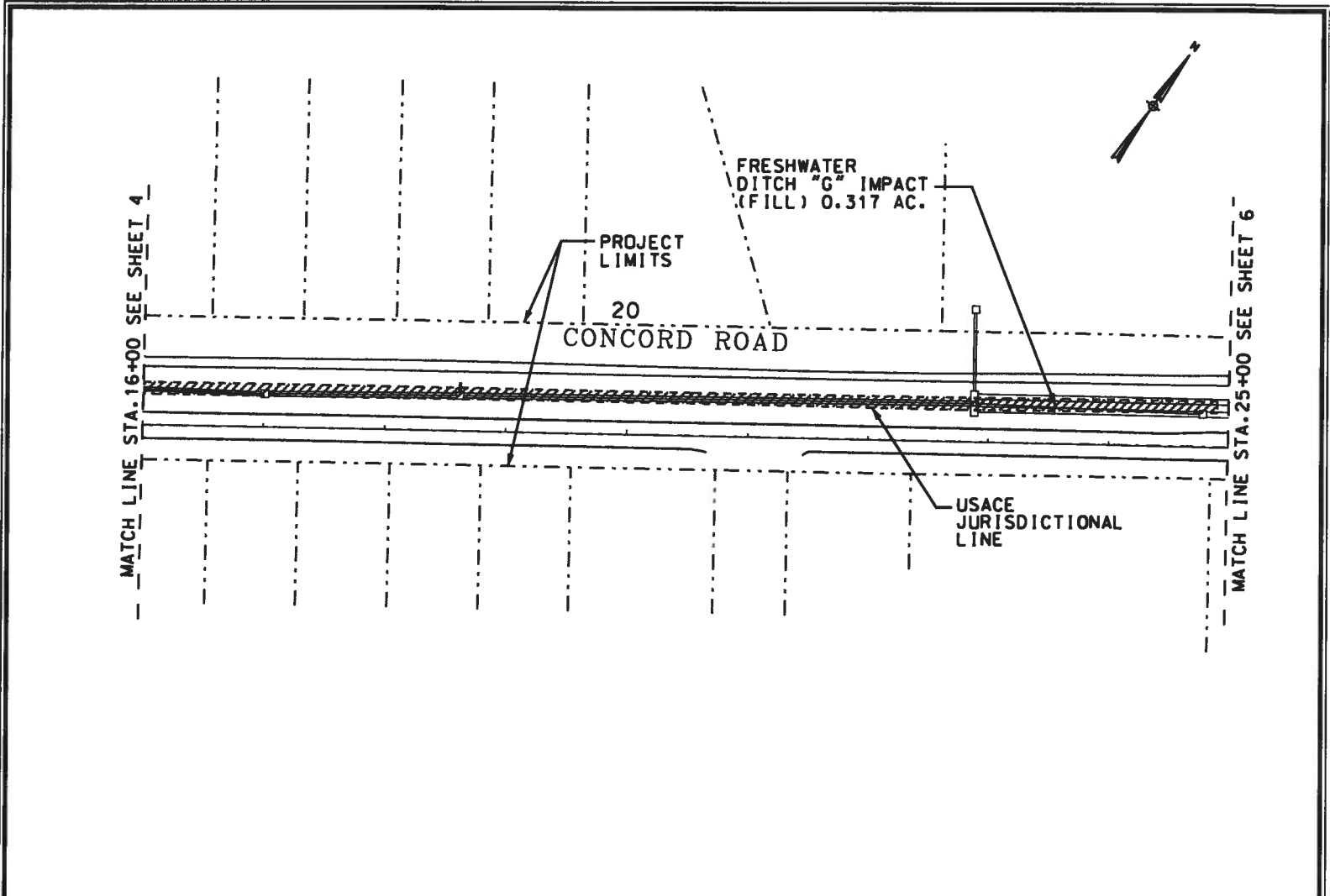

**HUSSEY GAY BELL**

Established 1958

**LEGEND / IMPACTS**

- DITCH FILL AREA 
- DITCH EXCAVATION 

**DRAINAGE DITCH IMPACT EXHIBIT**

FOR  
 CONCORD ROAD  
 DRAINAGE IMPROVEMENTS  
 DATE: APRIL 3, 2017 SCALE: 1"=100'  
 SHEET 5 OF 9

FRESHWATER  
DITCH "G" IMPACT  
(FILL) 0.317 AC.

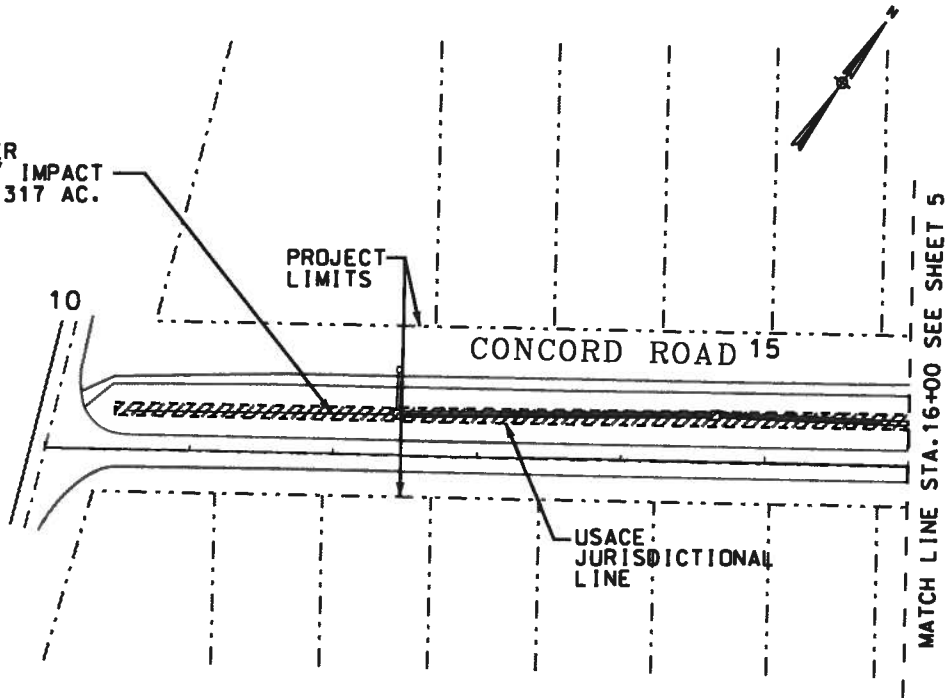

**HUSSEY GAY BELL**

Established 1958

**LEGEND / IMPACTS**

- DITCH FILL AREA 
- DITCH EXCAVATION 

**DRAINAGE DITCH IMPACT EXHIBIT**

FOR  
CONCORD ROAD  
DRAINAGE IMPROVEMENTS  
DATE: APRIL 3, 2017 SCALE: 1"=100'  
SHEET 6 OF 9



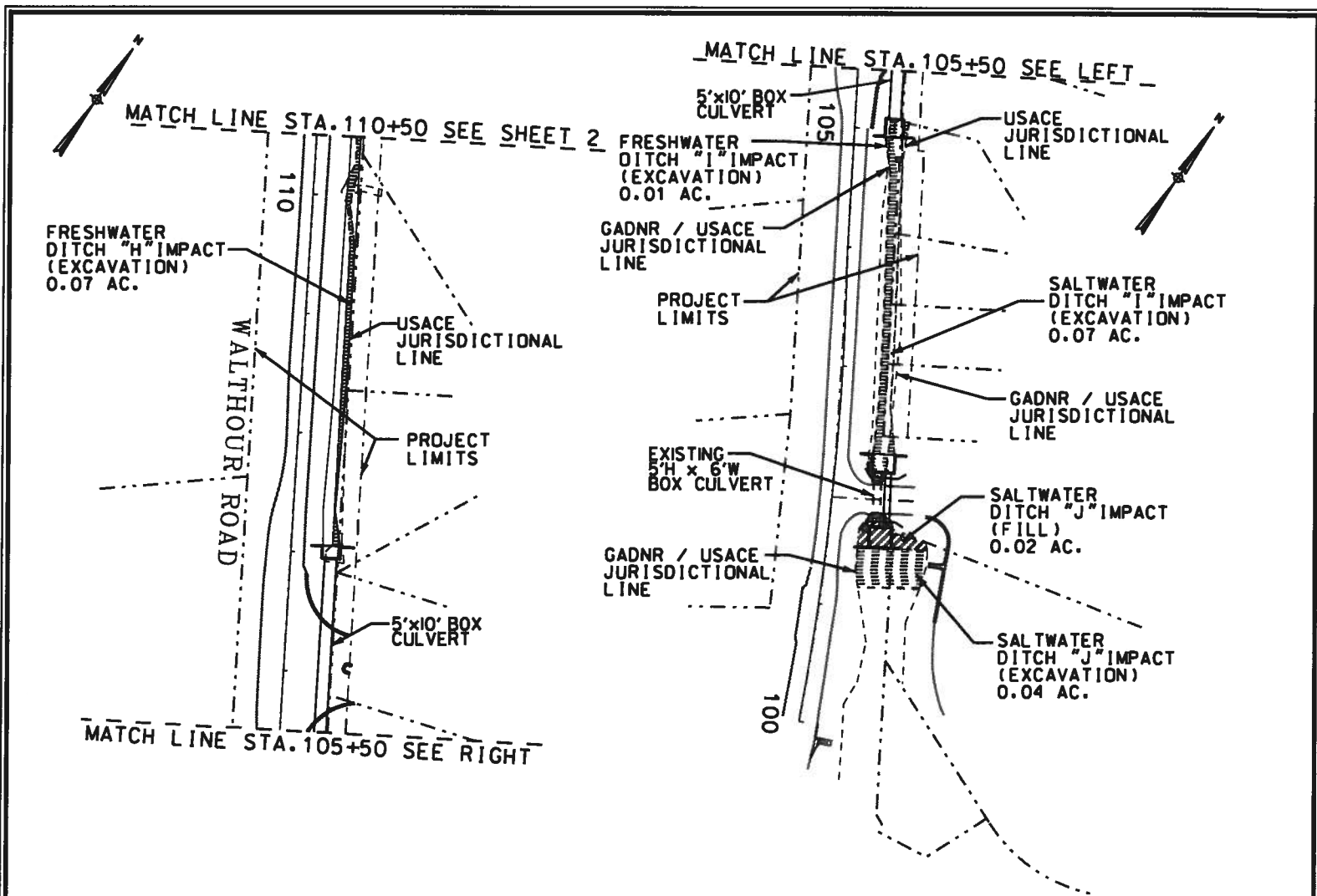

**HUSSEY GAY BELL**  
*Established 1958*

**LEGEND / IMPACTS**

DITCH FILL AREA	
DITCH EXCAVATION	

**DRAINAGE DITCH IMPACT EXHIBIT**  
 FOR  
**CONCORD ROAD**  
**DRAINAGE IMPROVEMENTS**  
 DATE: APRIL 3, 2017      SCALE: 1"=100'  
 SHEET 7 OF 9

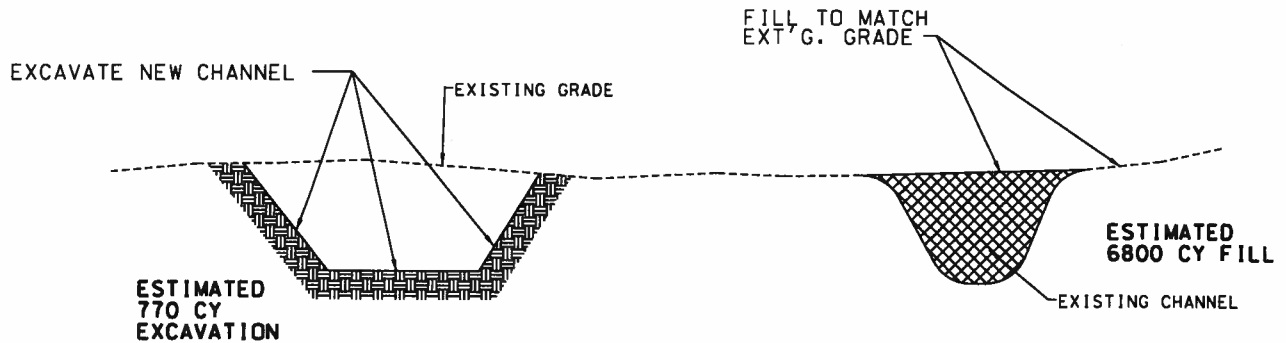

**TYPICAL SECTION**

N. T. S.

**SUMMARY TABLE**

PROJECT LIMITS .....	6.78 ACRES
TOTAL FRESHWATER DITCH AREA .....	1.06 ACRES
TOTAL SALTWATER DITCH AREA .....	0.13 ACRES
TOTAL UPLAND .....	5.53 ACRES

**IMPACT SUMMARY TABLE**

FRESHWATER DITCH IMPACT (FILL).....	0.808 ACRES
FRESHWATER DITCH IMPACT (EXCAVATION).....	0.090 ACRES
SALTWATER DITCH IMPACT (EXCAVATION).....	0.110 ACRES
SALTWATER DITCH IMPACT (FILL) .....	0.020 ACRES
TOTAL DITCH IMPACT.....	1.028 ACRES

**HUSSEY GAY BELL**

Established 1958

**LEGEND / IMPACTS**

DITCH FILL AREA	
DITCH EXCAVATION	

**DRAINAGE DITCH IMPACT EXHIBIT**

FOR  
CONCORD ROAD  
DRAINAGE IMPROVEMENTS  
DATE: APRIL 8, 2017 SCALE: N.T.S.  
SHEET 8 OF 9

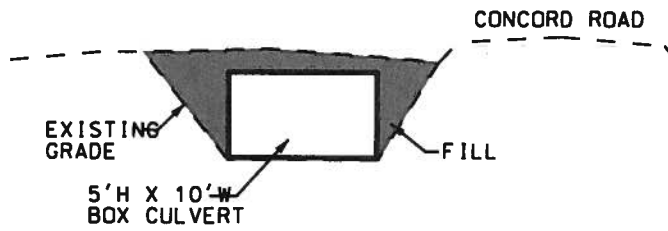

NEW BOX CULVERT SECTION  
N.T.S.

**HUSSEY GAY BELL**  
— Established 1958 —

**LEGEND**  
DITCH FILL AREA 

**DRAINAGE DITCH IMPACT EXHIBIT**  
FOR  
CONCORD ROAD  
DRAINAGE IMPROVEMENTS  
DATE: APRIL 3, 2017 SCALE: N.T.S.  
SHEET 9 OF 9