

RLC Project No.:	17-126
Figure No.:	1
Prepared By:	DB
Sketch Date:	4/25/2017
Map Scale :	1 inch = 400 feet

510 Ribault Lane
Glynn County, Georgia

Vicinity Map
Prepared For: Last House, LLC

RLC
RESOURCE+LAND
CONSULTANTS
RECEIVED
Savannah, Georgia 31405
912.443.5896 www.rlc.com

Y:\2017 Projects\17-126 Noonan SPA Cottage 85\Vicinity Map.mxd

MAY 10 2017

GA DNR

Sea Island Acquisition Stormwater Requirements:

Sea Island Covenants. Sixth Amendment to The Declaration of Restrictions, Conditions, Limitations, Easements, Rights, Privileges, etc. for Sea Island Subdivision No. 1.
 Section:
 No. 2 (February 19, 2008) - page 10 - Item 4. Grading and Drainage.

States:
 "Each building site shall be graded and/or accommodated with sub-surface drainage systems to prevent any storm drainage impacts to neighboring lots and/or rights of way and to ensure positive drainage of the building site. Where the availability and/or capacity of the storm systems within rights of way adjacent to building sites is insufficient to accommodate surface water run-off, the ARC may require on-site storm water detention, limiting run-off quantities to pre-development, or existing, conditions. The ARC reserves the right to establish storm drainage requirements specific to each building site and to require the submission of drainage plans prepared by licensed engineers."

Irrigation:

Irrigation to the lawn area and shrub areas are provided by MFI (Matched Precipitation) rotator sprinklers with head-to-head coverage via an automatic, in-ground permanent system. The water source is from a permanent irrigation well located on the property.

Pool Location:

- Reasons for the location of the pool:
1. Positive drainage away from the house footings, and pool, discharge away from the pool coping.
 2. Min. 5' wide plant bed around house for drainage and buffer.
 3. Min. 30' wide pool deck for chase burrows to be placed around pool.
 4. Min. 3' width between setbacks and pool right for safe working width.

SPA JURISDICTIONAL AREA

Total JD Area:	6,221 SF
Hardscape within JD Area:	195 SF (3%)
Lawn within JD Area:	3,640 SF (59%)
Shrub/Buffer Plantings within JD Area:	2,386 SF (38%)

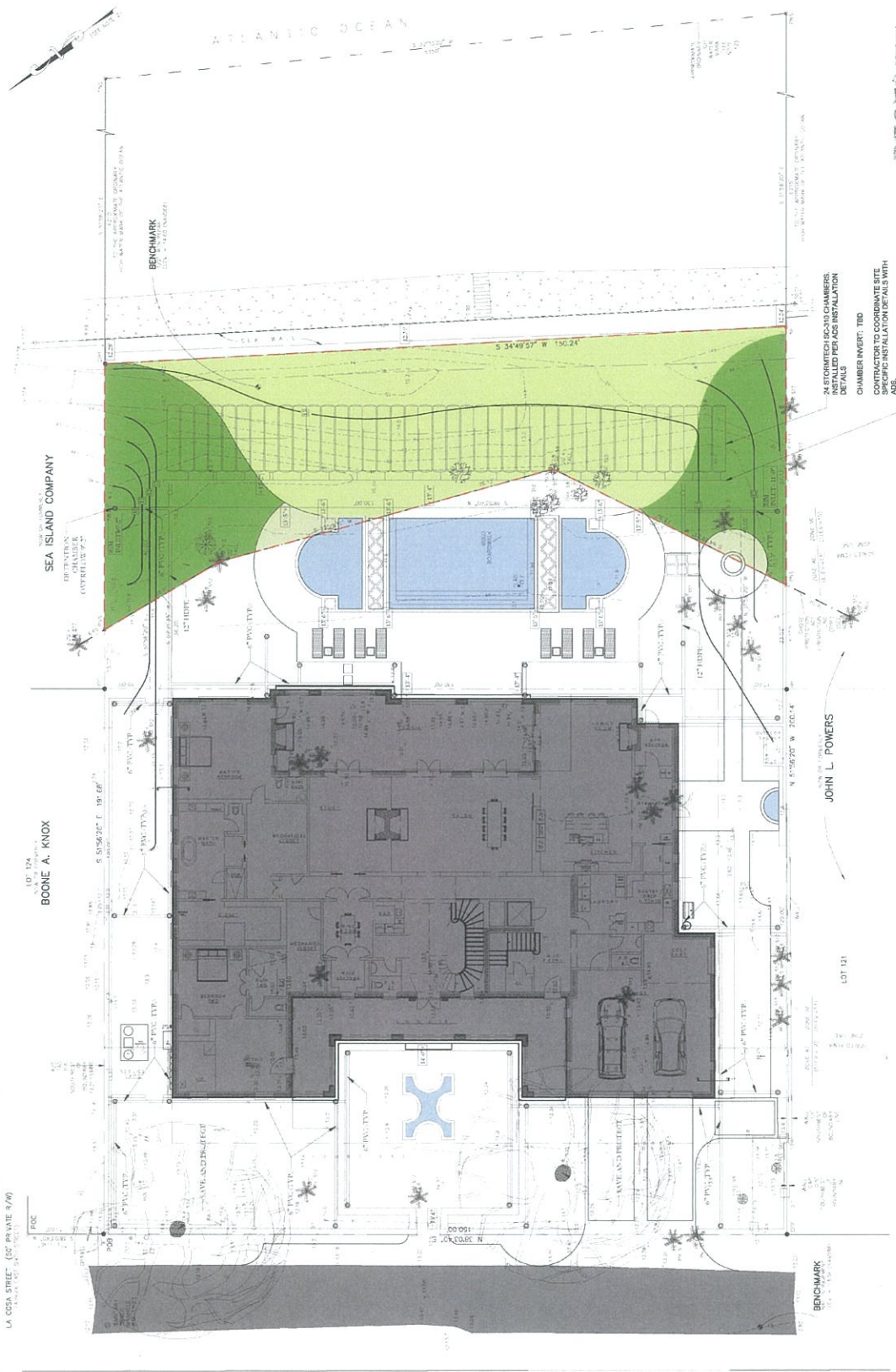

AS PREPARED BY SEA ISLANDERS
 DETAILS
 CHAMBER INVERT TBD
 CONTRACTOR TO COORDINATE SITE
 SPECIFIC INSTALLATION DETAILS WITH
 AS. SEE DETAILS FOR
 SEE AS. DETAILS

RECEIVED

JUL 05 2017
 GA DNR

DAVID W. WENTWORTH
 ARCHITECT
 510 RIBAUT LANE, SEA ISLAND, GA 31556
 PH: 904.241.1234

NOONAN RESIDENCE
 Cottage 85
 510 Ribault Lane, Sea Island, GA

PLAN TITLE: _____
 DATE: _____
 SCALE: _____
 DRAWN BY: _____
 CHECKED BY: _____
 DATE: 3/23/17

**DNR/SPA Jurisdiction
 Approval Plan**

C-1



DAVID W. WELTAWER III
 5555 ATLANTA ROAD, SUITE 100
 ATLANTA, GA 30340
 404.252.2663
 FAX: 404.252.2663
 WWW.DWWE.COM

NOONAN RESIDENCE
 Cottage 85
 510 Ribault Lane, Sea Island, GA

DNR/SPA Jurisdiction
 Approval Plan

C-2

3/7/32-1-10'

ACCEPTABLE FILL MATERIALS, STORMTECH SC-310 CHAMBER SYSTEMS

MATERIAL LOCATION	DESCRIPTION	ADDED MATERIAL REQUIREMENTS	COMPLETION VERIFIY REQUIREMENTS
1. FILL MATERIALS TO BE USED FOR THE CONSTRUCTION OF THE STORMTECH SC-310 CHAMBER SYSTEMS	NO. 5.5 GRADE MATERIAL, 100% SAND, OR OTHER MATERIAL THAT IS EQUIVALENT TO SAND AS SPECIFIED IN THE STORMTECH SC-310 CHAMBER SYSTEMS MANUAL.	NO. 5.5 GRADE MATERIAL, 100% SAND, OR OTHER MATERIAL THAT IS EQUIVALENT TO SAND AS SPECIFIED IN THE STORMTECH SC-310 CHAMBER SYSTEMS MANUAL.	NO. 5.5 GRADE MATERIAL, 100% SAND, OR OTHER MATERIAL THAT IS EQUIVALENT TO SAND AS SPECIFIED IN THE STORMTECH SC-310 CHAMBER SYSTEMS MANUAL.
2. FILL MATERIALS TO BE USED FOR THE CONSTRUCTION OF THE STORMTECH SC-310 CHAMBER SYSTEMS	NO. 5.5 GRADE MATERIAL, 100% SAND, OR OTHER MATERIAL THAT IS EQUIVALENT TO SAND AS SPECIFIED IN THE STORMTECH SC-310 CHAMBER SYSTEMS MANUAL.	NO. 5.5 GRADE MATERIAL, 100% SAND, OR OTHER MATERIAL THAT IS EQUIVALENT TO SAND AS SPECIFIED IN THE STORMTECH SC-310 CHAMBER SYSTEMS MANUAL.	NO. 5.5 GRADE MATERIAL, 100% SAND, OR OTHER MATERIAL THAT IS EQUIVALENT TO SAND AS SPECIFIED IN THE STORMTECH SC-310 CHAMBER SYSTEMS MANUAL.

NOTES:

- ALL STORMTECH SC-310 CHAMBER SYSTEMS SHALL BE INSTALLED IN ACCORDANCE WITH THE STORMTECH SC-310 CHAMBER SYSTEMS MANUAL.
- ALL STORMTECH SC-310 CHAMBER SYSTEMS SHALL BE INSTALLED IN ACCORDANCE WITH THE STORMTECH SC-310 CHAMBER SYSTEMS MANUAL.
- ALL STORMTECH SC-310 CHAMBER SYSTEMS SHALL BE INSTALLED IN ACCORDANCE WITH THE STORMTECH SC-310 CHAMBER SYSTEMS MANUAL.
- ALL STORMTECH SC-310 CHAMBER SYSTEMS SHALL BE INSTALLED IN ACCORDANCE WITH THE STORMTECH SC-310 CHAMBER SYSTEMS MANUAL.



RELEASED DRAIN BASIN

NOTES:

- ALL STORMTECH SC-310 CHAMBER SYSTEMS SHALL BE INSTALLED IN ACCORDANCE WITH THE STORMTECH SC-310 CHAMBER SYSTEMS MANUAL.
- ALL STORMTECH SC-310 CHAMBER SYSTEMS SHALL BE INSTALLED IN ACCORDANCE WITH THE STORMTECH SC-310 CHAMBER SYSTEMS MANUAL.
- ALL STORMTECH SC-310 CHAMBER SYSTEMS SHALL BE INSTALLED IN ACCORDANCE WITH THE STORMTECH SC-310 CHAMBER SYSTEMS MANUAL.
- ALL STORMTECH SC-310 CHAMBER SYSTEMS SHALL BE INSTALLED IN ACCORDANCE WITH THE STORMTECH SC-310 CHAMBER SYSTEMS MANUAL.

PART #	DESCRIPTION	QUANTITY	UNIT	CONTRACTOR'S PRICE	OWNER'S PRICE
1	STORMTECH SC-310 CHAMBER SYSTEM	1	EA		
2	STORMTECH SC-310 CHAMBER SYSTEM	1	EA		
3	STORMTECH SC-310 CHAMBER SYSTEM	1	EA		
4	STORMTECH SC-310 CHAMBER SYSTEM	1	EA		



ADSDS ADVANCED DRAINAGE SYSTEMS, INC.

STORMTECH CHAMBER SPECIFICATIONS

IMPORTANT NOTES FOR THE DESIGN AND INSTALLATION OF THE SC-310 CHAMBER SYSTEM:

- STORMTECH CHAMBER SYSTEMS SHALL BE INSTALLED IN ACCORDANCE WITH THE STORMTECH SC-310 CHAMBER SYSTEMS MANUAL.
- STORMTECH CHAMBER SYSTEMS SHALL BE INSTALLED IN ACCORDANCE WITH THE STORMTECH SC-310 CHAMBER SYSTEMS MANUAL.
- STORMTECH CHAMBER SYSTEMS SHALL BE INSTALLED IN ACCORDANCE WITH THE STORMTECH SC-310 CHAMBER SYSTEMS MANUAL.
- STORMTECH CHAMBER SYSTEMS SHALL BE INSTALLED IN ACCORDANCE WITH THE STORMTECH SC-310 CHAMBER SYSTEMS MANUAL.
- STORMTECH CHAMBER SYSTEMS SHALL BE INSTALLED IN ACCORDANCE WITH THE STORMTECH SC-310 CHAMBER SYSTEMS MANUAL.
- STORMTECH CHAMBER SYSTEMS SHALL BE INSTALLED IN ACCORDANCE WITH THE STORMTECH SC-310 CHAMBER SYSTEMS MANUAL.
- STORMTECH CHAMBER SYSTEMS SHALL BE INSTALLED IN ACCORDANCE WITH THE STORMTECH SC-310 CHAMBER SYSTEMS MANUAL.
- STORMTECH CHAMBER SYSTEMS SHALL BE INSTALLED IN ACCORDANCE WITH THE STORMTECH SC-310 CHAMBER SYSTEMS MANUAL.
- STORMTECH CHAMBER SYSTEMS SHALL BE INSTALLED IN ACCORDANCE WITH THE STORMTECH SC-310 CHAMBER SYSTEMS MANUAL.
- STORMTECH CHAMBER SYSTEMS SHALL BE INSTALLED IN ACCORDANCE WITH THE STORMTECH SC-310 CHAMBER SYSTEMS MANUAL.

SC-310 TECHNICAL SPECIFICATION

SIZE	A	B	C
18" x 24" x 18"	18.00"	24.00"	18.00"
24" x 30" x 24"	24.00"	30.00"	24.00"
30" x 36" x 30"	30.00"	36.00"	30.00"
36" x 42" x 36"	36.00"	42.00"	36.00"
42" x 48" x 42"	42.00"	48.00"	42.00"
48" x 54" x 48"	48.00"	54.00"	48.00"
54" x 60" x 54"	54.00"	60.00"	54.00"
60" x 66" x 60"	60.00"	66.00"	60.00"
66" x 72" x 66"	66.00"	72.00"	66.00"
72" x 78" x 72"	72.00"	78.00"	72.00"
78" x 84" x 78"	78.00"	84.00"	78.00"
84" x 90" x 84"	84.00"	90.00"	84.00"
90" x 96" x 90"	90.00"	96.00"	90.00"
96" x 102" x 96"	96.00"	102.00"	96.00"



RECEIVED
 JUL 05 2017
 GA DNR