



MARK WILLIAMS
COMMISSIONER

A.G. "SPUD" WOODWARD
DIRECTOR

Public Notice

June 17, 2017

Mark V. Smith Revocable Trust, Mark V. Smith Trustee Dredging of Coastal Marshlands 141 Fairwind Road, Whitemarsh Island, Wilmington River, Chatham County, Georgia

This serves as notification from the Coastal Marshlands Protection Committee and the Georgia Department of Natural Resources of a request from Mark V. Smith Revocable Trust, Mark V. Smith Trustee for a Coastal Marshlands Protection Act (CMPA) Permit under O.C.G.A. 12-5-280 et. seq. to perform a one-time dredging event adjacent to 141 Fairwind Road, Whitemarsh Island, Wilmington River, Chatham County, Georgia.

Currently there is an existing private, single-family residential dock facility that was originally authorized in 2007. It consists of a 6ft. x 360ft. walkway, a partially covered 24ft. x 36ft. fixed deck, a 3ft. x 30ft. ramp leading to a 10ft. x 90ft. floating dock, and a 3ft. x 27ft. catwalk servicing a 14ft. x 28ft. covered hoist. A second 8ft. x 8ft. hoist is also associated with the structure. Impacts total approximately 4,551sq.ft. (0.11 acres).

The applicant is proposing to dredge approximately 6,400 cubic yards of material from a 1.29 acre area surrounding the private dock to provide for vessel access to the existing floating dock at all tidal stages. Current bottom elevations vary from -3ft to -8ft. at Mean Low Water (MLW). The proposed dredging will result in an -8ft. MLW along the landward side of the floating dock within the 1.29 acre dredge area.

An 8 inch hydraulic cutter head dredge positioned on a floating barge will be used to siphon the bottom of the Wilmington River within the project area. An agreement between the applicant and the Savannah Yacht Club authorizes the placement of

approximately 6,400 cubic yards of sediment into the upland confined disposal area owned by the Savannah Yacht Club.

The applicant has stated that the project contains an upland component that consists of the existing 9.3 acre confined upland disposal area owned by the Savannah Yacht Club.

It is the responsibility of the applicant to demonstrate that the project is not contrary to the public interest and that no feasible alternative sites exist. Impacts to coastal marshlands must be minimal in size. In passing upon the application for permit, the Coastal Marshlands Protection Committee shall consider the public interest: (1) Whether or not unreasonably harmful obstruction to or alteration of the natural flow of navigational water within the affected area will arise as a result of the proposal; (2) Whether or not unreasonably harmful or increased erosion, shoaling of channels, or stagnant areas of water will be created; and (3) Whether or not the granting of a permit and the completion of the applicant's proposal will unreasonably interfere with the conservation of fish, shrimp, oysters, crabs, clams, or other marine life, wildlife, or other resources, including but not limited to water and oxygen supply.

A detailed public notice with drawings has been distributed and is available by visiting the Division's website: CoastalGaDNR.org under "Marsh & Shore Permits".

Please provide this office with substantive, project-specific comments as to why the proposed work should or should not proceed. Comments and questions concerning this proposed project should be submitted in writing by the close of business July 17, 2017 to Deb Barreiro, Department of Natural Resources, 185 Richard Davis Drive, Suite 104, Richmond Hill, Georgia 31324.

Z:\25738\15738-0000\Engineering\Drawings\Drawings\Mark SMITH DREDGING.dwg - Jan 25, 2016 - 9:38:17 AM

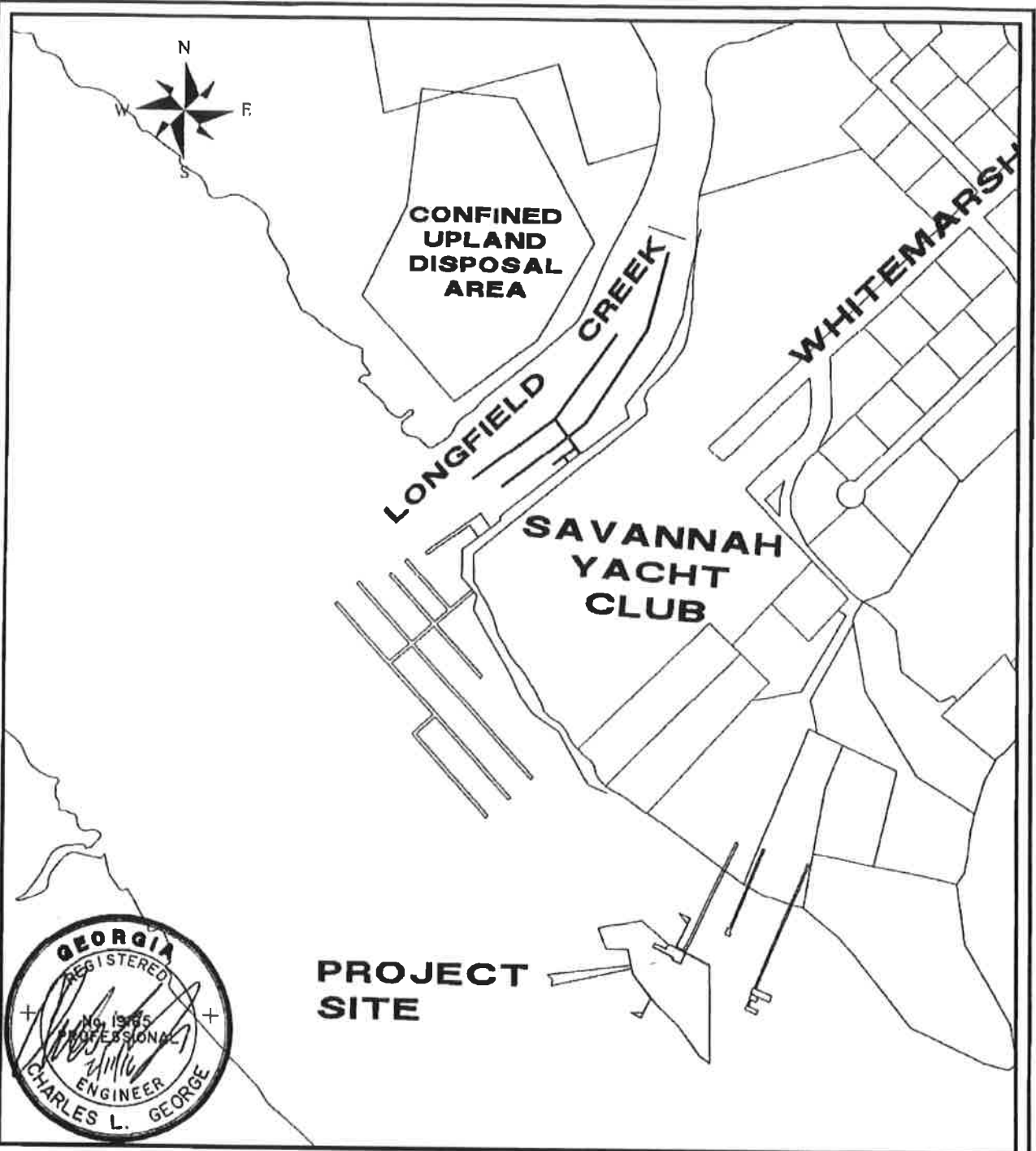

PROJECT MAP

PROPOSED ACTIVITY:
 HYDRAULIC MAINT. DREDGING OF EXIST. DOCK
 CLIENT:
 MARK SMITH
 LOCATION: CHATHAM COUNTY, GEORGIA
 DATE: JULY 28, 2015
 JOB NUMBER: J - 25738

SHEET: P2
 SCALE: 1" = 400.0002'



50 Park of Commerce Way
 Savannah, GA 31405 • 912.234.5300

www.thomasandhutton.com

Z:\25738\25738.000\Engineering\Drawings\Mark Smith Dredging.dwg - Feb 11, 2015 - 2:50:46 PM

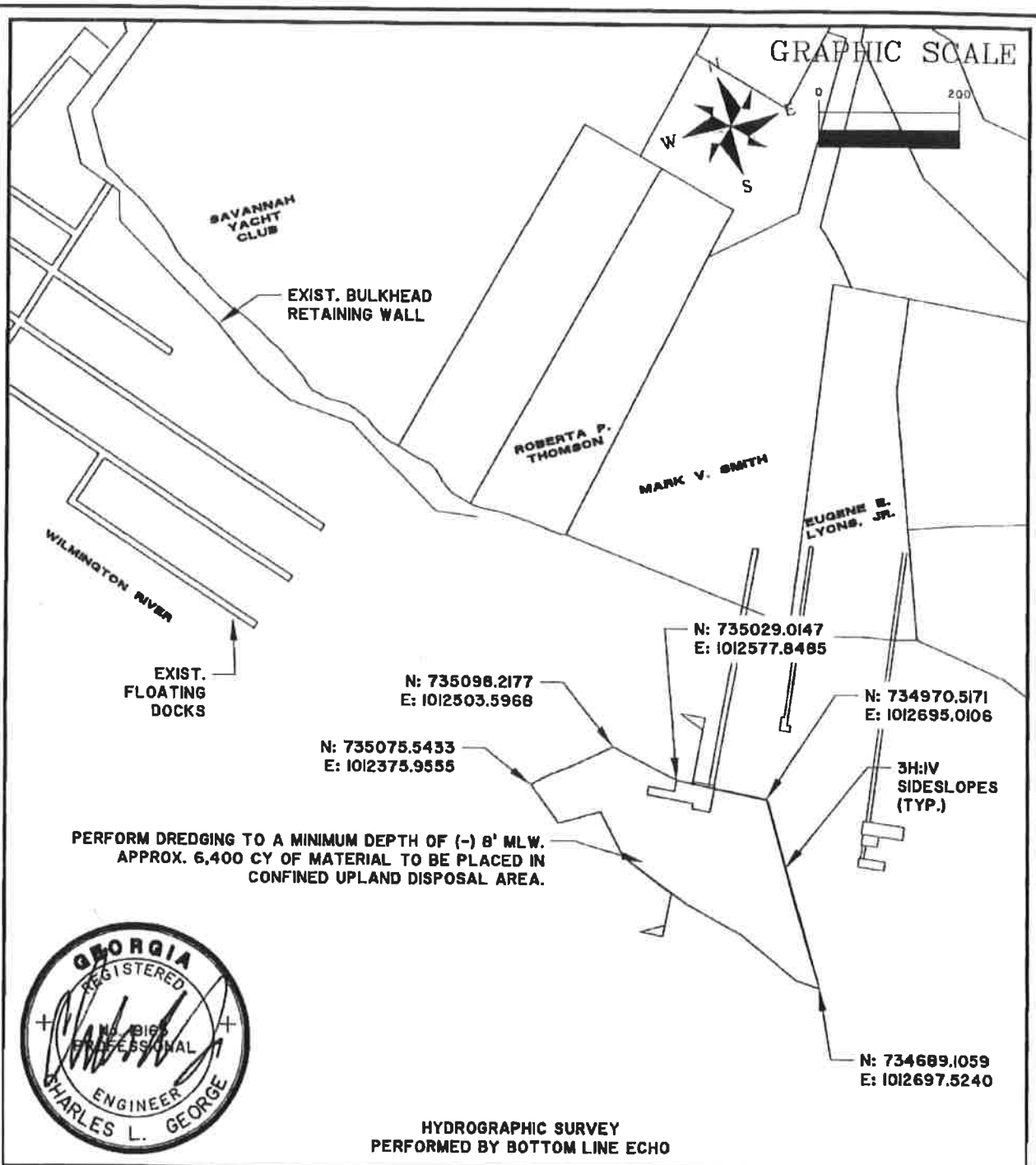

DREDGING PLAN - WILMINGTON RIVER
 PROPOSED ACTIVITY:
HYDRAULIC DREDGING OF EXIST. DOCK
 CLIENT:
MARK SMITH
 LOCATION: CHATHAM COUNTY, GEORGIA
 DATE: AUG 24, 2015
 JOB NUMBER: J - 25738

SHEET: P3
 SCALE: 1" = 200'

THOMAS & HUTTON
 Engineering | Surveying | Planning | GIS | Consulting

50 Park of Commerce Way
 Savannah, GA 31405 • 912.234.5300

www.thomasandhutton.com

Z:\25738\25738.DDD\Engineer\04\Drawings\Reek\MARK SMITH - PROPOSED 100 FT WIDE DREDGING.dwg - Feb 11 2016 - 2:30:02 PM

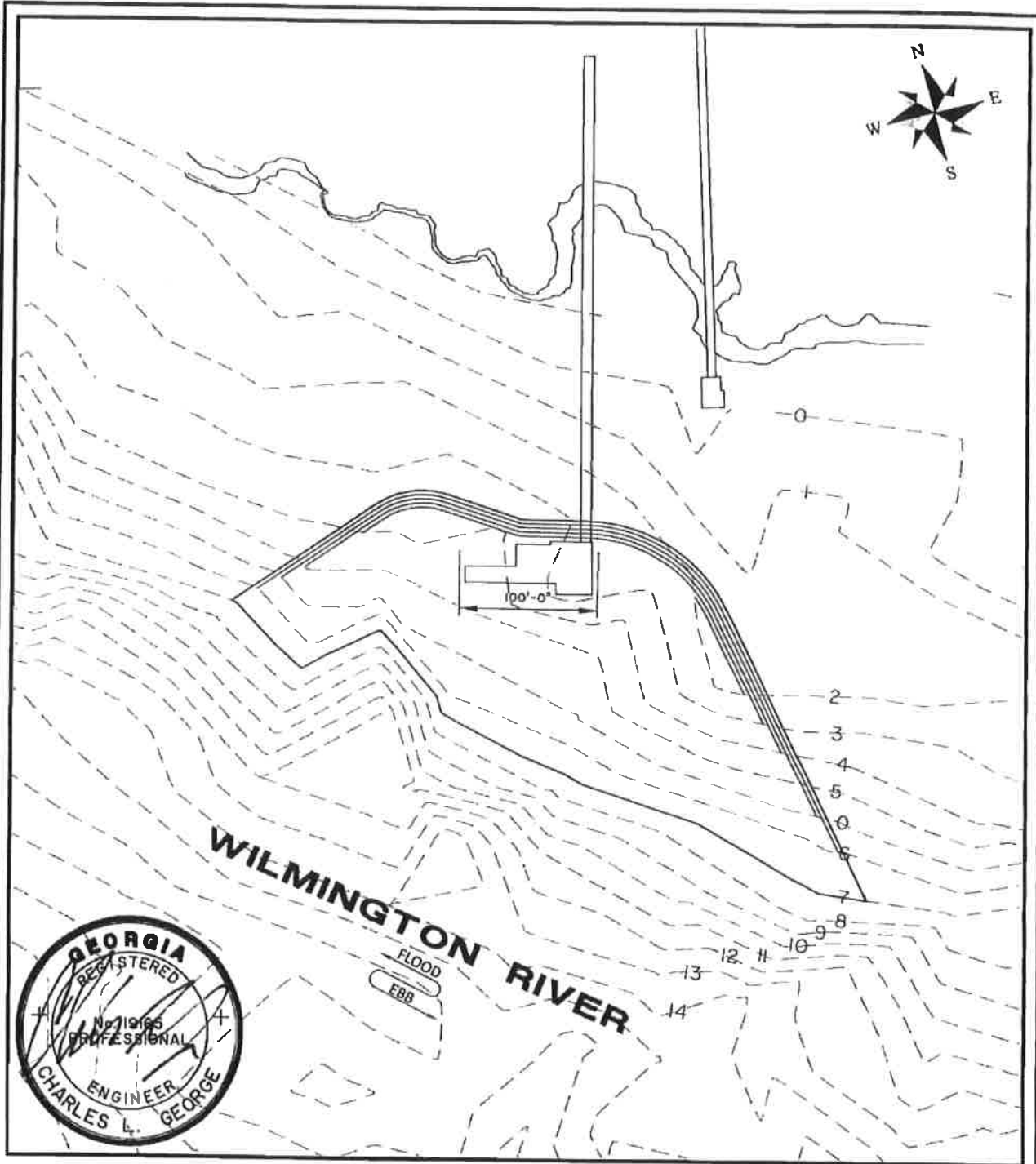

SITE PLAN

PROPOSED ACTIVITY:
HYDRAULIC MAINT. DREDGING OF EXIST. DOCK

CLIENT:
MARK SMITH

LOCATION: CHATHAM COUNTY, GEORGIA
DATE: JULY 28, 2015
JOB NUMBER: J - 25738

SHEET: P4
SCALE: 1" = 100'

THOMAS & HUTTON
Engineering | Surveying | Planning | GIS | Consulting

50 Park of Commerce Way
Savannah, GA 31405 • 912.234.5300

www.thomasandhutton.com

Z:\25738\25738 0000\Engineering\Drawings\Basic\25738 0000.dwg - Jun 25, 2016 - 9:35:16 AM

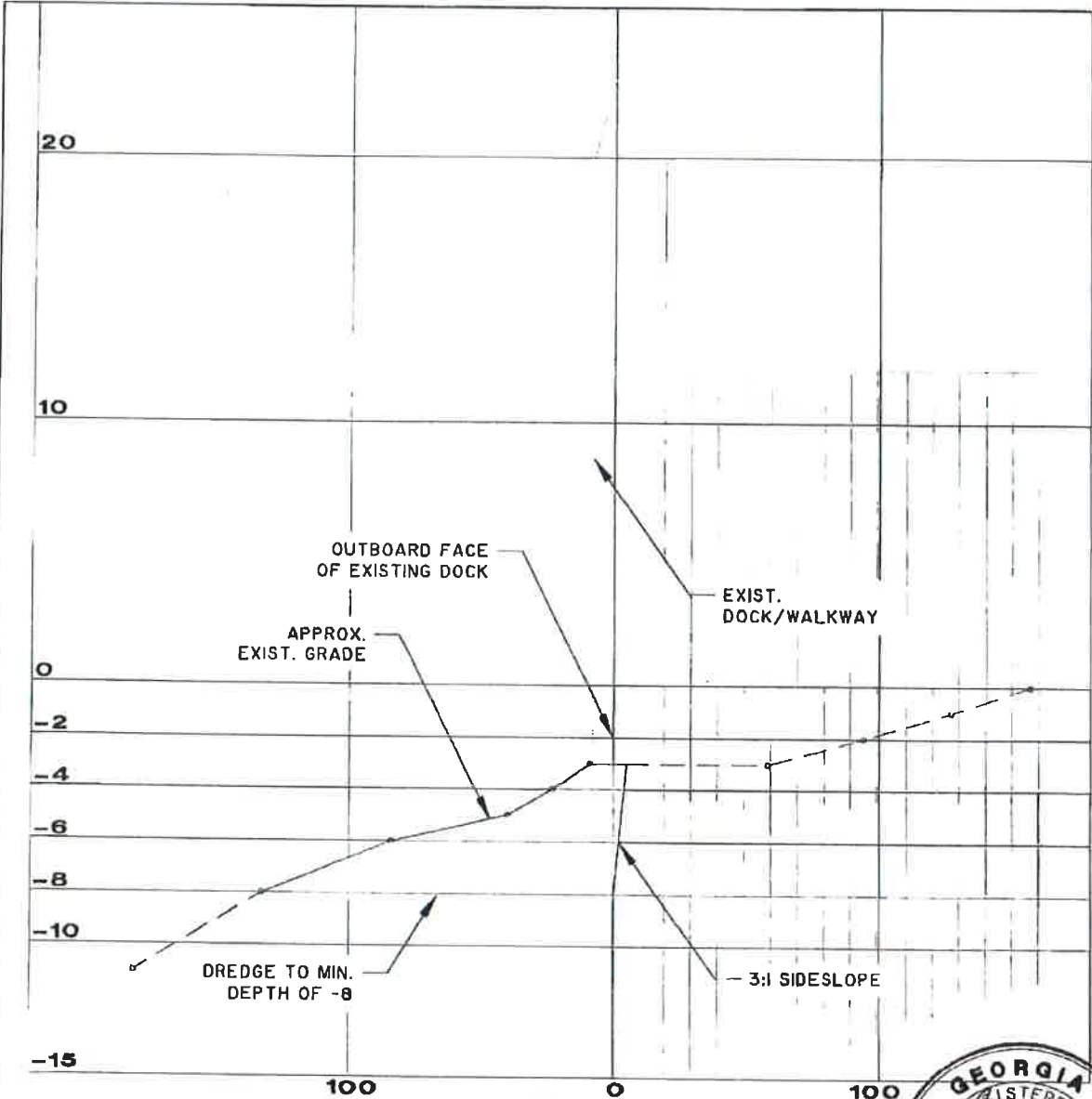

TYPICAL DREDGE SECTION

HORIZ: 1" = 60'
VERT: 1" = 6'



DREDGE SECTION
 PROPOSED ACTIVITY:
 HYDRAULIC MAINT. DREDGING OF EXIST. DOCK
 CLIENT:
MARK SMITH
 LOCATION: CHATHAM COUNTY, GEORGIA
 DATE: JULY 28, 2015
 JOB NUMBER: J - 25738

SHEET: P5
 SCALE: AS SHOWN

THOMAS & HUTTON
 Engineering | Surveying | Planning | GIS | Consulting

50 Park of Commerce Way
 Savannah, GA 31405 • 912.234.5300

www.thomasandhutton.com

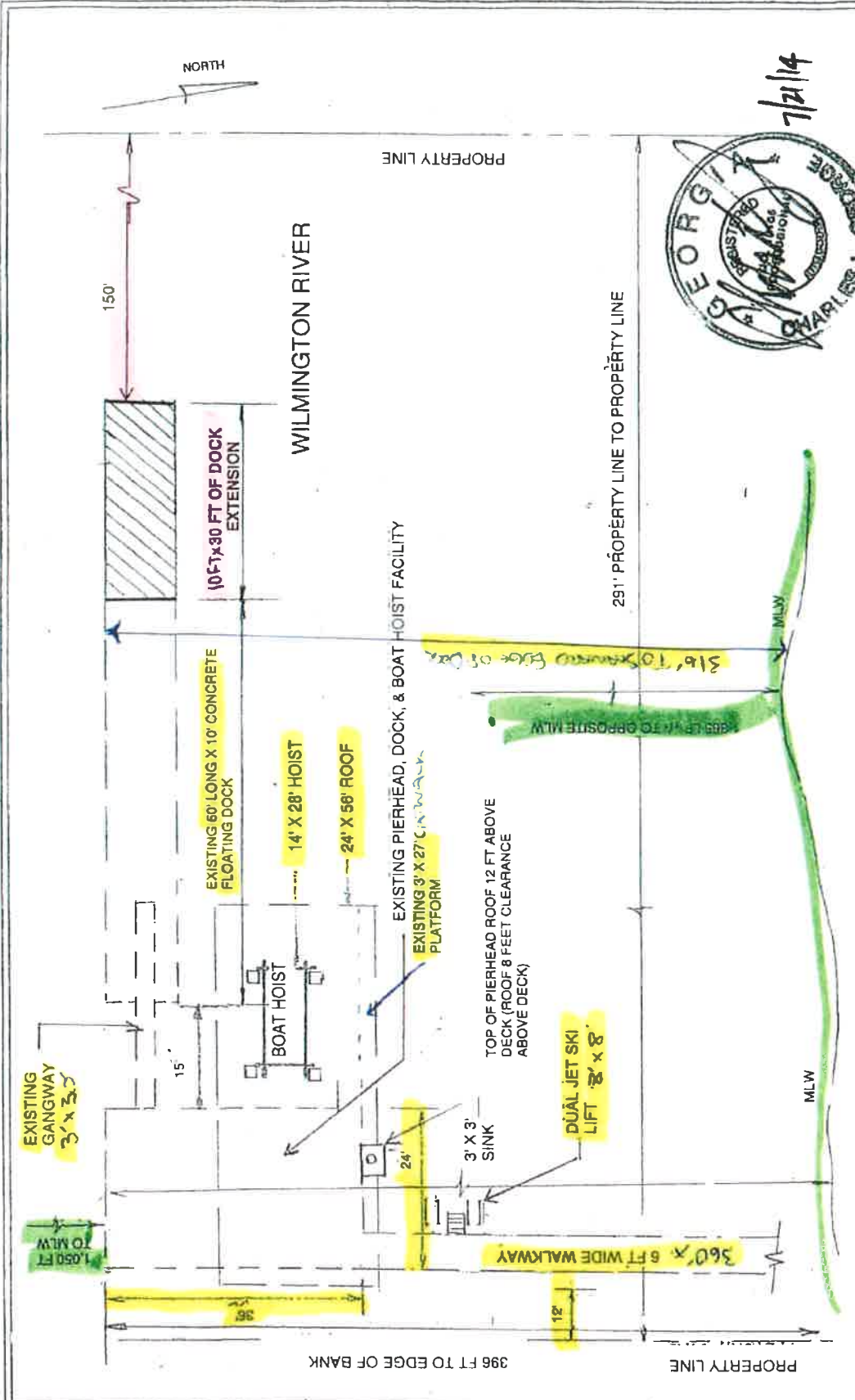

THOMAS & HUTTON
 50 PARK OF COMMERCE WAY • PO BOX 2727
 SAVANNAH, GA 31402-2727 • 912.234.5300
 www.thomasandhutton.com

The maps, drawings, or general plans of the development which it is for discussion purposes only does not limit or bind the engineer, architect, planner, or contractor in any way. The engineer, architect, planner, or contractor shall be responsible for all details and specifications. The engineer, architect, planner, or contractor shall be responsible for all details and specifications. The engineer, architect, planner, or contractor shall be responsible for all details and specifications.

7/21/14

PROPOSED ACTIVITY:
 FLOATING DOCK EXTENSION

DATUM:
 MLW

SHEET: of

SCALE: 1" = 20'

LOT 2 BRADLEY POINT-SMITH RESIDENCE
 SAVANNAH, GEORGIA
 APPLICANT: MARK SMITH

ATTACHMENT B

DATE: JULY 21, 2014
 COUNTY: CHATHAM

Charles Ezelle
Thomas & Hutton Engineering Co.
1503 Newcastle Street, Ste A
Brunswick, GA 31520

Laura Fabrizio
P.O. Box 643
Winston, GA 30187

Michael and Janene Wilson
P.O. Box 824
Richmond Hill, GA 31324

Jane Fraser
P.O. Box 31189
Sea Island, GA 31561

Tyler Frazier MCP
Glynn County Community Development
1725 Reynolds St., Ste 200
Brunswick, GA 31520

Rick Gardner
140 Bea Road
Richmond Hill, GA 31324

Roger Gay
515 Birch Ridge Court
Roswell, GA 30076

Kim Gollin
502 Wesley Oaks Circle
St. Simons, GA 31522

Karen Grainey
316 Tanglewood Road
Savannah, GA 31419

Zach Harris
130 Sea Palms Lane
St. Simons Island, GA 31522

Duane Harris
105 Demere Retreat Lane
St. Simons, GA 31522

Clark Harrison
2 Coquena Drive
Savannah, GA 31410

Joe Hatfield
Fieldale Farms Corporation
P.O. Box 558
Baldwin, GA 30511

Connie Haynes
401 Journey's End
Peachtree City, GA 30269

John Henderson
375 Youmans Road
Midway, GA 31320

Dianne Hilliard
134 Maxwell Street
Midway, GA 31320

John Hinely
813 Betz Creek Road
Savannah, GA 31410

Mike Holland
1103 Ratcliffe Lake Drive
Brunswick, GA 31523

Nicole Horton
Liberty Co. Building & Liscensing
100 North Main St., Ste 7410
Hinesville, GA 31313

Joni House
5671 Aven Road
Marietta, GA 30068

Stanley Humphries
500 North Breakers, 1470 Wood Ave.
St. Simons, GA 31522

Nate Hunt
Southern Environmental Law Center
127 Peachtree Street, Suite 605
Atlanta, GA 30303

Jack Jones
3820 Turners Rock Road
Savannah, GA 31410

Commissioner Mark Williams
GA DNR
2 Martin Luther King, Jr. Drive, Ste 1252 E
Atlanta, GA 30334

Teddy Kelley
265 Youmans Road
Midway, GA 31320

Catherine Wannamaker
31 Edenton Rd.
Mt. Pleasant, SC 29464

Rhonda Knight
117 Asbury Street
St. Simons, GA 31522

David Kyler
Center for a Sustainable Coast
221 Mallory Street, Suite B
St. Simons, GA 31522

Mary Landers
P.O. Box 1088
Savannah, GA 31402

Tony Langston
2690 Braswell Mountain Rd.
Dallas, GA 30132

Charlie Waller
GA Marine Business Association
16 Gale Break Circle
Savannah, GA 31406

Wilson Lee
9936 Cedar Lane
El Monte, CA 91731

Cliff Lewis
Watershed Protection Branch, GA EPD
531 Main St. Suite D
Tifton, GA 31794

Scott Lowman
P.O. Box 1302
Vidalia, GA 30475

Betty Anderson
19 Raleigh Dr.
Savannah, GA 31406

Darrell McCann
Dulany Industries
P.O. Box 546
Savannah, GA 31402

Joe McDonough
P.O. Box 20569
St. Simons, GA 31522

Cynthia Miles
Seabrook Village
660 Trade Hill Road
Midway, GA 31320

Frank Mirasola
4 Captain Wylly Road
Jekyll Island, GA 31527

Clay Mobley
Georgia Conservancy
428 Bull Street, Suite 210
Savannah, GA 31401

Elton Yawn
1456 Captains Cove Road NE
Townsend, GA 31331

Henry Morgan
4 Bransby Drive
Savannah, GA 31406

Nikki Wiley
The Brunswick News
3011 Altama Avenue
Brunswick, GA 31520

Pat Music
251 Midway Circle
Brunswick, GA 31520

Lane Nelson
23 Full Sweep Drive
Savannah, GA 31419

Joe Parker Jr.
125 South Main
Hinesville, GA 31313

Ms. Gerard Quinn
98 Hallock Landing Road
Rocky Point, NY 11778

Sherelle Reinhardt
Savannah District Corps of Engineers
100 West Oglethorpe Avenue
Savannah, GA 31401

David Retterbush MD
3324 Plantation Drive
Valdosta, GA 31560

David Royer
The Brunswick News
3011 Altama
Brunswick, GA 31522

Mark Sanchez
1455 Otter Slide Loop NE
Townsend, GA 31331

William Sapp
Southern Environmental Law Center
Ten 10th Street NW, Suite 1050
Atlanta, GA 30309

Helen Barnes
Southern Environmental Law Center
Ten 10th Street NW, Suite 1050
Atlanta, GA 30309

Daren Schatz
858 Williamson Road
Mooresville, NC 28117

Peter Schoenauer
102 Driver Morris St.
St. Simons, GA 31522

Robert Sebek
P.O. Box 8161
Savannah, GA 31412

George Sedberry
Gray's Reef National Marine Sanctuary
10 Ocean Science Circle
Savannah, GA 31411

Robert Sisson
16 Hopecrest Avenue
Savannah, GA 31406

Earl Slocum
115 Tolomato Trace
St. Simons, GA 31522

Bradley Smith
EPD
400 Commerce Center Drive
Brunswick, GA 31523

James Wilson
85 Drum Point Way
Midway, GA 31320

Donald Stack
Stack & Associates, P.C.
260 Peachtree St., NW Suite 1200
Atlanta, GA 30303

Richard Stafford
368 Davis Road, Heron Point
Richmond Hill, GA 31324

Brian Stanley
102 Cartersville Rd Ext
Cartersville, VA 23027

Stuart Stevens
765 St. Paul Road
E. Dublin, GA 31027

Alan Stewart
6407 Statesboro Hwy.
Sylvania, GA 30467

Margee Theiler
208 Maple Street
St. Simons, GA 31522

Monty Walker
Monty Walker Dock Builders
6 Sayle Lane
Richmond Hill, GA 31324

Rick Thomas
103 River's Edge Drive
Savannah, GA 31406

To whom it may concern
Altamaha Riverkeeper
P. O. Box 4122
Macon, GA 31208

To whom it may concern
G2, H, G, Inc.
102 East 48th Street
Savannah, GA 31405

To whom it may concern
Ogeechee River Keeper
P.O. Box 16206
Savannah, GA 31416

To whom it may concern
Sligh Environmental Consultants, Inc.
31 Park of Commerce Way, Ste 200 B
Savannah, GA 31405

To whom it may concern
U.S. Fish and Wildlife Service
4980 Wildlife Drive, NE
Townsend, GA 31331

Mrs. J.M. Turbidy
Post Office Box 30055
Sea Island, GA 31561

To whom it may concern
City of Tybee Island, Planning & Zoning
P.O. Box 2749
Tybee Island, GA 31328

Eric Landon, Director
Camden County Palnning & Development
107 Gross Road, Ste 3
Kingsland, GA 31548

HunterMaclean
c/o Andrew H. Ernst
200 E. Saint Julian Street
P.O. Box 9848
Savannah, GA 31412-0048

APD's

Roberta B. Thompson
149 Fairwind Road
Savannah, GA 31410

Eugene E. Lyons, Jr.
182 Fairwind Road
Savannah, Ga 31410

AGENT

Sligh Environmental Consultants, Inc.
Attn: Stuart F. Sligh
31 Park of Commerce Way, Suite 200B
Savannah, GA 31405 (912) 232-0451
s_sligh@slighec.com