

## VICINITY MAP

PROPOSED ACTIVITY: FACILITY UPGRADES

Applicant: SAFE HARBOR

Date: 08-14-25

County: CHATHAM

JOB#: 25-1016

SCALE: 1" = 2 Miles

DATUM: NAVD88

SHEET: 1 of 11

SCALE: 1"=2 MILES



## SAVANNAH YACHT CENTER UPGRADES

SAVANNAH, GEORGIA

### GENERAL NOTES:

1. SOURCE OF MAPS - MICROSOFT BING
2. PROJECT LOCATION  
LAT: N 32° 5'47.97"  
LON: W 81° 6'39.78"



## Ball Maritime Group

4 Cedar View Court | Savannah, GA 31410  
www.ballmaritime.com | (912) 662-2914  
Copyright © 2024

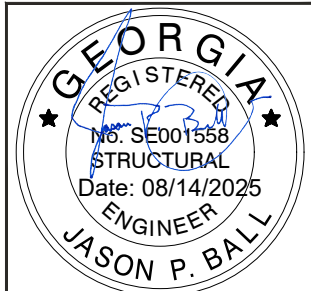



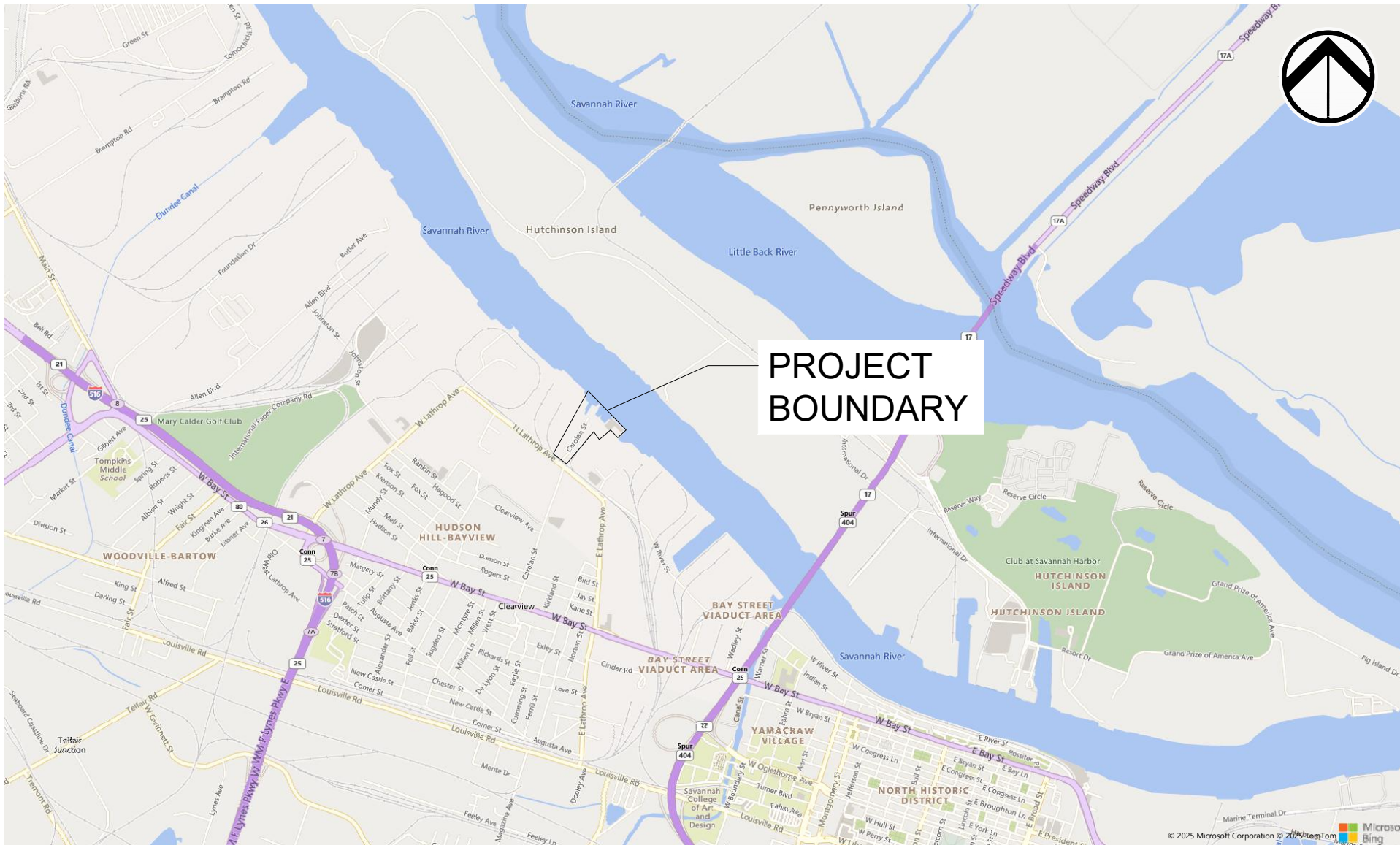

## LOCATION MAP

PROPOSED ACTIVITY: FACILITY UPGRADES

## SAVANNAH YACHT CENTER UPGRADES

SAVANNAH, GEORGIA

Applicant: SAFE HARBOR

Date: 08-14-25

County: CHATHAM

JOB#: 25-1016

SCALE: 1" = 1/2 Mile

DATUM: NAVD88

SHEET: 2 of 11

### GENERAL NOTES:

1. SOURCE OF MAPS - MICROSOFT BING
2. PROJECT LOCATION  
LAT: N 32° 5'47.97"  
LON: W 81° 6'39.78"



## Ball Maritime Group

4 Cedar View Court | Savannah, GA 31410  
www.ballmaritime.com | (912) 662-2914  
Copyright © 2024

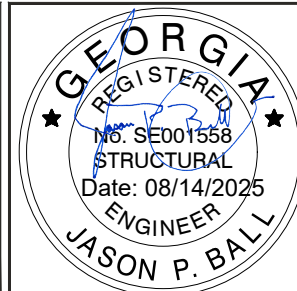

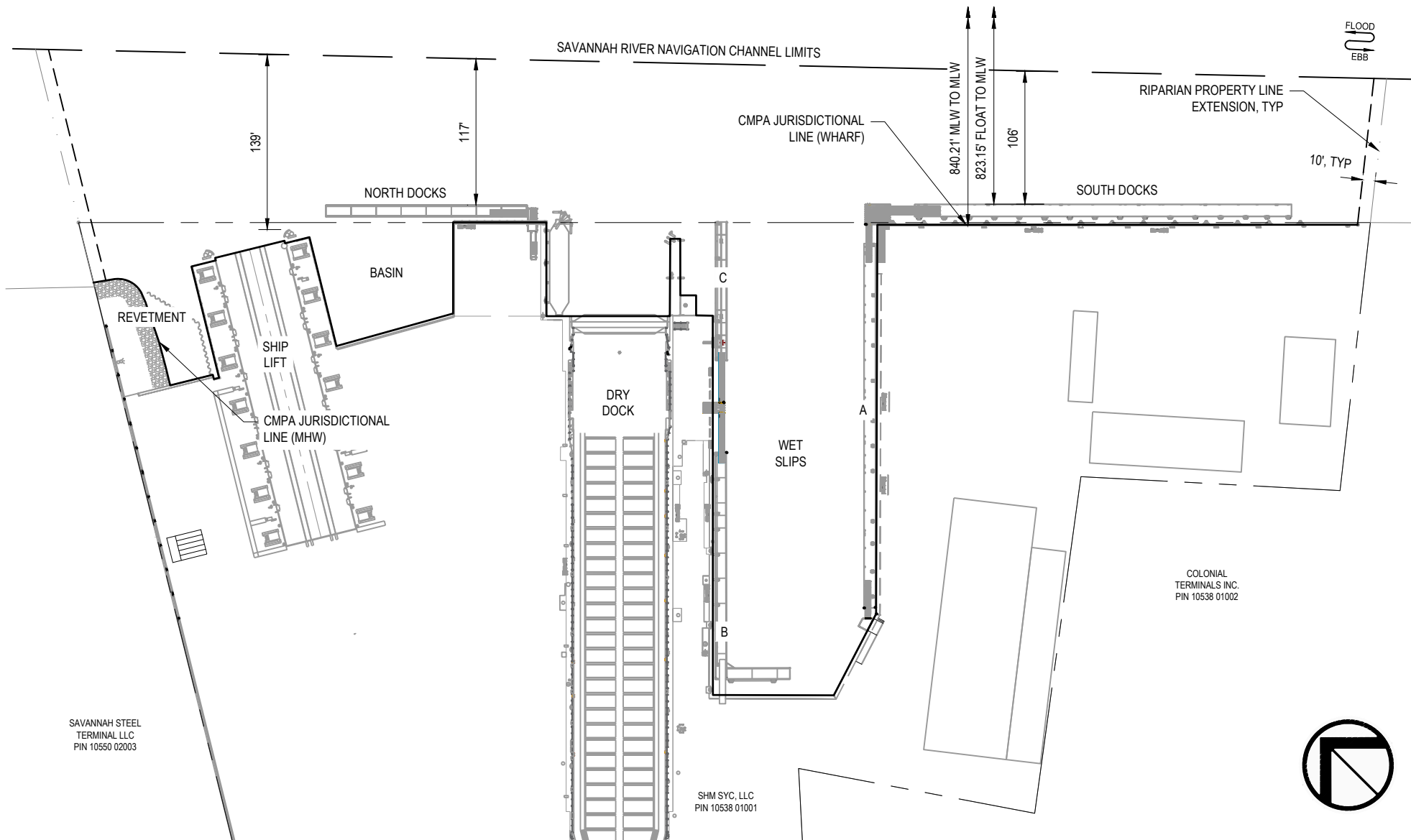

### EXISTING CONDITIONS

**PROPOSED ACTIVITY:** FACILITY UPGRADES

**Applicant:** SAFE HARBOR

**Date:** 08-14-25

**County:** CHATHAM

**JOB#:** 25-1016

**SCALE:** 1" = 110'

**DATUM:** NAVD88

**SHEET:** 3 of 11

### SAVANNAH YACHT CENTER UPGRADES

SAVANNAH, GEORGIA

- GENERAL NOTES:**
- EXISTING LAYOUT BASED ON AS-BUILT FACILITY PLAN PROVIDED BY SAFE HARBOR (OWNER) & SAGIS.ORG GIS INFORMATION.
  - SEE SHEET 4 FOR PROPOSED PLANS.
  - THERE ARE EXISTING STRUCTURES INSIDE JURISDICTIONAL AREA.
  - MHW & MLW DERIVED FROM NOAA STATION FORT PULASKI, NAVD88 DATUM.
  - BUILDINGS, OTHER STRUCTURES, & TEMPORARY ITEMS NOT SHOWN FOR CLARITY.



## Ball Maritime Group

4 Cedar View Court | Savannah, GA 31410  
[www.ballmaritime.com](http://www.ballmaritime.com) | (912) 662-2914  
 Copyright © 2024

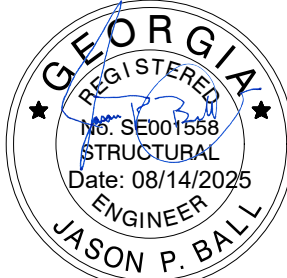

SAVANNAH RIVER NAVIGATION CHANNEL LIMITS

FLOOD  
EBB

RIPARIAN PROPERTY LINE  
EXTENSION, TYP

CMPA JURISDICTIONAL  
LINE (WHARF)

CMPA JURISDICTIONAL  
LINE (MHW)

NORTH DOCKS

SOUTH DOCKS

BASIN

SHIP  
LIFT

REVTMENT

SHEET 7

SHEET 5

SHEET 6

DRY  
DOCK

WET  
SLIPS

COLONIAL  
TERMINALS INC.  
PIN 10538 01002

SAVANNAH STEEL  
TERMINAL LLC  
PIN 10550 02003

SHM SYC, LLC  
PIN 10538 01001

## PROPOSED UPGRADES

PROPOSED ACTIVITY: FACILITY UPGRADES

## SAVANNAH YACHT CENTER UPGRADES

SAVANNAH, GEORGIA

Applicant: SAFE HARBOR

Date: 08-14-25

County: CHATHAM

JOB#: 25-1016

SCALE: 1" = 110'

DATUM: NAVD88

SHEET: 4 of 11

### GENERAL NOTES:

1. EXISTING LAYOUT BASED ON AS-BUILT FACILITY PLAN PROVIDED BY SAFE HARBOR (OWNER) & SAGIS.ORG GIS INFORMATION.
2. SEE SHEETS 5, 6, & 7 FOR PROPOSED DETAILED PLANS.
3. THERE ARE EXISTING STRUCTURES INSIDE JURISDICTIONAL AREA.
4. MHW & MLW DERIVED FROM NOAA STATION FORT PULASKI, NAVD88 DATUM.
5. BUILDINGS, OTHER STRUCTURES, & TEMPORARY ITEMS NOT SHOWN FOR CLARITY.



# Ball Maritime Group

4 Cedar View Court | Savannah, GA 31410

www.ballmaritime.com | (912) 662-2914

Copyright © 2024

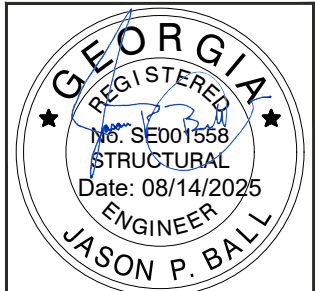

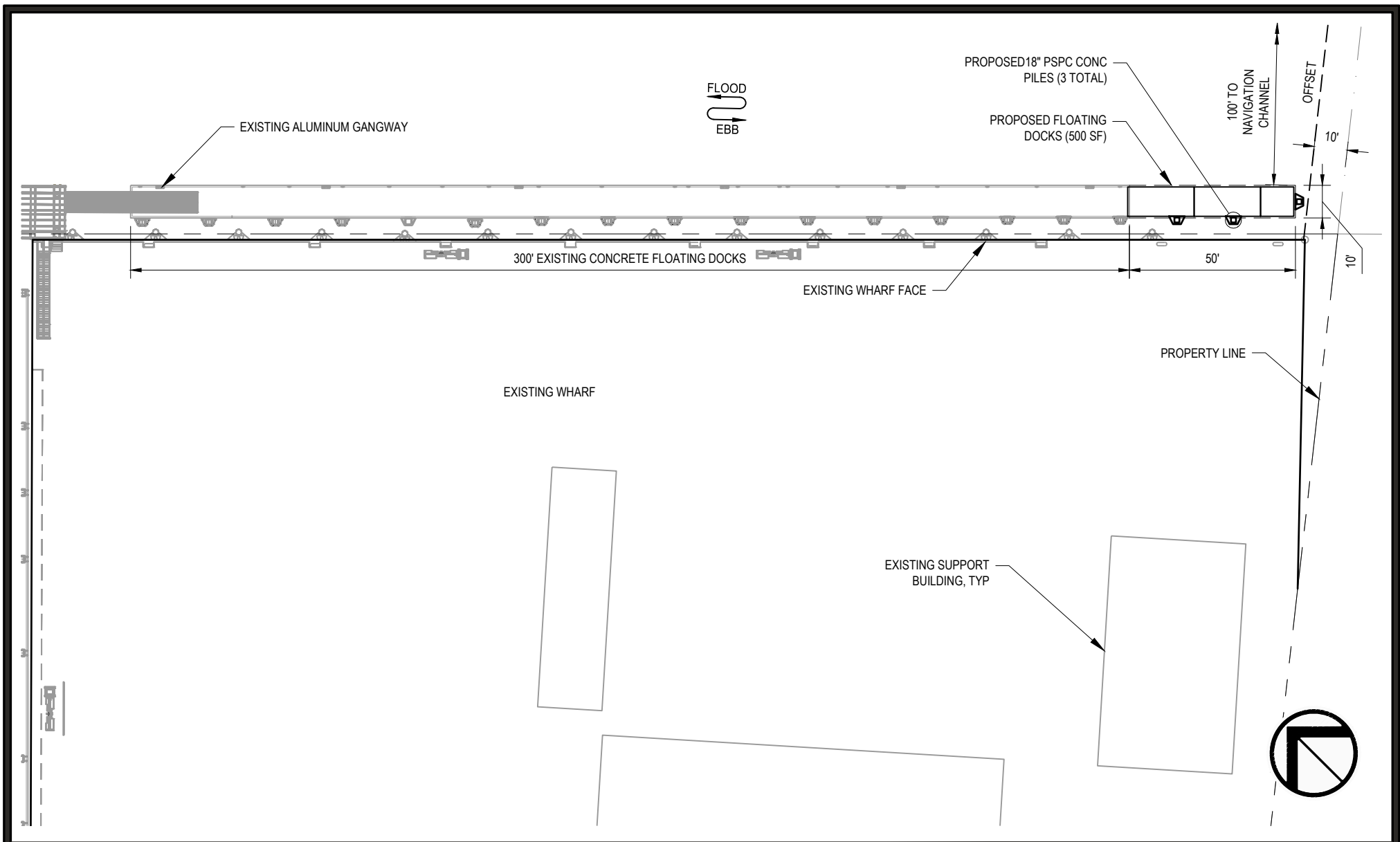

## DETAILED PLAN

PROPOSED ACTIVITY: FACILITY UPGRADES

Applicant: SAFE HARBOR

Date: 08-14-25

County: CHATHAM

JOB#: 25-1016

SCALE: 1" = 40'

DATUM: NAVD88

SHEET: 5 of 11

## SAVANNAH YACHT CENTER UPGRADES

SAVANNAH, GEORGIA

### GENERAL NOTES:

1. EXISTING LAYOUT BASED ON AS-BUILT FACILITY PLAN PROVIDED BY SAFE HARBOR (OWNER) & SAGIS.ORG GIS INFORMATION.
2. SEE SHEET 8 FOR TYPICAL FLOATING DOCK ELEVATION.
3. THERE ARE EXISTING STRUCTURES INSIDE JURISDICTIONAL AREA.
4. MHW & MLW DERIVED FROM NOAA STATION FORT PULASKI, NAVD88 DATUM.
5. BUILDINGS, OTHER STRUCTURES, & TEMPORARY ITEMS NOT SHOWN FOR CLARITY.



# Ball Maritime Group

4 Cedar View Court | Savannah, GA 31410

www.ballmaritime.com | (912) 662-2914

Copyright © 2024

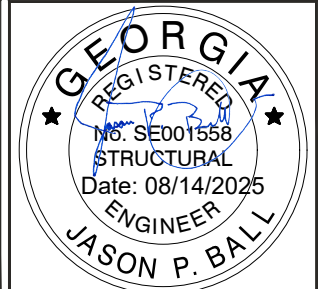

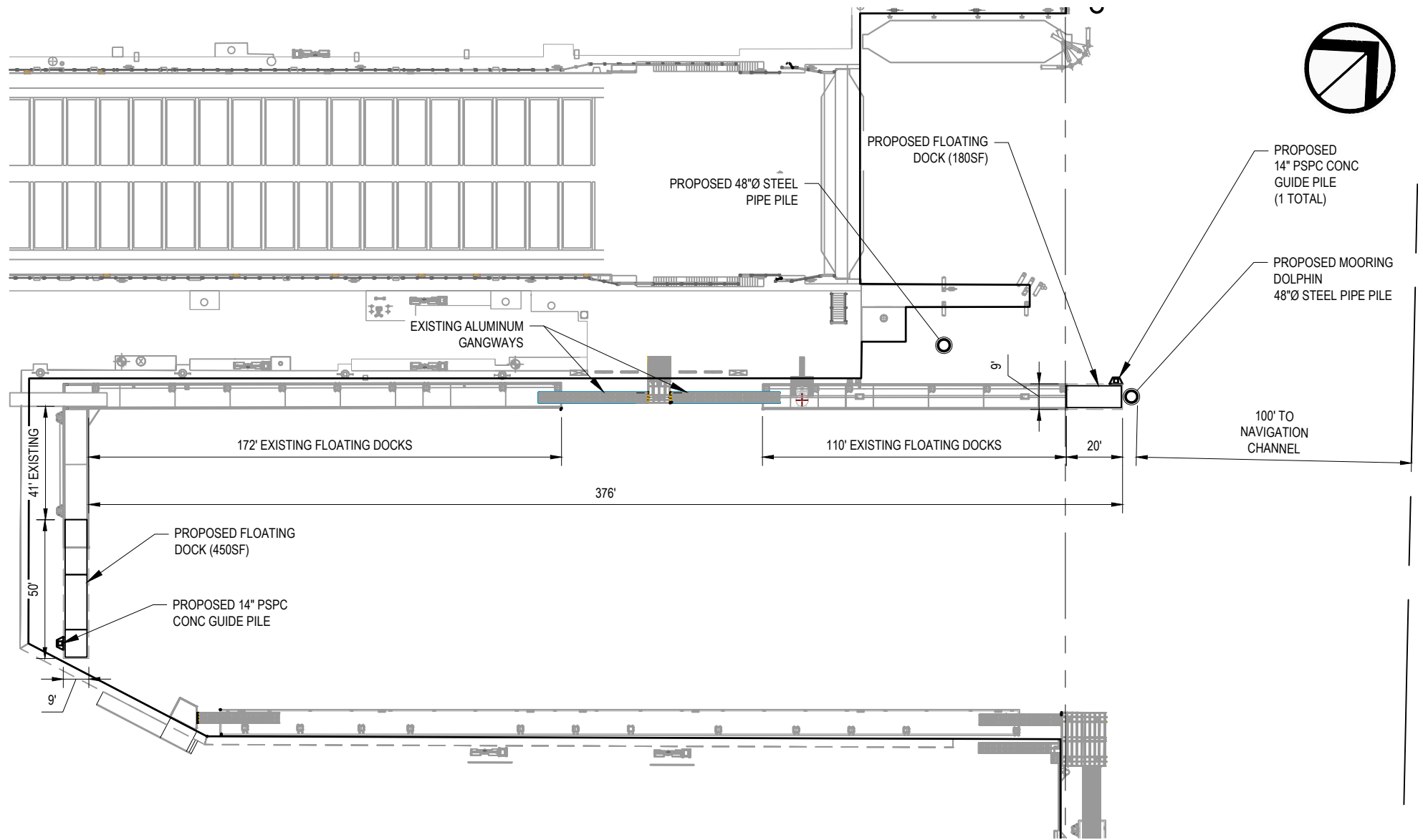

## DETAILED PLAN

PROPOSED ACTIVITY: FACILITY UPGRADES

## SAVANNAH YACHT CENTER UPGRADES

SAVANNAH, GEORGIA

Applicant: SAFE HARBOR

Date: 08-14-25

County: CHATHAM

JOB#: 25-1016

SCALE: 1" = 50'

DATUM: NAVD88

SHEET: 6 of 11

### GENERAL NOTES:

1. EXISTING LAYOUT BASED ON AS-BUILT FACILITY PLAN PROVIDED BY SAFE HARBOR (OWNER) & SAGIS.ORG GIS INFORMATION.
2. SEE SHEET 8 FOR TYPICAL FLOATING ELEVATION.
3. THERE ARE EXISTING STRUCTURES INSIDE JURISDICTIONAL AREA.
4. MHW & MLW DERIVED FROM NOAA STATION FORT PULASKI, NAVD88 DATUM.
5. BUILDINGS, OTHER STRUCTURES, & TEMPORARY ITEMS NOT SHOWN FOR CLARITY.



## Ball Maritime Group

4 Cedar View Court | Savannah, GA 31410

www.ballmaritime.com | (912) 662-2914

Copyright © 2024





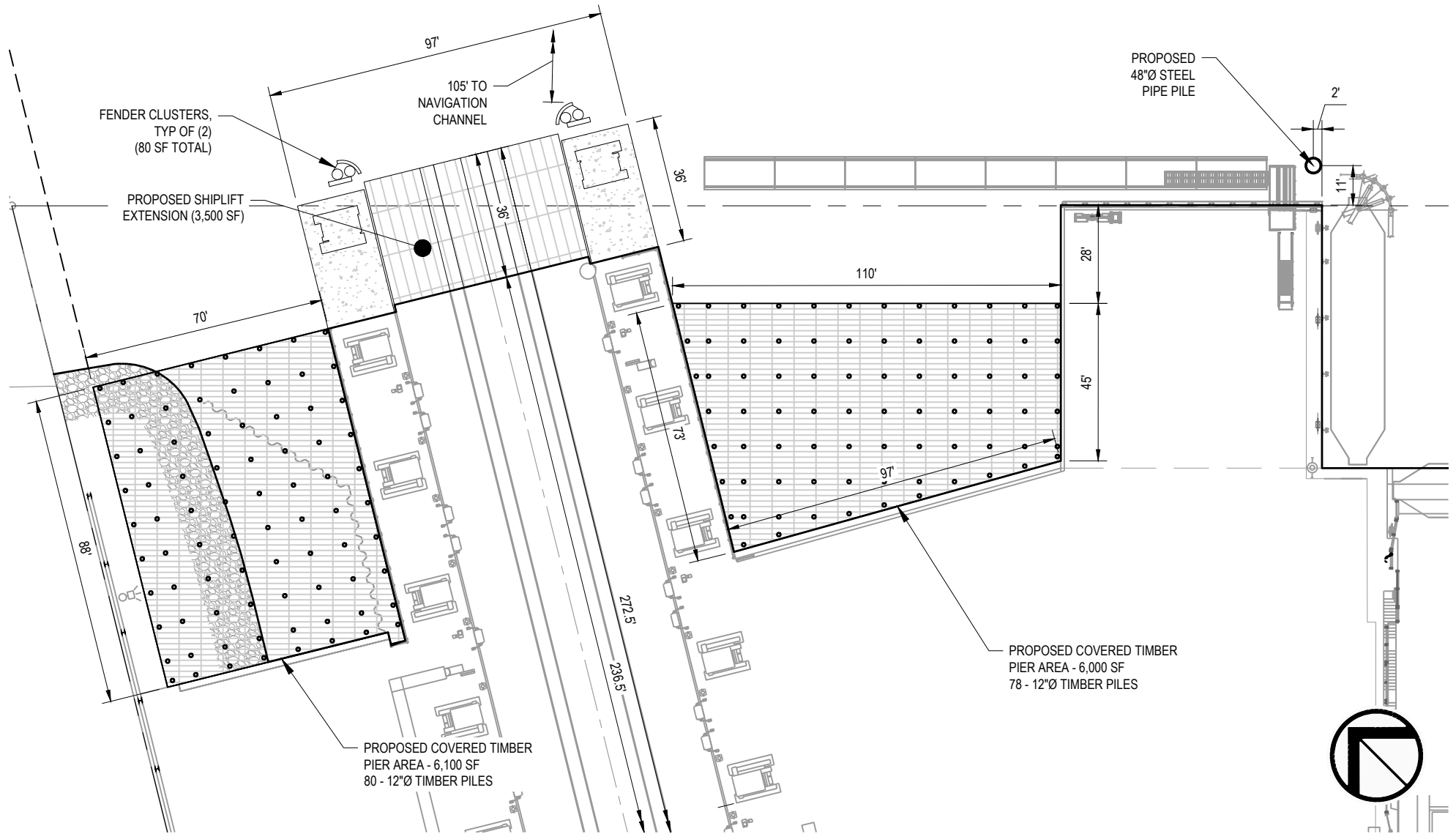

## DETAILED PLAN

PROPOSED ACTIVITY: FACILITY UPGRADES

## SAVANNAH YACHT CENTER UPGRADES

SAVANNAH, GEORGIA

Applicant: SAFE HARBOR

Date: 08-14-25

County: CHATHAM

JOB#: 25-1016

SCALE: 1" = 40'

DATUM: NAVD88

SHEET: 7 of 11

### GENERAL NOTES:

1. EXISTING LAYOUT BASED ON AS-BUILT FACILITY PLAN PROVIDED BY SAFE HARBOR (OWNER) & SAGIS.ORG GIS INFORMATION.
2. SEE SHEET 9 FOR TYPICAL COVERED TIMBER PIER ELEVATION.
3. SEE SHEET 10 FOR SHIPLIFT ELEVATION.
4. THERE ARE EXISTING STRUCTURES INSIDE JURISDICTIONAL AREA.
5. MHW & MLW DERIVED FROM NOAA STATION FORT PULASKI, NAVD88 DATUM.
6. BUILDINGS, OTHER STRUCTURES, & TEMPORARY ITEMS NOT SHOWN FOR CLARITY.



## Ball Maritime Group

4 Cedar View Court | Savannah, GA 31410

www.ballmaritime.com | (912) 662-2914

Copyright © 2024



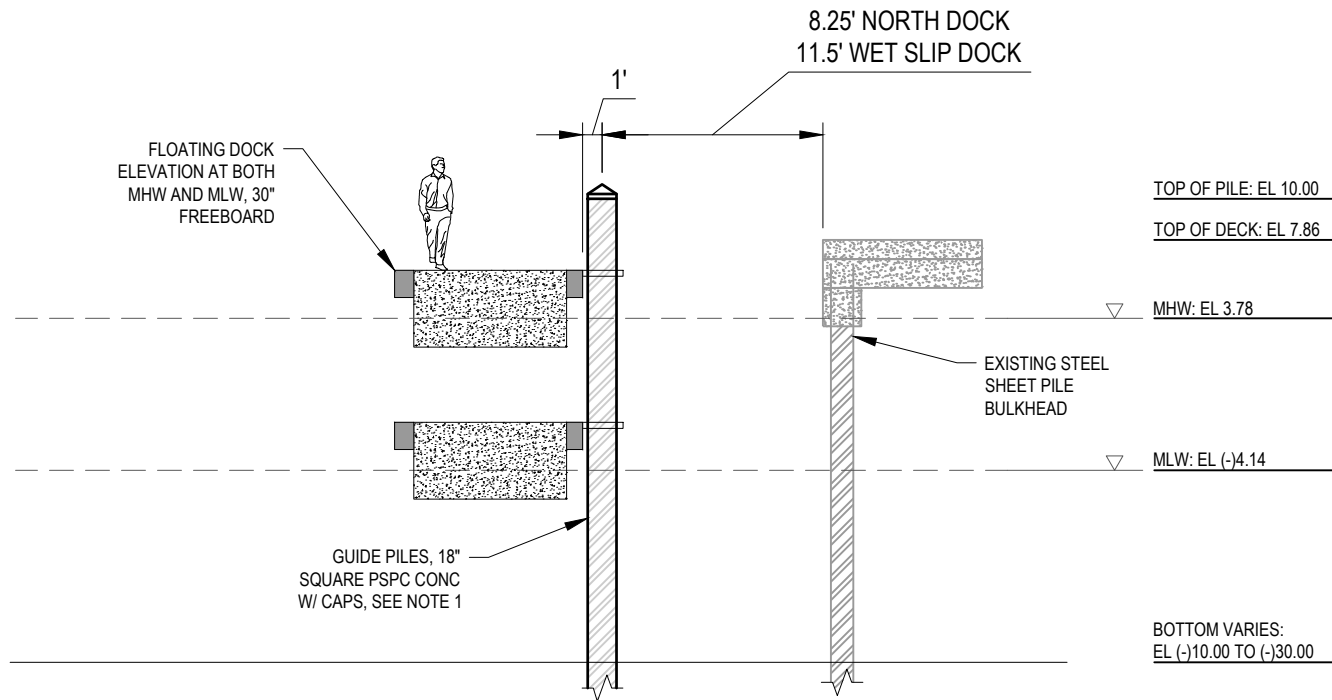

#### NOTES:

1. DEPTH OF MUD LINE VARIES. DRIVE EACH PILE TO A MIN DEPTH OF 35' BELOW MUD LINE. FINAL LOCATION OF PILES TO BE DETERMINED BY CONTRACTOR.
2. ALL HARDWARE TO BE HDG OR EQUAL.
3. CONCRETE FLOATING DOCKS TO BE SAME SIZE & SHAPE AS EXISTING. SEE SHEET 11 FOR TYPICAL SECTIONS.

## ELEVATION

### SAVANNAH YACHT CENTER UPGRADES

PROPOSED ACTIVITY: FACILITY UPGRADES

SAVANNAH, GEORGIA

Applicant: SAFE HARBOR

Date: 08-14-25

County: CHATHAM

JOB#: 25-1016

SCALE: N.T.S

DATUM: NAVD88

SHEET: 8 of 11

SCALE: 1"=50' (IN FEET)

#### GENERAL NOTES:



## Ball Maritime Group

4 Cedar View Court | Savannah, GA 31410

www.ballmaritime.com | (912) 662-2914

Copyright © 2024

Date: 08/14/2025



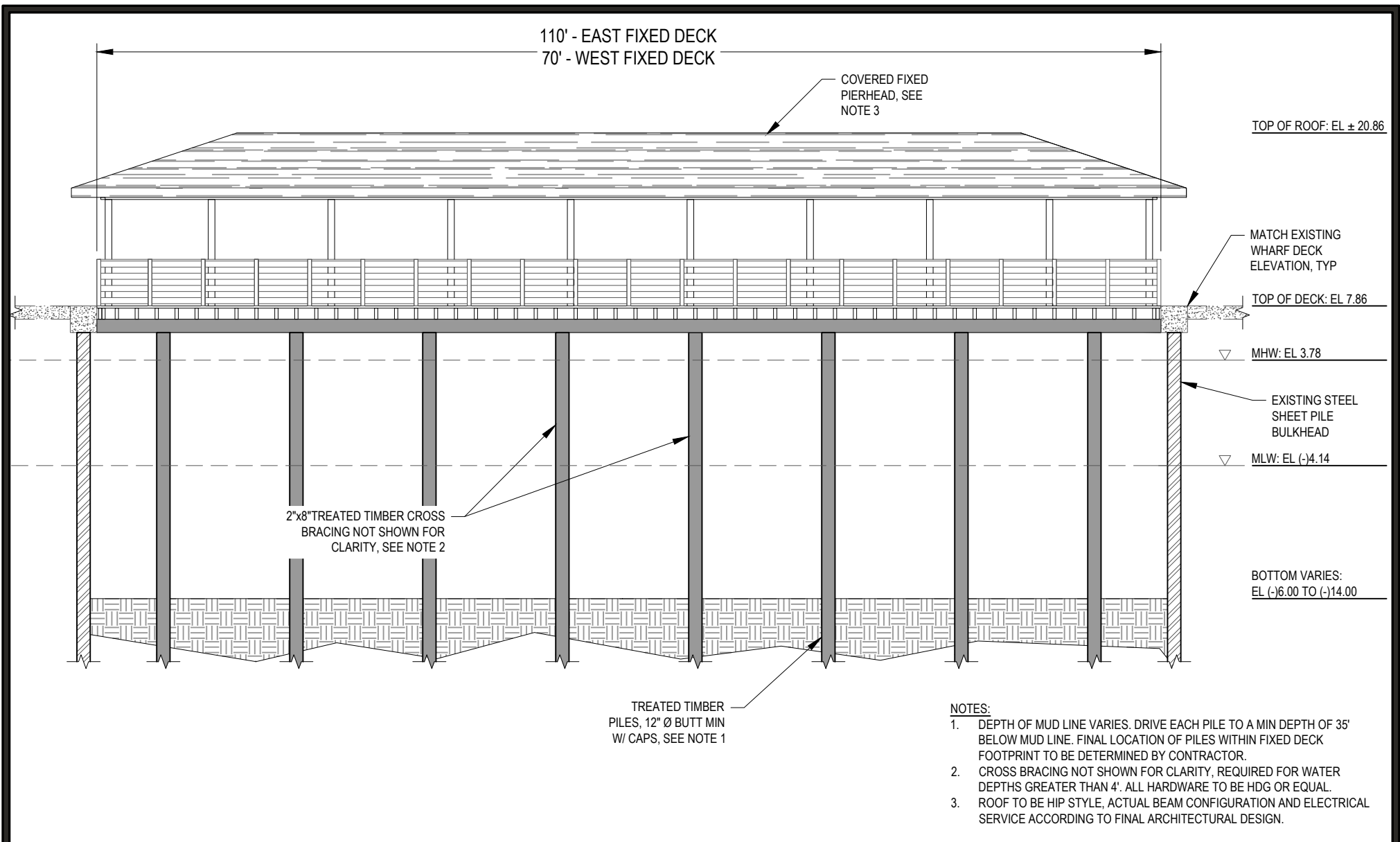

## ELEVATION

PROPOSED ACTIVITY: FACILITY UPGRADES

Applicant: SAFE HARBOR

Date: 08-14-25

County: CHATHAM

JOB#: 25-1016

SCALE: N.T.S

DATUM: NAVD88

SHEET: 9 of 11

## SAVANNAH YACHT CENTER UPGRADES

SAVANNAH, GEORGIA

### GENERAL NOTES:



**Ball Maritime Group**

4 Cedar View Court | Savannah, GA 31410

www.ballmaritime.com | (912) 662-2914

Copyright © 2024

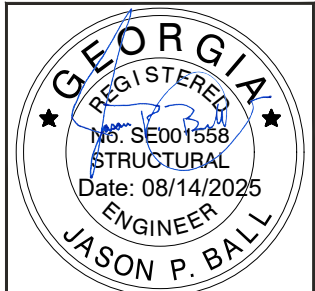

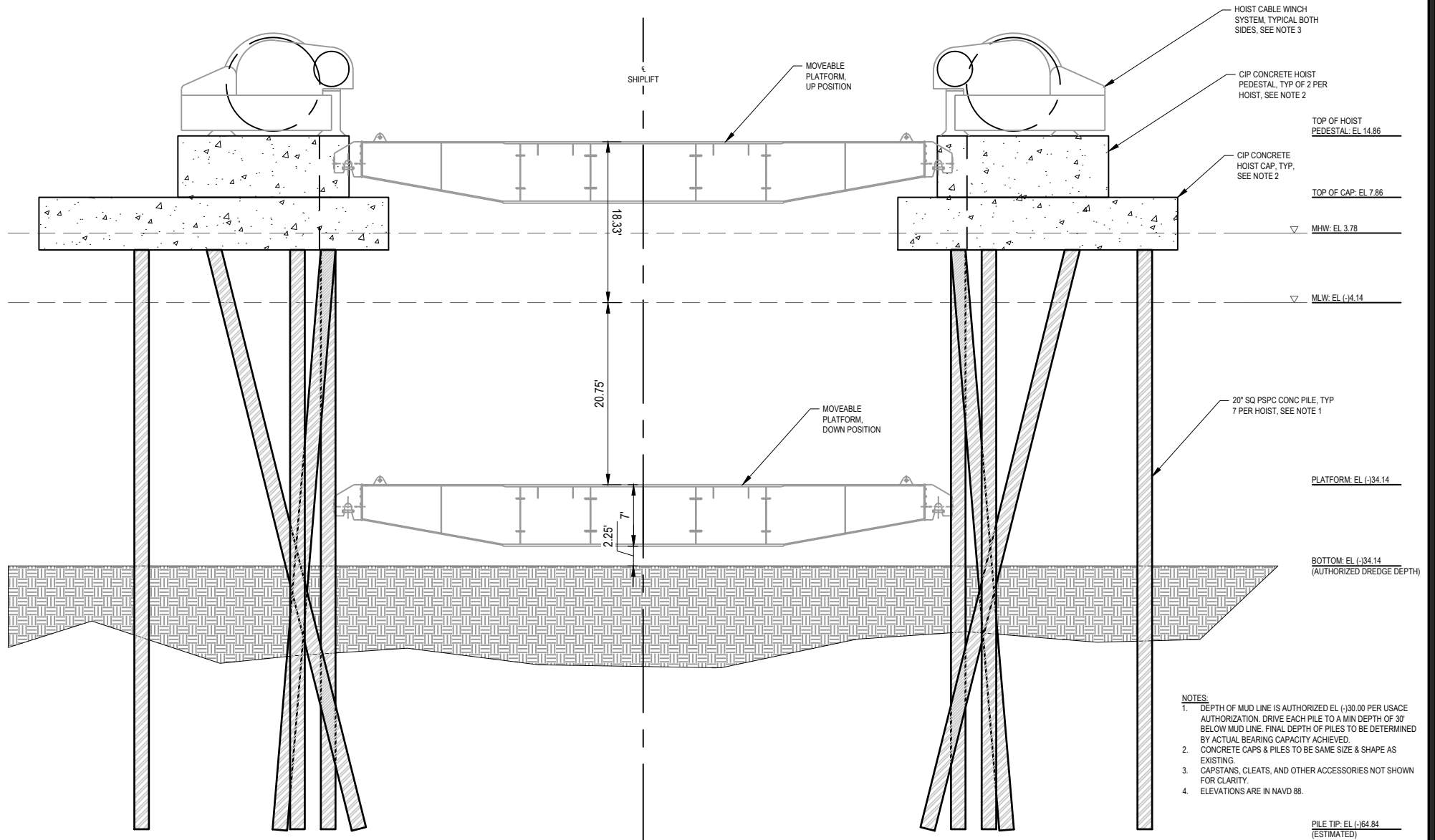

## ELEVATION

PROPOSED ACTIVITY: FACILITY UPGRADES

**SAVANNAH YACHT  
CENTER UPGRADES**  
SAVANNAH, GEORGIA

Applicant: **SAFE HARBOR**

Date: **08-14-25**

County: **CHATHAM**

JOB#: **25-1016**

SCALE: **N.T.S**

DATUM: **NAVD88**

SHEET: **10 of 11**

## GENERAL NOTES:



**Ball Maritime Group**

4 Cedar View Court | Savannah, GA 31410

www.ballmaritime.com | (912) 662-2914

Copyright © 2024



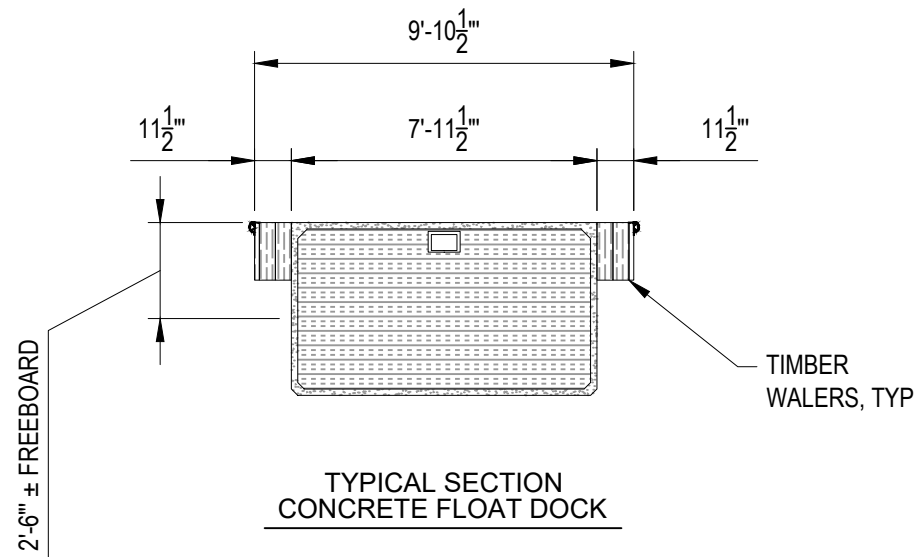

**NOTES:**

1. CORE OF FLOAT IS POLYSTYRENE.
2. CORE IS ENCAPSULATED BY PRECAST REINFORCED CONCRETE.
3. GUIDE PILE BRACKETS AND ACCESSORIES NOT SHOWN FOR CLARITY.

**TYPICAL SECTION**

PROPOSED ACTIVITY: FACILITY UPGRADES

**SAVANNAH YACHT  
CENTER UPGRADES**

SAVANNAH, GEORGIA

Applicant: SAFE HARBOR

Date: 08-14-25

County: CHATHAM

JOB#: 25-1016

SCALE: N.T.S

DATUM: NAVD88

SHEET: 11 of 11

**GENERAL NOTES:**



**Ball Maritime Group**

4 Cedar View Court | Savannah, GA 31410

www.ballmaritime.com | (912) 662-2914

Copyright © 2024

