

PURPOSE:
REMOVE AND REPLACE
EXISTING FLOATING DOCKS
DATUM: NAVD88
LAT: 32.0806
LONG: -81.0853
COUNTY: CHATHAM
STATE: GA
DATE: 10/02/2025

PROJECT NAME:
SAVANNAH RIVERBOAT CRUISES DOCK REPLACEMENT

LOCATION MAP

PROJECT ADDRESS: 504 E RIVER STREET
SAVANNAH, GA 31401

APPLICATION BY: RIVER STREET MARKET LANDING LLC

Bockhold Engineering



112 Mercer Road
Savannah, Georgia 31411
ph. 251-490-6755

SCALE:
SHEET:

NTS
1

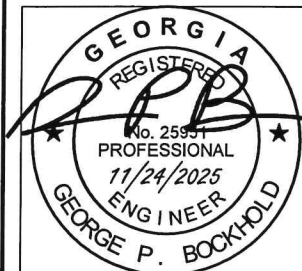
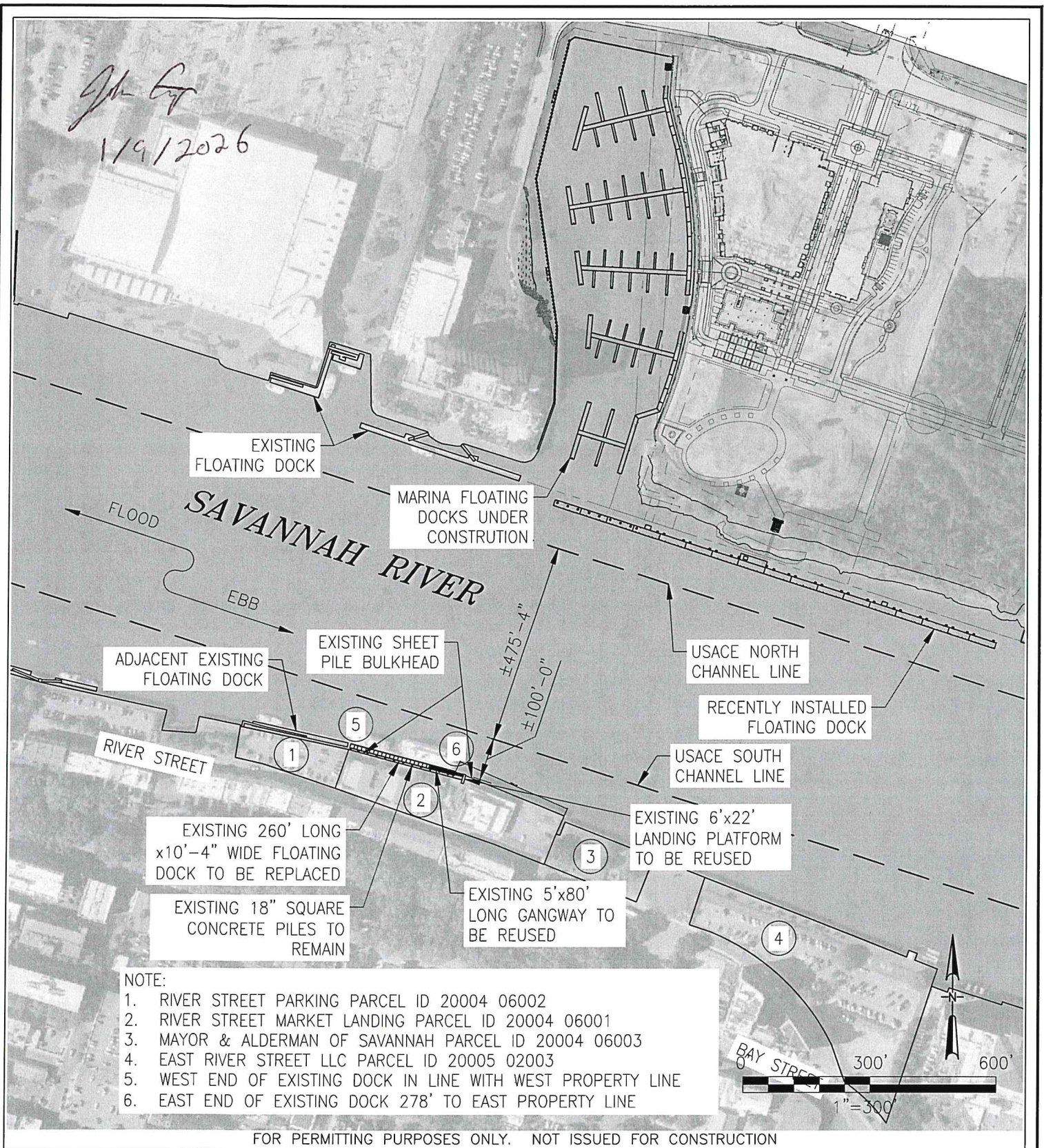

PURPOSE:
REMOVE AND REPLACE
EXISTING FLOATING DOCKS

DATUM: NAVD88

LAT: 32.0806

LONG: -81.0853

COUNTY: CHATHAM

STATE: GA

DATE: 10/02/2025

PROJECT NAME:
SAVANNAH RIVERBOAT CRUISES DOCK REPLACEMENT

EXISTING CONDITIONS

PROJECT ADDRESS: 504 E RIVER STREET
SAVANNAH, GA 31401

APPLICATION BY: RIVER STREET MARKET LANDING LLC

Bockhold Engineering

BE

112 Mercer Road
Savannah, Georgia 31411
ph. 251-490-6755

SCALE: 1"=300'
SHEET: 2

NOTES:

1. PHASE 1 WILL INCLUDE REPLACING THE EXISTING 260'x10'-4" FLOATING DOCKS WITH NEW 260'x16' FLOATING DOCKS, INSTALLING 8 NEW 24"Ø STEEL PIPE PILES, REUSING THE EXISTING 5'x80' GANGWAY AND 6'x22' LANDING PLATFORM, AND INSTALLING (1) NEW 80'x6' GANGWAY AND 6'x20' LANDING PLATFORM.
2. PHASE 2 WILL BE CONSTRUCTED SOMETIME IN THE FUTURE AND WILL INCLUDE INSTALLING NEW 230'x16' FLOATING DOCK, 6 NEW 24"Ø STEEL PIPE PILES, (2) NEW 80'x6' GANGWAYS, (1) 6'x20' LANDING PLATFORM, A 6'x11' PLATFORM EXTENSION, A 12'x15' TRANSITION DOCK, AND A 30'x6' TRANSITION GANGWAY.

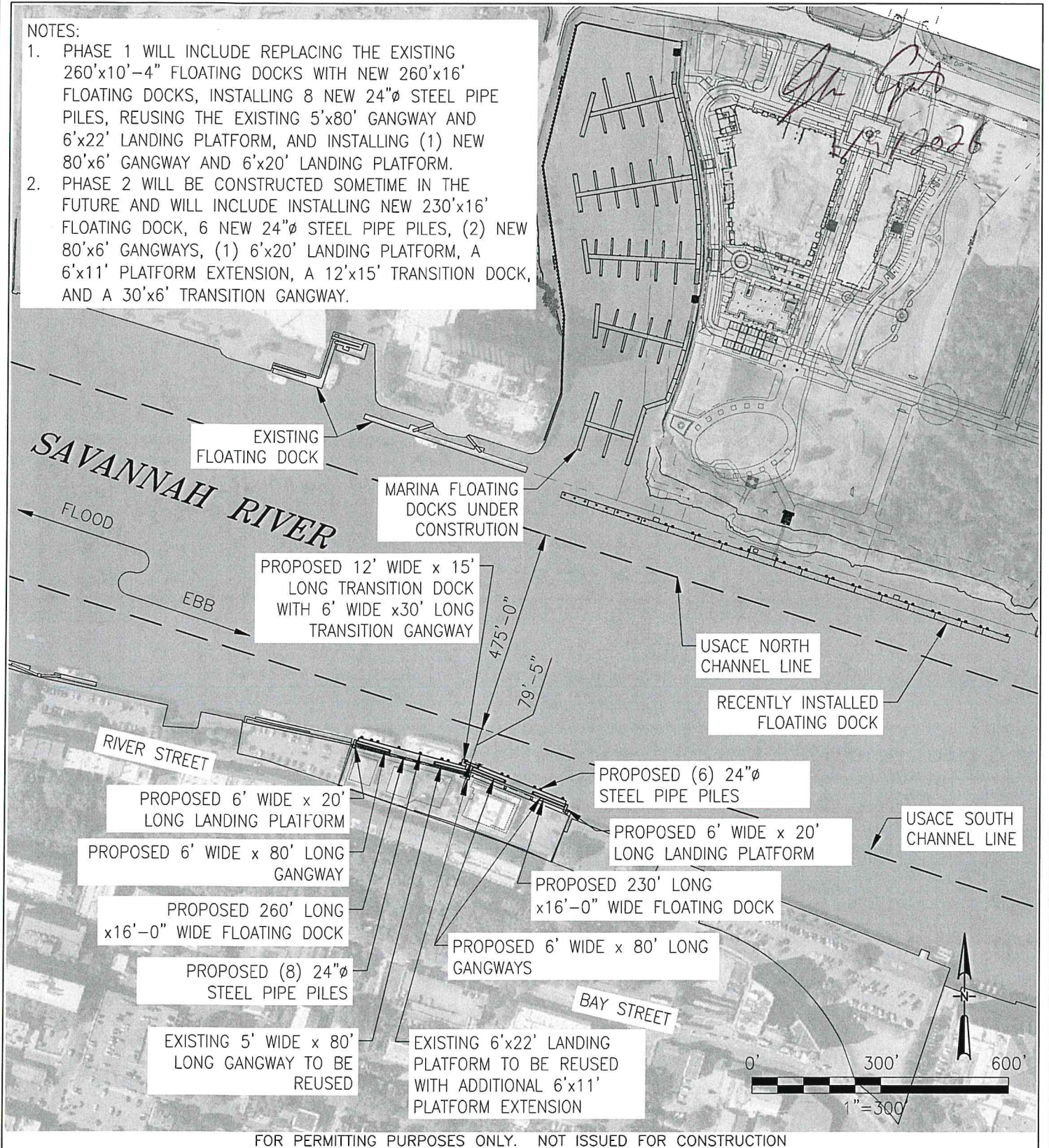

FOR PERMITTING PURPOSES ONLY. NOT ISSUED FOR CONSTRUCTION

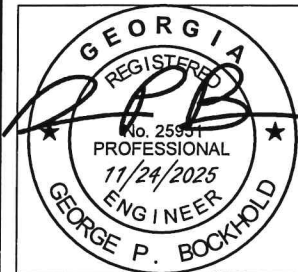

PURPOSE:
REMOVE AND REPLACE
EXISTING FLOATING DOCKS

DATUM: NAVD88

LAT: 32.0806

LONG: -81.0853

COUNTY: CHATHAM

STATE: GA

DATE: 10/02/2025

PROJECT NAME:
SAVANNAH RIVERBOAT CRUISES DOCK REPLACEMENT

PHASE 1 & 2 OVERALL IMPROVEMENTS

PROJECT ADDRESS: 504 E RIVER STREET
SAVANNAH, GA 31401

APPLICATION BY: RIVER STREET MARKET LANDING LLC

Bockhold Engineering

BE

112 Mercer Road
Savannah, Georgia 31411
ph. 251-490-6755

SCALE: 1"=300'

SHEET: 3

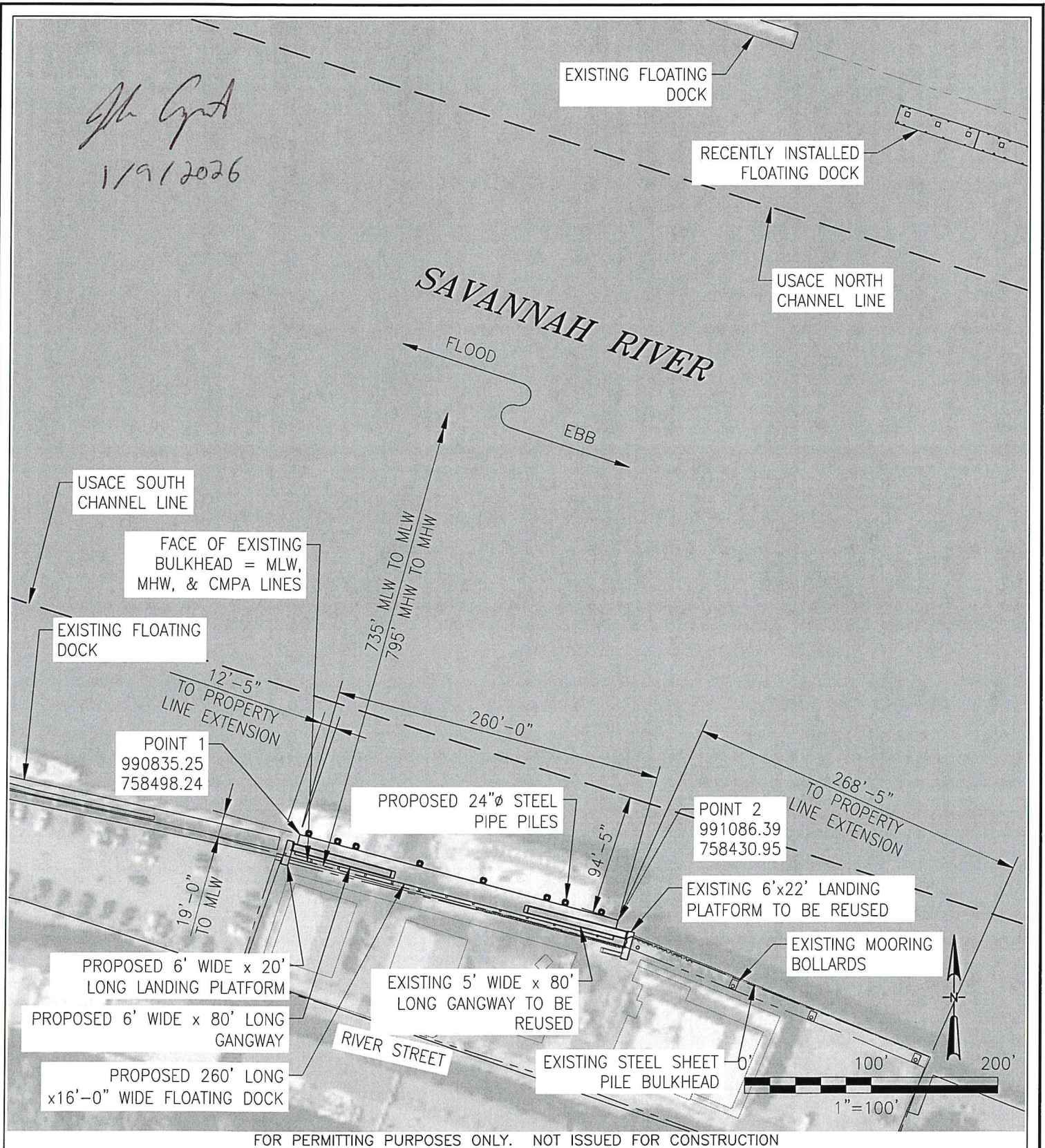

FOR PERMITTING PURPOSES ONLY. NOT ISSUED FOR CONSTRUCTION

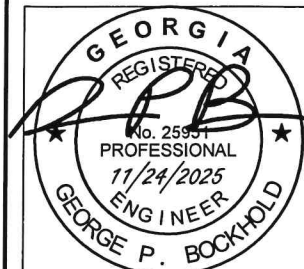

PURPOSE:
REMOVE AND REPLACE
EXISTING FLOATING DOCKS

DATUM: NAVD88

LAT: 32.0806

LONG: -81.0853

COUNTY: CHATHAM

STATE: GA

DATE: 10/02/2025

PROJECT NAME:
SAVANNAH RIVERBOAT CRUISES DOCK REPLACEMENT

PHASE 1 ENLARGED PLAN

PROJECT ADDRESS: 504 E RIVER STREET
SAVANNAH, GA 31401

APPLICATION BY: RIVER STREET MARKET LANDING LLC

Bockhold Engineering

BE

112 Mercer Road
Savannah, Georgia 31411
ph. 251-490-6755

SCALE: 1"=100'
SHEET: 4

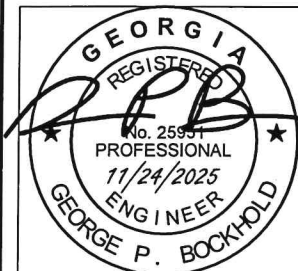
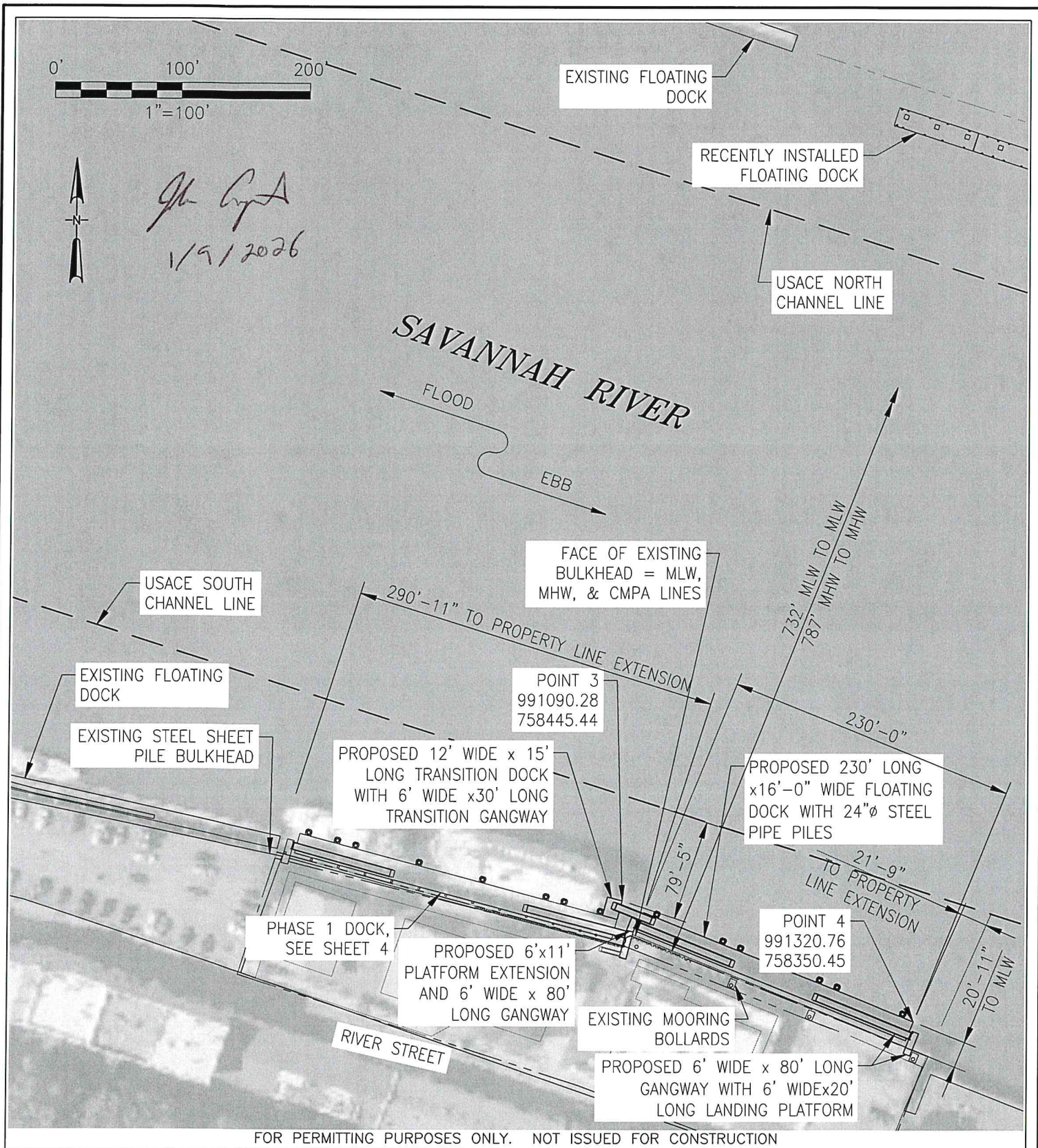

PURPOSE:
REMOVE AND REPLACE
EXISTING FLOATING DOCKS

DATUM: NAVD88

LAT: 32.0806

LONG: -81.0853

COUNTY: CHATHAM

STATE: GA

DATE: 10/02/2025

PROJECT NAME:
SAVANNAH RIVERBOAT CRUISES DOCK REPLACEMENT

PHASE 2 ENLARGED PLAN

PROJECT ADDRESS: 504 E RIVER STREET
SAVANNAH, GA 31401

APPLICATION BY: RIVER STREET MARKET LANDING LLC

Bockhold Engineering

BE

112 Mercer Road
Savannah, Georgia 31411
ph. 251-490-6755

SCALE: 1"=100'
SHEET: 5

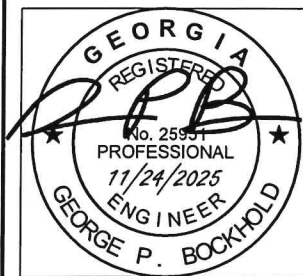
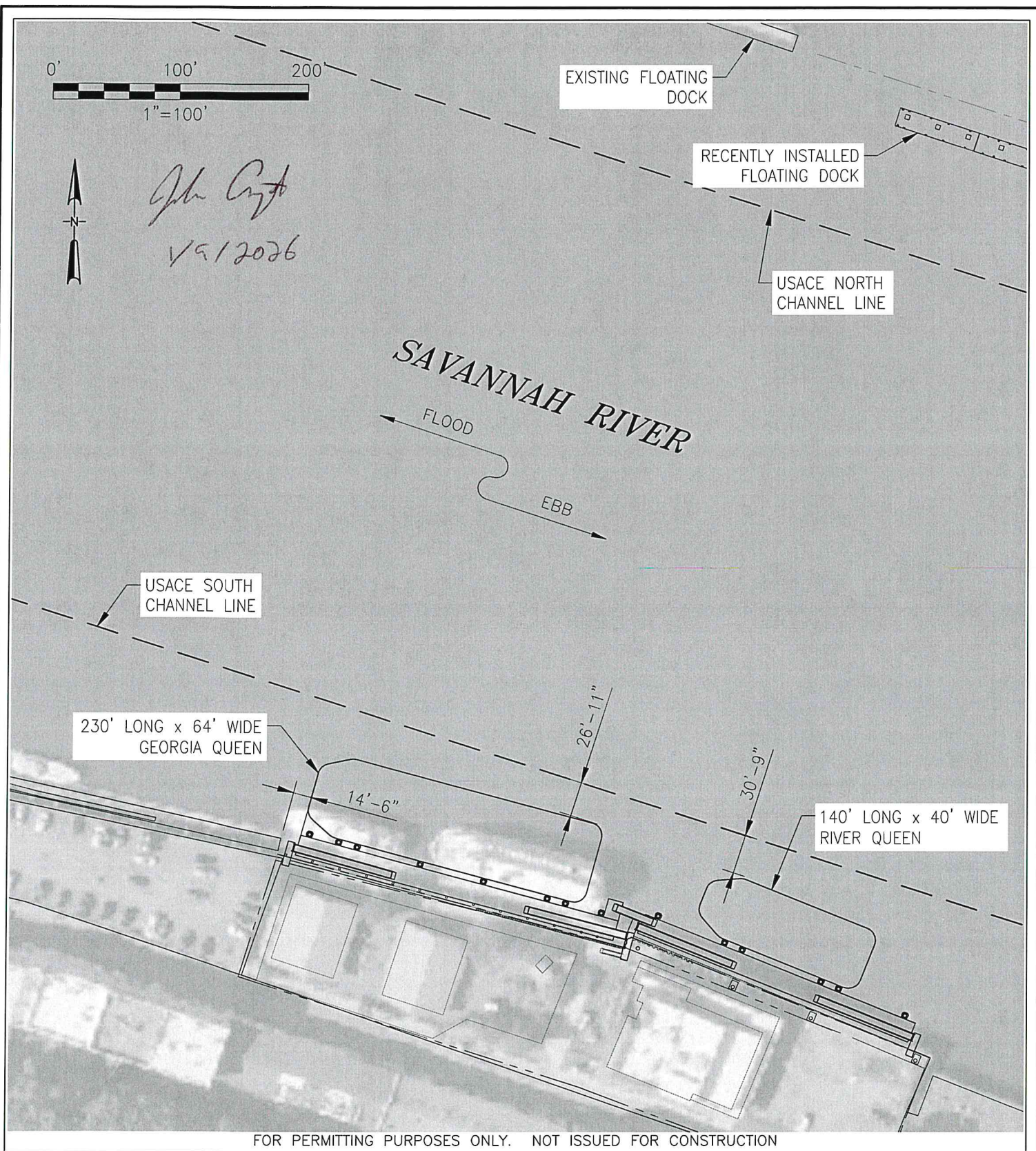

PURPOSE:
REMOVE AND REPLACE
EXISTING FLOATING DOCKS
DATUM: NAVD88
LAT: 32.0806
LONG: -81.0853
COUNTY: CHATHAM
STATE: GA
DATE: 10/02/2025

PROJECT NAME:
SAVANNAH RIVERBOAT CRUISES DOCK REPLACEMENT
VESSEL OFFSET
PROJECT ADDRESS: 504 E RIVER STREET
SAVANNAH, GA 31401
APPLICATION BY: RIVER STREET MARKET LANDING LLC

Bockhold Engineering
BE
112 Mercer Road
Savannah, Georgia 31411
ph. 251-490-6755
SCALE: 1"=100'
SHEET: 6

GP
1/9/2026

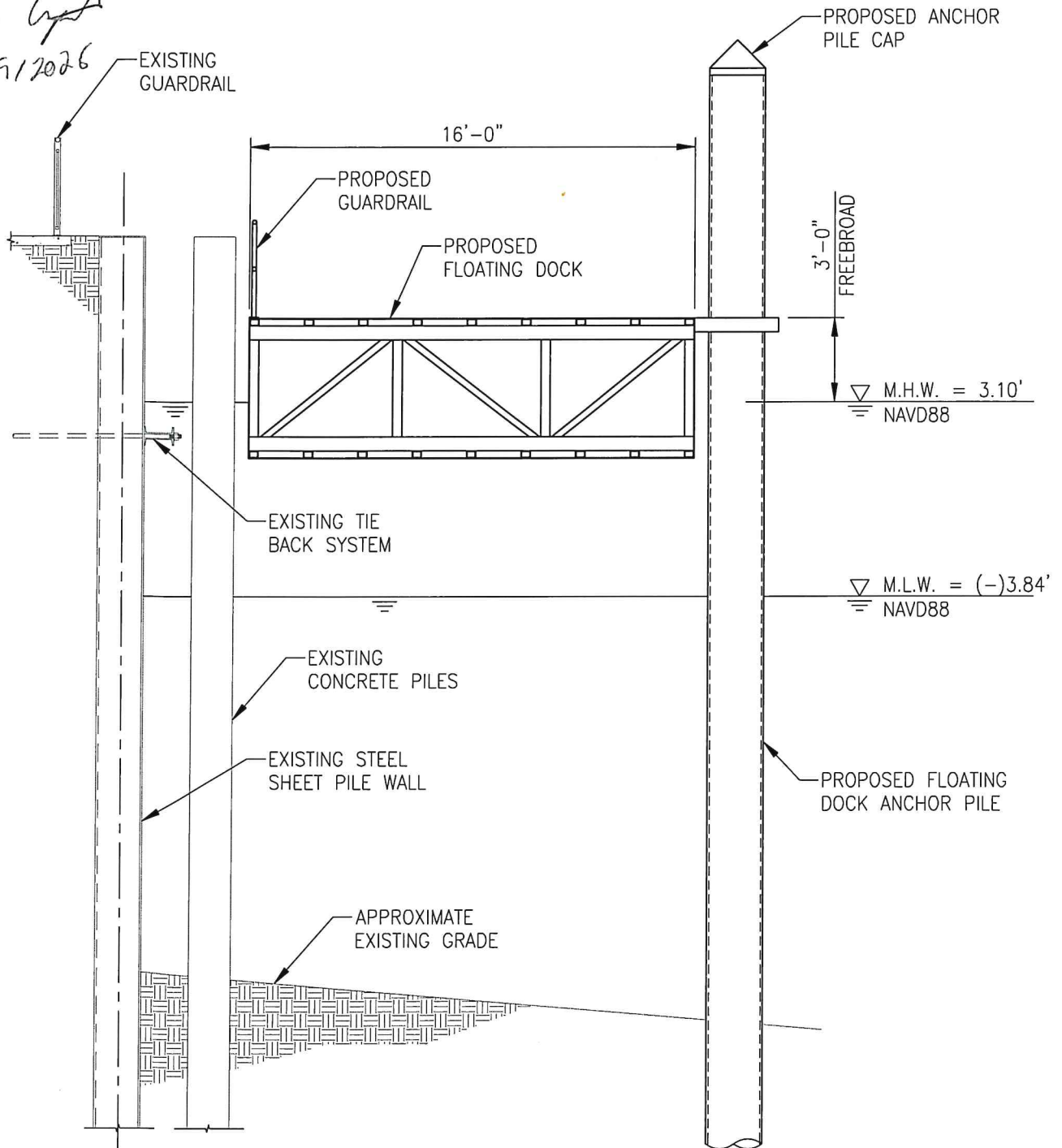

TYPICAL SECTION

SCALE 3/16" = 1'-0"

FOR PERMITTING PURPOSES ONLY. NOT ISSUED FOR CONSTRUCTION

PURPOSE:
REMOVE AND REPLACE
EXISTING FLOATING DOCKS
DATUM: NAVD88
LAT: 32.0806
LONG: -81.0853
COUNTY: CHATHAM
STATE: GA
DATE: 10/02/2025

PROJECT NAME:
SAVANNAH RIVERBOAT CRUISES DOCK REPLACEMENT

TYPICAL SECTION

PROJECT ADDRESS: 504 E RIVER STREET
SAVANNAH, GA 31401

APPLICATION BY: RIVER STREET MARKET LANDING LLC

Bockhold Engineering

BE

112 Mercer Road
Savannah, Georgia 31411
ph. 251-490-6755

SCALE: AS SHOWN
SHEET: 7

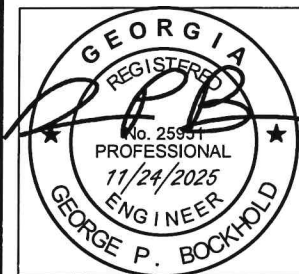

1/9/2026

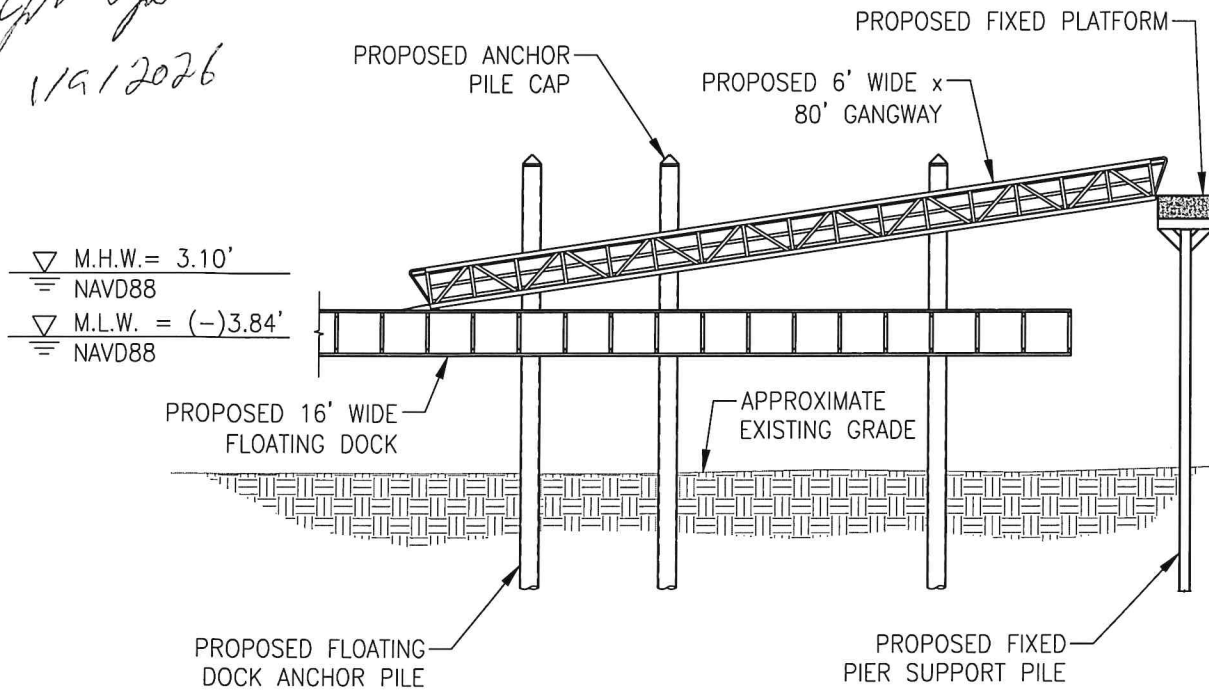

TYPICAL ELEVATION

SCALE 1" = 20'-0"

FOR PERMITTING PURPOSES ONLY. NOT ISSUED FOR CONSTRUCTION

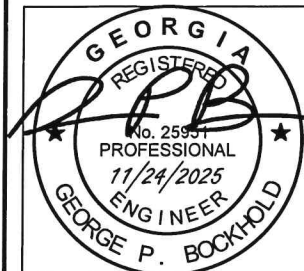

PURPOSE:
REMOVE AND REPLACE
EXISTING FLOATING DOCKS
DATUM: NAVD88
LAT: 32.0806
LONG: -81.0853
COUNTY: CHATHAM
STATE: GA
DATE: 10/02/2025

PROJECT NAME:
SAVANNAH RIVERBOAT CRUISES DOCK REPLACEMENT

VESSEL OFFSET

PROJECT ADDRESS: 504 E RIVER STREET
SAVANNAH, GA 31401
APPLICATION BY: RIVER STREET MARKET LANDING LLC

Bockhold Engineering



112 Mercer Road
Savannah, Georgia 31411
ph. 251-490-6755

SCALE: 1"=20'
SHEET: 8