



COASTAL RESOURCES DIVISION
ONE CONSERVATION WAY • BRUNSWICK, GA 31520 • 912.264.7218
COASTALGADNR.ORG

JAN 03 2019
MARK WILLIAMS
COMMISSIONER

DOUG HAYMANS
DIRECTOR

Alan K. & Kimberly C. Worthley
524 Marsh Circle Street
St. Simons Island, Georgia 31522

Re: Letter of Permission (LOP) for Maintenance of a Bridge and Platform on a Marsh Hammock, 524 Marsh Circle Street, Glynn County, Georgia. (GPS: 31.17965°N/81.38610°W)

Dear Mr. & Ms. Worthley:

This Letter of Permission (LOP) is in response to your request dated October 15, 2018 for maintenance of a bridge to a marsh hammock and an upland platform located on a hammock. The project consists of general maintenance to the bridge and platform. The project will begin no sooner than fifteen (15) days from the receipt of this letter and be completed no later than six (6) months after the date of this letter.

The existing structure consists of a 366ft. x 6ft. bridge extending from the mainland to a 24ft. x 24ft. fixed deck on an upland hammock. Approximately 331ft. of the bridge is constructed over jurisdictional marshlands. Any modification to the structure or deviation from its current footprint will require a Coastal Marshlands Protection Act (CMPA) Permit.

The Department authorizes the maintenance of the bridge and platform in their current footprint as depicted in the attached description and drawings. All Best Management Practices (BMPs) should be used to prevent any erosion and sedimentation at the site and to protect coastal marshlands. No unauthorized equipment, materials, or debris may be placed in, disposed of, or stored in jurisdictional areas. All material removed must be disposed of at an appropriate upland disposal area. Any visible alterations in marsh topography will be restored immediately using low-impact hand tools. Any damage to the marsh vegetation that has not recovered naturally during the next growing season will be repaired by a method acceptable to the Department.

This authorization does not relieve you from obtaining any other required federal, state, or local permits. Tidal water bottoms and marshlands of coastal Georgia are public trust lands controlled by the State, except for such lands where a validated Crown Grant or State Grant exists. Please contact Sam LaBarba at (912) 264-7218 should you require more information.

Sincerely,

Jill Andrews
Chief, Coastal Management Section

Enclosures: Revocable License (Attachment A), Approved Plan (Attachment B)
Cc: Glynn County Building Inspector
File #: LOP20180199

REVOCABLE LICENSE REQUEST FOR THE USE OF TIDAL WATERBOTTOMS

DEC 11 2018

APPLICANTS NAME(S): Alan K. Worthley, Kimberly C. Worthley GA DNR

MAILING ADDRESS: 524 Marsh Circle St. Simons Is. GA 31522
(Street) (City) (State) (Zip)

PROJECT ADDRESS/LOCATION: Same

COUNTY: Chynn WATERWAY: N/A DATE: Oct. 15, 2018

LOT, BLOCK & SUBDIVISION NAME FROM DEED: Lot 6-B, The Marshes

Georgia Department of Natural Resources
Coastal Resources Division
One Conservation Way
Brunswick, Georgia 31520-8687

I am requesting that I be granted a revocable license from the State of Georgia to encroach on the beds of tidewaters, which are state owned property. Attached hereto and made a part of this request is a copy of the plans and description of the project that will be the subject of such a license. I certify that all information submitted is true and correct to the best of my knowledge and understand that willful misrepresentation or falsification is punishable by law.

I understand that if permission from the State is granted, it will be a revocable license and will not constitute a license coupled with an interest. I acknowledge that this revocable license does not resolve any actual or potential disputes regarding the ownership of, or rights in, or over the property upon which the subject project is proposed, and shall not be construed as recognizing or denying any such rights or interests. I acknowledge that such a license would relate only to the property interests of the State and would not obviate the necessity of obtaining any other State license, permit or authorization required by State law. I recognize that I waive my right of expectation of privacy and I do not have the permission of the State of Georgia to proceed with such project until the Commissioner of DNR or his/her designee has signed a copy of this request.

Sincerely,

By: Alan K. Worthley
(Applicant), title if applicable

By: Kimberly C. Worthley
(Applicant), title if applicable

The State of Georgia hereby grants you a revocable license not coupled with an interest as provided in your request. This area may now or in the future be utilized by boats employing power drawn nets under the provisions for commercial or sport bait shrimping. In its occupancy and use of the premises, licensee shall not discriminate against any person on the basis of race, gender, color, national origin, religion, age, or disability. This covenant by licensee may be enforced by termination of this license, by injunction, and by any other remedy available at law to the Department. The project proposed for this license must be constructed and completed within the specified timeframe associated with the authorization and/or transmittal letter associated with this revocable license and must be maintained in serviceable condition. Otherwise, action will be initiated to revoke this license and all structures must be removed immediately at the licensee's expense.

STATE OF GEORGIA
Office of the Governor

By: [Signature]
For: Mark Williams, Commissioner-DNR

Date: JAN 03 2019

RECEIVED

DEC 11 2018

GA DNR

TO: Georgia Department of Natural Resources
Coastal Resources Division
Josh Noble
Cindy Ridley

From: Alan Worthley
524 Marsh Circle
St Simons Is, GA 31522

Date: October 15, 2018

Josh & Cindy,

Per your direction, I am requesting a permit for an existing dock at my residence of 524 Marsh Circle, St Simons Island, GA. The previous owners constructed a walkway to a Marsh Hammock from the backyard of the residence in the early 1980's. The property consists of 33 acres by deed, the majority of this acreage being marsh. The walkway is approximately 365' long by 6' wide with a 24' by 24' deck that ends on a 130' by 150' hammock. The dock and the deck are constructed of marine grade 2x10 decking, 3x8 stringers, 2x6 mud slips, and 12" pilings. The structure is in good shape and used regularly. The hammock is covered in old growth trees consisting of Cedar, Oak, Palms, and Pine trees. There is a host of wildlife that thrives on this property to include; Deer, Raccoon, Owls, Opossum, Armadillo, Otter, and many species of birds. This hammock was the staging area when Georgia Power replaced the power poles, in the marsh, during the G-8 summit.

I would welcome a site review at your early convenience.
Thank You,

Alan Worthley

RECEIVED

DEC 11 2018

GA DNR

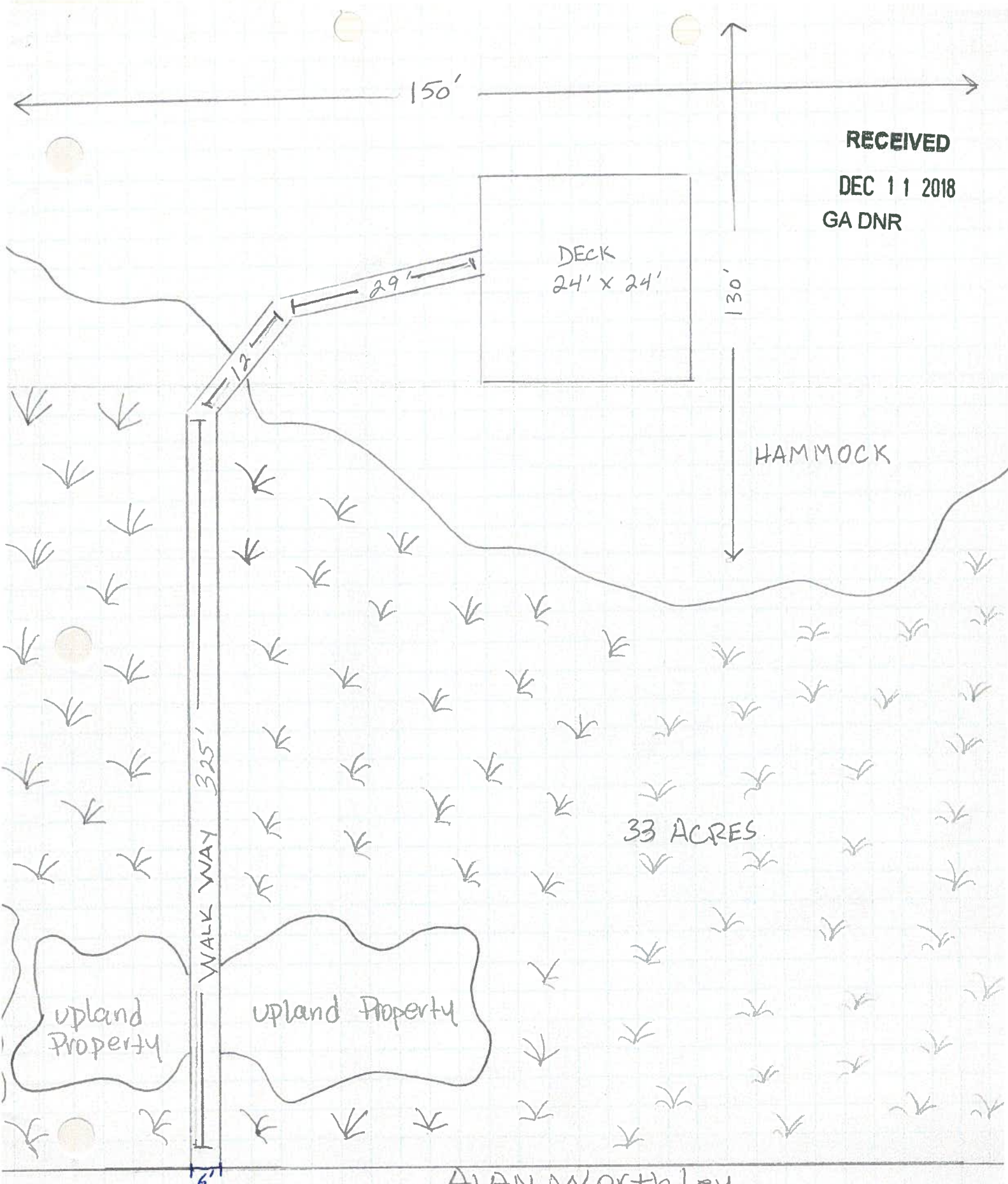

upland Property

ALAN WORTH LEY
524 Marsh Circle
St. Simons Island GA 31522