

THE SURVEY WAS PROVIDED BY SHUPE SURVEYING TITLED "A PORTION OF SOUTH BRUNSWICK RIVER" DATED 4/14/2023.

STRUCTURE	SIZE	TOTAL (SF)
WALKWAY	690' X 4'-4"	2,990
FIXED DECK	20' X 20'	400
GANGWAY	5' X 30'	150
GANGWAY LANDING	8' X 8'	64
FLOATING DOCK	10' X 398'	3,980
TOTAL		7,584

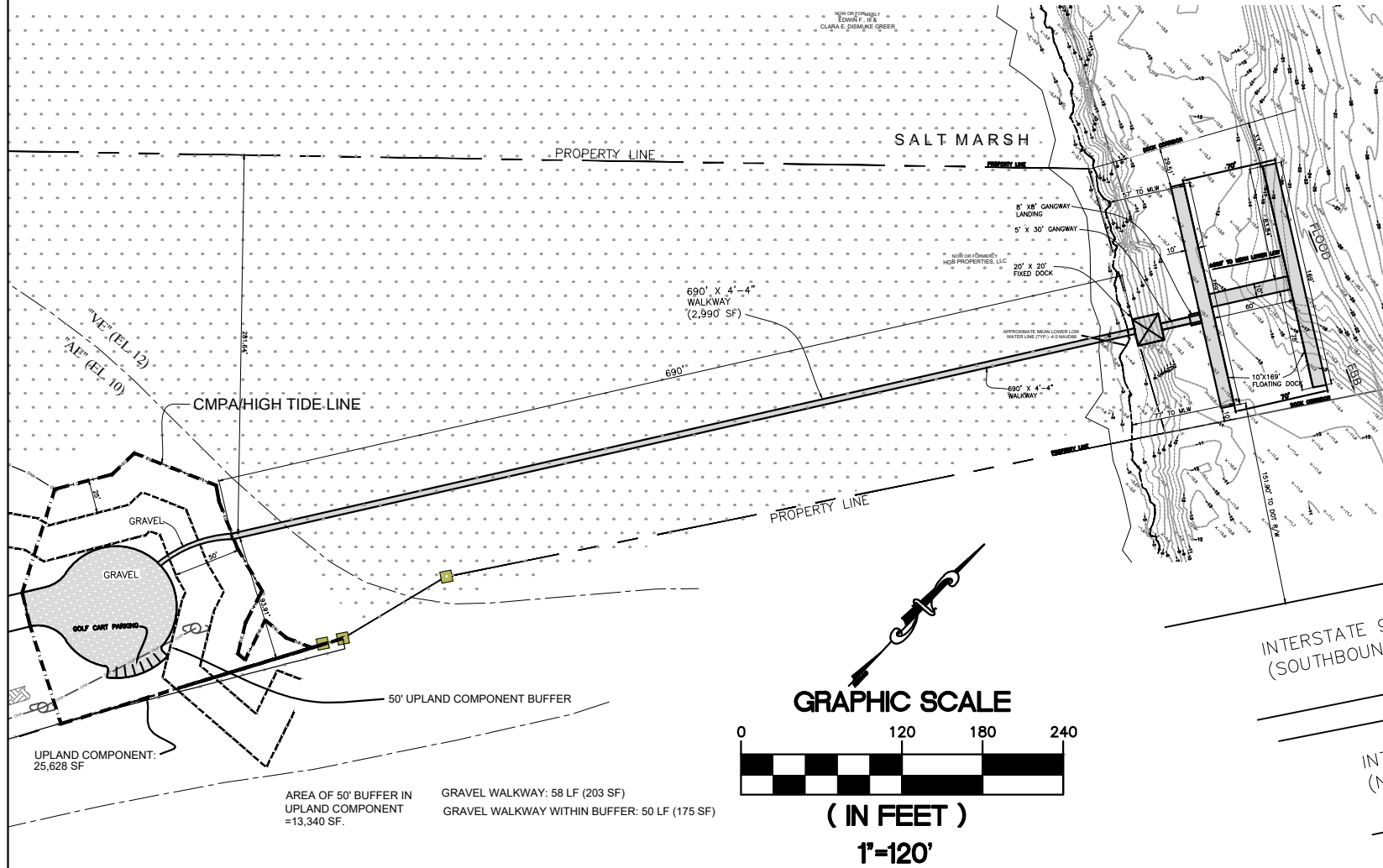

UPLAND COMPONENT:
25,628 SF

AREA OF 50' BUFFER IN
UPLAND COMPONENT
=13,340 SF.

GRAVEL WALKWAY: 58 LF (203 SF)
GRAVEL WALKWAY WITHIN BUFFER: 50 LF (175 SF)

RIVER DOCK HOMES
HIGHWAY 303
BRUNSWICK, GLYNN COUNTY, GA

PREPARED BY:
TIDEWATER ENGINEERING, INC.
200 Plantation Chase
St. Simons Island, GA 31522
PH. (912) 266-2164 EMAIL: info@tidewatereng.com

SALT MARSH

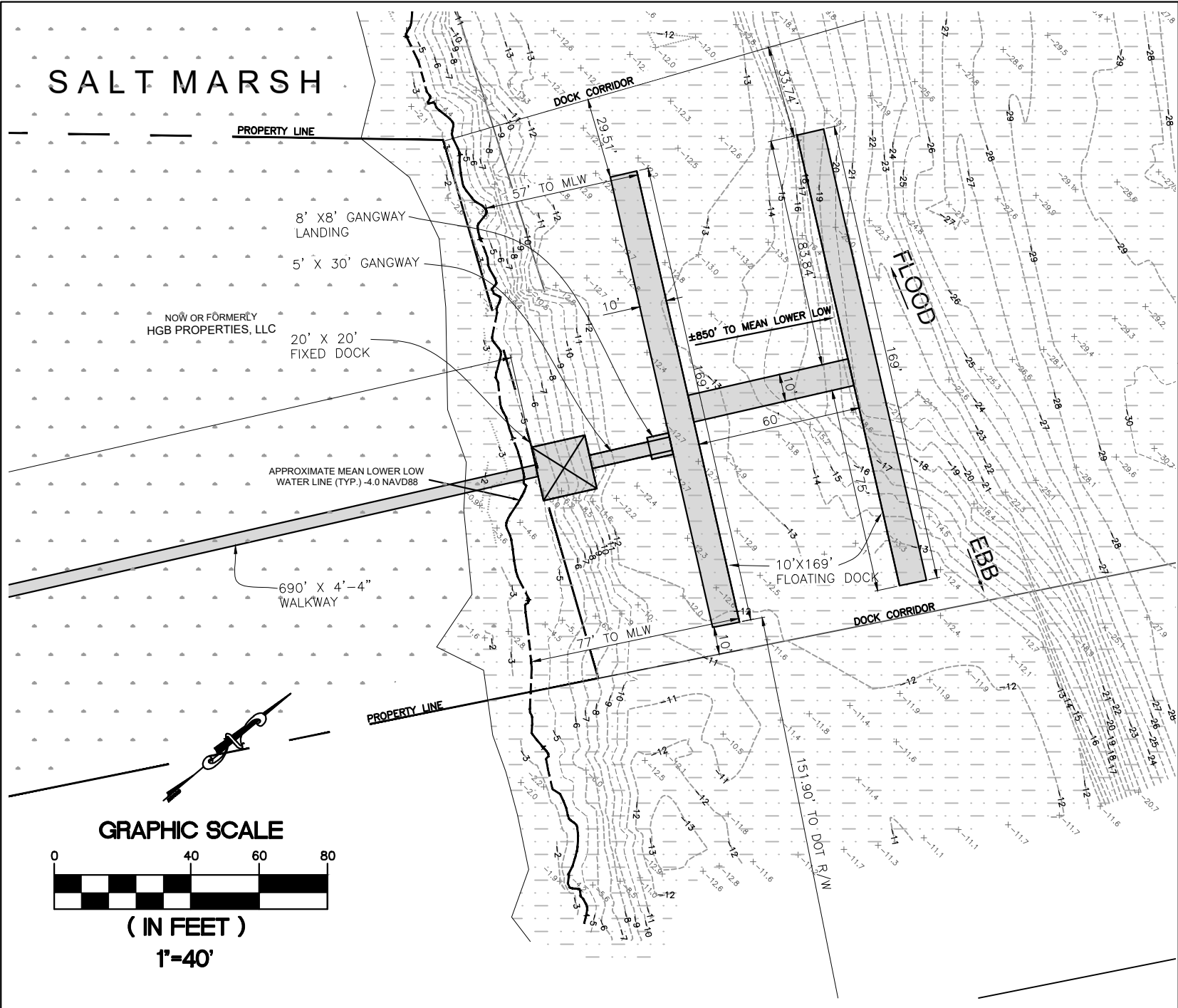

PREPARED BY:

TIDEWATER ENGINEERING, INC.
 200 Plantation Chase
 St. Simons Island, GA 31522
 PH. (912) 268-2164 EMAIL: info@tidewatereng.com

RIVER DOCK HOMES

HIGHWAY 303
 BRUNSWICK, GLYNN COUNTY, GA

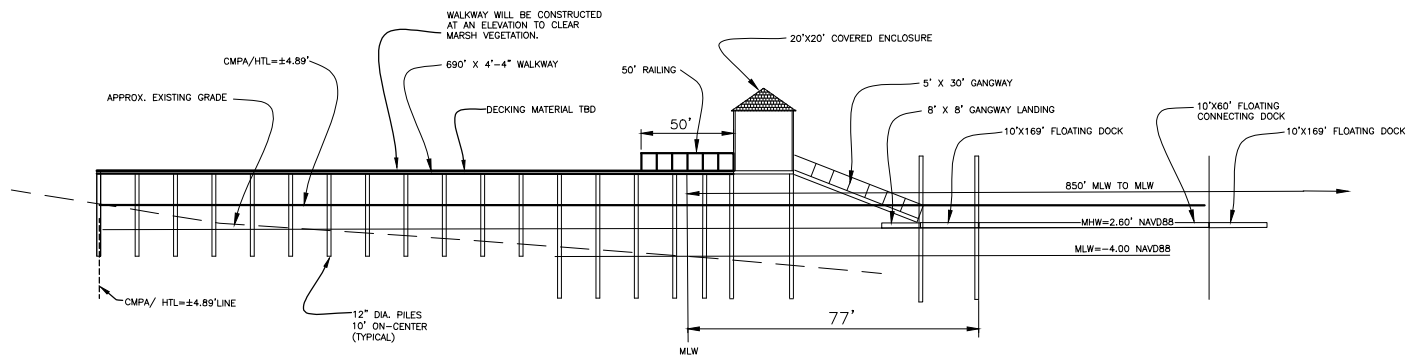

THIS DRAWING IS FOR PERMITTING PURPOSES ONLY AND NOT FOR CONSTRUCTION.

NOT TO SCALE

RIVER DOCK HOMES

HIGHWAY 303
BRUNSWICK, GLYNN COUNTY, GA

PREPARED BY:

TIDEWATER ENGINEERING, INC.
200 Plantation Chase
St. Simons Island, GA 31522
PH. (912) 268-2164 EMAIL: info@tidewatereng.com

SHEET
3 of 3