



NOT RELEASED FOR CONSTRUCTION

**EXISTING DOCK**

FIXED DECK AREA: 1,757 SF  
(995 SF TO BE REMOVED)

BUILDING: 1,270 SF

BULKHEAD: 252 SF

TOTAL EXISTING STRUCTURES: 3,279 SF

EXISTING DOCK

**COASTAL PERMITTING SERVICE**

**SAVANNAH, GA**

PREPARED FOR:  
RIVERS EDGE COMMUNITY DOCK COMMON AREA

DATE: 07/28/2023

SCALE: 1"=30' (FOR 11"x17" PLOT)

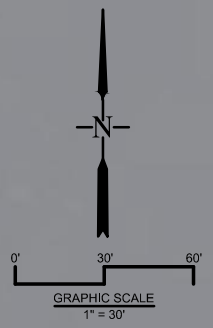

1

SHEET:

c:\office\roberts\civil\engineering\deskplottings\seaford\dock\seaford\_dock.dwg, plotted 7/31/2023 3:42 PM by djm/budnick

NOT RELEASED  
FOR  
CONSTRUCTION

**PROPOSED DOCK**

FIXED DECK AREA: 895 SF  
BUILDING: 1,270 SF  
BULKHEAD: 252 SF  
GANGWAY: 330 SF  
FLOATING DOCK: 1,325 SF  
MLW - MLW: 1,313'  
MHW - MHW: 1,358'  
EXTENT PAST MLW: 76.1'  
EXTENT PAST MHW: 96.1'  
RIGHT DOCK: 176.5'  
LEFT DOCK: 105.2'

PROPOSED STRUCTURES

COASTAL PERMITTING SERVICE  
SAVANNAH, GA

PREPARED FOR:  
RIVERS EDGE COMMUNITY DOCK COMMON AREA

DATE: 07/28/2023

SCALE: 1"=30' (FOR 11"x17" PLOT)

2

SHEET:

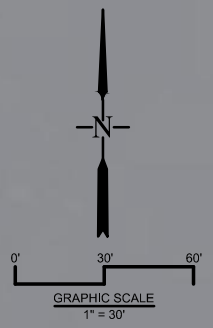
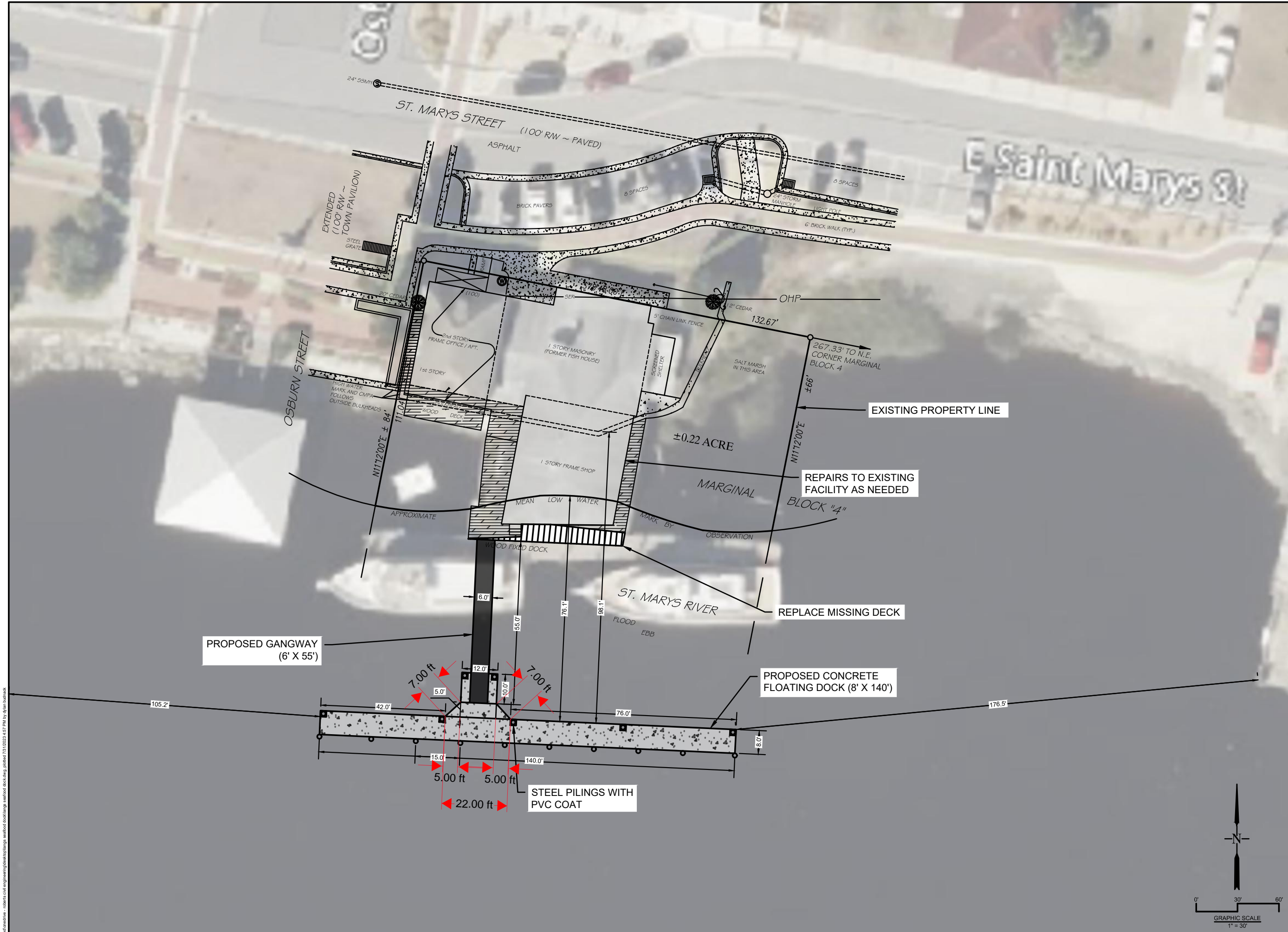

cc:\office\roberts\civil\engineering\design\planning\seaboard\dock\planning\seaboard dock.dwg, plotted 7/31/2023 4:47 PM by djm\hudson

NOTES:

1. MHW AND MLW OBTAINED FROM NOAA STATION 8679964.

NOT RELEASED  
FOR  
CONSTRUCTION

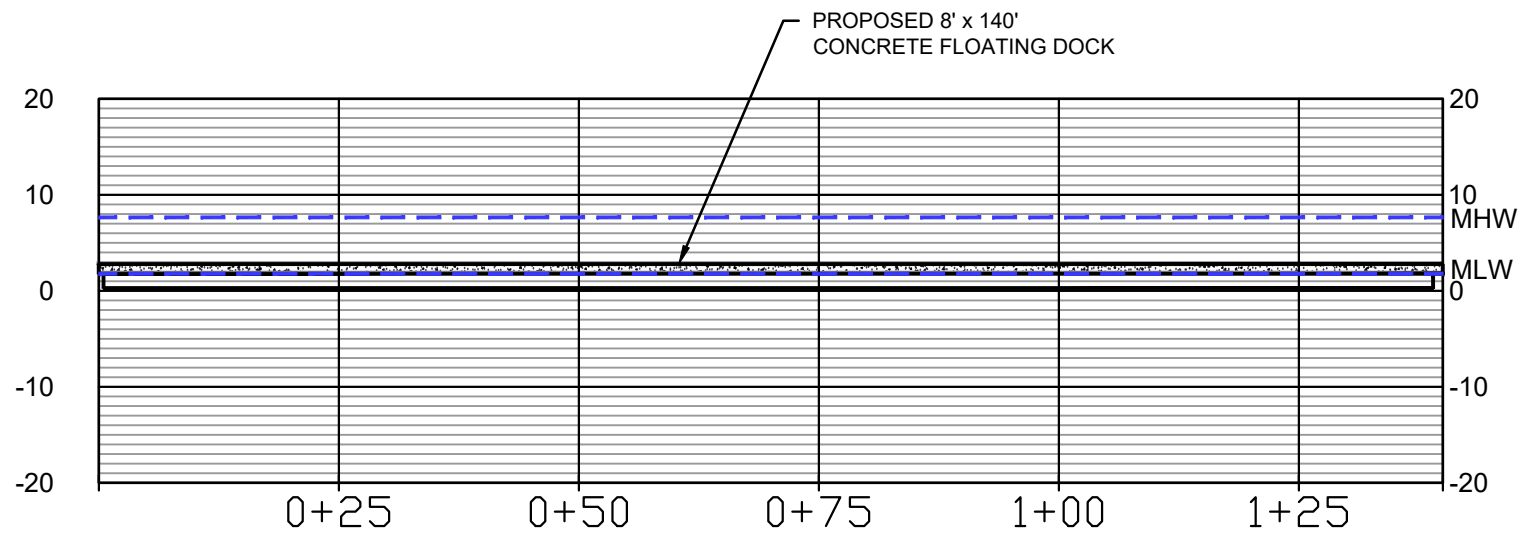
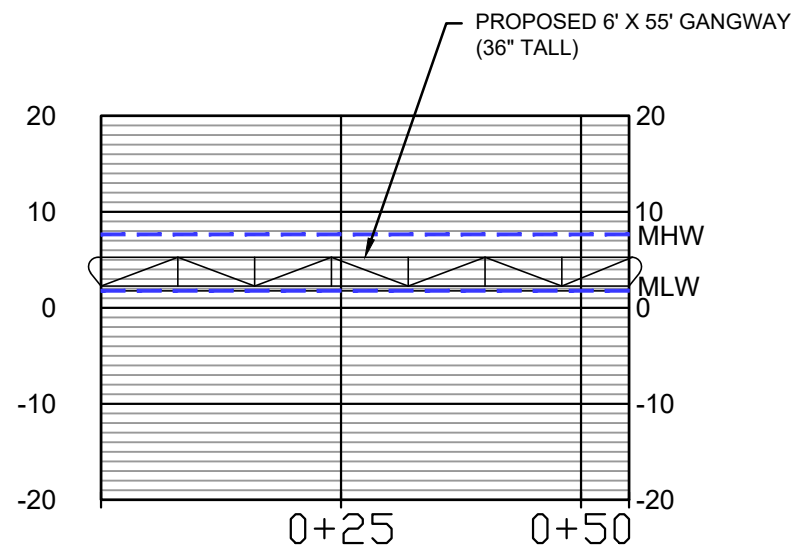

GANGWAY 0+55.00  
Vertical Scale: 1" = 20 FT  
Horizontal Scale: 1" = 20 FT

CONCRETE FLOATING DOCK 1+40.00  
Vertical Scale: 1" = 20 FT  
Horizontal Scale: 1" = 20 FT

PROFILES

COASTAL PERMITTING SERVICE  
SAVANNAH, GA  
PREPARED FOR:  
RIVERS EDGE COMMUNITY DOCK COMMON AREA

DATE: 06/06/2023  
SCALE: 1":20' (FOR 11"x17" PLOT)

3

SHEET:

c:\office\roberts\civil\engineering\deskplottings\seaford dock\lange\_seaford dock.dwg, plotted 7/11/2023 4:48 PM by dylan.burrows