

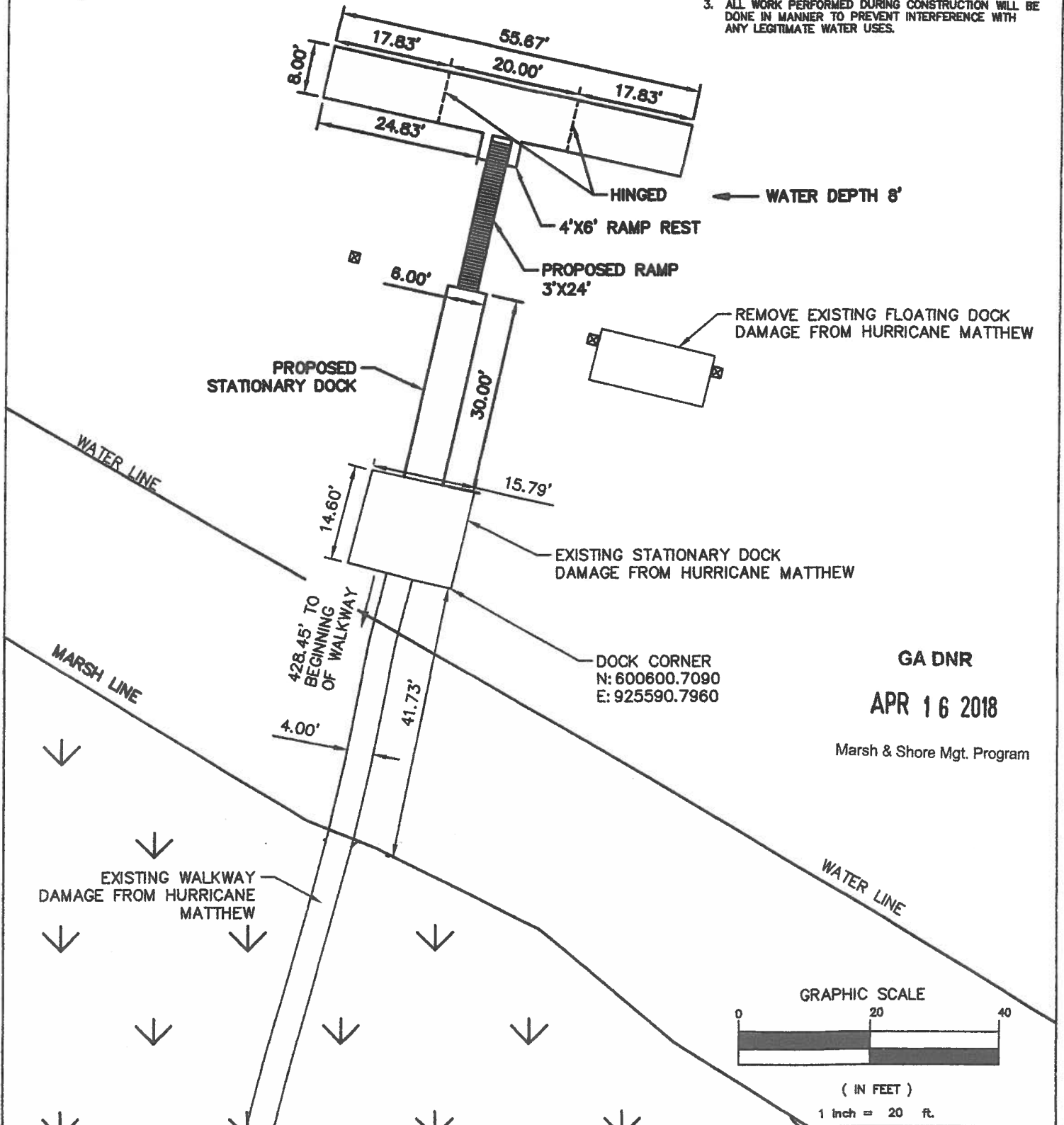

NOTE:

1. ALL ACTIVITIES WILL BE PERFORMED IN A MANNER TO MINIMIZE TURBIDITY IN THE STREAM.
2. THERE WILL BE NO OILS OR OTHER POLLUTANTS RELEASED FROM THE PROPOSED ACTIVITIES WHICH WILL REACH THE STREAM.
3. ALL WORK PERFORMED DURING CONSTRUCTION WILL BE DONE IN MANNER TO PREVENT INTERFERENCE WITH ANY LEGITIMATE WATER USES.



GA DNR

APR 16 2018

Marsh & Shore Mgt. Program

T. R. Long Engineering, P.C.
 114 North Commerce Street
 Hinesville, Georgia 31313
 (912) 368-5664
 (912) 368-7206 Fax

**Dock Improvements
 for
 Belvedere Island**

Sheet Name: Proposed Conditions
 Sheet Number: C-06
 Initial Date: 11/10/2017
 Revision Date: 3/22/2018
 Drawn By: RAD
 Project Number: 2017-140

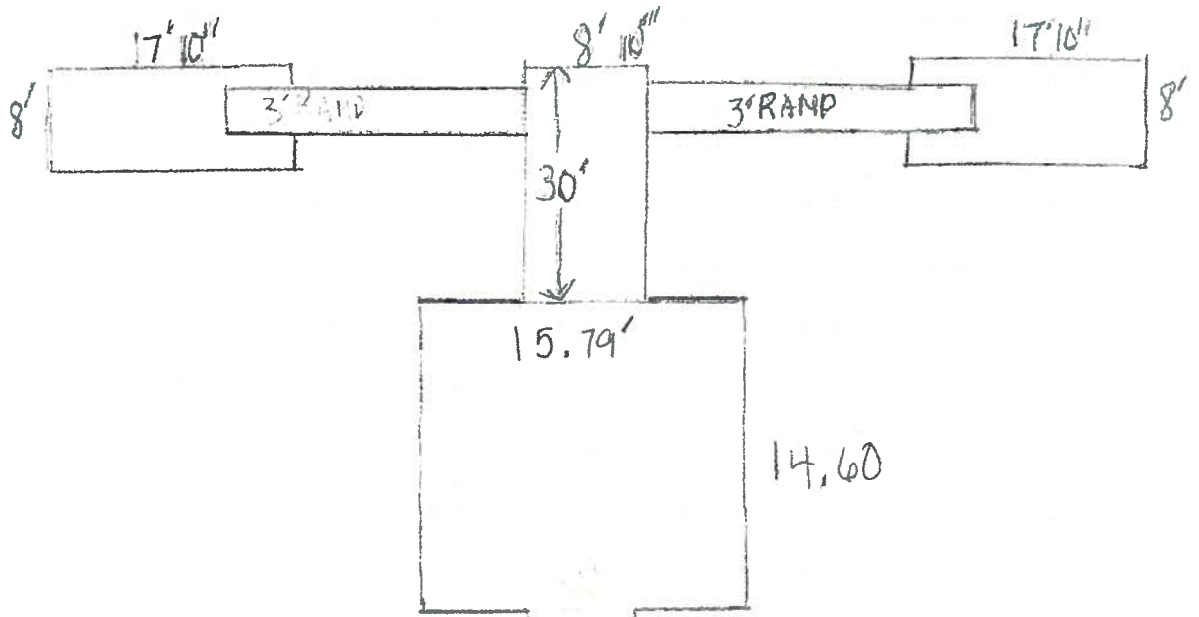

GA DNR
APR 16 2018
Marsh & Shore Mgt. Program

428.45'

PRE-HURRICANE

55 3/4"
#5

APR 16 2018

Marsh & Shore Mgt. Program

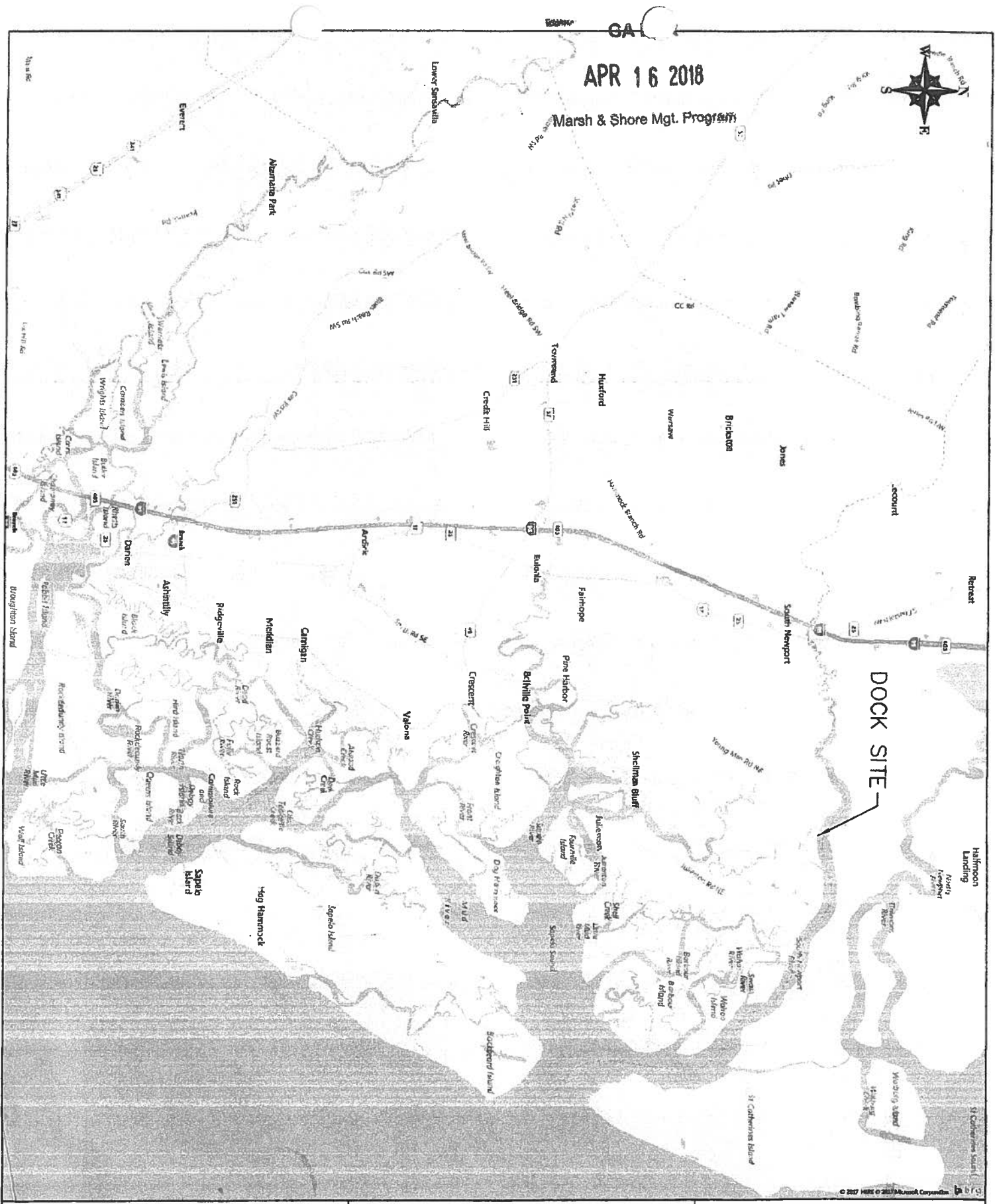

© 2017 H&E © 2013 M&S Corporation

T. R. Long Engineering, P.C.
114 North Commerce Street
Hinesville, Georgia 31313
(912) 368-5664
(912) 368-7206 Fax

Dock Improvements
for
Belvedere Island

Sheet Name: County Level Vicinity Map
Sheet Number: C-01
Initial Date: 11/10/2017
Drawn By: RAD
Project Number: 2017-140



GA DNR

APR 16 2018

Marsh & Shore Mgt. Program

DOCK SITE

SOUTH NEWPORT RIVER

HARRIS NECK RD

RIVER RD

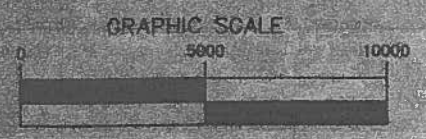

(IN FEET)

1 inch = 5000 ft.

T. R. Long Engineering, P.C.
114 North Commerce Street
Hinesville, Georgia 31313
(912) 368-5664
(912) 368-7206 Fax

**Dock Improvements
for
Belvedere Island**

Sheet Name: Vicinity Map
Sheet Number: C-02
Initial Date: 11/10/2017
Drawn By: RAD
Project Number: 2017-140



GA DNR

APR 16 2018

Marsh & Shore Mgt. Program

SOUTH NEWPORT RIVER

LIBERTY COUNTY
MCINTOSH COUNTY

DOCK SITE

BELVEDERE DRIVE

FAIR HOPE DRIVE

GRAPHIC SCALE



(IN FEET)

1 inch = 500 ft

T. R. Long Engineering, P.C.
114 North Commerce Street
Hinesville, Georgia 31313
(912) 368-5664
(912) 368-7206 Fax

**Dock Improvements
for
Belvedere Island**

Sheet Name: Vicinity Map Enlarged
Sheet Number: C-03
Initial Date: 11/10/2017
Drawn By: RAD
Project Number: 2017-140

APR 16 2018

Marsh & Shore Mgt. Program



SOUTH NEWPORT RIVER

EXISTING POST
DAMAGED FROM
HURRICANE MATTHEW

EXISTING FLOATING DOCK
DAMAGED FROM HURRICANE MATTHEW

EXISTING STATIONARY DOCK
DAMAGED FROM HURRICANE MATTHEW

WATER LINE
MARSH LINE

N/F US DEPT OF INTERIOR
WOLF ISLAND NATIONAL PARK
TAX # 0082 0004001

RBF
N: 600189.2990
E: 925471.8340

RBF

RBF D

OTF

OTF

ACCESS TO DOCK

N/F ANN HOFF &
ANN & ROHN MUGFORD
TAX # 0081A0002

N/F SARA C. CAMACHO
TAX # 0081A0003

N/F NATHANIEL C. MERRITT
TAX # 0081A 0004

N/F LORRAINE H. GOFF TRUSTEE
TAX # 0081A 0005

BELVEDERE DRIVE
(60' R/W)

RBF
N: 599845.6950
E: 925386.1820

FAIR HOPE DRIVE
(60' R/W)

GRAPHIC SCALE



(IN FEET)

1 inch = 150 ft.

T. R. Long Engineering, P.C.
114 North Commerce Street
Hinesville, Georgia 31313
(912) 368-5664
(912) 368-7206 Fax

Dock Improvements
for
Belvedere Island

Sheet Name: Existing Conditions
Sheet Number: C-04
Initial Date: 11/10/2017
Drawn By: RAD
Project Number: 2017-140

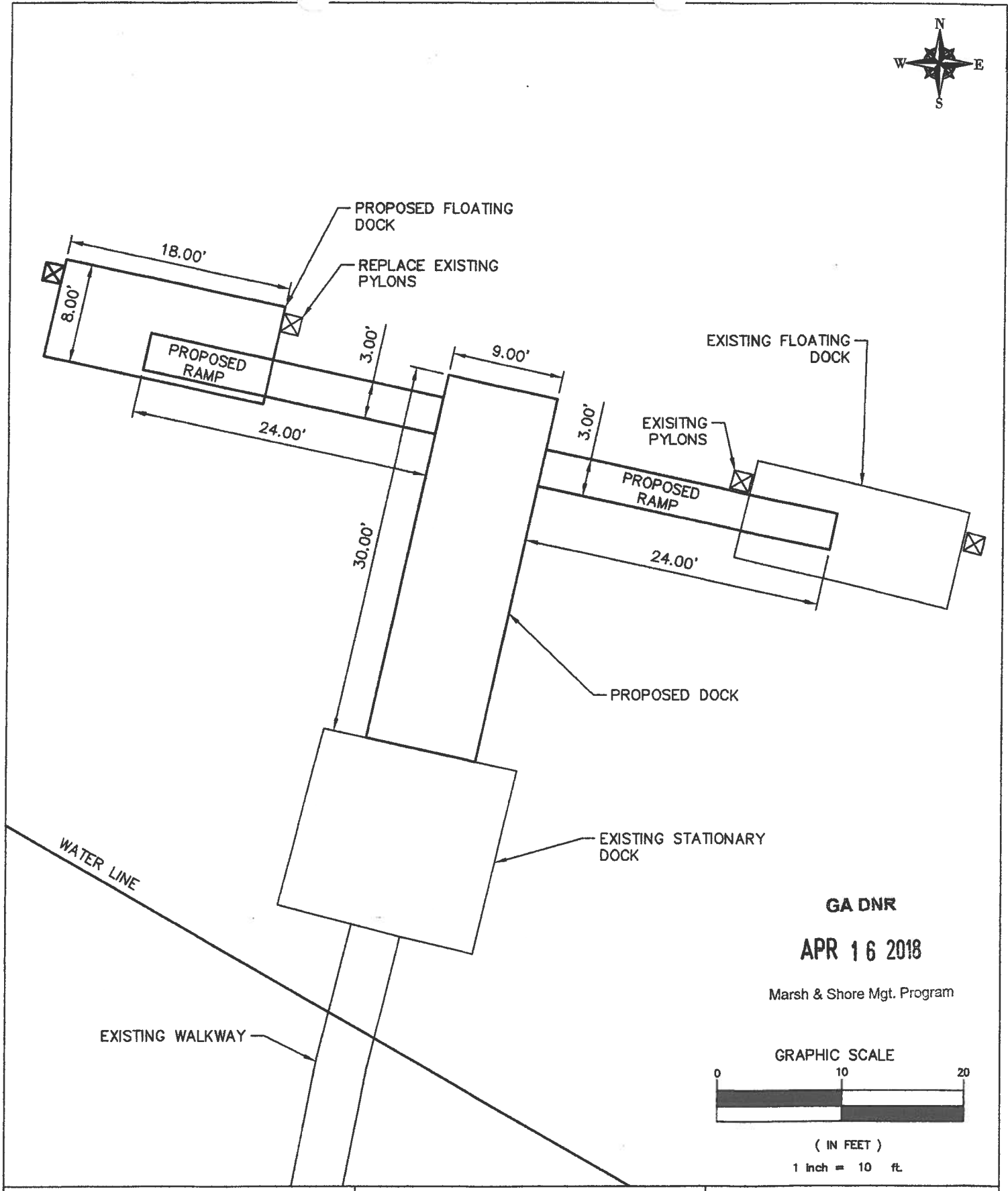

GA DNR

APR 16 2018

Marsh & Shore Mgt. Program

GRAPHIC SCALE

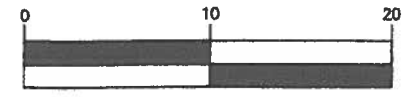

(IN FEET)

1 inch = 10 ft.

T. R. Long Engineering, P.C.
114 North Commerce Street
Hinesville, Georgia 31313
(912) 368-5664
(912) 368-7206 Fax

Dock Improvements
for
Belvedere Island

Sheet Name: Proposed Conditions
Sheet Number: C-07
Initial Date: 11/10/2017
Drawn By: RAD
Project Number: 2017-140



SOUTH NEWPORT RIVER

LIBERTY COUNTY
MCINTOSH COUNTY

GA DNR

APR 16 2018

Marsh & Shore Mgt. Program

1299.47'
1355.04' MLLW

136'

339'

MARSH LINE
WATER LINE

MARSH LINE

GRAPHIC SCALE



(IN FEET)

1 Inch = 200 ft.

T. R. Long Engineering, P.C.
114 North Commerce Street
Hinesville, Georgia 31313
(912) 368-5664
(912) 368-7206 Fax

Dock Improvements
for
Belvedere Island

Sheet Name: Relation to Low Water Line
Sheet Number: C-08
Initial Date: 11/10/2017
Drawn By: RAD
Project Number: 2017-140