

CRIP WORTHY  
GA SPEC EAST ZONE NAD 83

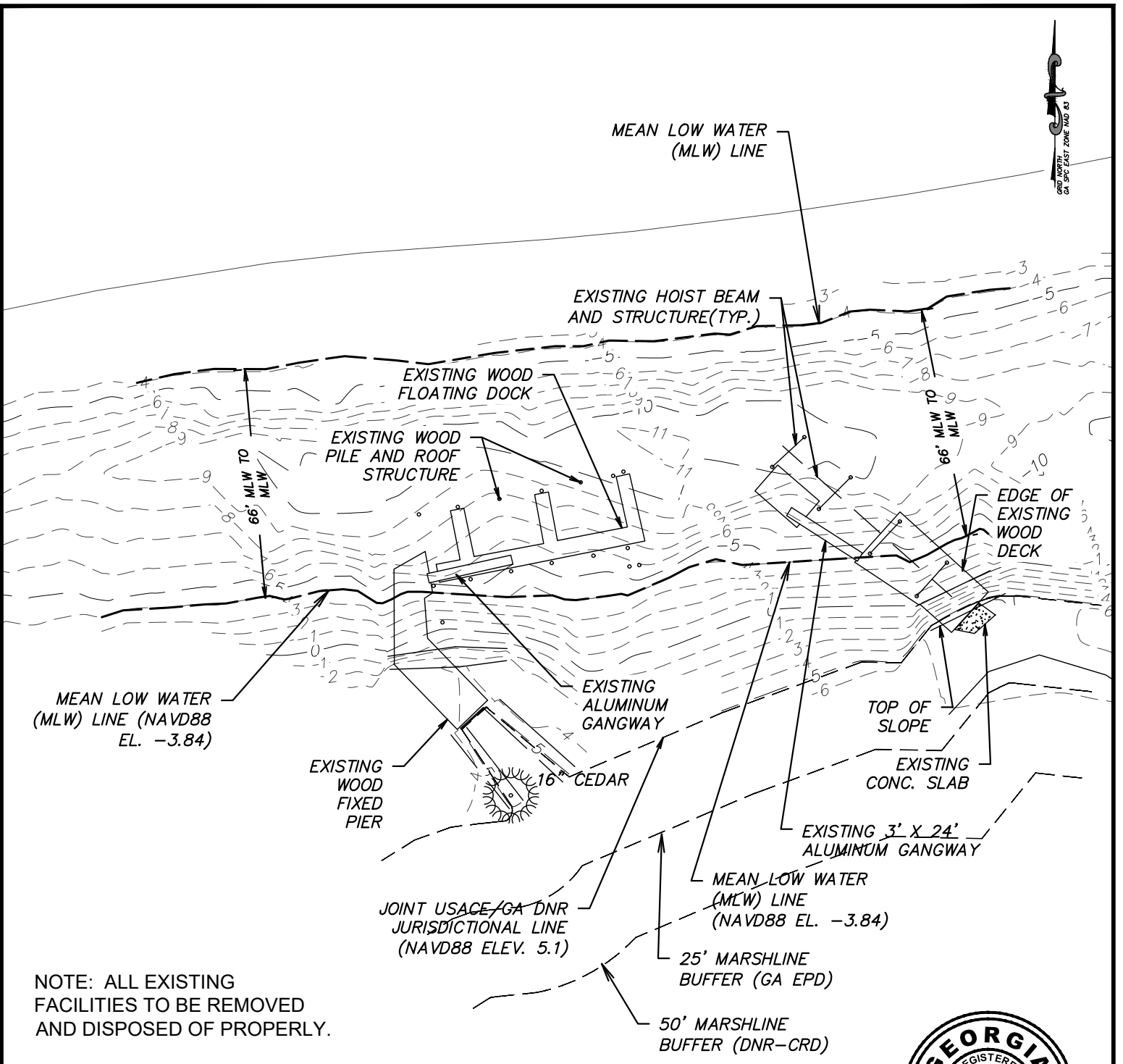

MEAN LOW WATER (MLW) LINE (NAVD88 EL. -3.84)

JOINT USACE/GA DNR JURISDICTIONAL LINE (NAVD88 ELEV. 5.1)

MEAN LOW WATER (MLW) LINE (NAVD88 EL. -3.84)

NOTE: ALL EXISTING FACILITIES TO BE REMOVED AND DISPOSED OF PROPERLY.

NOTE: CONTOUR ELEV. 5.1 FT NAVD88 IS DELINEATED AS A CONVERSION OF CMPA 5.6 FT MTL IN NOAA'S VDATUM TRANSFORMATION



### SHEET 2

**EMC ENGINEERING SERVICES, INC.**  
 10 Chatham Center South,  
 Ste 100  
 Savannah, GA 31405  
 Ph: (912) 232-6533  
 Fax: (912) 233-4580  
 savannah@emc-eng.com  
 www.emc-eng.com

**emc**  
 CIVIL MARINE ENVIRONMENTAL

ALBANY • ATLANTA • AUGUSTA • BRUNSWICK  
 COLUMBUS • SAVANNAH • STATESBORO  
 THOMASTON • VALDOSTA • WARNER ROBINS

**EXISTING CONDITIONS**

**BOATHOUSE AND HOIST IMPROVEMENTS**  
 SAPELO ISLAND, MCINTOSH CO., GEORGIA

Prepared for:  
**GEORGIA DEPARTMENT OF NATURAL RESOURCES**

PROJECT NO:	21-0103
DRAWN BY:	CFM
DESIGNED BY:	JMM
SURVEYED BY:	EMC
SURVEY DATE:	AUG. 2021
CHECKED BY:	JMM
SCALE:	1" = 40'
DATE:	OCT. 2021

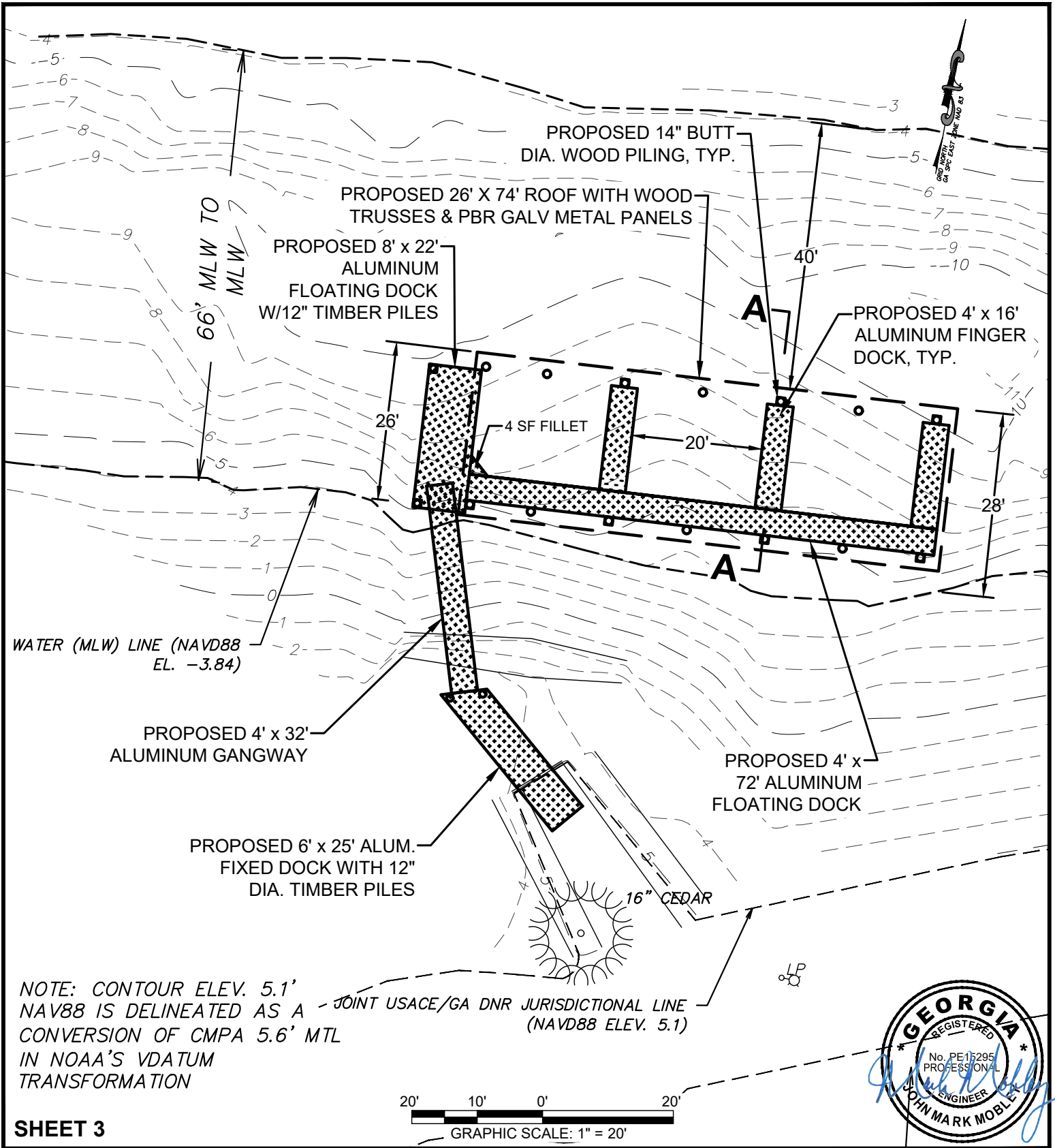

NOTE: CONTOUR ELEV. 5.1' NAV88 IS DELINEATED AS A JOINT USACE/GA DNR JURISDICTIONAL LINE (NAVD88 ELEV. 5.1) IN NOAA'S VDATUM TRANSFORMATION



**SHEET 3**

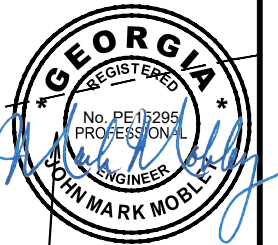

**EMC ENGINEERING SERVICES, INC.**  
 10 Chatham Center South,  
 Ste 100  
 Savannah, GA 31405  
 Ph: (912) 232-6533  
 Fax: (912) 233-4580  
 savannah@emc-eng.com  
 www.emc-eng.com

**emc**  
 CIVIL MARINE ENVIRONMENTAL

ALBANY • ATLANTA • AUGUSTA • BRUNSWICK  
 COLUMBUS • SAVANNAH • STATESBORO  
 THOMASTON • VALDOSTA • WARNER ROBINS

**PROPOSED CONDITIONS - BOAT HOUSE**

**BOATHOUSE AND HOIST IMPROVEMENTS**

**SAPELO ISLAND, MCINTOSH CO., GEORGIA**

Prepared for:  
**GEORGIA DEPARTMENT OF NATURAL RESOURCES**

PROJECT NO:	21-0103
DRAWN BY:	CFM
DESIGNED BY:	JMM
SURVEYED BY:	EMC
SURVEY DATE:	AUG. 2021
CHECKED BY:	JMM
SCALE:	1" = 20'
DATE:	OCT. 2021

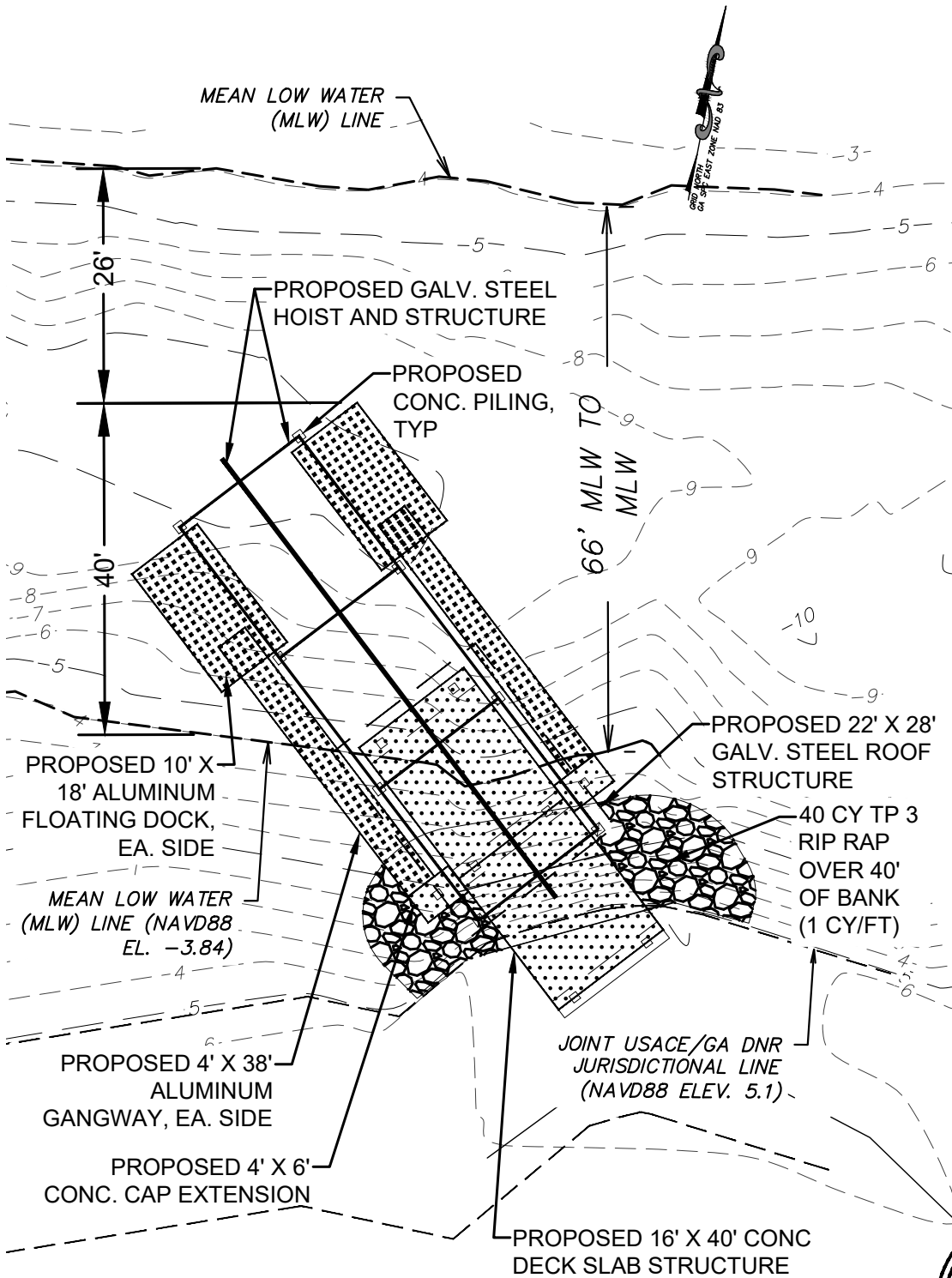

**SHEET 4**

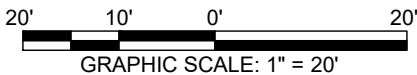

*NOTE: CONTOUR ELEV. 5.1' NAVD88 IS DELINEATED AS A CONVERSION OF CMPA 5.6' MTL IN NOAA'S VDATUM TRANSFORMATION*



**EMC ENGINEERING SERVICES, INC.**  
 10 Chatham Center South,  
 Ste 100  
 Savannah, GA 31405  
 Ph: (912) 232-6533  
 Fax: (912) 233-4580  
 savannah@emc-eng.com  
 www.emc-eng.com

**emc**  
 CIVIL MARINE ENVIRONMENTAL

ALBANY • ATLANTA • AUGUSTA • BRUNSWICK  
 COLUMBUS • SAVANNAH • STATESBORO  
 THOMASTON • VALDOSTA • WARNER ROBINS

**PROPOSED CONDITIONS - BOAT HOIST  
 BOATHOUSE AND HOIST IMPROVEMENTS  
 SAPELO ISLAND, MCINTOSH CO., GEORGIA**

Prepared for:  
**GEORGIA DEPARTMENT OF NATURAL RESOURCES**

PROJECT NO:	21-0103
DRAWN BY:	CFM
DESIGNED BY:	JMM
SURVEYED BY:	EMC
SURVEY DATE:	AUG. 2021
CHECKED BY:	JMM
SCALE:	1" = 20'
DATE:	OCT. 2021

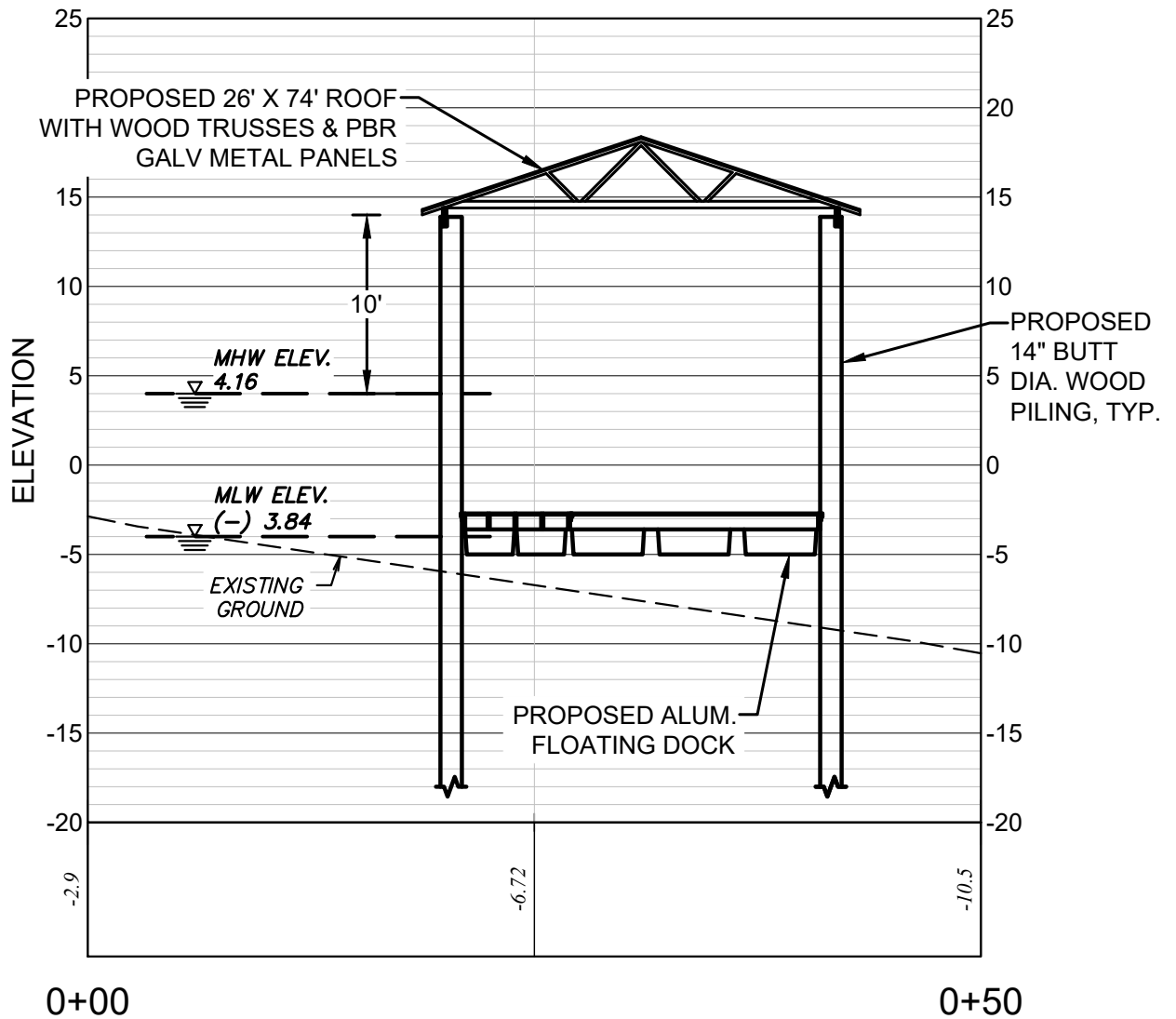

**SECTION A PROFILE**

SCALE: 1" = 10' HORIZ.  
1" = 10' VERT.



**SHEET 5**

**EMC ENGINEERING SERVICES, INC.**  
10 Chatham Center South,  
Ste 100  
Savannah, GA 31405  
Ph: (912) 232-6533  
Fax: (912) 233-4580  
savannah@emc-eng.com  
www.emc-eng.com

**emc**  
CIVIL MARINE ENVIRONMENTAL

ALBANY • ATLANTA • AUGUSTA • BRUNSWICK  
COLUMBUS • SAVANNAH • STATESBORO  
THOMASTON • VALDOSTA • WARNER ROBINS

**BOATHOUSE PROFILE**

**BOATHOUSE AND HOIST IMPROVEMENTS**  
SAPELO ISLAND, MCINTOSH CO., GEORGIA

Prepared for:  
**GEORGIA DEPARTMENT OF NATURAL RESOURCES**

PROJECT NO:	21-0103
DRAWN BY:	CFM
DESIGNED BY:	JMM
SURVEYED BY:	EMC
SURVEY DATE:	AUG. 2021
CHECKED BY:	JMM
SCALE:	1" = 10'
DATE:	OCT. 2021

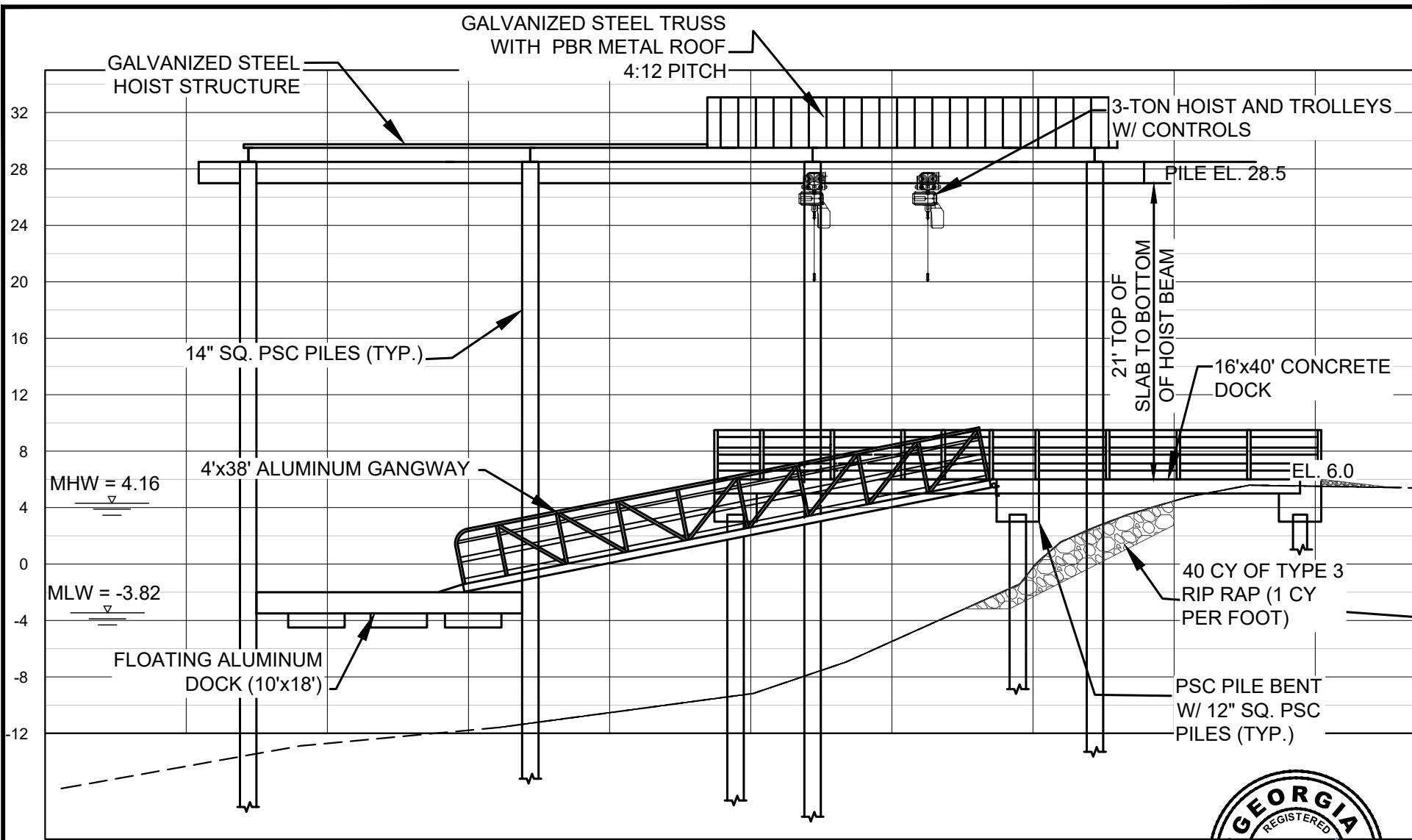

**BOAT HOIST PROFILE**

SCALE: 1" = 10' HORIZ.  
1" = 10' VERT.



**SHEET 6**

**EMC ENGINEERING SERVICES, INC.**  
10 Chatham Center South,  
Ste 100  
Savannah, GA 31405  
Ph: (912) 232-6533  
Fax: (912) 233-4580  
savannah@emc-eng.com  
www.emc-eng.com

**emc**  
CIVIL  
MARINE  
ENVIRONMENTAL

ALBANY • ATLANTA • AUGUSTA • BRUNSWICK  
COLUMBUS • SAVANNAH • STATESBORO  
THOMASTON • VALDOSTA • WARNER ROBINS

**BOAT HOIST PROFILE**

---

**BOATHOUSE AND HOIST IMPROVEMENTS**  
SAPELO ISLAND, MCINTOSH CO., GEORGIA

Prepared for:  
**GEORGIA DEPARTMENT OF NATURAL RESOURCES**

PROJECT NO:	21-0103
DRAWN BY:	CFM
DESIGNED BY:	JMM
SURVEYED BY:	EMC
SURVEY DATE:	AUG. 2021
CHECKED BY:	JMM
SCALE:	1" = 10'
DATE:	OCT. 2021