

EXISTING STRUCTURE FOOTPRINT:
UPLAND FOOTPRINT: 20 SF
COASTAL MARSHLAND FOOTPRINT: 2,622 SF

PROPOSED ADDITIONAL STRUCTURE FOOTPRINT:
UPLAND FOOTPRINT: 0 SF
COASTAL MARSHLAND FOOTPRINT: 1,618 SF

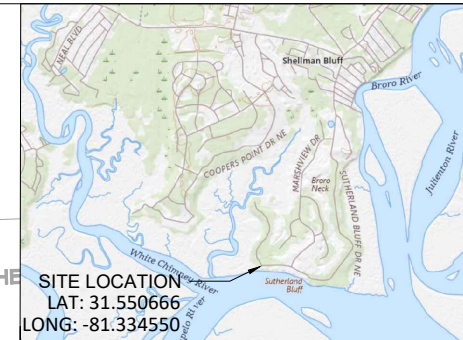
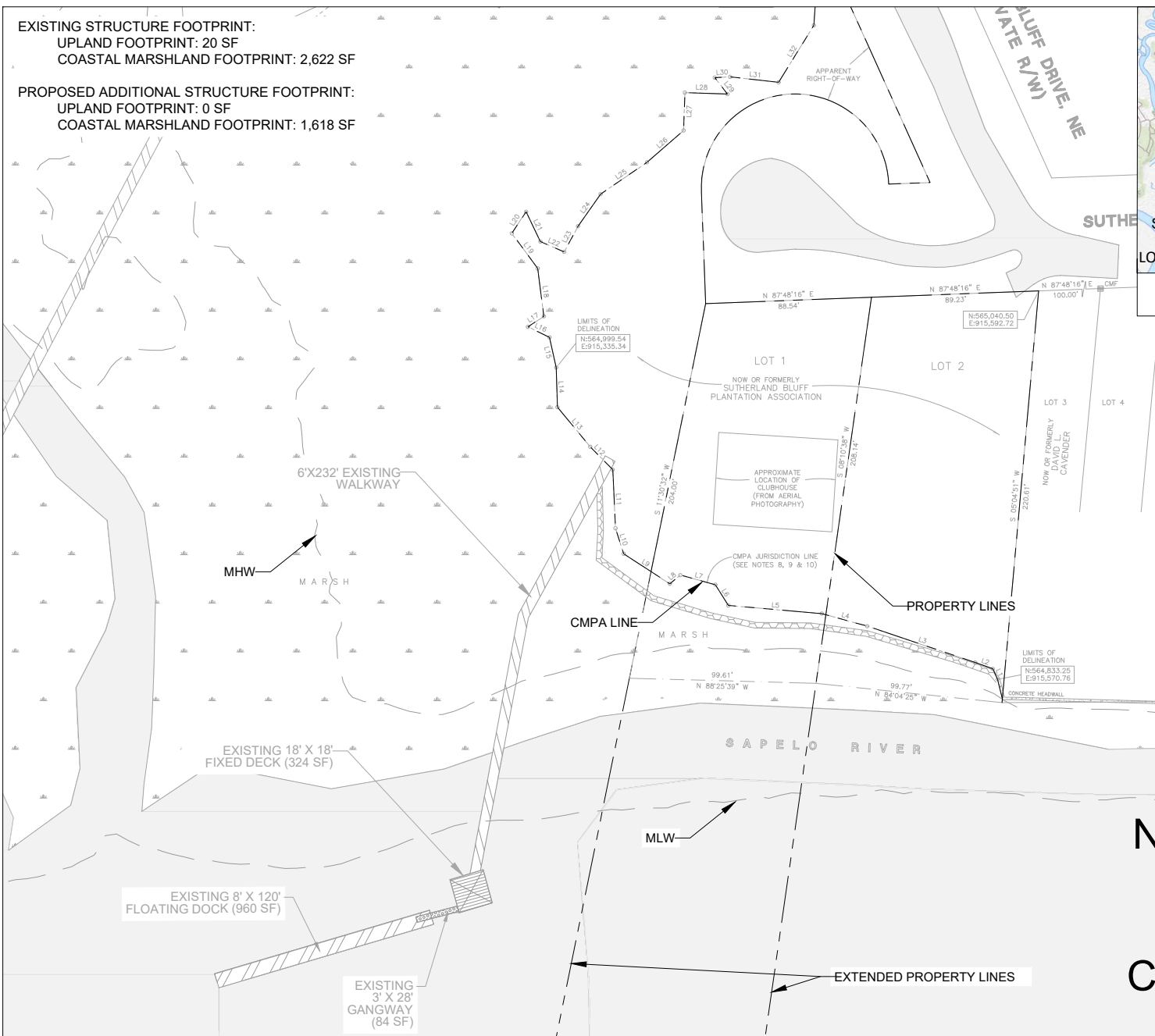

VICINITY MAP

PROJECT INFORMATION

Owner: Sutherland Bluff Plantation POA
Agent: Austin Chalmers
Phone: (912) 638-9681
Email: achalmers@robertscivilengineering.com
SITE DATA
Site Address: 3347 Sutherland Bluff Drive
Parcel Number: 0072E 0031
Waterway: Sapelo River

LEGEND

	EXISTING MARSH
	EXISTING GANGWAY
	EXISTING FIXED DECK
	EXISTING FLOATING DOCK
	EXISTING WATER BODY
	PROPERTY LINE
	MLW, MHW
	EXISTING WETLAND BOUNDARY



NOTES:

1. THE DOCK PLANS SHOWN HEREIN SHALL BE USED ONLY AS AN EXHIBIT FOR DOCK PERMITTING WITH THE GEORGIA DEPARTMENT OF NATURAL RESOURCES AND THE ARMY CORPS OF ENGINEERS.
2. THE DIAGRAM IS NOT INTENDED TO BE USED FOR CONSTRUCTION DRAWINGS.
3. THE PROPERTY BOUNDARIES WERE OBTAINED THROUGH A SURVEY CONDUCTED BY SHUPE SURVEYING.
4. THE MLW & MHW LINES SHOWN WERE APPROXIMATED THROUGH LIDAR AND GIS INFORMATION.



Know what's below.
Call before you dig.

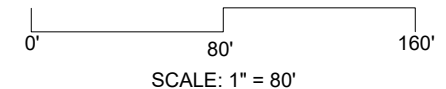

SCALE: 1" = 80'

REVISIONS

ROBERTS CIVIL ENGINEERING
301 SEA ISLAND ROAD, SUITE 10
SEASIDE, GA 31565
912-638-9681 OFFICE
912-289-0339 FAX



ROBERTS
CIVIL ENGINEERING

SITE OVERVIEW

SUTHERLAND BLUFF DOCK PLAN
TOWNSEND, GA 31331

PREPARED FOR:
SUTHERLAND BLUFF PLANTATION POA

DATE: 2025-06-02
PROJECT NO.: 24005
DRAWN BY: CS
CHECKED BY: AC
SCALE: 1" = 80'

1

SHEET

EXISTING STRUCTURE FOOTPRINT:
 UPLAND FOOTPRINT: 20 SF
 COASTAL MARSHLAND FOOTPRINT: 2,622 SF

PROPOSED ADDITIONAL STRUCTURE FOOTPRINT:
 UPLAND FOOTPRINT: 0 SF
 COASTAL MARSHLAND FOOTPRINT: 1,618 SF

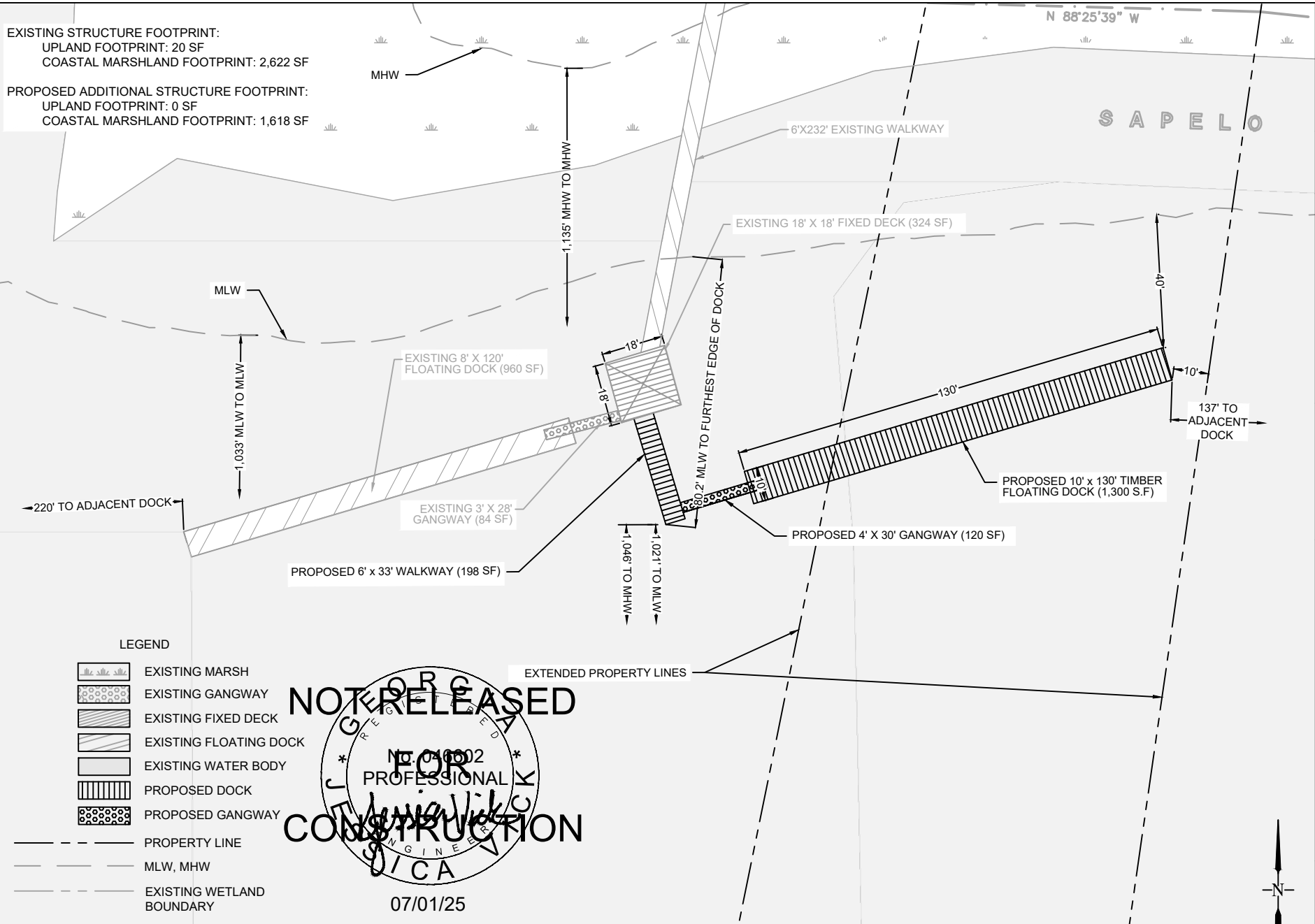

- NOTES:
1. THE DOCK PLANS SHOWN HEREIN SHALL BE USED ONLY AS AN EXHIBIT FOR DOCK PERMITTING WITH THE GEORGIA DEPARTMENT OF NATURAL RESOURCES AND THE ARMY CORPS OF ENGINEERS.
 2. THE DIAGRAM IS NOT INTENDED TO BE USED FOR CONSTRUCTION DRAWINGS.
 3. THE PROPERTY BOUNDARIES WERE OBTAINED THROUGH A SURVEY CONDUCTED BY SHUPE SURVEYING.
 4. THE MLW & MHW LINES SHOWN WERE APPROXIMATED THROUGH LIDAR AND GIS INFORMATION.

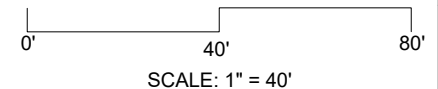

REVISIONS

ROBERTS CIVIL ENGINEERING
 301 SEA ISLAND ROAD, SUITE 10
 SEASIDE, GA 31565
 912-438-9884 OFFICE
 912-289-0339 FAX



PROPOSED LAYOUT

SUTHERLAND BLUFF DOCK PLAN

TOWNSEND, GA 31331

PREPARED FOR:
 SUTHERLAND BLUFF PLANTATION POA

DATE: 2025-06-02
 PROJECT NO.: 24005
 DRAWN BY: CS
 CHECKED BY: AC
 SCALE: 1" = 40'

2

SHEET

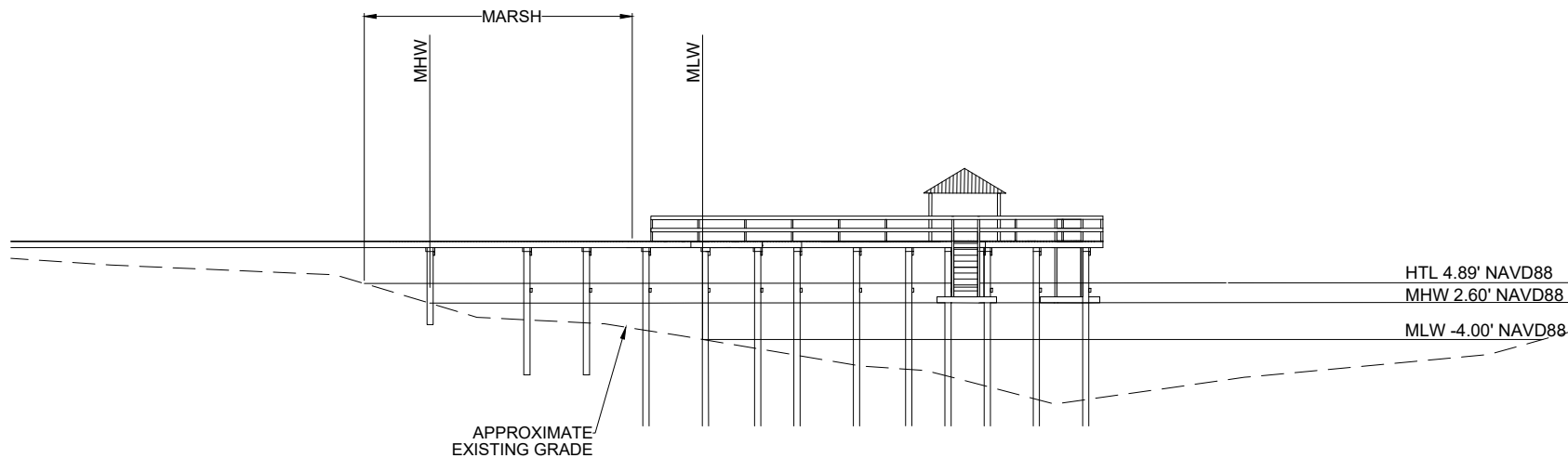

PROFILE
N.T.S.

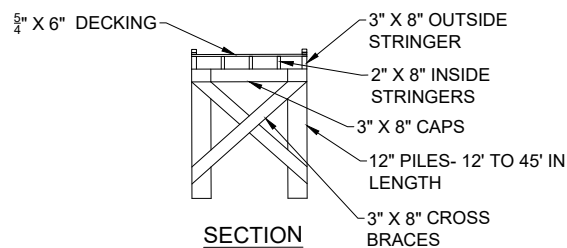

SECTION
N.T.S.



07/01/25

NOTES:

1. THE DOCK PLANS SHOWN HEREIN SHALL BE USED ONLY AS AN EXHIBIT FOR DOCK PERMITTING WITH THE GEORGIA DEPARTMENT OF NATURAL RESOURCES AND THE ARMY CORPS OF ENGINEERS.
2. THE DIAGRAM IS NOT INTENDED TO BE USED FOR CONSTRUCTION DRAWINGS.
3. THE PROPERTY BOUNDARIES WERE OBTAINED THROUGH A SURVEY CONDUCTED BY SHUPE SURVEYING.
4. THE MLW & MHW LINES SHOWN WERE APPROXIMATED THROUGH LIDAR AND GIS INFORMATION.



Know what's below.
Call before you dig.

REVISIONS

ROBERTS CIVIL ENGINEERING
301 SEA ISLAND ROAD, SUITE 10
TOWNSENDE, GA 31331
912-458-9681 OFFICE
912-289-0393 FAX



ROBERTS
CIVIL ENGINEERING

PROPOSED PROFILE

SUTHERLAND BLUFF DOCK PLAN
TOWNSENDE, GA 31331
PREPARED FOR:
SUTHERLAND BLUFF PLANTATION POA

DATE: 2025-06-02
PROJECT NO.: 24005
DRAWN BY: CS
CHECKED BY: AC
SCALE: NTS

3

SHEET