

07-22-2022

ROBERTS CIVIL ENGINEERING
301 SEA ISLAND ROAD, SUITE 10
ST. SIMONS, GA 31522
912-638-9681 OFFICE
912-614-5689 FAX

PREPARED FOR:
TRAVIS WEBB

DOCK SITE PLAN
116 BURNETT ROAD
BRUNSWICK, GA

DATE: 2022-03-02
PROJECT NO.: 21095
DRAWN BY: CS
CHECKED BY: SW
SCALE: 1" = 30'

1

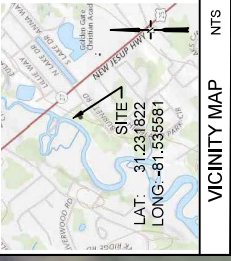

VICINITY MAP
NTS

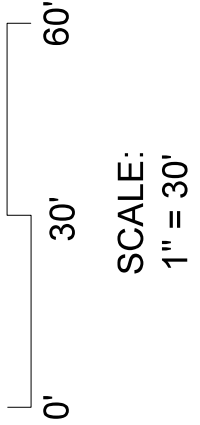
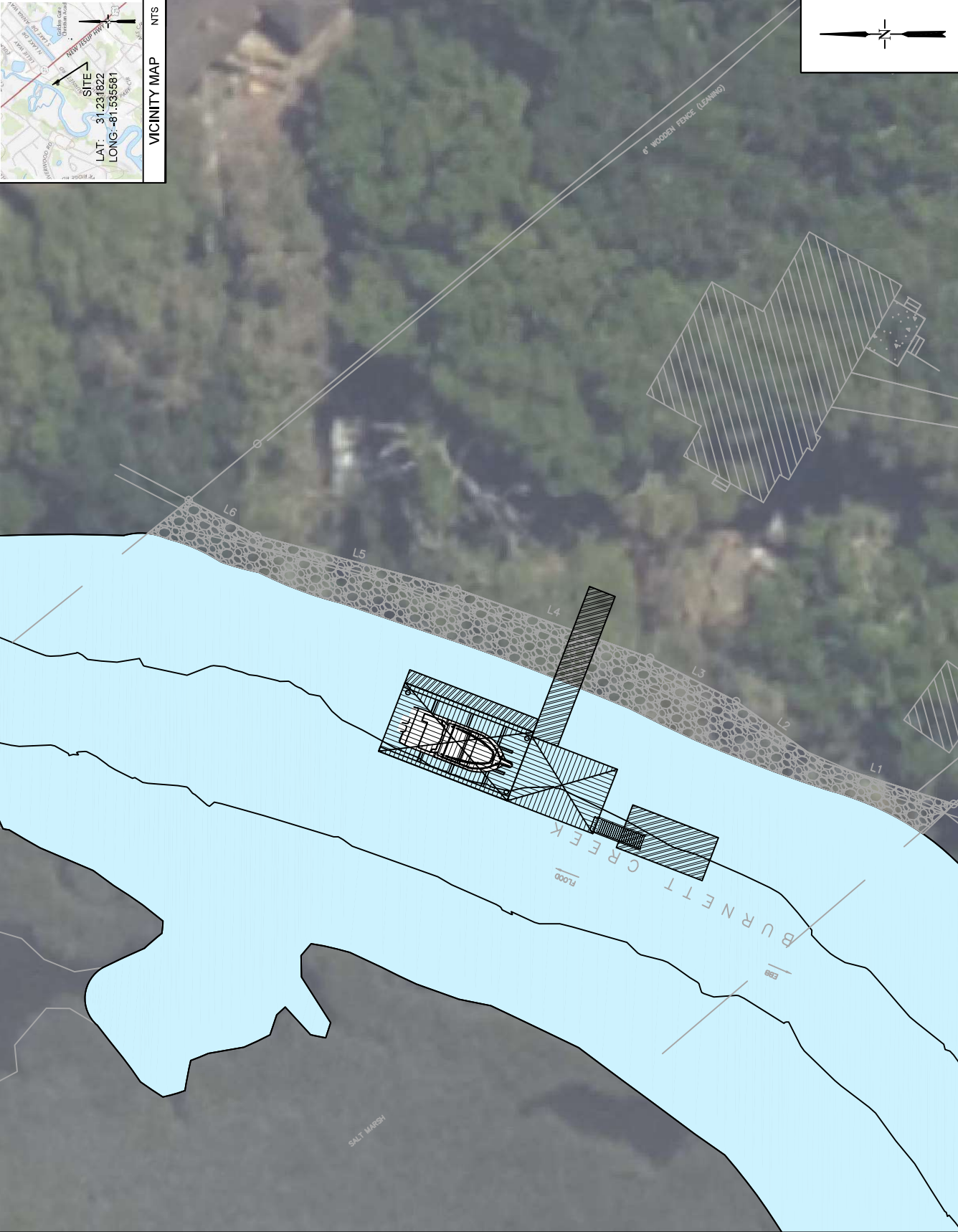
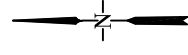

- NOTES:
1. THE DOCK PLANS SHOWN HEREIN SHALL BE USED ONLY AS AN EXHIBIT FOR DOCK PERMITTING WITH THE GEORGIA DEPARTMENT OF NATURAL RESOURCES.
 2. DEPTHS OF THE CHANNEL WERE OBSERVED BY SHUPE SURVEYING COMPANY, PC.
 3. MEAN LOW WATER LINE ELEVATION IS BASED ON NGS TIDAL BENCHMARK BR0079 (STA8677344) ST. SIMONS ISLAND LIGHTHOUSE.



07-22-2022
 ROBERTS CIVIL ENGINEERING
 301 SEA ISLAND ROAD, SUITE 10
 ST. SIMONS, GA 31522
 912-638-9681 OFFICE
 912-614-5689 FAX

PREPARED FOR:
 TRAVIS WEBB

PROPOSED DOCK PLAN
 116 BURNETT ROAD
 BRUNSWICK, GA

DATE: 2022-03-02
 PROJECT NO.: 21095
 DRAWN BY: CS
 CHECKED BY: SW
 SCALE: 1" = 30'

3

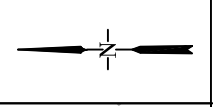
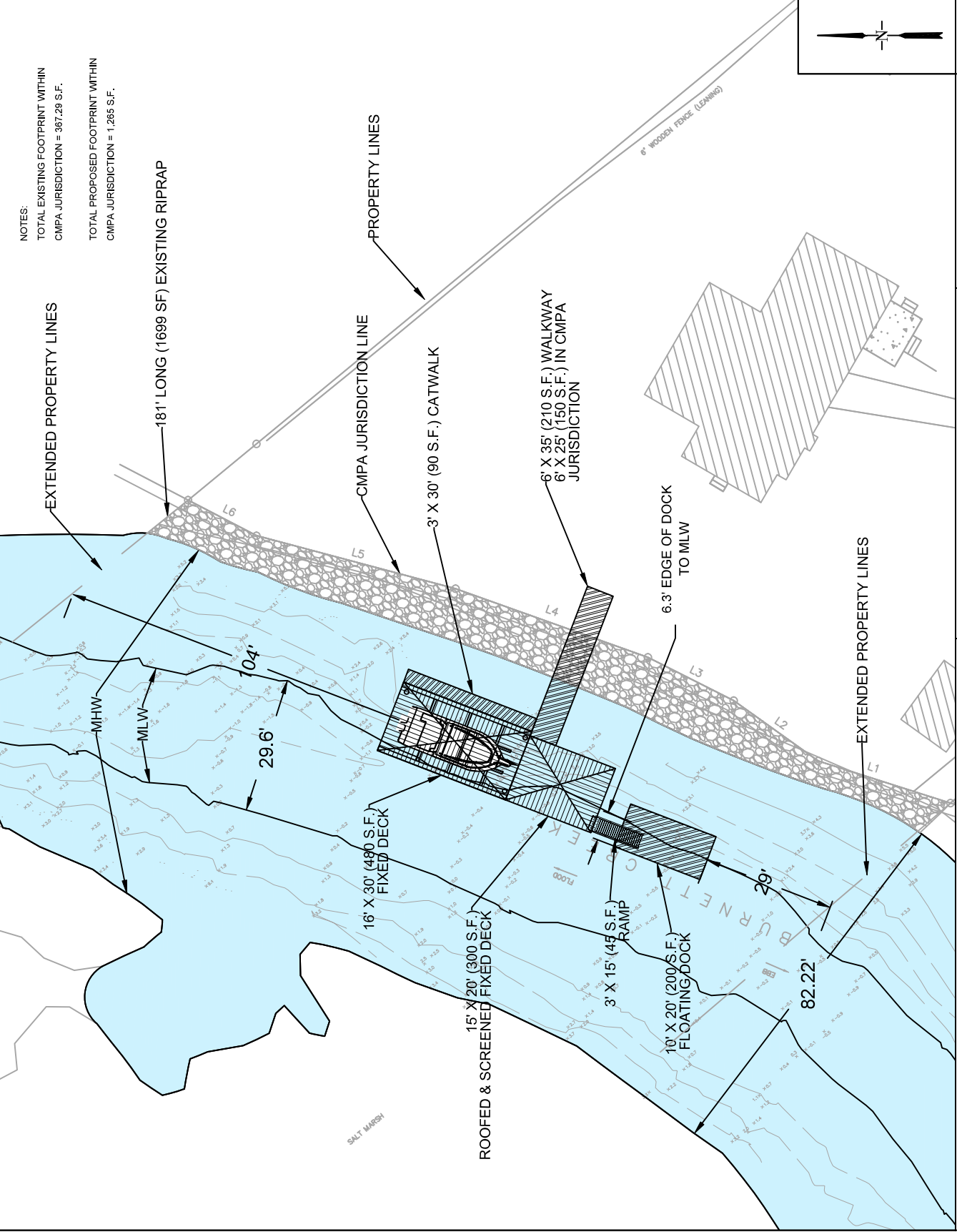

NOTES:

- THE DOCK PLANS SHOWN HEREIN SHALL BE USED ONLY AS AN EXHIBIT FOR DOCK PERMITTING WITH THE GEORGIA DEPARTMENT OF NATURAL RESOURCES.
- DEPTHS OF THE CHANNEL WERE OBSERVED BY SHUPE SURVEYING COMPANY, PC.
- MEAN LOW WATER LINE ELEVATION IS BASED ON NGS TIDAL BENCHMARK BR0079 (STA667344) ST. SIMONS ISLAND LIGHTHOUSE.

