

# IMPROVING RESILIENCE IN WEST BRUNSWICK

## FOR THE CITY OF BRUNSWICK

GLYNN COUNTY, GEORGIA

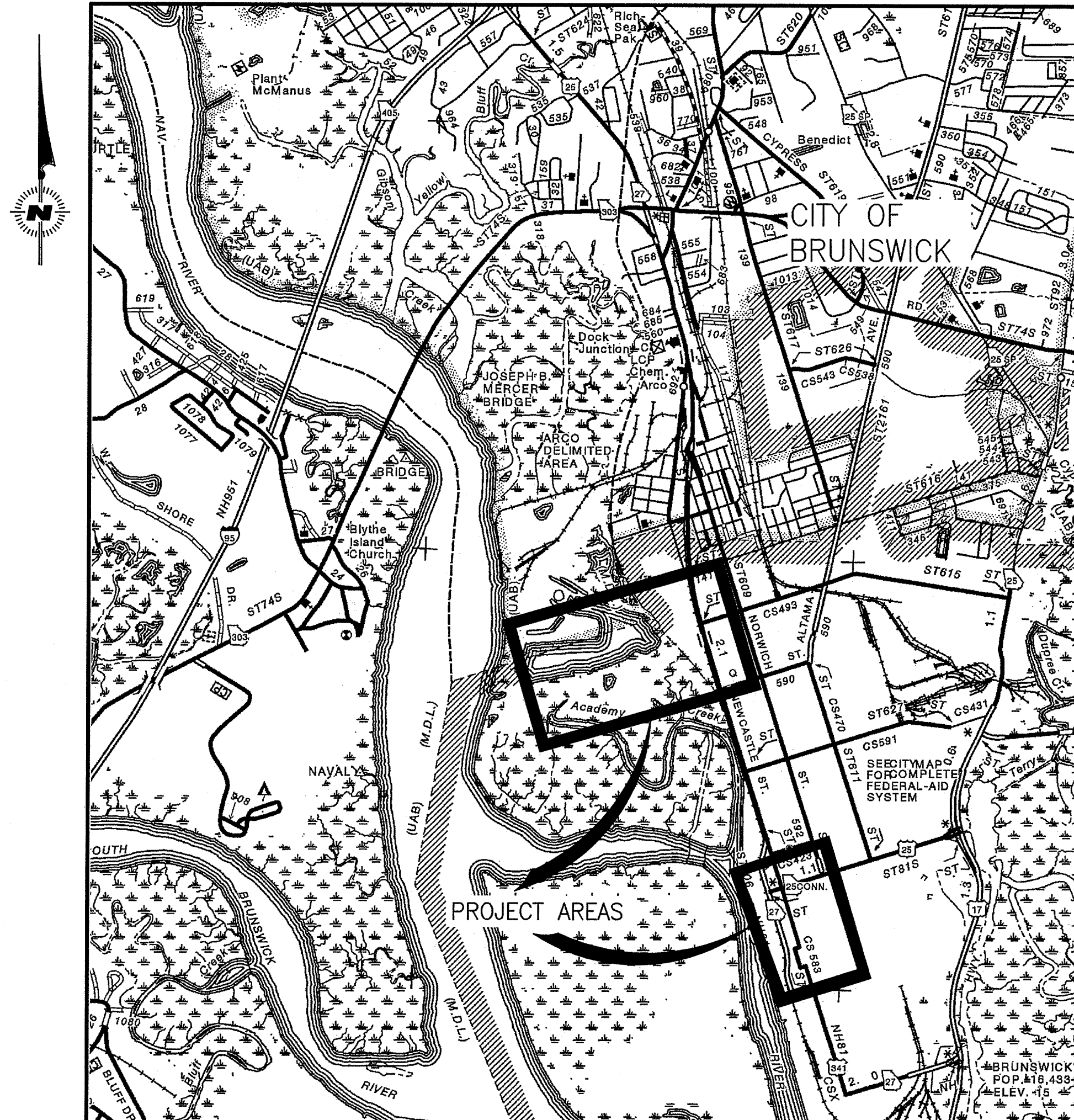

VICINITY MAP  
SCALE: N.T.S.



24 Hr. Contact: Garrow Alberson, PE  
Telephone: (912) 267-5540  
Email: galberson@cityofbrunswick-ga.gov

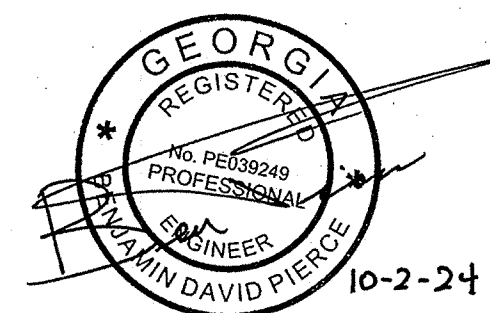

PERMIT SET



# GWES

CIVIL • ENVIRONMENTAL • TRANSPORTATION  
ENGINEERING

511 GLOUCESTER ST, BRUNSWICK, GA 31520  
GEORGIA COA: PEF006783; EXPIRES 6/30/2024

GWES Project Number: 092.04.3.22

DRAWING INDEX

- C-1 COVER SHEET
- C-2 KEY MAP
- C-3 EXHIBIT - PALMETTO CEMETERY OUTFALL DITCH STA 10+00 TO STA 20+00
- C-3 EXHIBIT - T STREET OUTFALL DITCH, HOWE STREET OUTFALL DITCH
- C-4 MISCELLANEOUS DETAILS

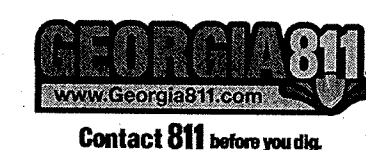



KEY MAP  
N.T.S



ISSUE SEQUENCE		
NO.	DATE	DESCRIPTION
0	10/02/2024	FOR PERMIT SET

© Copyright 2024 GWES, LLC.  
(all rights reserved)

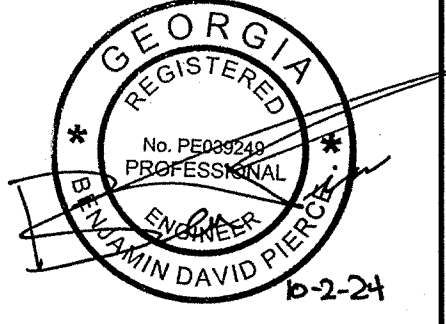

GSWCC LEVEL II CERTIFICATION #94108  
EXPIRATION DATE: 4-23-2027

**GWES**  
CIVIL • ENVIRONMENTAL • TRANSPORTATION  
ENGINEERING  
511 GLOUCESTER ST, BRUNSWICK, GA 31520

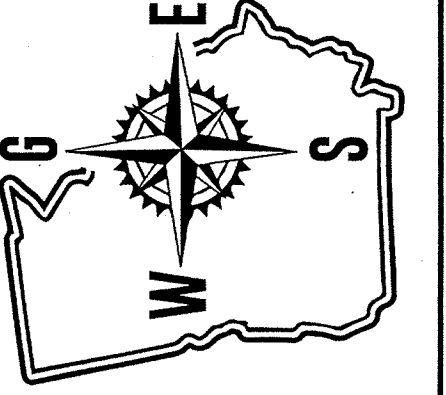

IMPROVING RESILIENCE IN  
WEST BRUNSWICK  
FOR  
CITY OF BRUNSWICK

PROJECT NO.: 092.04.3.22  
DESIGNED: B.D.P.  
CHECKED: M.W.T.  
APPROVED: B.D.P.  
DATE: MAY 17, 2024

KEY MAP

SCALE: AS SHOWN

DRAWING NO.  
**C-1**  
SHEET: 1 OF 4

P:\Active\092.04.3.22 Improving Resilience in West Brunswick\DWG\02403\_KEY\_MAP.dwg  
2024/05/17 10:31 AM By: Justin Wallace

ISSUE SEQUENCE		
NO.	DATE	DESCRIPTION
0	10/02/2024	FOR PERMIT SET

© Copyright 2024 GWES, LLC.  
(all rights reserved)

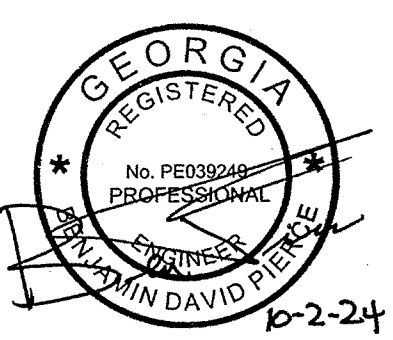

GSWCC LEVEL II CERTIFICATION #94108  
EXPIRATION DATE: 4-23-2027

**GWES**  
CIVIL • ENVIRONMENTAL • TRANSPORTATION  
ENGINEERING  
511 GLOUCESTER ST. BRUNSWICK, GA 31520

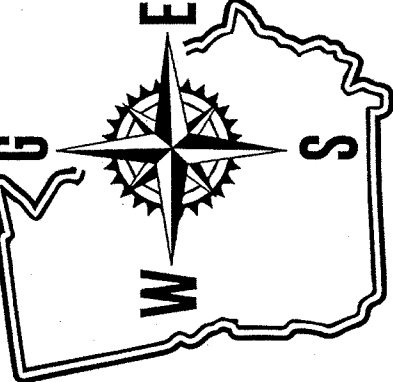

IMPROVING RESILIENCE IN  
WEST BRUNSWICK  
FOR  
CITY OF BRUNSWICK

PROJECT NO.: 092.04.3.22  
DESIGNED: B.D.P.  
CHECKED: M.W.T.  
APPROVED: B.D.P.  
DATE: MAY 17, 2024

EXHIBIT -  
PALMETTO STREET OUTFALL DITCH  
STA 10+00 TO STA 20+00

0 20' 40'  
SCALE: AS SHOWN

DRAWING NO.  
**C-2**  
SHEET: 2 OF 4

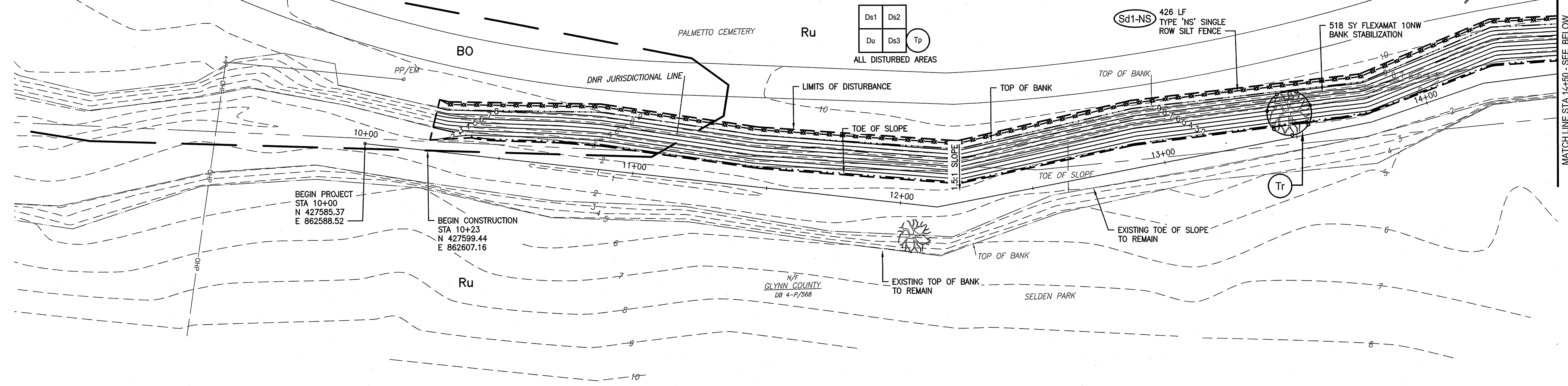

EXHIBITS - PALMETTO CEMETERY OUTFALL DITCH STA 10+00 TO STA 14+50

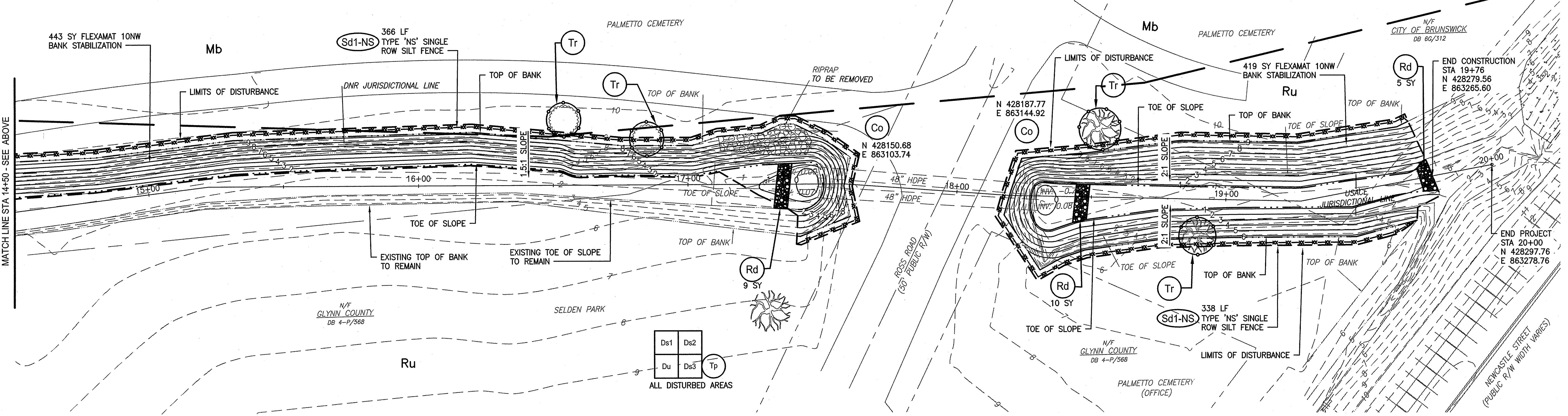

EXHIBITS - PALMETTO CEMETERY OUTFALL DITCH STA 14+50 TO STA 20+00

PALMETTO CEMETERY OUTFALL DISTURBANCE = 1,359 SY (0.28 ACRES)  
IMPACTS WITHIN CMPA JURISDICTIONAL DELINEATION = 792 SY (0.16 ACRES)  
FILL = 600 CY  
DREDGE = 116 CY  
IMPACTS WITHIN WATERS UPSTREAM OF CMPA JURISDICTION = 280 SY (0.06 ACRES)  
IMPACTS WITHIN USACE JURISDICTIONAL DELINEATION = 1,072 (0.24 ACRES)  
FILL = 659 CY  
DREDGE = 163 CY

- ESPCP PHASING**
- INITIAL BMPS SHALL INCLUDE INLET DUST CONTROL, SILT FENCES AND CONSTRUCTION EXITS.
  - INTERMEDIATE BMPS SHALL INCLUDE STORM DRAIN OUTLET PROTECTION, ROCK FILTER DAMS, TEMPORARY GRASSING AND MULCHING, AND MAINTENANCE OF ALL BMPS.
  - FINAL BMPS SHALL INCLUDE PERMANENT GRASSING, MULCHING, AND REMOVAL OF ALL BMPS.

P:\Drawings\2024\3.22 Improving Resilience in West Brunswick\1404 Exhibits\140403 Exhibits.dwg  
2024/10/02 10:53 AM By: Jordan Nelson

ISSUE SEQUENCE		
NO.	DATE	DESCRIPTION
0	10/02/2024	FOR PERMIT SET

© Copyright 2024 GWES, LLC.  
(all rights reserved)



GSWCC LEVEL II CERTIFICATION #04108  
EXPIRATION DATE: 4-23-2027

**GWES**  
CIVIL • ENVIRONMENTAL • TRANSPORTATION  
ENGINEERING  
511 BLOOMSTER ST, BRUNSWICK, GA 31520

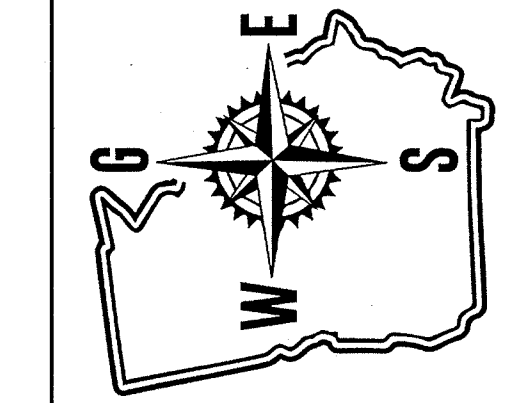

IMPROVING RESILIENCE IN  
WEST BRUNSWICK  
FOR  
CITY OF BRUNSWICK

PROJECT NO.:	092.04.3.22
DESIGNED:	B.D.P.
CHECKED:	M.W.T.
APPROVED:	B.D.P.
DATE:	MAY 17, 2024

EXHIBITS -  
T STREET OUTFALL DITCH,  
HOWE STREET OUTFALL

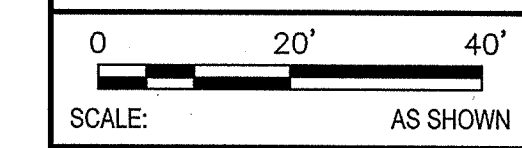

DRAWING NO.  
**C-3**  
SHEET:  
3 OF 4

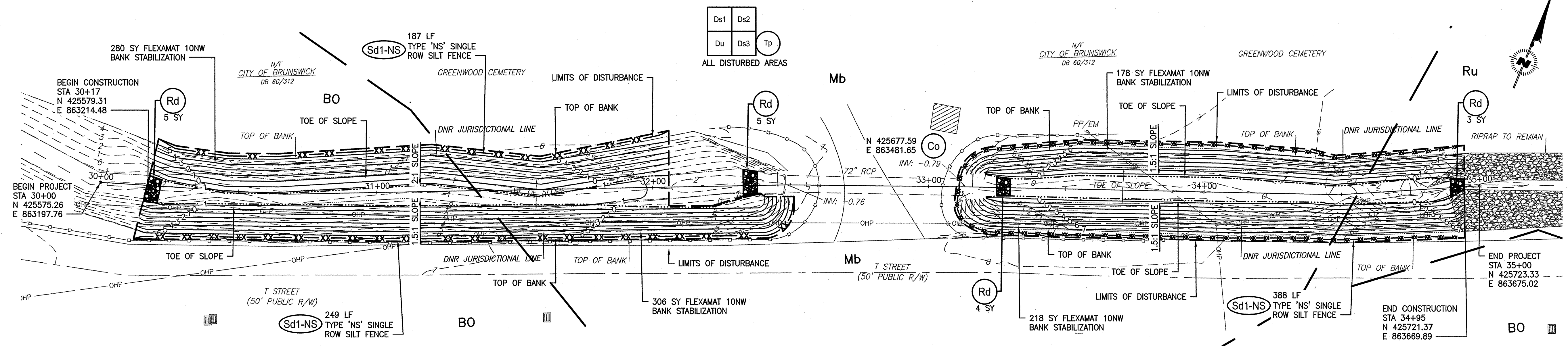

T STREET OUTFALL DISTURBANCE = 1,453 SY (0.30 ACRES)  
IMPACTS WITHIN CMPA JURISDICTIONAL DELINEATION = 1,028 SY (0.22 ACRES)  
FILL = 677 CY  
DREDGE = 103 CY

**T STREET OUTFALL DITCH**

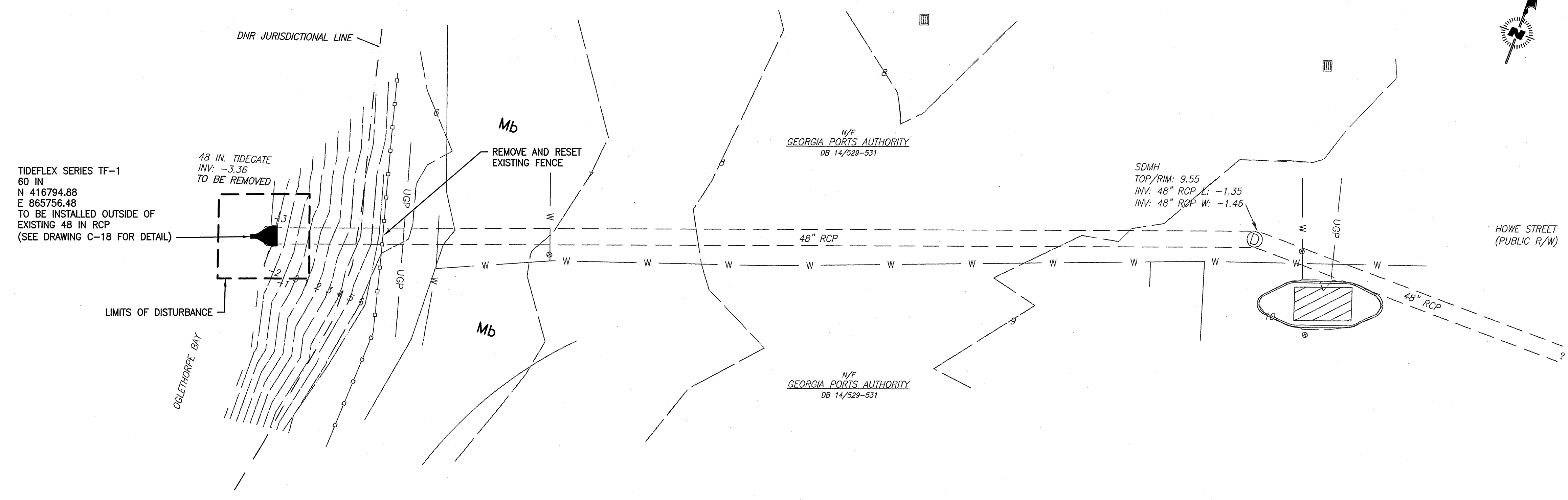

HOWE STREET OUTFALL DISTURBANCE = 81 SY (0.02 ACRES)  
IMPACTS WITHIN CMPA JURISDICTIONAL DELINEATION = 81 SY (0.02 ACRES)

**HOWE STREET OUTFALL**

**ESPCP PHASING**

- INITIAL BMPS SHALL INCLUDE INLET DUST CONTROL, SILT FENCES AND CONSTRUCTION EXITS.
- INTERMEDIATE BMPS SHALL INCLUDE STORM DRAIN OUTLET PROTECTION, ROCK FILTER DAMS, TEMPORARY GRASSING AND MULCHING, AND MAINTENANCE OF ALL BMPS.
- FINAL BMPS SHALL INCLUDE PERMANENT GRASSING, MULCHING, AND REMOVAL OF ALL BMPS.

P:\Active\024.04.3.22 Improving Resilience in West Brunswick\04.04.03\024.04.3.22\Drawings\024.04.3.22\EXHIBITS.dwg 10/02/2024 10:53 AM by: Jordan Mallard

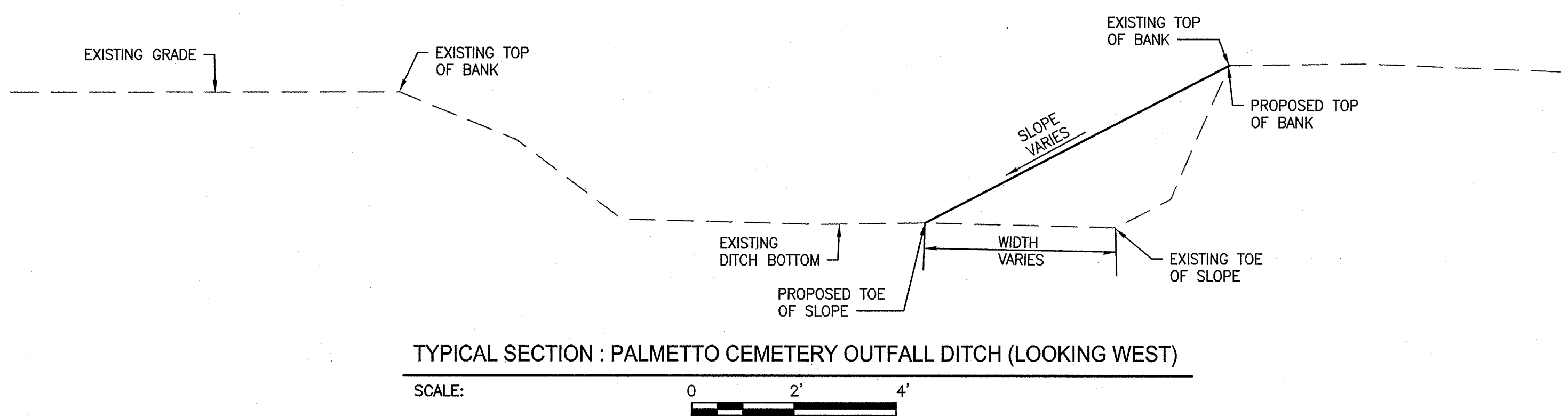

TYPICAL SECTION : PALMETTO CEMETERY OUTFALL DITCH (LOOKING WEST)

SCALE: 0 2' 4'

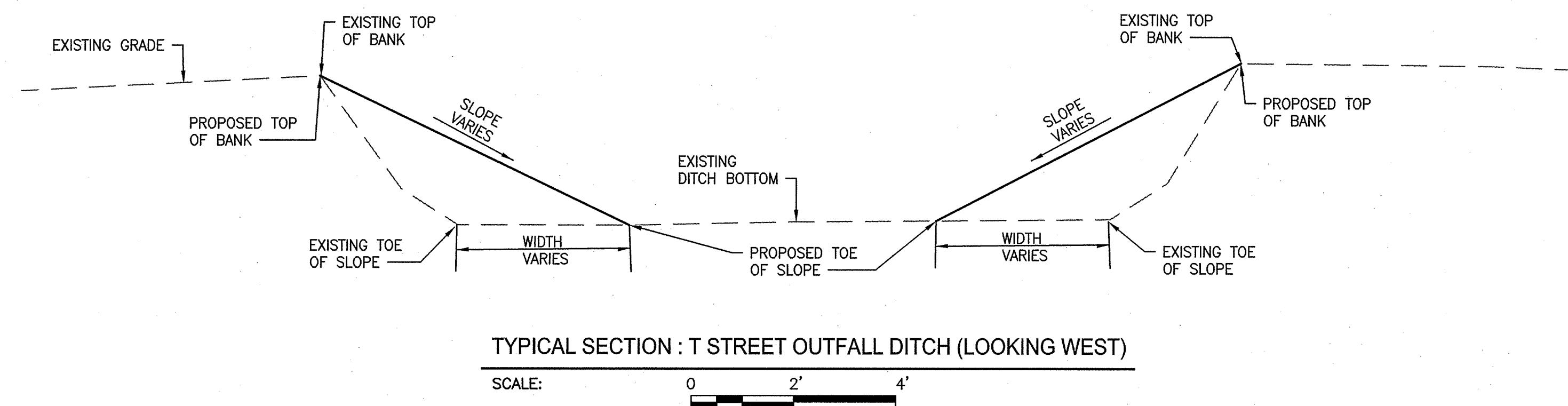

TYPICAL SECTION : T STREET OUTFALL DITCH (LOOKING WEST)

SCALE: 0 2' 4'

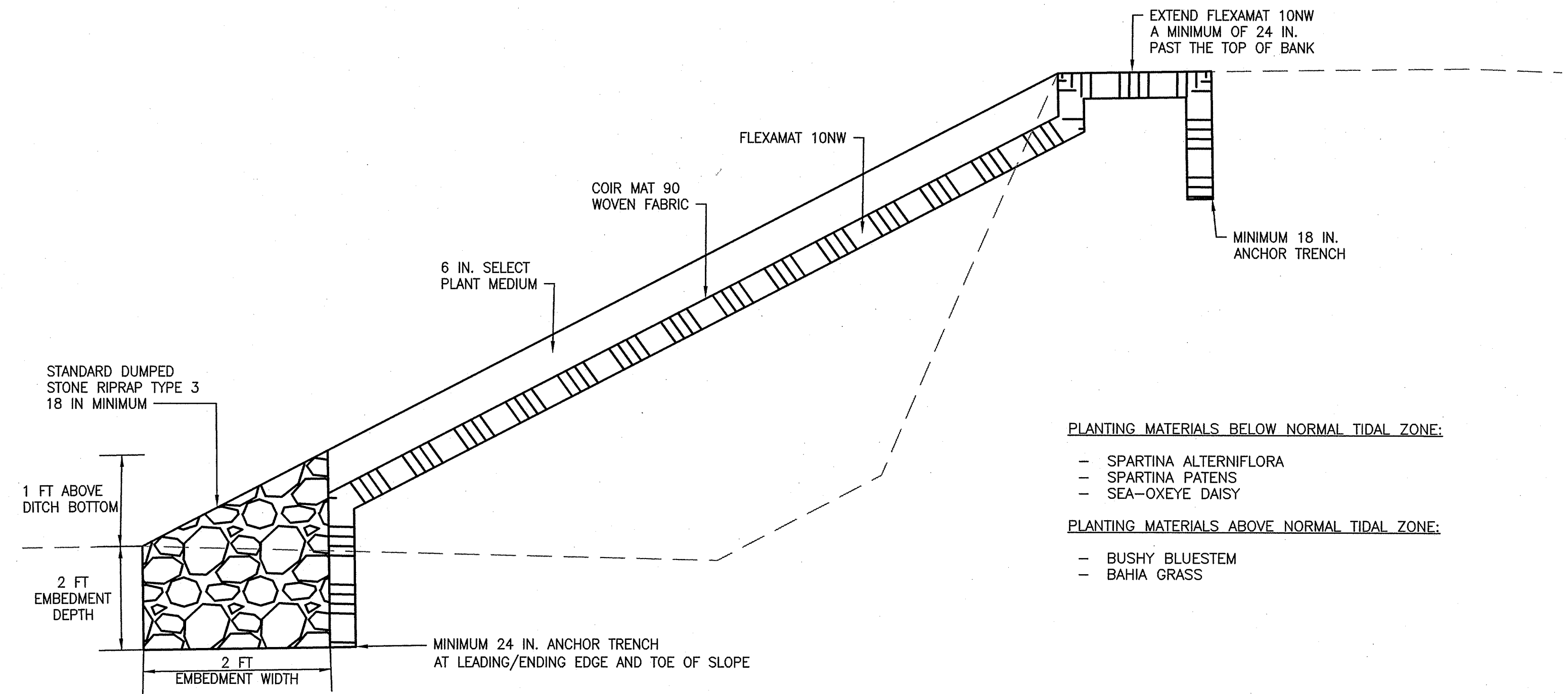

- PLANTING MATERIALS BELOW NORMAL TIDAL ZONE:
- SPARTINA ALTERNIFLORA
  - SPARTINA PATENS
  - SEA-OXEYE DAISY
- PLANTING MATERIALS ABOVE NORMAL TIDAL ZONE:
- BUSHY BLUESTEM
  - BAHIA GRASS

TYPICAL SECTION : BANK STABILIZATION TREATMENT

SCALE: N.T.S.

ISSUE SEQUENCE		
NO.	DATE	DESCRIPTION
0	10/02/2024	FOR PERMIT SET

© Copyright 2024 GWES, LLC.  
(all rights reserved)

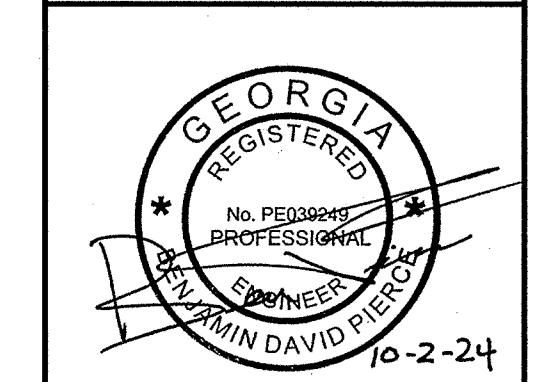

GSWCC LEVEL II CERTIFICATION #84108  
EXPIRATION DATE: 4-23-2027

**GWES**  
CIVIL • ENVIRONMENTAL • TRANSPORTATION  
ENGINEERING  
511 BLOUCESTER ST, BRUNSWICK, GA 31520

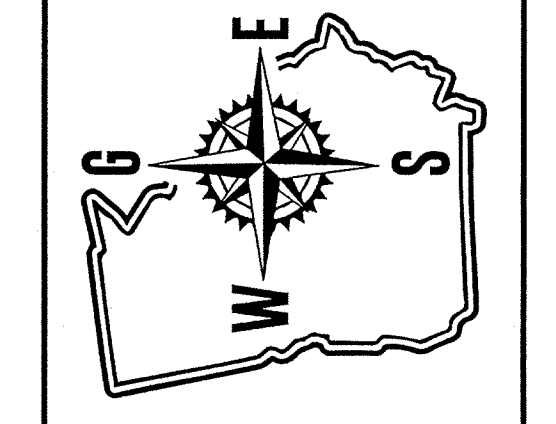

IMPROVING RESILIENCE IN  
WEST BRUNSWICK  
FOR  
CITY OF BRUNSWICK

PROJECT NO.:	092.04.3.22
DESIGNED:	B.D.P.
CHECKED:	M.W.T.
APPROVED:	B.D.P.
DATE:	MAY 17, 2024

MISCELLANEOUS DETAILS

SCALE: AS SHOWN

DRAWING NO.

**C-4**  
SHEET: 4 OF 4

2024/05/03 10:52 AM Improving Resiliency in West Brunswick.dwg Exhibits/Drawings/20240503\_01.dwg