

Z:\27691\27691.0074\ENGINEERING\DRAWINGS\PERMIT\DRAWINGS\27691.0074 01 VICINITY MAP.DWG - Dec 12, 2022 - 1:22 PM

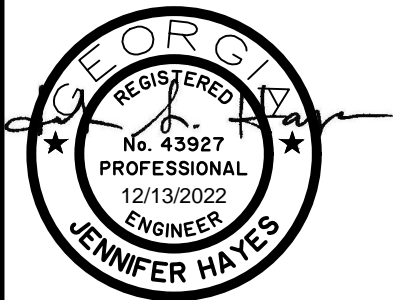

### GRAPHIC SCALE

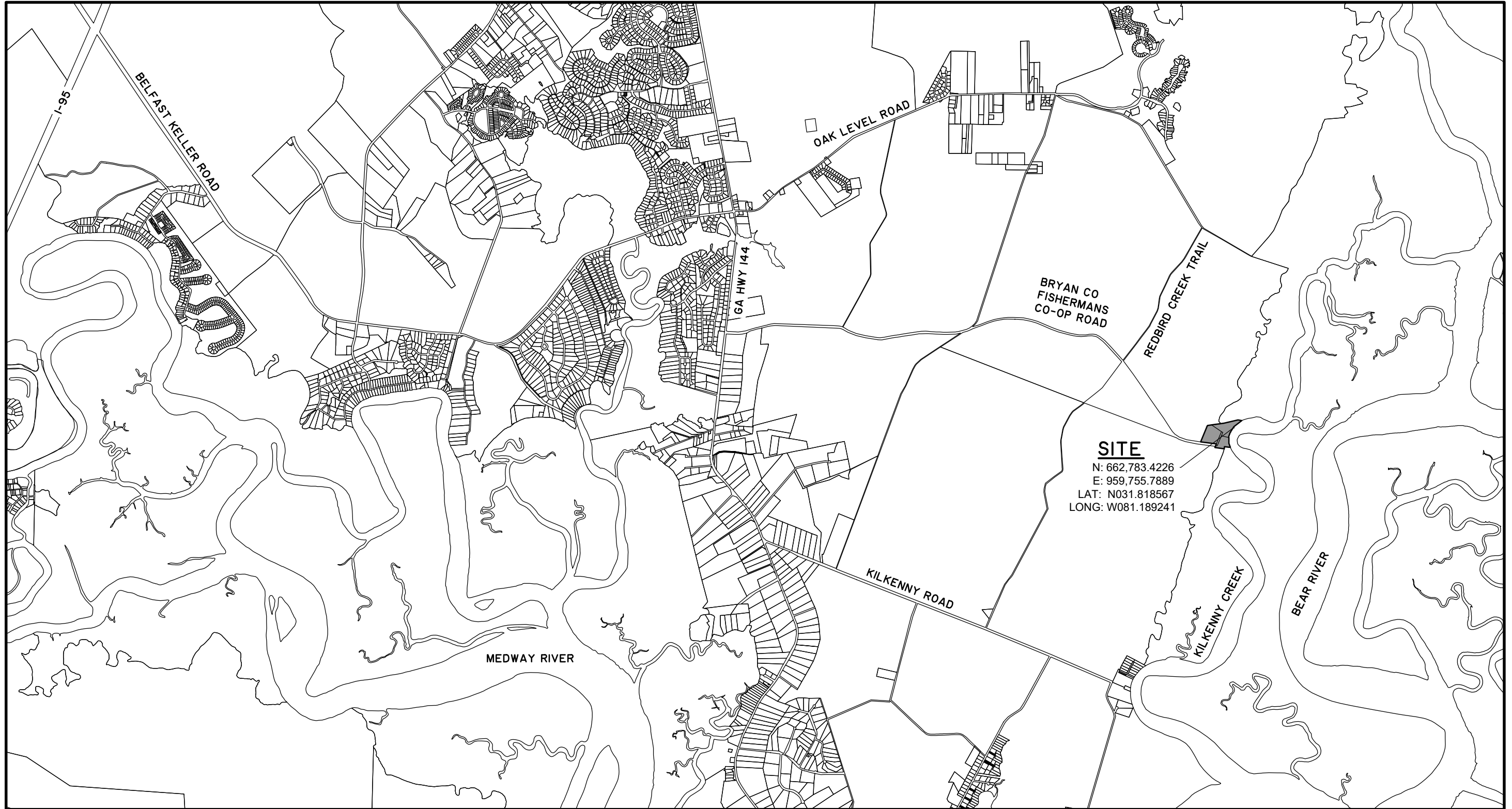
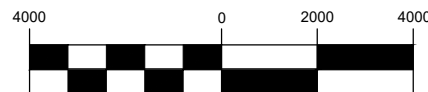

( IN FEET )  
1 inch = 4000ft.

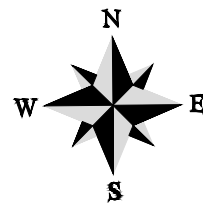

### FISHERMANS CO-OP RECREATION AREA

SHEET:  
VICINITY MAP

CLIENT:  
DEVELOPMENT AUTHORITY OF BRYAN COUNTY

LOCATION: BRYAN COUNTY, GA  
DATE: 12/12/22  
JOB NUMBER: J-27691.0074  
DRAWN BY: RAS  
REVIEWED BY: JAH  
SHEET: 1  
SCALE: 1" = 4000'





50 Park of Commerce Way  
Savannah, GA 31405 • 912.234.5300

[www.thomasandhutton.com](http://www.thomasandhutton.com)





Z:\27691\27691.0074\_ENGINEERING\DRAWINGS\PERMIT\DRAWINGS\27691.0074 01 LEGEND SHEET.DWG - Dec 12, 2022 - 2:30 PM

LEGEND

PROJECT AREA

|   |  |           |
|---|--|-----------|
|  | JURISDICTIONAL SALT MARSH & SALTWATER              | 7.53 AC.  |
|   | - TOTAL AREA WITHIN 50' SALT MARSH BUFFER          | 6.72 AC.  |
|   | - TOTAL IMPACTED AREA WITHIN 50' SALT MARSH BUFFER | 2.19 AC.  |
|  | JURISDICTIONAL FRESHWATER WETLANDS                 | 2.84 AC.  |
|   | TOTAL PROJECT WETLAND AREA                         | 10.37 AC. |
|   | TOTAL PROJECT UPLAND AREA                          | 12.31 AC. |
|   | TOTAL PROJECT AREA                                 | 22.68 AC. |

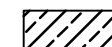
PROJECT IMPACTS

|   | IMPACT AREA:             | IMPACT VOLUME:                        |
|---|--------------------------|---------------------------------------|
|  PERMANENT SALT MARSH IMPACTS                | 0.17 AC. (7,569 SQ. FT.) | 73 CU. YD. (FILL) / 169 CU. YD. (CUT) |
|  PERMANENT OPEN WATER IMPACT                 | 0.16 AC. (6,929 SQ. FT.) | 56 CU. YD. (FILL) / 156 CU. YD. (CUT) |
|  TEMPORARY CONSTRUCTION SALTWATER IMPACT     | 0.09 AC. (3,850 SQ. FT.) |                                       |
|  BOARDWALK SALT MARSH INSTALL COVERAGE       | 0.14 AC. (6,274 SQ. FT.) |                                       |
|  BOARDWALK FRESHWATER MARSH INSTALL COVERAGE | 0.07 AC. (3,252 SQ. FT.) |                                       |

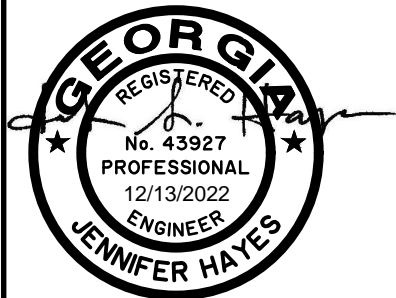

FISHERMANS CO-OP RECREATION AREA

SHEET:  
PROJECT IMPACTS  
CLIENT:  
DEVELOPMENT AUTHORITY OF BRYAN COUNTY  
LOCATION: BRYAN COUNTY, GA  
DATE: 12/12/22  
JOB NUMBER: J-27691.0074  
DRAWN BY: RAS  
REVIEWED BY: JAH  
SHEET: 2  
SCALE: NTS



50 Park of Commerce Way  
Savannah, GA 31405 • 912.234.5300

www.thomasandhutton.com

Z:\27691\27691.0074\ENGINEERING\DRAWINGS\PERMIT\DRAWINGS\27691.0074 02 EXISTING CONDITIONS.DWG - Dec 12, 2022 - 1:22 PM

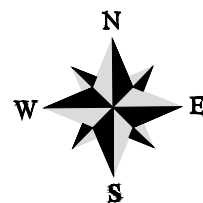
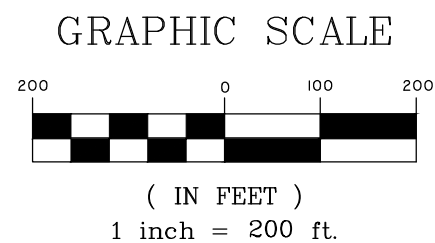
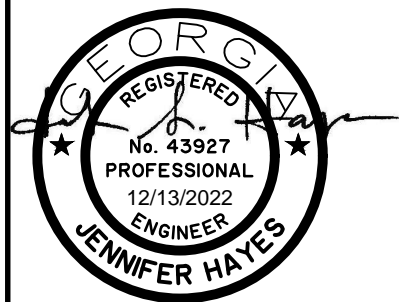
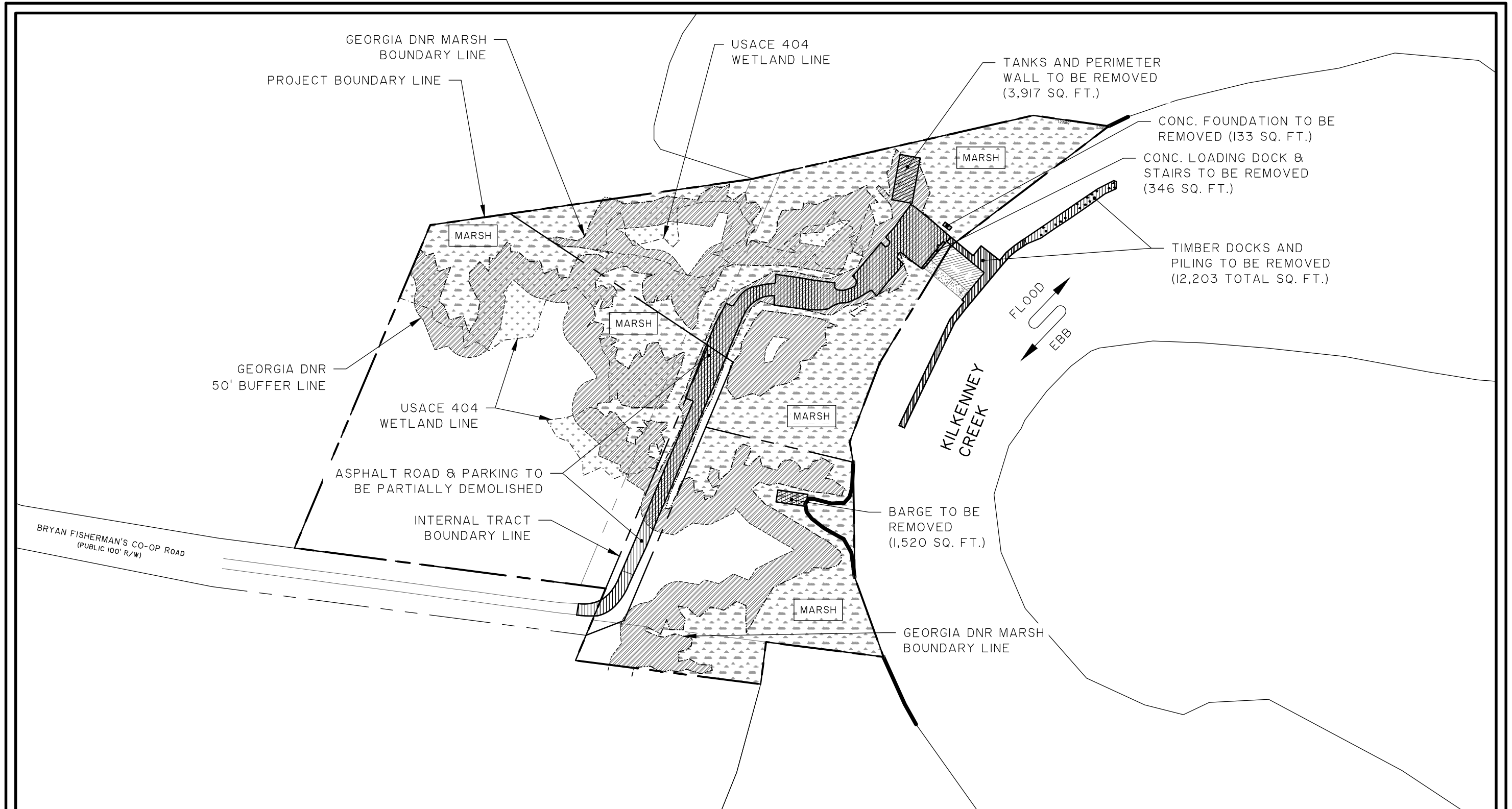

## FISHERMANS CO-OP RECREATION AREA

SHEET:  
EXISTING CONDITIONS AND DEMOLITION

CLIENT:  
DEVELOPMENT AUTHORITY OF BRYAN COUNTY

LOCATION: BRYAN COUNTY, GA  
DATE: 12/12/22  
JOB NUMBER: J-27691.0074  
DRAWN BY: RAS  
REVIEWED BY: JAH  
SHEET: 3  
SCALE: 1" = 200'



50 Park of Commerce Way  
Savannah, GA 31405 • 912.234.5300

[www.thomasandhutton.com](http://www.thomasandhutton.com)

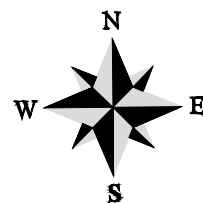
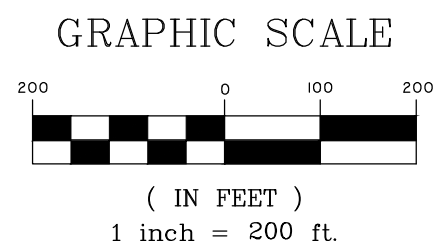
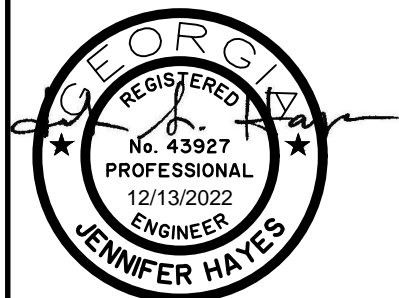

SHEET:  
OVERALL PLAN

CLIENT:  
DEVELOPMENT AUTHORITY OF BRYAN COUNTY

LOCATION: BRYAN COUNTY, GA  
DATE: 12/12/22 DRAWN BY: RAS SHEET: 4  
JOB NUMBER: J-27691.0074 REVIEWED BY: JAH SCALE: 1" = 200'



50 Park of Commerce Way  
Savannah, GA 31405 • 912.234.5300

www.thomasandhutton.com

Z:\27691\27691.0074\ENGINEERING\DRAWINGS\PERMIT\DRAWINGS\27691.0074 04 SITE PLANS.DWG - Dec 12, 2022 - 1:22 PM

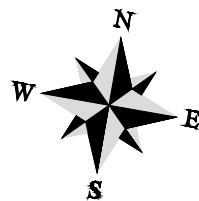
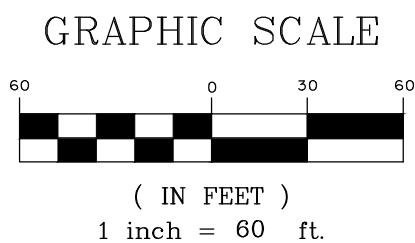
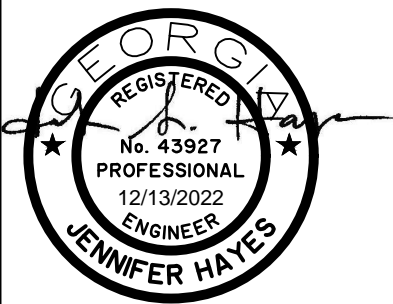
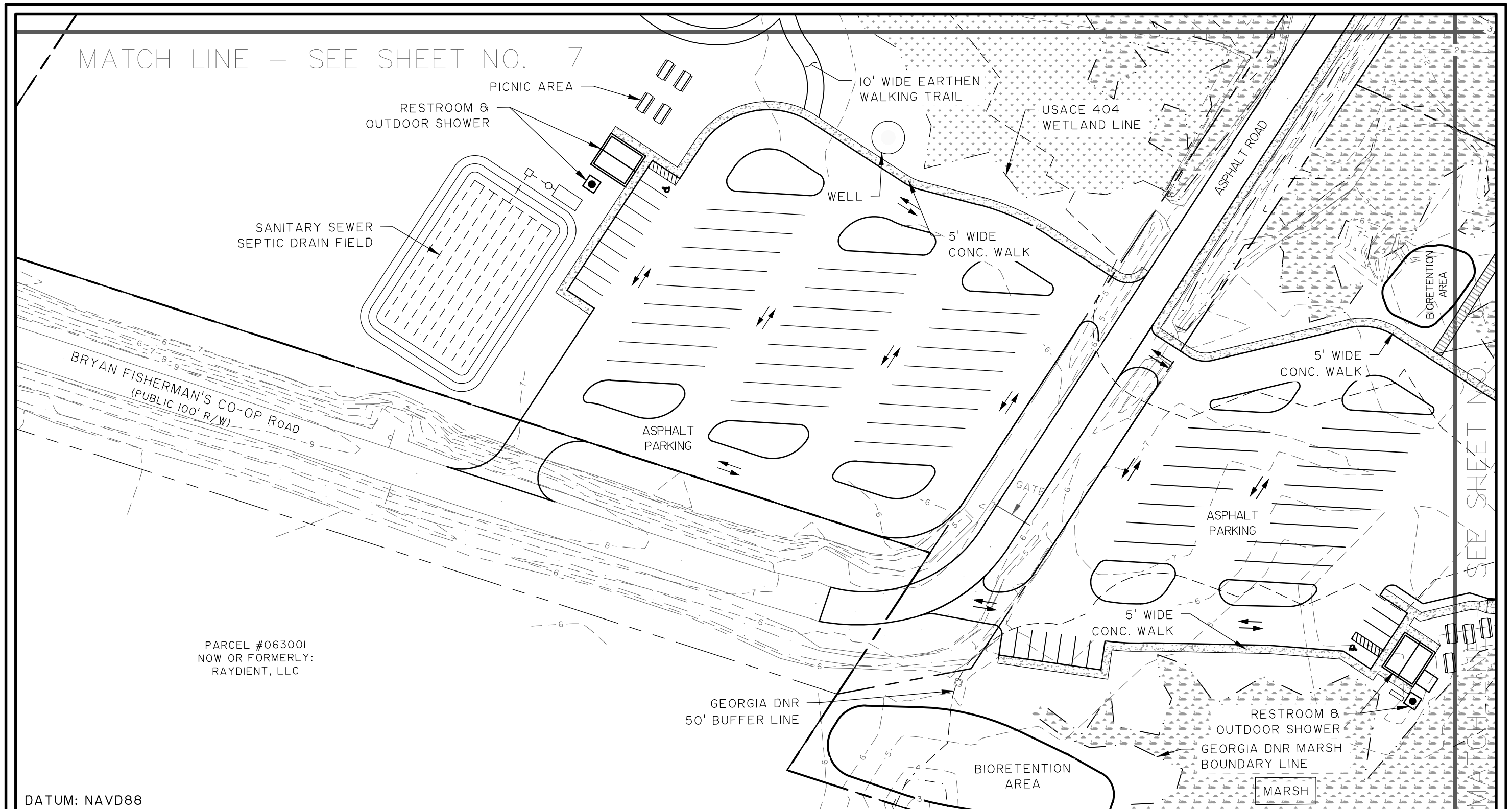

## FISHERMANS CO-OP RECREATION AREA

SHEET:  
PARTIAL SITE PLAN

CLIENT:  
DEVELOPMENT AUTHORITY OF BRYAN COUNTY

LOCATION: BRYAN COUNTY, GA

DATE: 12/12/22

DRAWN BY: RAS

SHEET: 5

JOB NUMBER: J-27691.0074

REVIEWED BY: JAH

SCALE: 1" = 60'



50 Park of Commerce Way  
Savannah, GA 31405 • 912.234.5300

[www.thomasandhutton.com](http://www.thomasandhutton.com)

The image contains three elements: a professional engineer's seal for Jennifer Hayes, a graphic scale, and a north arrow. The seal is circular with "GEORGIA" at the top and "JENNIFER HAYES" at the bottom. Inside the seal, it says "REGISTERED PROFESSIONAL ENGINEER", "No. 43927", and "12/13/2022". A signature is written across the seal. To the right of the seal is a "GRAPHIC SCALE" showing a bar divided into segments, with markings for 60, 0, 30, and 60 feet. Below the scale, it says "( IN FEET )" and "1 inch = 60 ft.". To the right of the scale is a north arrow pointing towards the top right, with "N", "S", "E", and "W" labels.

www.thomasandhutton.com

SCALE: 1" = 60'



Z:\27691\27691.0074\ENGINEERING\DRAWINGS\PERMIT\DRAWINGS\27691.0074 04 SITE PLANS.DWG - Dec 12, 2022 - 1:22 PM

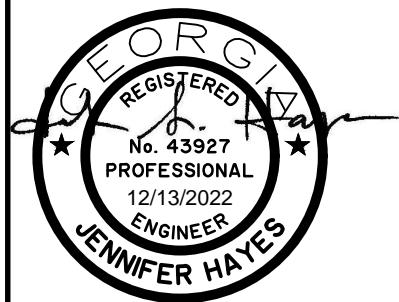
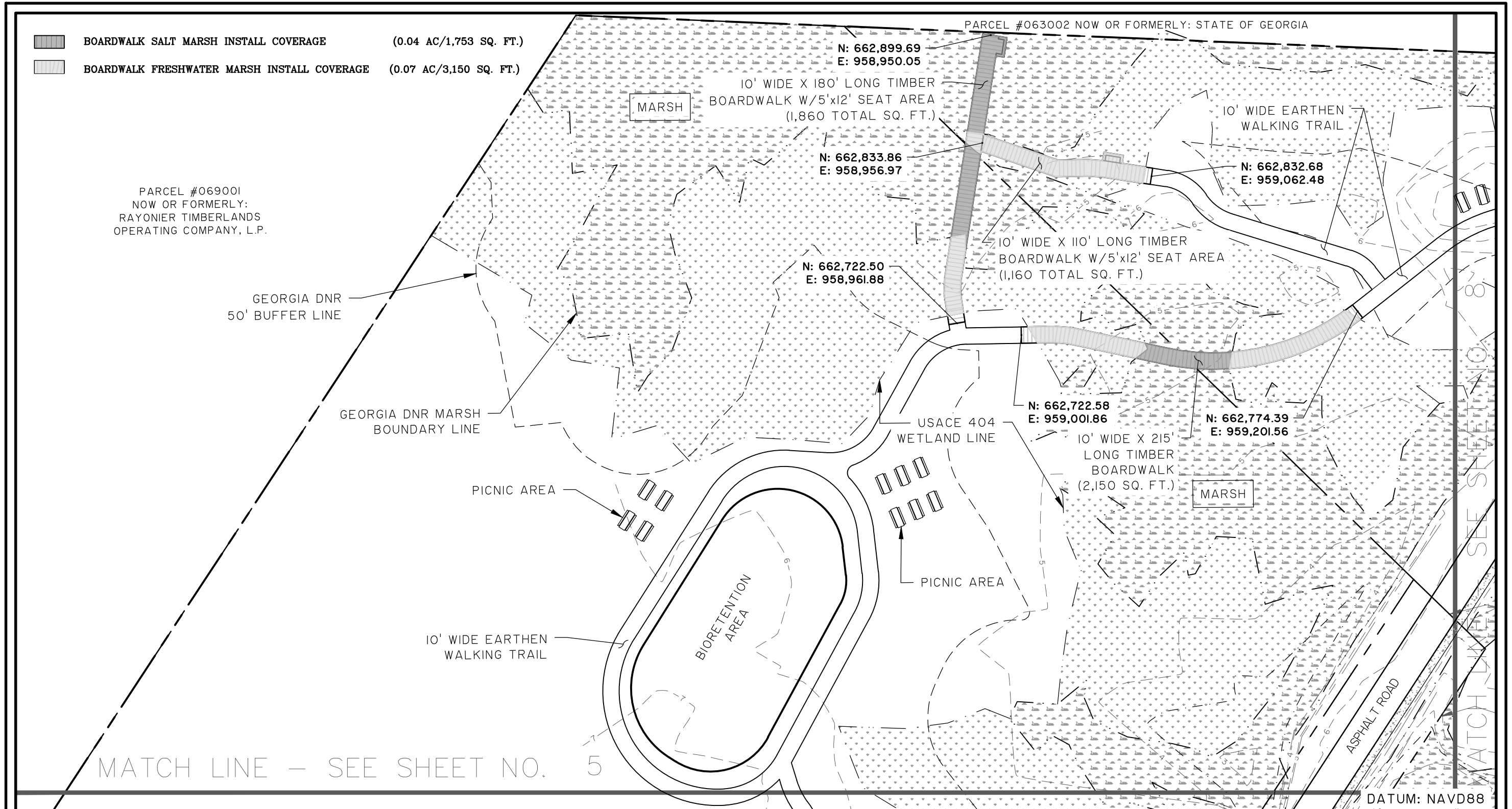

GRAPHIC SCALE

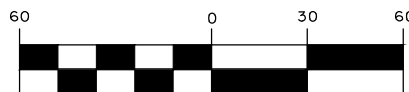

( IN FEET )  
1 inch = 60 ft.

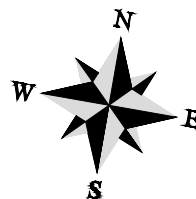

## FISHERMANS CO-OP RECREATION AREA

SHEET:  
PARTIAL SITE PLAN

CLIENT:  
DEVELOPMENT AUTHORITY OF BRYAN COUNTY

LOCATION: BRYAN COUNTY, GA  
DATE: 12/12/22  
JOB NUMBER: J-27691.0074

DRAWN BY: RAS  
REVIEWED BY: JAH

SHEET: 7  
SCALE: 1" = 60'

**THOMAS  
&  
HUTTON**

50 Park of Commerce Way  
Savannah, GA 31405 • 912.234.5300

[www.thomasandhutton.com](http://www.thomasandhutton.com)

Z:\27691\27691.0074\ENGINEERING\DRAWINGS\PERMIT\DRAWINGS\27691.0074 04 SITE PLANS.DWG - Dec 12, 2022 - 1:22 PM

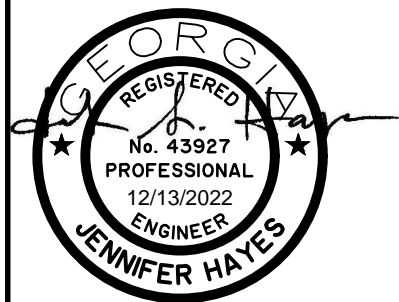
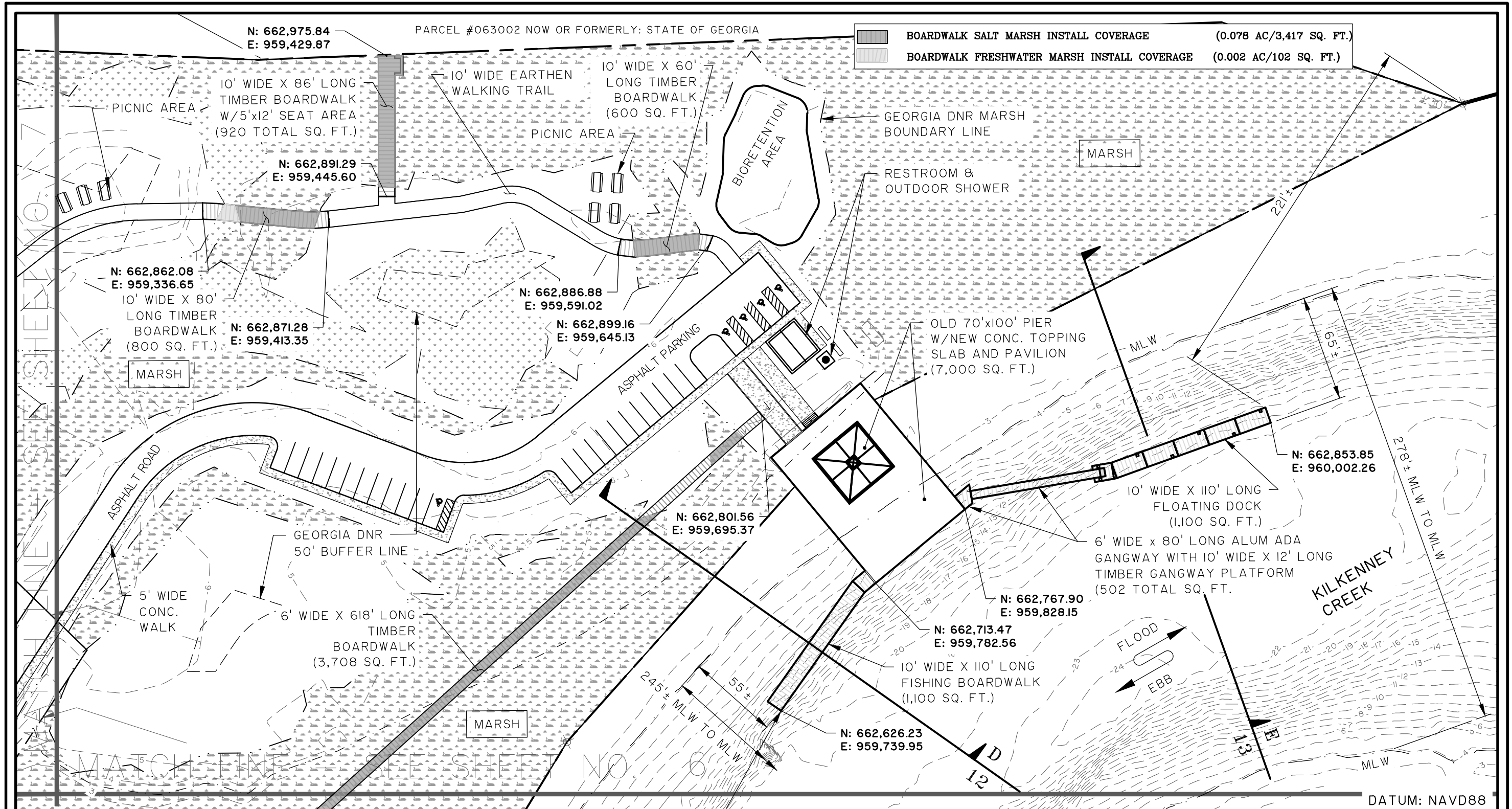

GRAPHIC SCALE

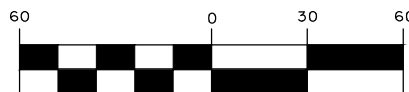

( IN FEET )  
1 inch = 60 ft.

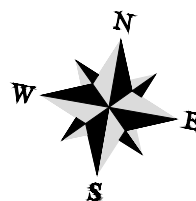

## FISHERMANS CO-OP RECREATION AREA

SHEET:  
PARTIAL SITE PLAN

CLIENT:  
DEVELOPMENT AUTHORITY OF BRYAN COUNTY

LOCATION: BRYAN COUNTY, GA

DATE: 12/12/22

JOB NUMBER: J-27691.0074

DRAWN BY: RAS

REVIEWED BY: JAH

SHEET: 8

SCALE: 1" = 60'

**THOMAS  
&  
HUTTON**

50 Park of Commerce Way  
Savannah, GA 31405 • 912.234.5300

www.thomasandhutton.com



Z:\27691\27691.0074\ENGINEERING\DRAWINGS\PERMIT\DRAWINGS\27691.0074 08 RIVER SECTIONS.DWG - Dec 12, 2022 - 1:22 PM

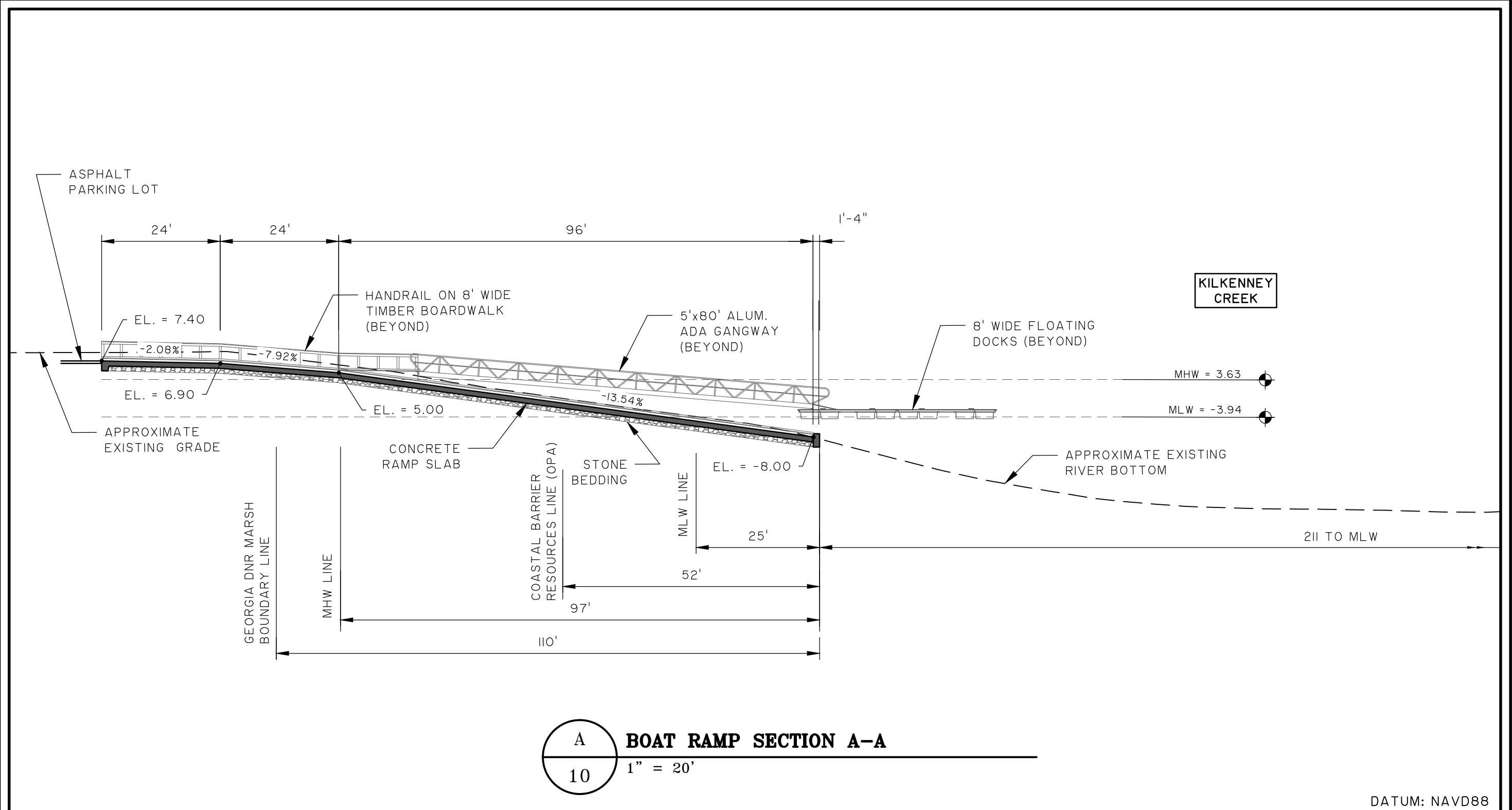



GRAPHIC SCALE

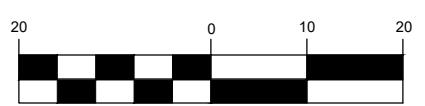

( IN FEET )

1 inch = 20 ft.

**FISHERMANS CO-OP RECREATION AREA**

SHEET: BOAT RAMP SECTION A-A

CLIENT: DEVELOPMENT AUTHORITY OF BRYAN COUNTY

LOCATION: BRYAN COUNTY, GA

DATE: 12/12/22 DRAWN BY: RAS SHEET: 9

JOB NUMBER: J-27691.0074 REVIEWED BY: JAH SCALE: 1" = 20'



**THOMAS & HUTTON**

50 Park of Commerce Way  
Savannah, GA 31405 • 912.234.5300

[www.thomasandhutton.com](http://www.thomasandhutton.com)

Z:\27691\27691.0074\ENGINEERING\DRAWINGS\PERMIT\DRAWINGS\27691.0074 08 RIVER SECTIONS 2.DWG - Dec 12, 2022 - 1:22 PM

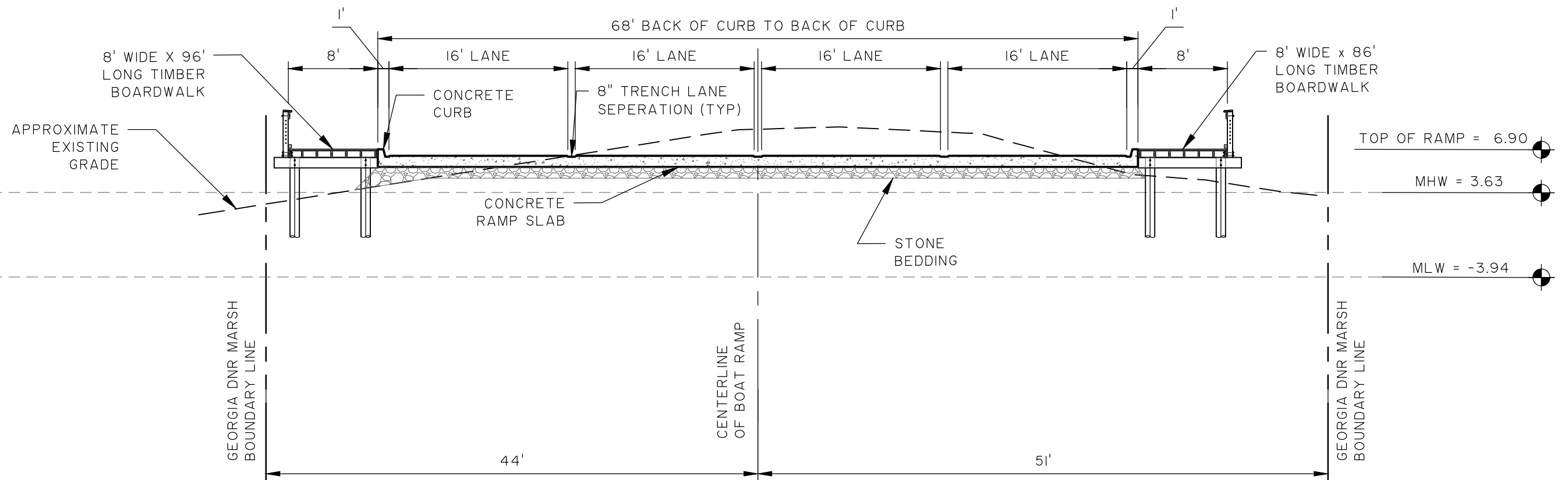

**BOAT RAMP SECTION B-B**  
1" = 10'

DATUM: NAVD88

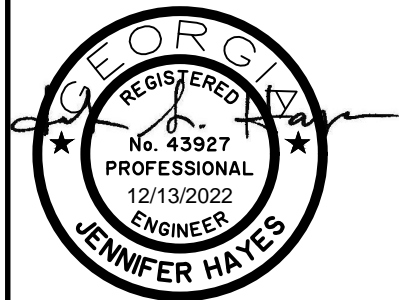

GRAPHIC SCALE

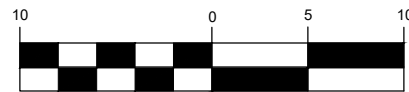

( IN FEET )  
1 inch = 10 ft.

### FISHERMANS CO-OP RECREATION AREA

SHEET:  
BOAT RAMP SECTION B-B  
CLIENT:  
DEVELOPMENT AUTHORITY OF BRYAN COUNTY  
LOCATION: BRYAN COUNTY, GA  
DATE: 12/12/22 DRAWN BY: RAS SHEET: 10  
JOB NUMBER: J-27691.0074 REVIEWED BY: JAH SCALE: 1" = 10'

**THOMAS  
&  
HUTTON**

50 Park of Commerce Way  
Savannah, GA 31405 • 912.234.5300

[www.thomasandhutton.com](http://www.thomasandhutton.com)

Z:\27691\27691.0074\ENGINEERING\DRAWINGS\PERMIT\DRAWINGS\27691.0074 08 RIVER SECTIONS 2.DWG - Dec 12, 2022 - 1:22 PM

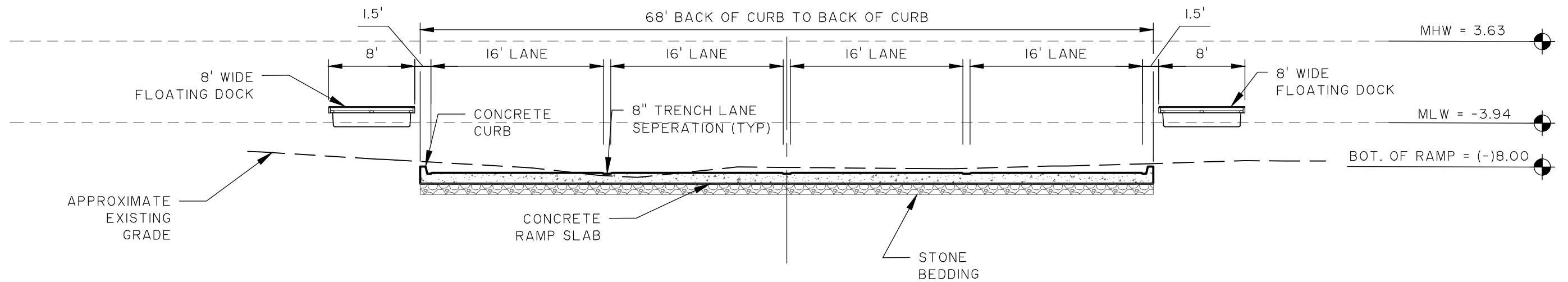

C  
10

**BOAT RAMP SECTION C-C**

1" = 10'

DATUM: NGVD88

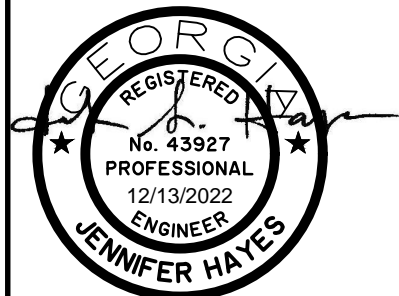

GRAPHIC SCALE

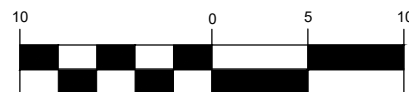

( IN FEET )  
1 inch = 10 ft.

### FISHERMANS CO-OP RECREATION AREA

SHEET:

BOAT RAMP SECTION C-C

CLIENT:

DEVELOPMENT AUTHORITY OF BRYAN COUNTY

LOCATION: BRYAN COUNTY, GA

DATE: 12/12/22

DRAWN BY: RAS

SHEET: 11

JOB NUMBER: J-27691.0074

REVIEWED BY: JAH

SCALE: 1" = 10'

**THOMAS  
&  
HUTTON**

50 Park of Commerce Way  
Savannah, GA 31405 • 912.234.5300

[www.thomasandhutton.com](http://www.thomasandhutton.com)

Z:\27691\27691.0074\ENGINEERING\DRAWINGS\PERMIT\DRAWINGS\27691.0074 08 RIVER SECTIONS DWG - Dec 12, 2022 - 1:22 PM

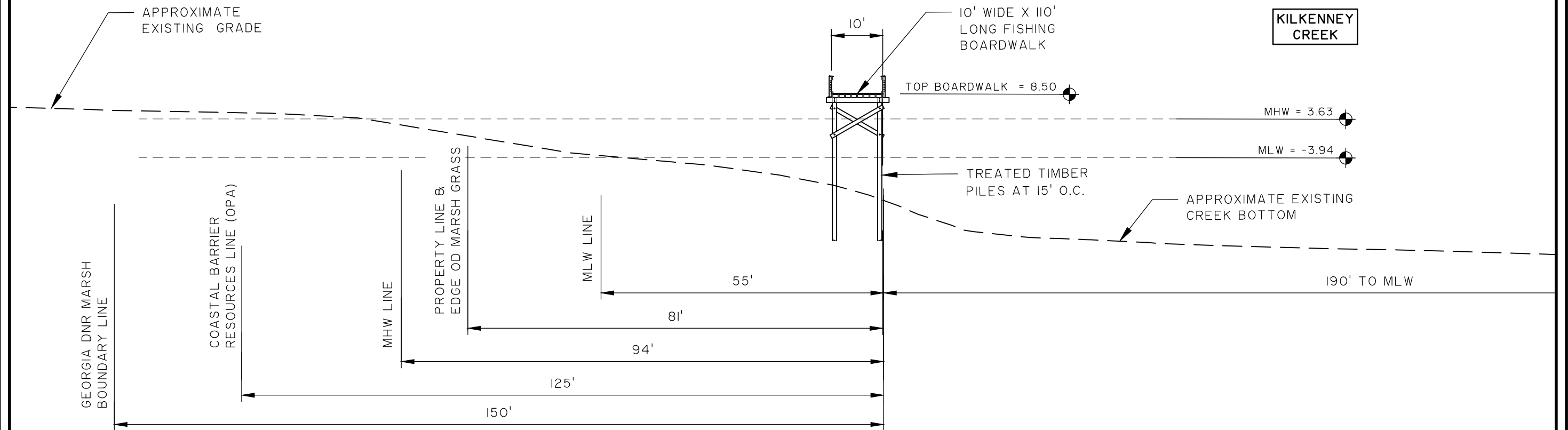

**FISHING BOARDWALK SECTION D-D**  
1" = 20'

DATUM: NAVD88

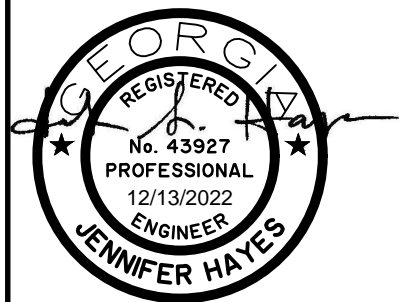

GRAPHIC SCALE

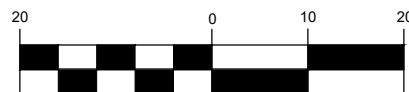

( IN FEET )  
1 inch = 20 ft.

### FISHERMANS CO-OP RECREATION AREA

SHEET:  
FISHING BOARDWALK SECTION D-D  
CLIENT:  
DEVELOPMENT AUTHORITY OF BRYAN COUNTY  
LOCATION: BRYAN COUNTY, GA  
DATE: 12/12/22 DRAWN BY: RAS SHEET: 12  
JOB NUMBER: J-27691.0074 REVIEWED BY: JAH SCALE: 1" = 20'



50 Park of Commerce Way  
Savannah, GA 31405 • 912.234.5300

[www.thomasandhutton.com](http://www.thomasandhutton.com)

Z:\27691\27691.0074\ENGINEERING\DRAWINGS\PERMIT\DRAWINGS\27691.0074 08 RIVER SECTIONS DWG - Dec 12, 2022 - 1:22 PM

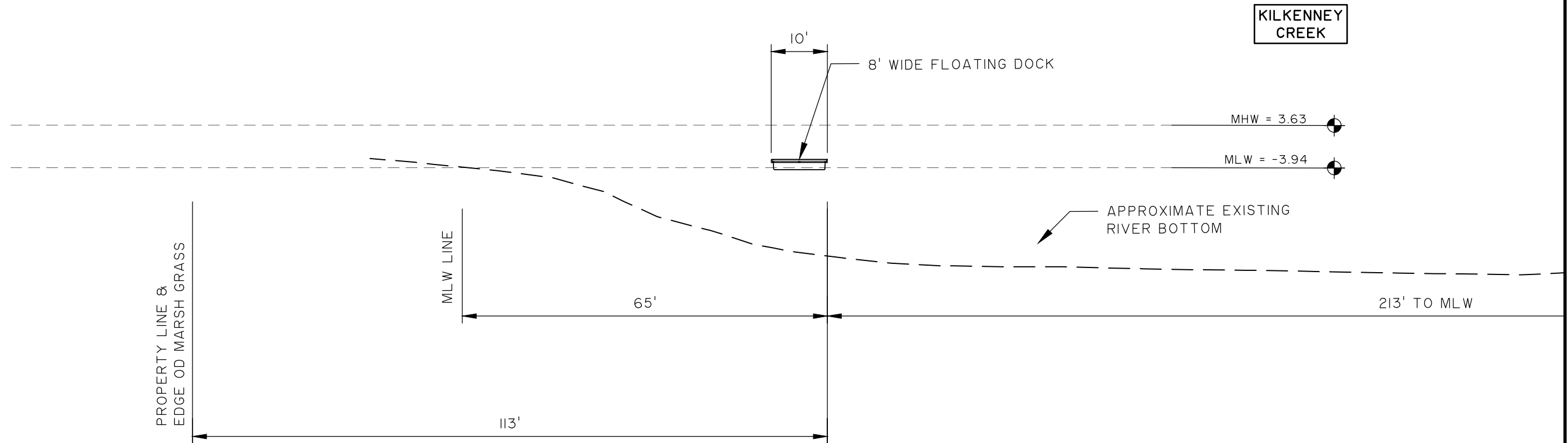

**FLOATING DOCK SECTION E-E**

1" = 20'

DATUM: NAVD88

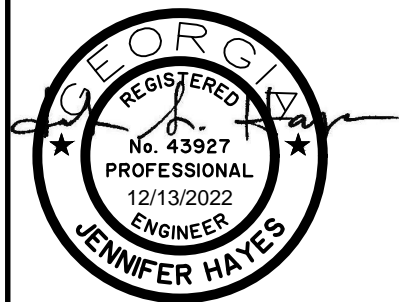

GRAPHIC SCALE



( IN FEET )  
1 inch = 20 ft.

### FISHERMANS CO-OP RECREATION AREA

SHEET:  
13 FLOATING DOCK SECTION E-E  
CLIENT:  
DEVELOPMENT AUTHORITY OF BRYAN COUNTY  
LOCATION: BRYAN COUNTY, GA  
DATE: 12/12/22 DRAWN BY: RAS SHEET: 13  
JOB NUMBER: J-27691.0074 REVIEWED BY: JAH SCALE: 1" = 20'

**THOMAS & HUTTON**

50 Park of Commerce Way  
Savannah, GA 31405 • 912.234.5300

[www.thomasandhutton.com](http://www.thomasandhutton.com)

Z:\27691\27691\_0074\ENGINEERING\DRAWINGS\PERMIT\DRAWINGS\27691.0074\_10\_BOARDWALK DETAILS.DWG - Dec 12, 2022 - 1:22 PM

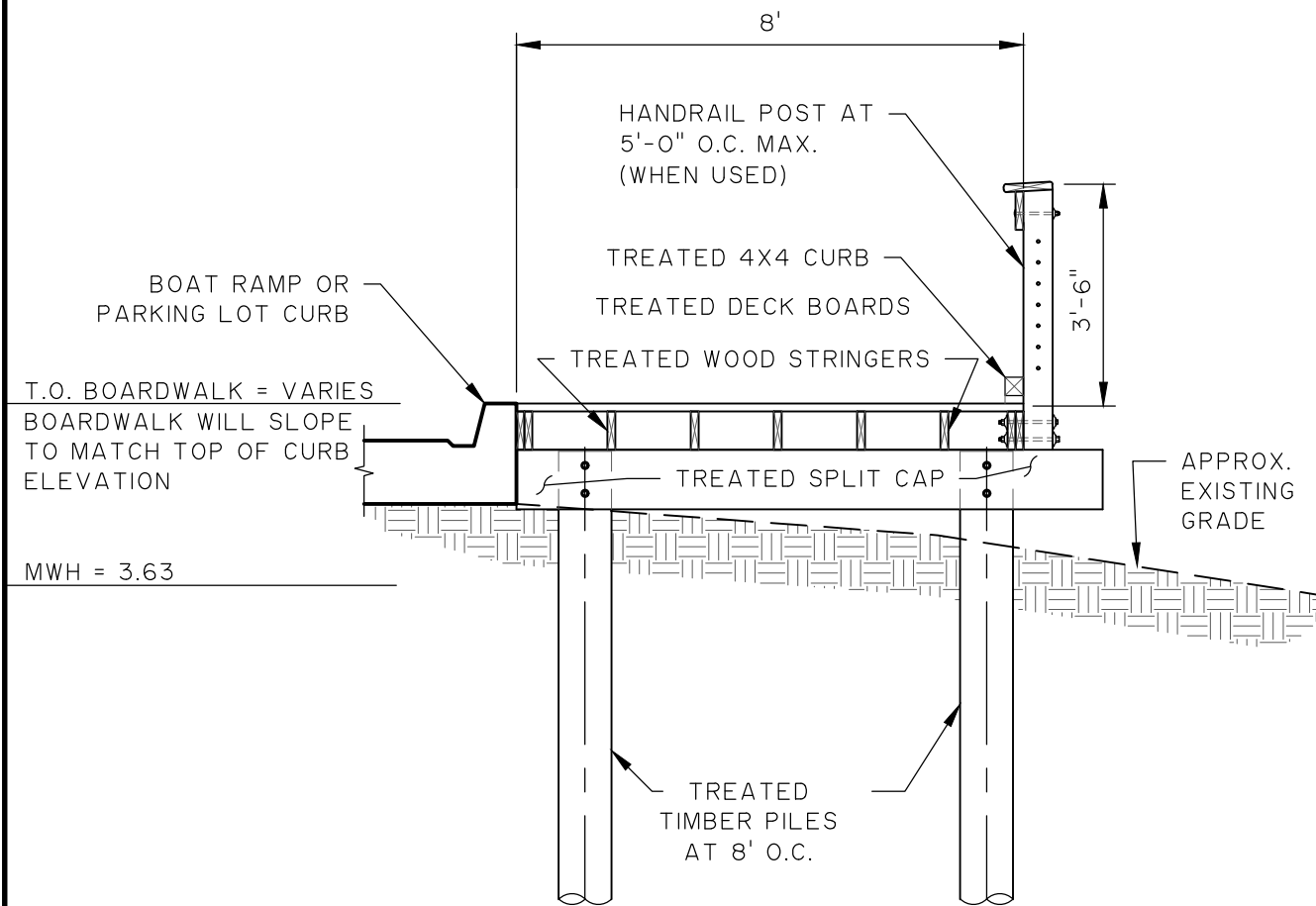

1  
10  
TYPICAL BOARDWALK SECTION AT BOAT RAMP  
1" = 3'

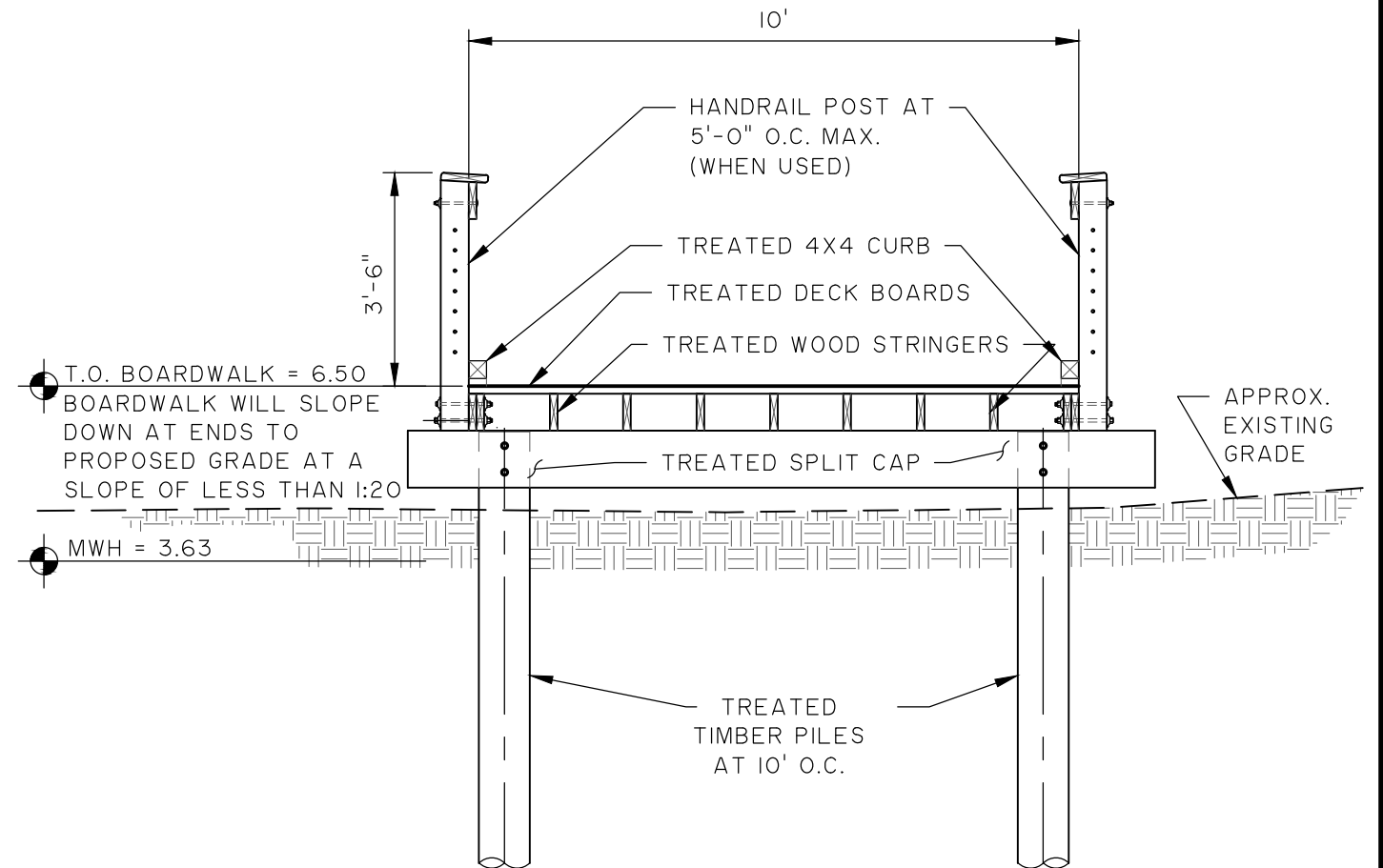

2  
10  
TYPICAL BOARDWALK SECTION AT MARSH WALK  
1" = 3'

DATUM: NAVD88

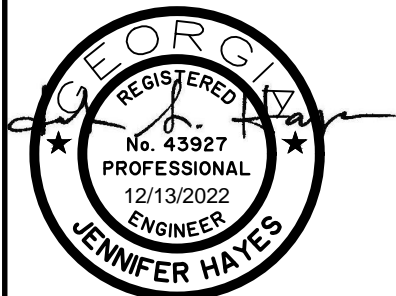

GRAPHIC SCALE

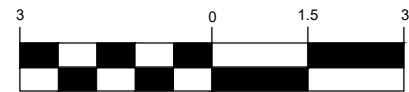

( IN FEET )  
1 inch = 3 ft.

## FISHERMANS CO-OP RECREATION AREA

SHEET:

TYPICAL BOARDWALK SECTION

CLIENT:

DEVELOPMENT AUTHORITY OF BRYAN COUNTY

LOCATION: BRYAN COUNTY, GA

DATE: 12/12/22

DRAWN BY: RAS

SHEET: 14

JOB NUMBER: J-27691.0074

REVIEWED BY: JAH

SCALE: 1" = 3'

**THOMAS  
&  
HUTTON**

50 Park of Commerce Way  
Savannah, GA 31405 • 912.234.5300

[www.thomasandhutton.com](http://www.thomasandhutton.com)



Z:\27691\27691\_0074\ENGINEERING\DRAWINGS\PERMIT\DRAWINGS\27691.0074\_10\_BOARDWALK\_DETAILS.DWG - Dec 12, 2022 - 1:22 PM

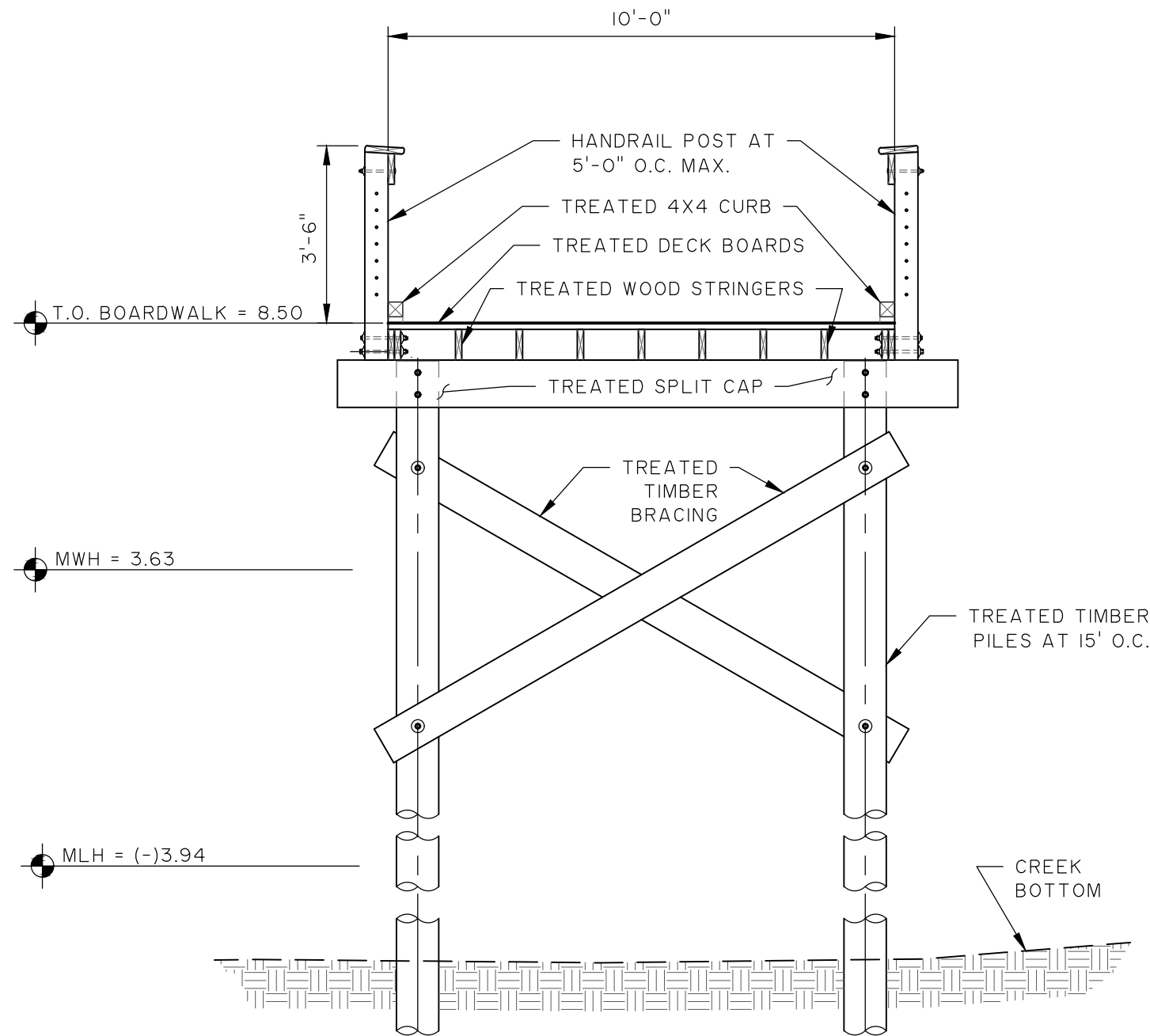

3  
11  
**TYPICAL FISHING BOARDWALK SECTION**  
1" = 3'

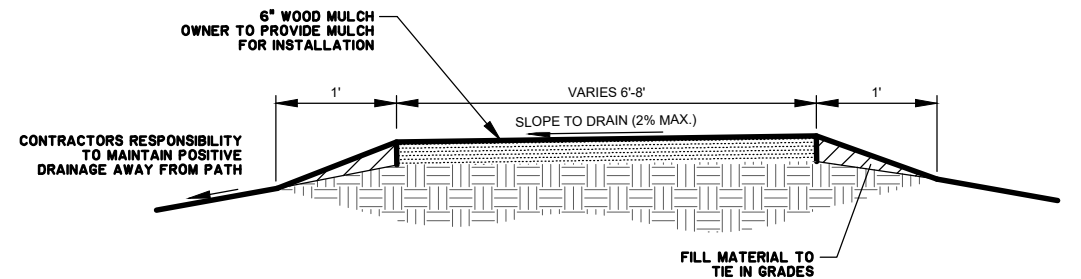

4  
11  
**TYPICAL EARTHEN TRAIL**  
1" = 3'

DATUM: NAVD88

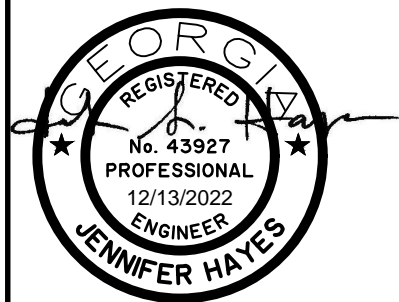

GRAPHIC SCALE



( IN FEET )  
1 inch = 3 ft.

## FISHERMANS CO-OP RECREATION AREA

SHEET:  
TYPICAL SECTIONS

CLIENT:  
DEVELOPMENT AUTHORITY OF BRYAN COUNTY

LOCATION: BRYAN COUNTY, GA  
DATE: 12/12/22  
JOB NUMBER: J-27691.0074  
DRAWN BY: RAS  
REVIEWED BY: JAH  
SHEET: 15  
SCALE: 1" = 3'

**THOMAS  
&  
HUTTON**

50 Park of Commerce Way  
Savannah, GA 31405 • 912.234.5300

www.thomasandhutton.com