



SITE DATA
 Site Address:
 Lots 358A & 359A Ward No.4
 Tybee Island, GA 31328
 PIN: 40011 09021
 Waterway: Horse Pen Creek

ROBERTS CIVIL ENGINEERING
 301 SEA ISLAND ROAD, SUITE 10
 ST. SIMONS, GA 31522
 912-638-9681 OFFICE
 912-289-0339 FAX

PREPARED FOR:
BRADLEY & KIM ELSBY

ELSBY DOCK PERMIT
 MAINTENANCE DOCK PLAN
 TYBEE ISLAND, GA

DATE: 2020-10-17
 DRAWN BY: JAF
 CHECKED BY: JDR
 SCALE: N.T.S.

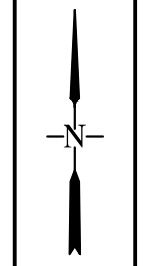

- NOTES:
1. THE DOCK PLANS SHOWN HEREIN SHALL BE USED ONLY AS AN EXHIBIT FOR DOCK PERMITTING WITH THE GEORGIA DEPARTMENT OF NATURAL RESOURCES.
 2. PLAT WAS COMPLETED BY BREWER LAND SURVEY, PROJECT #200697, FIELD DATE: 10/08/2020, PLAT DATE: 10/14/2020
 3. THE DIAGRAM IS NOT INTENDED TO BE USED FOR CONSTRUCTION DRAWINGS FOR THE DOCK.



— MLW — MLW — MEAN LOW WATER
 - - - - - EXISTING PROPERTY/WARD LINE
 - - - - - EXISTING CONTOUR
 x -1.4 EXISTING SPOT ELEVATION
 SALT MARSH
 EXISTING DOCK

SITE DATA
 Site Address:
 Lots 358A & 359A Ward No.4
 Tybee Island, GA 31328
 PIN: 40011 09021
 Waterway: Horse Pen Creek

ROBERTS CIVIL ENGINEERING
 301 SEA ISLAND ROAD, SUITE 10
 ST. SIMONS, GA 31522
 912-638-9681 OFFICE
 912-289-0339 FAX

PREPARED FOR:
 BRADLEY & KIM ELSBY

ELSBY DOCK PERMIT
 MAINTENANCE DOCK PLAN
 TYBEE ISLAND, GA

DATE: 2020-10-17
 DRAWN BY: JAF
 CHECKED BY: JDR
 SCALE: 1" = 40'

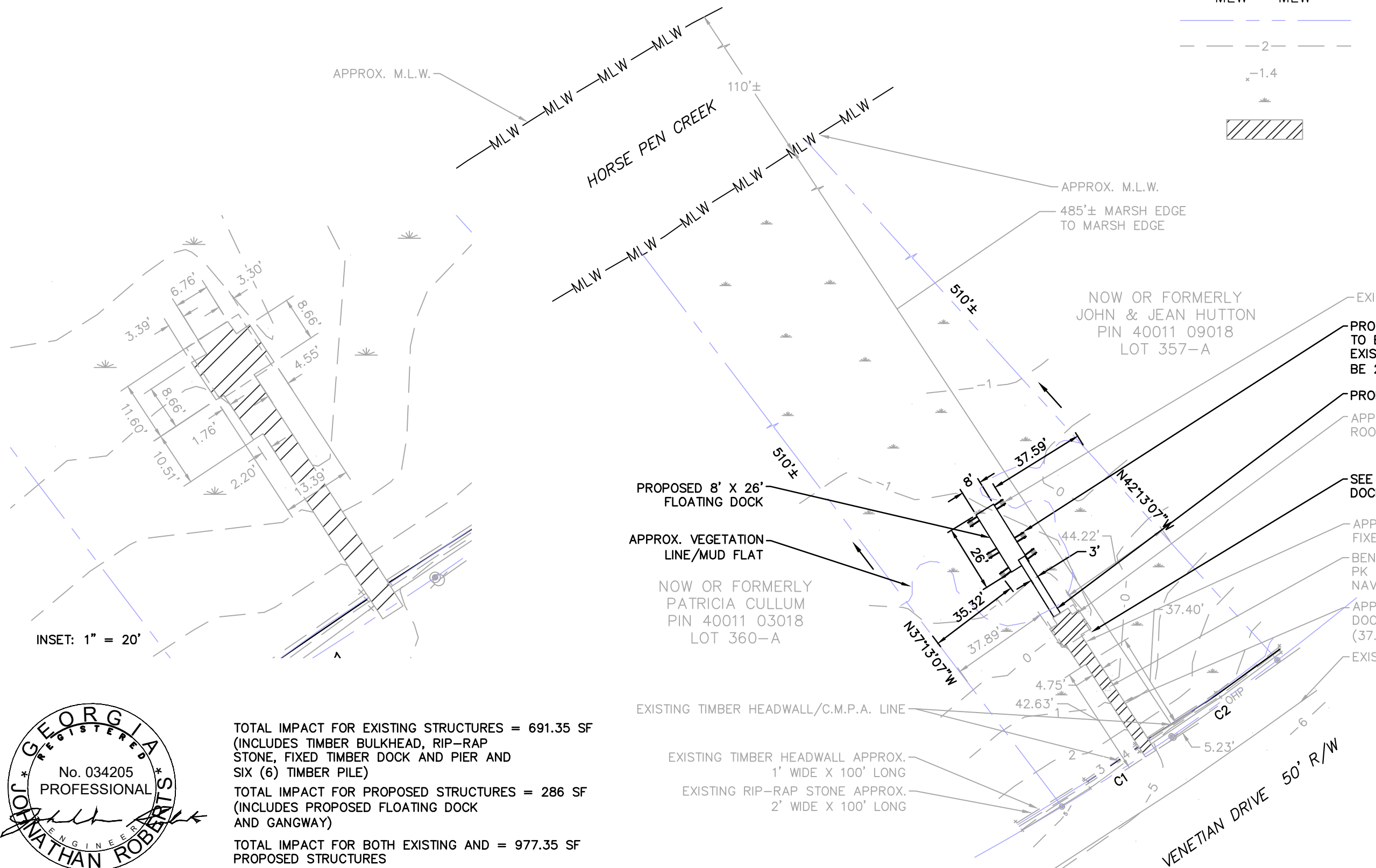
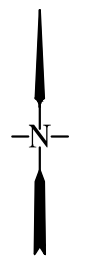

TOTAL IMPACT FOR EXISTING STRUCTURES = 691.35 SF
 (INCLUDES TIMBER BULKHEAD, RIP-RAP STONE, FIXED TIMBER DOCK AND PIER AND SIX (6) TIMBER PILE)

TOTAL IMPACT FOR PROPOSED STRUCTURES = 286 SF
 (INCLUDES PROPOSED FLOATING DOCK AND GANGWAY)

TOTAL IMPACT FOR BOTH EXISTING AND PROPOSED STRUCTURES = 977.35 SF



- NOTES:
1. THE DOCK PLANS SHOWN HEREIN SHALL BE USED ONLY AS AN EXHIBIT FOR DOCK PERMITTING WITH THE GEORGIA DEPARTMENT OF NATURAL RESOURCES.
 2. PLAT WAS COMPLETED BY BREWER LAND SURVEY, PROJECT #200697, FIELD DATE: 10/08/2020, PLAT DATE: 10/14/2020
 3. THE DIAGRAM IS NOT INTENDED TO BE USED FOR CONSTRUCTION DRAWINGS FOR THE DOCK.

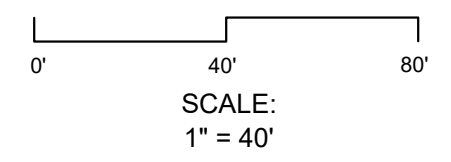

SITE DATA

Site Address:
 Lots 358A & 359A Ward No.4
 Tybee Island, GA 31328
 PIN: 40011 09021
 Waterway: Horse Pen Creek

ROBERTS CIVIL ENGINEERING
 301 SEA ISLAND ROAD, SUITE 10
 ST. SIMONS, GA 31522
 912-638-9681 OFFICE
 912-289-0339 FAX

PREPARED FOR:
BRADLEY & KIM ELSBY

ELSBY DOCK PERMIT
 MAINTENANCE DOCK PLAN
 TYBEE ISLAND, GA

DATE: 2020-10-17
 DRAWN BY: JAF
 CHECKED BY: JDR
 SCALE: 1" = 40'

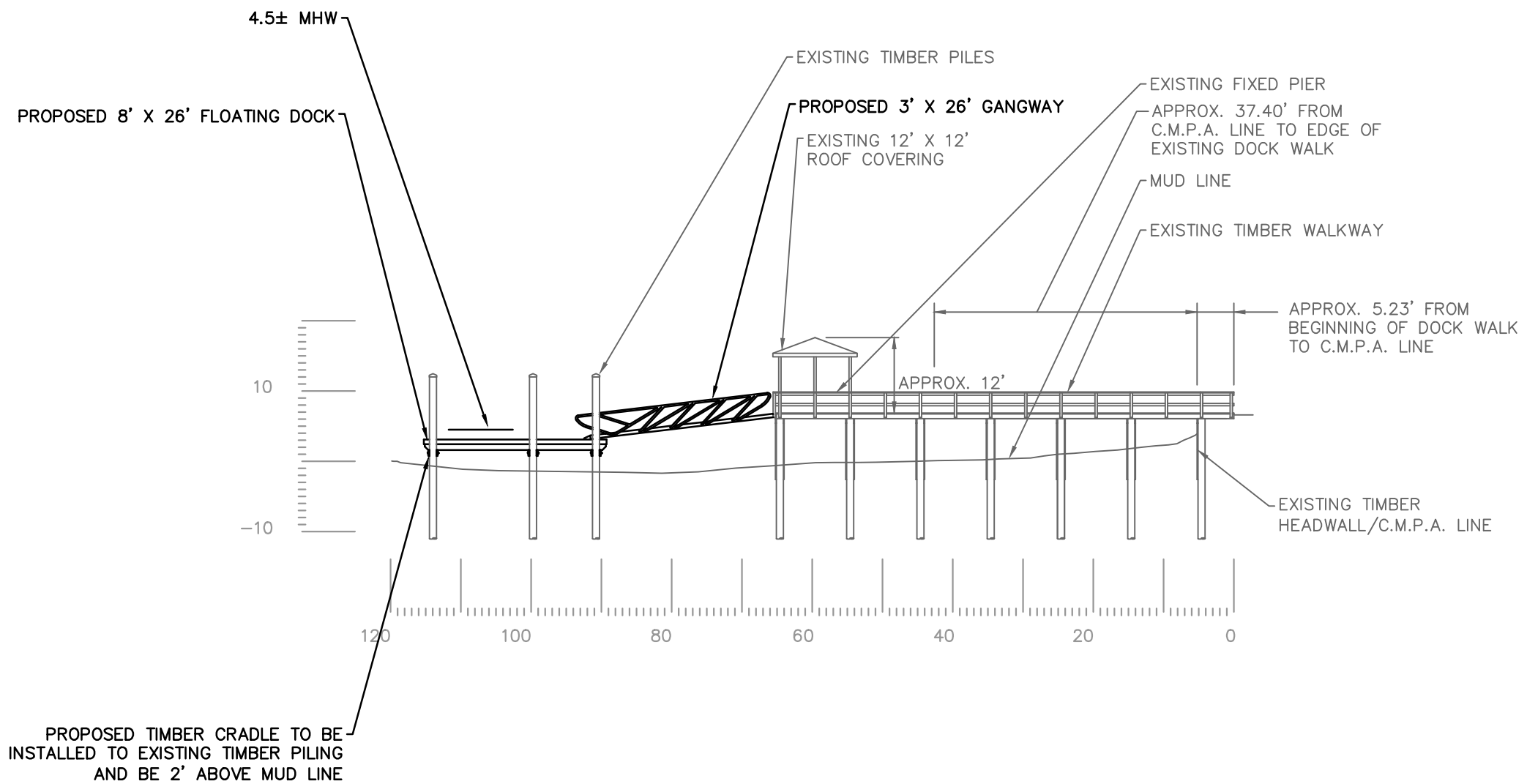
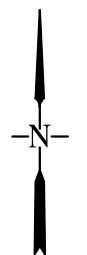

- NOTES:
1. THE DOCK PLANS SHOWN HEREIN SHALL BE USED ONLY AS AN EXHIBIT FOR DOCK PERMITTING WITH THE GEORGIA DEPARTMENT OF NATURAL RESOURCES.
 2. PLAT WAS COMPLETED BY BREWER LAND SURVEY, PROJECT #200697, FIELD DATE: 10/08/2020, PLAT DATE: 10/14/2020
 3. THE DIAGRAM IS NOT INTENDED TO BE USED FOR CONSTRUCTION DRAWINGS FOR THE DOCK.

