

O: \2024\24-5020.01 MARTHA RANDOLPH STEVENS PARK - LABARBA\DWG\24-5020C_C02 MLLW 5-29-2025.DWG

- NOTES:
1. Horizontal Datum is Georgia State Plane Coordinate System of 1985, East Zone, North American Datum of 1983 (NAD83).
 2. Vertical Datum is Mean Lower Low Water. Vertical Datum determined by adding 4.05' to North American Vertical Datum of 1988 (NAVD88). The conversion factor was obtained from Fort Pulaski Tidal Station.
 3. CMPA line was delineated by Georgia Department of Natural Resources - Coastal Resources Division. EMC Engineering Services, INC. field located the CMPA line on 4/10/2024.
 4. Property lines shown are based on Deed Book AAQ, Page 280

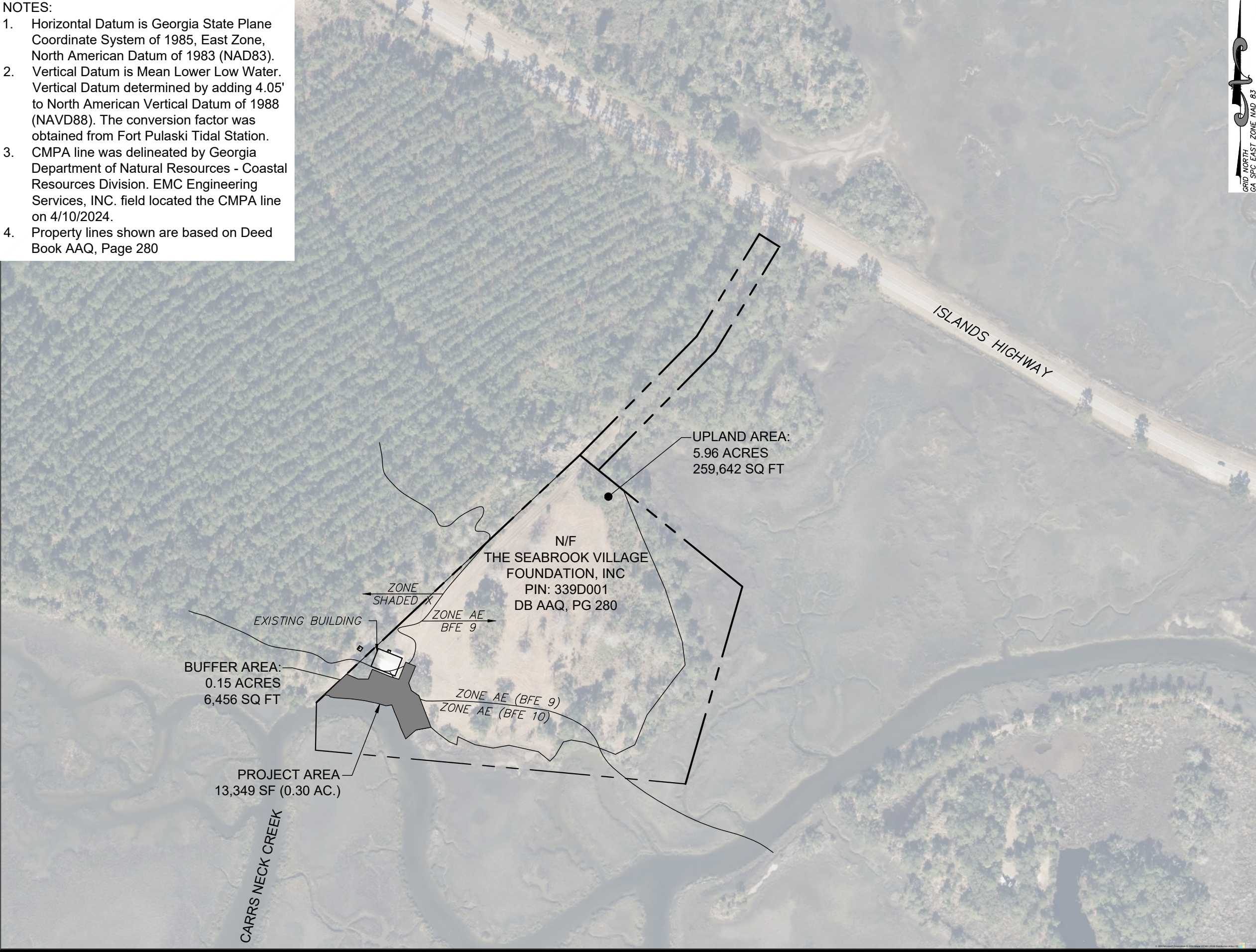

GRID NORTH
GA SFC EAST ZONE NAD 83

EMC ENGINEERING SERVICES, INC.
1111 Glynco Parkway
Bldg. #2, Suite 400
Brunswick, GA 31525
Ph: (912) 265-7636
Fax: (912) 233-4580
www.emc-eng.com

ALBANY • ATLANTA • AUGUSTA • BRUNSWICK • COLUMBUS
GREENVILLE • SAVANNAH • STATESBORO • THOMASTON

PROJECT LOCATION
MARTHA RANDOLPH STEVENS PARK
1359 G.M. DISTRICT
LIBERTY COUNTY, GEORGIA
Prepared for:
THE SEABROOK VILLAGE FOUNDATION, INC.



| | |
|--------------|-----------|
| PROJECT NO.: | 24-5020 |
| DRAWN BY: | KLC |
| DESIGNED BY: | KLC |
| SURVEYED BY: | JKL |
| SURVEY DATE: | 4/10/2024 |
| CHECKED BY: | ABM |
| SCALE: | 1" = 200' |
| DATE: | 6/2/2025 |

SHEET
1
OF 9

O:\2024\24-5020.01 MARTHA RANDOLPH STEVENS PARK - LABARBA\DWG\24-5020C_C02 MLLW 5-29-2025.DWG

- NOTES:
- Horizontal Datum is Georgia State Plane Coordinate System of 1985, East Zone, North American Datum of 1983 (NAD83).
 - Vertical Datum is Mean Lower Low Water. Vertical Datum determined by adding 4.05' to North American Vertical Datum of 1988 (NAVD88). The conversion factor was obtained from Fort Pulaski Tidal Station.
 - CMPA line was delineated by Georgia Department of Natural Resources - Coastal Resources Division. EMC Engineering Services, INC. field located the CMPA line on 4/10/2024.
 - Property lines shown are based on Deed Book AAQ, Page 280

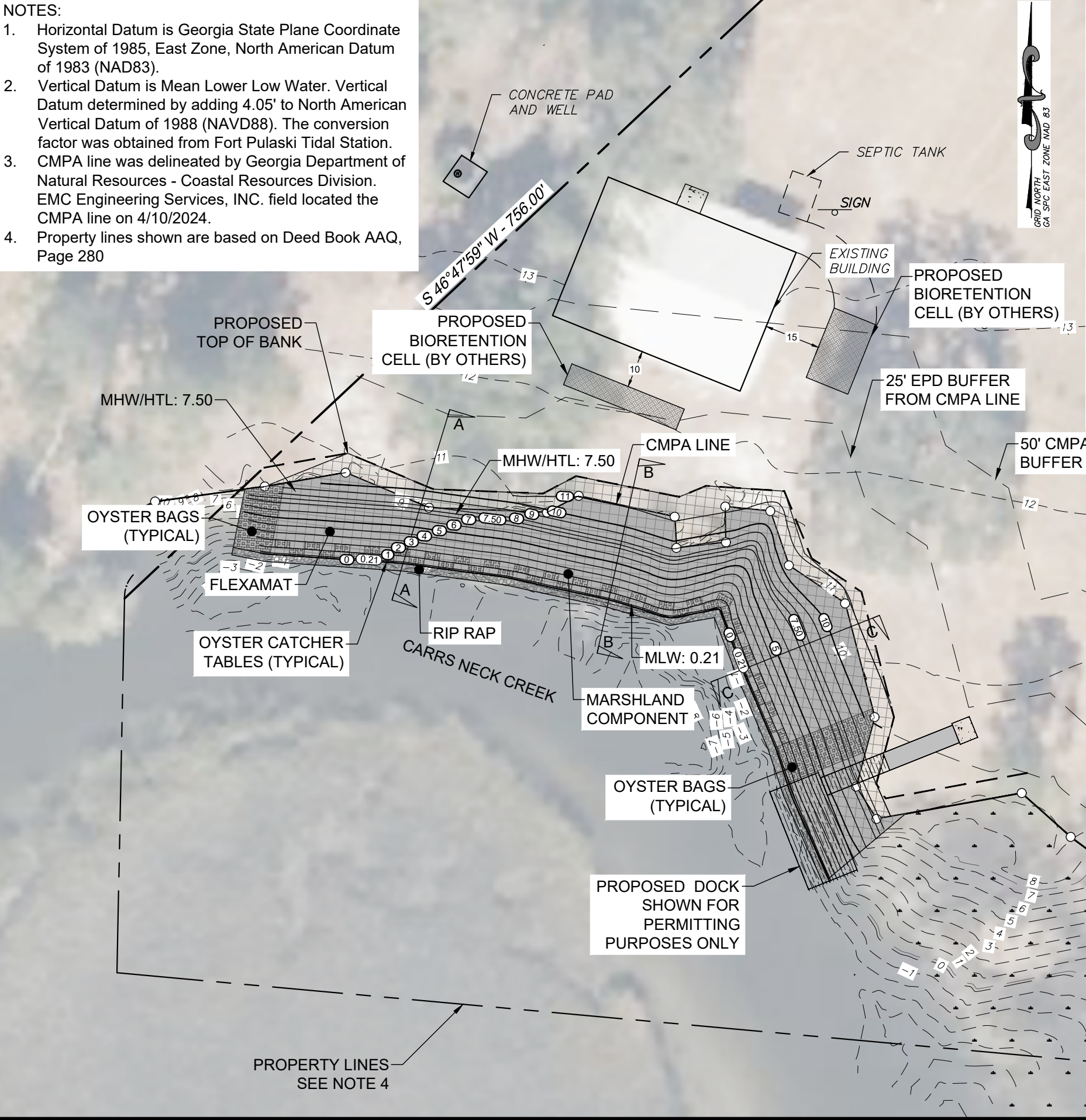

- CALCULATIONS BELOW CMPA LINE**
- TOTAL LENGTH: 243 LF
 - MARSHLAND IMPACT AREA: 5,340 SF (0.12 AC)
 - FLEXAMAT: 4,913 SF x 2.25" DEEP = 33.55 CY
 - RIP RAP: 210' (L) x 2' (W) x 2.5' (H) = 39 CY
 - OYSTER BAGS: 434 SF (0.01 AC)
 - APPROXIMATE OYSTER BAGS: 5 CY
 - OYSTER TABLES: 328 SF
 - GRADING AREA: 5,340 SF (0.12 AC)
 - APPROXIMATE CUT: 45 CY
 - APPROXIMATE FILL: 89 CY
 - VEGETATIVE PLANTING: 3,731 SF (0.08 AC)
- CALCULATIONS BELOW HIGH TIDE LINE**
- IMPACT AREA: 3,838 SF (0.09 AC)
 - FLEXAMAT: 3,413 SF x 2.25" DEEP = 25.78 CY
 - RIP RAP: 210' (L) x 2' (W) x 2.5' (H) = 39 CY
 - OYSTER BAGS: 325 SF (0.007 AC)
 - APPROXIMATE OYSTER BAGS: 4 CY
 - OYSTER TABLES: 328 SF
 - GRADING AREA: 3,838 SF (0.09 AC)
 - APPROXIMATE CUT: 28 CY
 - APPROXIMATE FILL: 73 CY
 - VEGETATIVE PLANTING: 2,340 SF (0.05 AC)

LEGEND

| | |
|---------------------|--|
| CONCRETE SURFACE | |
| RIP-RAP | |
| MARSHLAND COMPONENT | |
| MARSH AREA | |
| FLEXAMAT | |
| OYSTER BAGS | |

EMC ENGINEERING SERVICES, INC.
1111 Glynco Parkway
Bldg. #2, Suite 400
Brunswick, GA 31525
Ph: (912) 265-7636
Fax: (912) 233-4580
www.emc-eng.com

ALBANY • ATLANTA • AUGUSTA • BRUNSWICK • COLUMBUS
GREENVILLE • SAVANNAH • STATESBORO • THOMASTON

MARSHLAND COMPONENT

MARTHA RANDOLPH STEVEN PARK
1359 G.M. DISTRICT
LIBERTY COUNTY, GEORGIA

Prepared for:
THE SEABROOK VILLAGE FOUNDATION, INC

30' 15' 0' 30'
GRAPHIC SCALE: 1" = 30'

| | |
|--------------|-----------|
| PROJECT NO.: | 24-5020 |
| DRAWN BY: | KLC |
| DESIGNED BY: | KLC |
| SURVEYED BY: | JKL |
| SURVEY DATE: | 4/10/2024 |
| CHECKED BY: | ABM |
| SCALE: | 1" = 30' |
| DATE: | 6/2/2025 |

SHEET
2
OF 9

O:\2024\24-5020.01 MARTHA RANDOLPH STEVENS PARK - LABARBA\DWG\24-5020C_C02 MLLW 5-29-2025.DWG

- NOTES:
- Horizontal Datum is Georgia State Plane Coordinate System of 1985, East Zone, North American Datum of 1983 (NAD83).
 - Vertical Datum is Mean Lower Low Water. Vertical Datum determined by adding 4.05' to North American Vertical Datum of 1988 (NAVD88). The conversion factor was obtained from Fort Pulaski Tidal Station.
 - CMPA line was delineated by Georgia Department of Natural Resources - Coastal Resources Division. EMC Engineering Services, INC. field located the CMPA line on 4/10/2024.
 - Property lines shown are based on Deed Book AAQ, Page 280

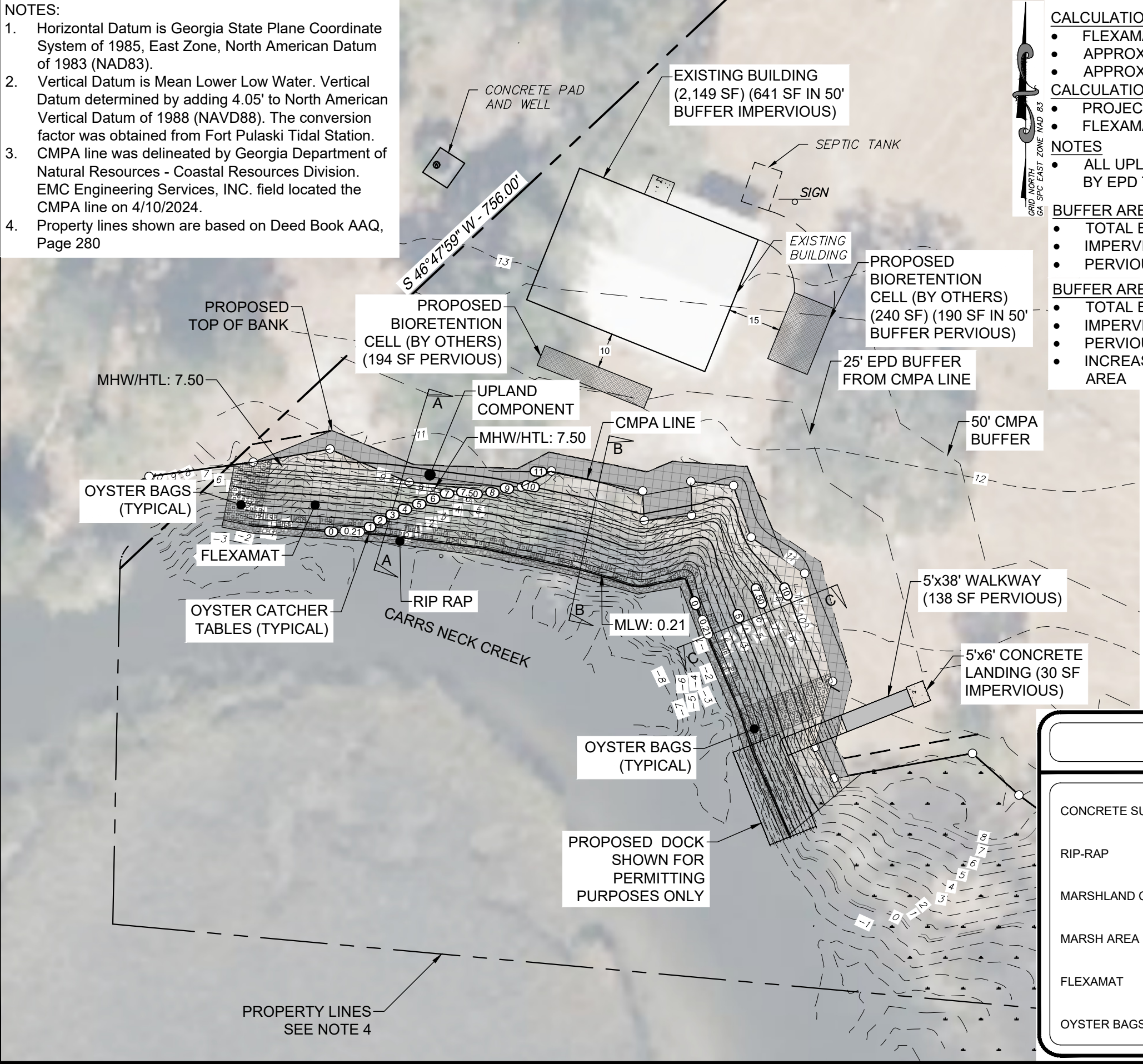

- CALCULATIONS ABOVE CMPA LINE**
- FLEXAMAT: 1,288 SF x 2.25" DEEP = 8.94 CY
 - APPROXIMATE CUT: 19 CY
 - APPROXIMATE FILL: 2 CY
- CALCULATIONS ABOVE HIGH TIDE LINE**
- PROJECT AREA: 13,349 SF (0.30 AC)
 - FLEXAMAT: 27,89 SF x 2.25" DEEP = 19.36 CY
- NOTES**
- ALL UPLAND IMPACTS WILL BE PERMITTED BY EPD THROUGH A BUFFER VARIANCE.
- BUFFER AREA (PRE CONSTRUCTION)**
- TOTAL BUFFER AREA: 12,805 SF (0.29 AC)
 - IMPERVIOUS AREA: 641 SF (5%)
 - PERVIOUS AREA: 12,164 SF (95%)
- BUFFER AREA (POST CONSTRUCTION)**
- TOTAL BUFFER AREA: 12,805 SF (0.29 AC)
 - IMPERVIOUS AREA: 671 SF (5.2%)
 - PERVIOUS AREA: 12,134 SF (94.8%)
 - INCREASE OF 30 SF (0.2%) IMPERVIOUS AREA

| LEGEND | |
|---------------------|--|
| CONCRETE SURFACE | |
| RIP-RAP | |
| MARSHLAND COMPONENT | |
| MARSH AREA | |
| FLEXAMAT | |
| OYSTER BAGS | |

EMC ENGINEERING SERVICES, INC.

1111 Glynco Parkway
Bldg. #2, Suite 400
Brunswick, GA 31525
Ph: (912) 265-7636
Fax: (912) 233-4580
www.emc-eng.com

CIVIL MARINE ENVIRONMENTAL

ALBANY • ATLANTA • AUGUSTA • BRUNSWICK • COLUMBUS
GREENVILLE • SAVANNAH • STATESBORO • THOMASTON

UPLAND

MARTHA RANDOLPH STEVEN PARK

1359 G.M. DISTRICT

LIBERTY COUNTY, GEORGIA

Prepared for:
THE SEABROOK VILLAGE FOUNDATION, INC

REGISTERED

No. PE30429

PROFESSIONAL

6-2-25

ENGINEER

ALEC B. METZGER

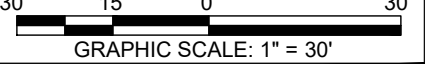

| | |
|--------------|-----------|
| PROJECT NO.: | 24-5020 |
| DRAWN BY: | KLC |
| DESIGNED BY: | KLC |
| SURVEYED BY: | JKL |
| SURVEY DATE: | 4/10/2024 |
| CHECKED BY: | ABM |
| SCALE: | 1" = 30' |
| DATE: | 6/2/2025 |

SHEET

3

OF 9

O:\2024\24-5020.01 MARTHA RANDOLPH STEVENS PARK - LABARBA\DWG\24-5020C_C02 MLLW 5-29-2025.DWG

- NOTES:
- Horizontal Datum is Georgia State Plane Coordinate System of 1985, East Zone, North American Datum of 1983 (NAD83).
 - Vertical Datum is Mean Lower Low Water. Vertical Datum determined by adding 4.05' to North American Vertical Datum of 1988 (NAVD88). The conversion factor was obtained from Fort Pulaski Tidal Station.
 - CMPA line was delineated by Georgia Department of Natural Resources - Coastal Resources Division. EMC Engineering Services, INC. field located the CMPA line on 4/10/2024.
 - Property lines shown are based on Deed Book AAQ, Page 280

- NOTES
- DOCK SHOWN FOR PERMITTING PURPOSES ONLY.
 - THE STRUCTURAL DESIGN AND CONSTRUCTION WILL BE COMPLETED IN THE FUTURE.

EMC ENGINEERING SERVICES, INC.
1111 Glynn Parkway
Bldg. #2, Suite 400
Brunswick, GA 31525
Ph: (912) 265-7636
Fax: (912) 233-4580
www.emc-eng.com

ALBANY • ATLANTA • AUGUSTA • BRUNSWICK • COLUMBUS
GREENVILLE • SAVANNAH • STATESBORO • THOMASTON

DOCK EXHIBIT

MARTHA RANDOLPH STEVEN PARK
1359 G.M. DISTRICT
LIBERTY COUNTY, GEORGIA

Prepared for:
THE SEABROOK VILLAGE FOUNDATION, INC



10' 5' 0' 10'
GRAPHIC SCALE: 1" = 10'

PROJECT NO.: 24-5020
DRAWN BY: KLC
DESIGNED BY: KLC
SURVEYED BY: JKL
SURVEY DATE: 4/10/2024
CHECKED BY: ABM
SCALE: 1" = 10'
DATE: 6/2/2025

SHEET
4

OF 9

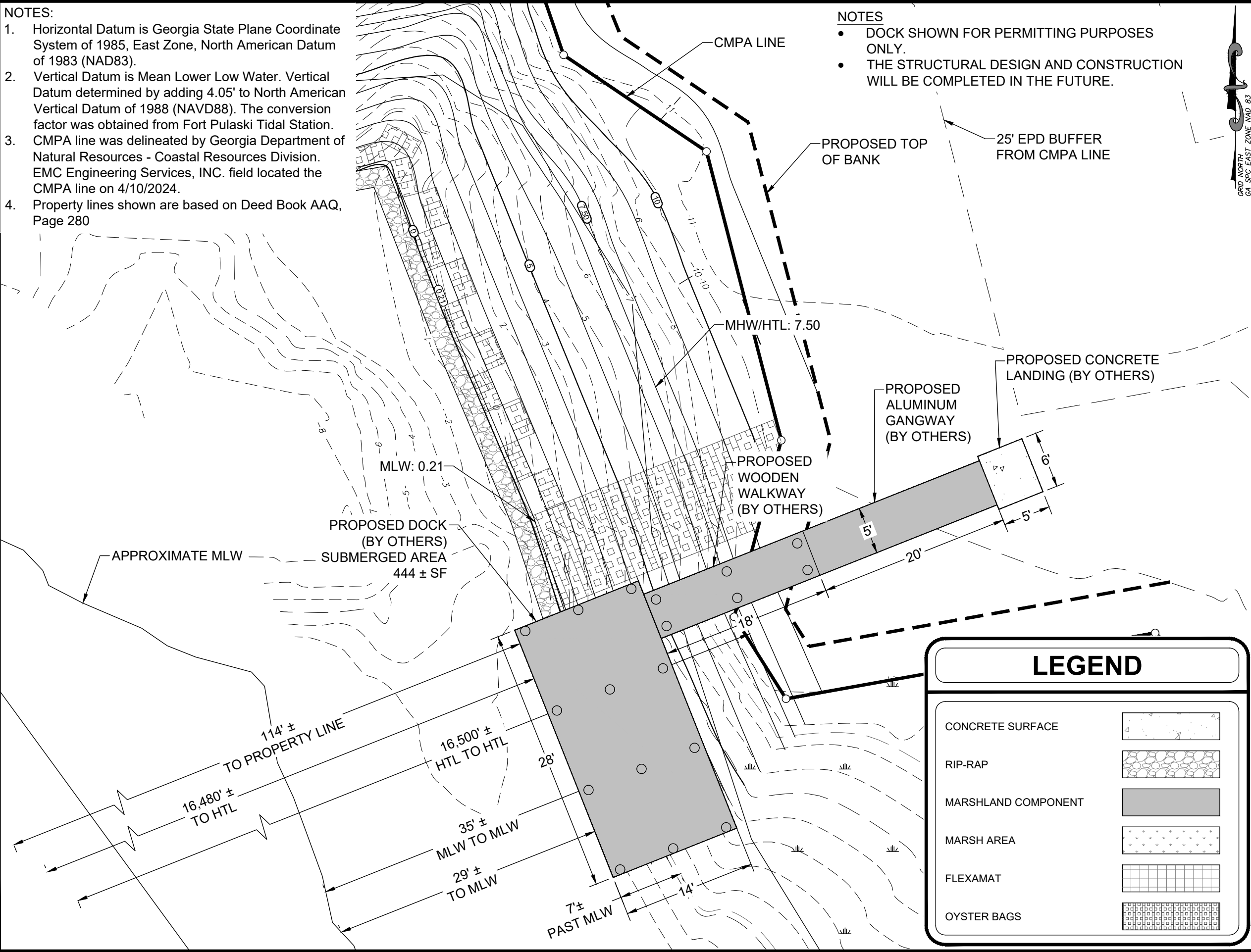

LEGEND

| | |
|---------------------|--|
| CONCRETE SURFACE | |
| RIP-RAP | |
| MARSHLAND COMPONENT | |
| MARSH AREA | |
| FLEXAMAT | |
| OYSTER BAGS | |

O: \2024\24-5020.01 MARTHA RANDOLPH STEVENS PARK - LABARBA\DWG\24-5020C_C02 MLLW 5-29-2025.DWG

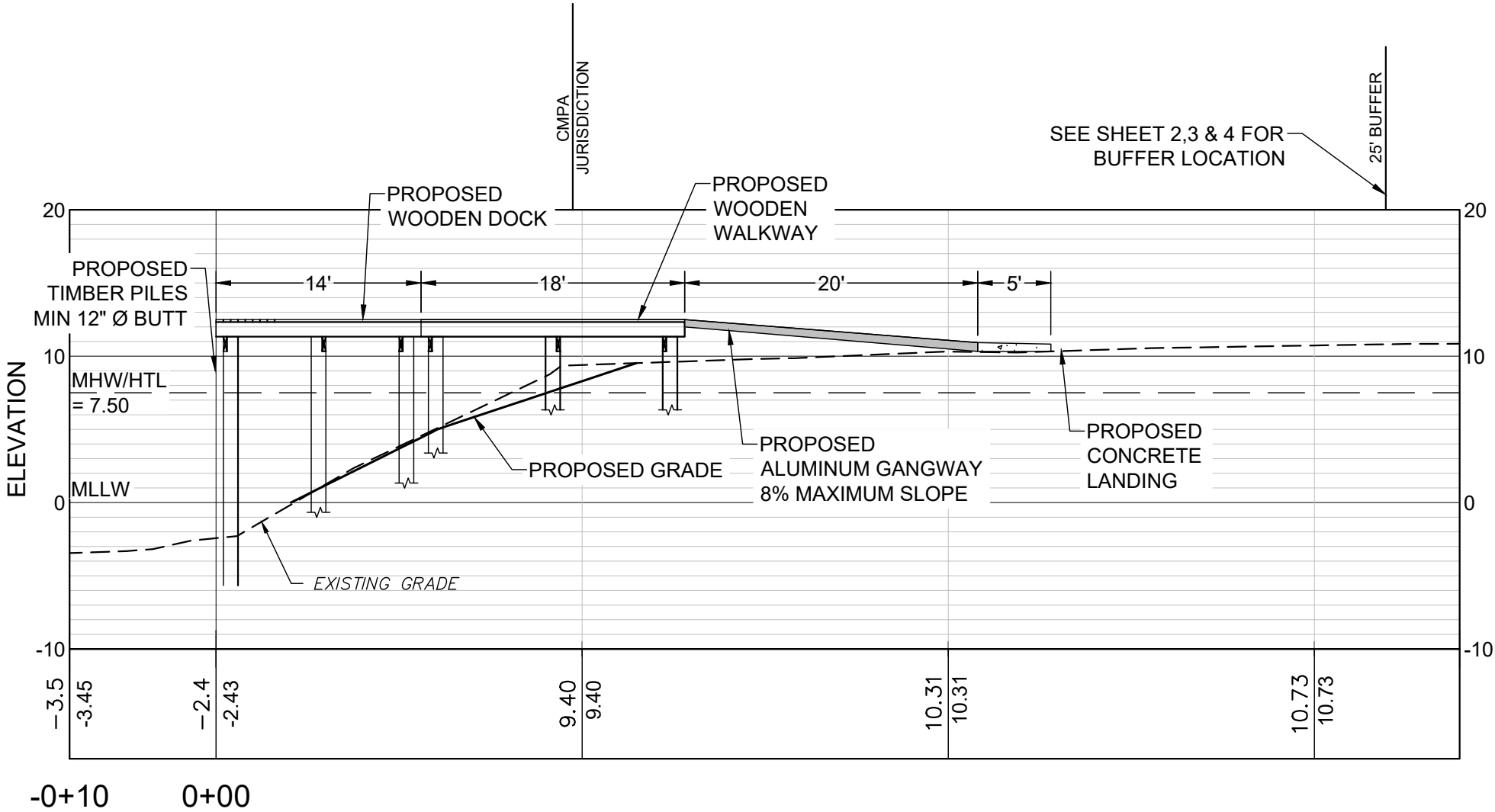

DOCK PROFILE
HORZ SCALE: 1" = 10'
VERT SCALE: 1" = 10'

- NOTES
- DOCK SHOWN FOR PERMITTING PURPOSES ONLY.
 - THE STRUCTURAL DESIGN AND CONSTRUCTION WILL BE COMPLETED IN THE FUTURE.

GRID NORTH
GA SFC EAST ZONE NAD 83

EMC ENGINEERING SERVICES, INC.

1111 Glynco Parkway
Bldg. #2, Suite 400
Brunswick, GA 31525
Ph: (912) 265-7636
Fax: (912) 233-4580
www.emc-eng.com

CIVIL
MARINE
ENVIRONMENTAL

ALBANY • ATLANTA • AUGUSTA • BRUNSWICK • COLUMBUS
GREENVILLE • SAVANNAH • STATESBORO • THOMASTON

DOCK EXHIBIT

MARTHA RANDOLPH STEVEN PARK
1359 G.M. DISTRICT
LIBERTY COUNTY, GEORGIA
Prepared for:
THE SEABROOK VILLAGE FOUNDATION, INC

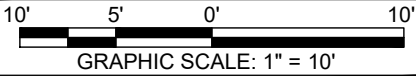

| | |
|--------------|-----------|
| PROJECT NO.: | 24-5020 |
| DRAWN BY: | KLC |
| DESIGNED BY: | KLC |
| SURVEYED BY: | JKL |
| SURVEY DATE: | 4/10/2024 |
| CHECKED BY: | ABM |
| SCALE: | 1" = 10' |
| DATE: | 6/2/2025 |

SHEET
5
OF 9

O: \2024\24-5020.01 MARTHA RANDOLPH STEVENS PARK - LABARBA\DWG\24-5020C_C02 MLLW 5-29-2025.DWG

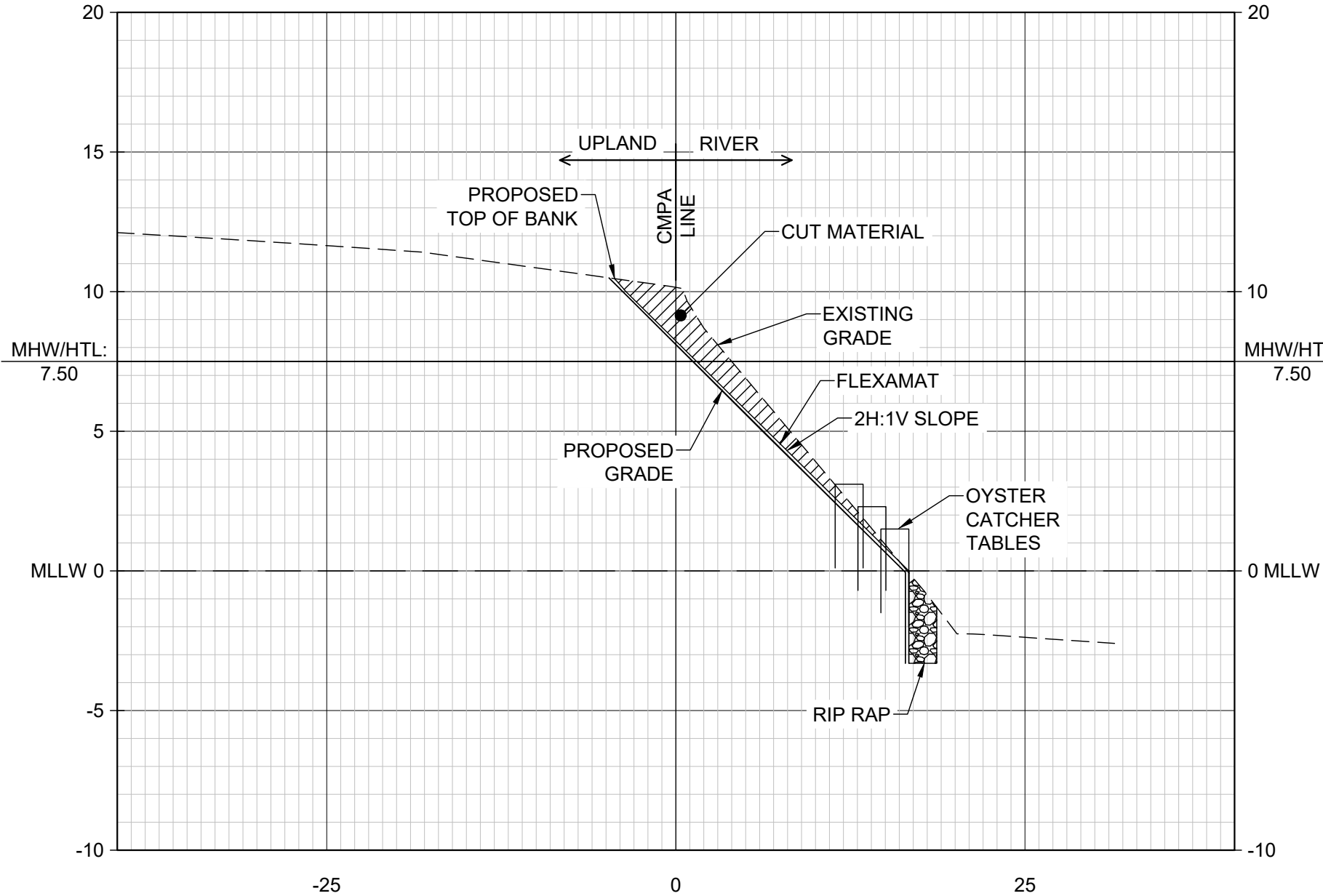

SECTION A
HORZ SCALE: 1" = 10'
VERT SCALE: 1" = 5'



CIVIL
MARINE
ENVIRONMENTAL

1111 Glynco Parkway
Bldg. #2, Suite 400
Brunswick, GA 31525
Ph: (912) 265-7636
Fax: (912) 233-4580
www.emc-eng.com

ALBANY • ATLANTA • AUGUSTA • BRUNSWICK • COLUMBUS
GREENVILLE • SAVANNAH • STATESBORO • THOMASTON

CROSS SECTION

MARTHA RANDOLPH STEVEN PARK
1359 G.M. DISTRICT
LIBERTY COUNTY, GEORGIA
Prepared for:
THE SEABROOK VILLAGE FOUNDATION, INC



REGISTERED
No. PE30429
PROFESSIONAL
6-2-25
ENGINEER
ALEC B. METZGER

| | |
|--------------|-----------|
| PROJECT NO.: | 24-5020 |
| DRAWN BY: | KLC |
| DESIGNED BY: | KLC |
| SURVEYED BY: | JKL |
| SURVEY DATE: | 4/10/2024 |
| CHECKED BY: | ABM |
| SCALE: | 1" = 10' |
| DATE: | 6/2/2025 |

O: \2024\24-5020.01 MARTHA RANDOLPH STEVENS PARK - LABARBA\DWG\24-5020C_C02 MLLW 5-29-2025.DWG

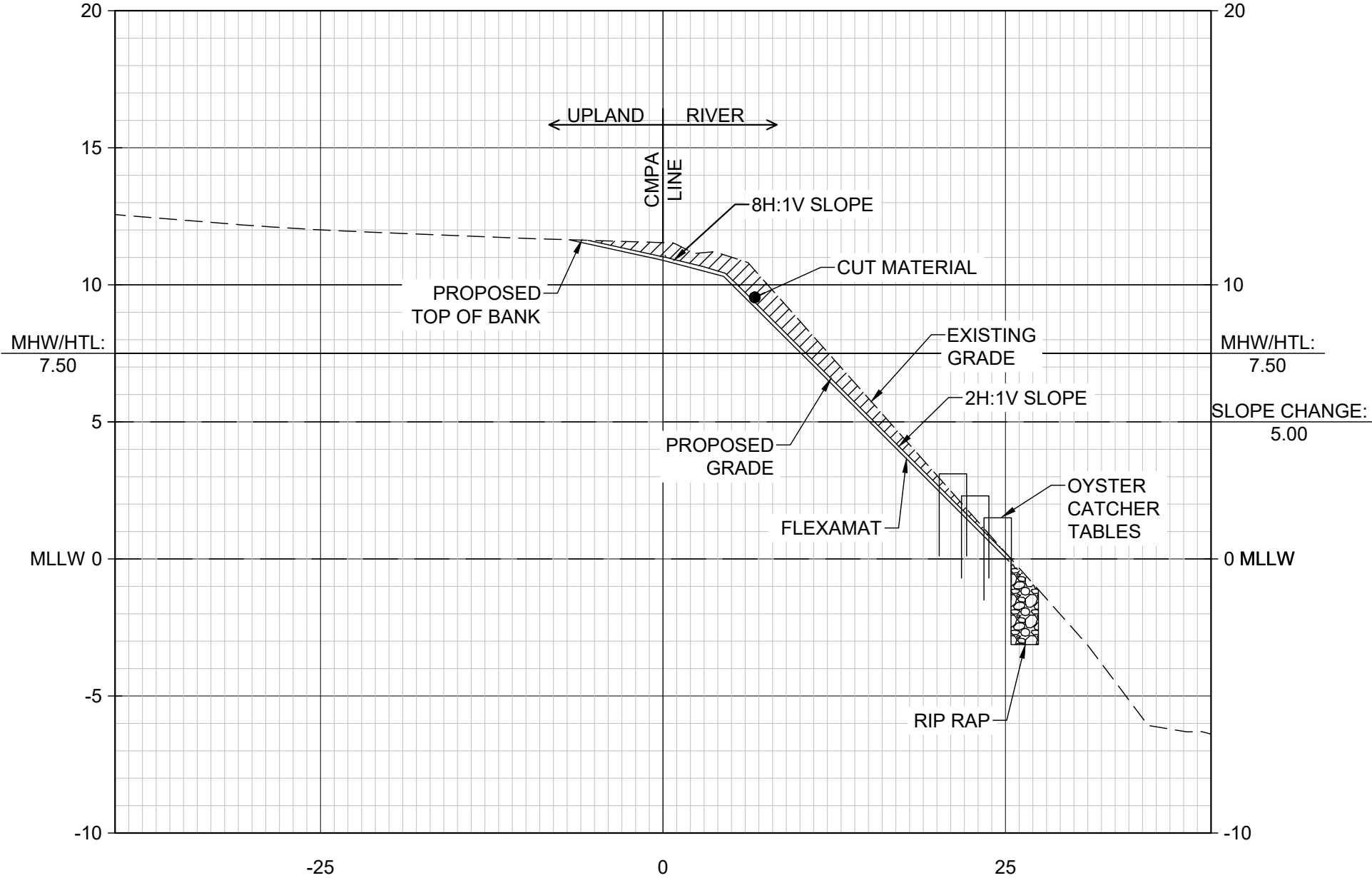

SECTION B
HORZ SCALE: 1" = 10'
VERT SCALE: 1" = 5'

CROSS SECTION
MARTHA RANDOLPH STEVEN PARK
1359 G.M. DISTRICT
LIBERTY COUNTY, GEORGIA
Prepared for:
THE SEABROOK VILLAGE FOUNDATION, INC



| | |
|--------------|-----------|
| PROJECT NO.: | 24-5020 |
| DRAWN BY: | KLC |
| DESIGNED BY: | KLC |
| SURVEYED BY: | JKL |
| SURVEY DATE: | 4/10/2024 |
| CHECKED BY: | ABM |
| SCALE: | 1" = 10' |
| DATE: | 6/2/2025 |

O: \2024\24-5020.01 MARTHA RANDOLPH STEVENS PARK - LABARBA\DWG\24-5020C_C02 MLLW 5-29-2025.DWG

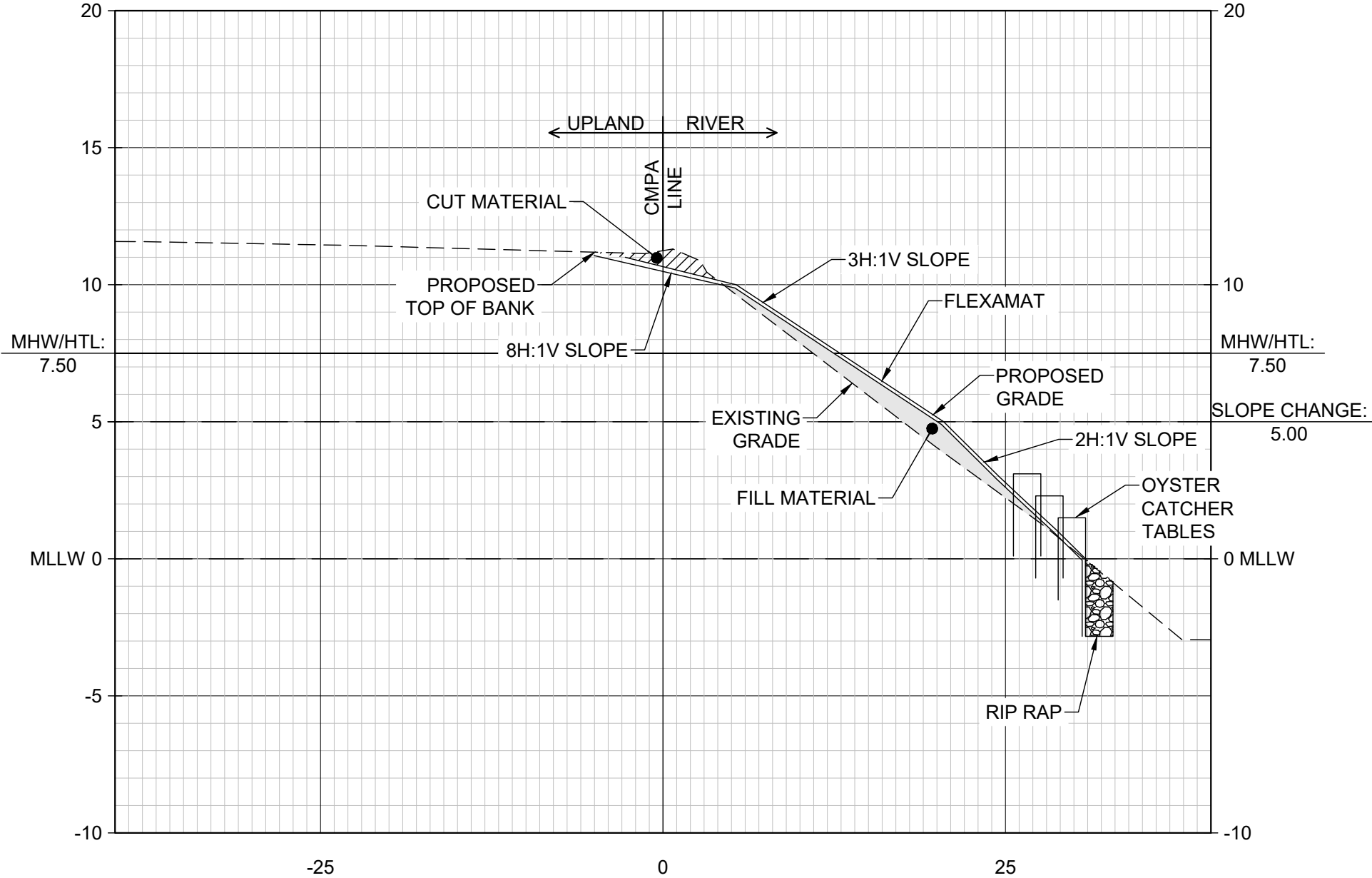

SECTION C
HORZ SCALE: 1" = 10'
VERT SCALE: 1" = 5'



EMC ENGINEERING SERVICES, INC.

1111 Glynco Parkway
Bldg. #2, Suite 400
Brunswick, GA 31525
Ph: (912) 265-7636
Fax: (912) 233-4580
www.emc-eng.com

ALBANY • ATLANTA • AUGUSTA • BRUNSWICK • COLUMBUS
GREENVILLE • SAVANNAH • STATESBORO • THOMASTON

6/2/2025

MARTHA RANDOLPH STEVEN PARK
1359 G.M. DISTRICT
LIBERTY COUNTY, GEORGIA
Prepared for:
THE SEABROOK VILLAGE FOUNDATION, INC



| | |
|--------------|-----------|
| PROJECT NO.: | 24-5020 |
| DRAWN BY: | KLC |
| DESIGNED BY: | KLC |
| SURVEYED BY: | JKL |
| SURVEY DATE: | 4/10/2024 |
| CHECKED BY: | ABM |
| SCALE: | 1" = 10' |
| DATE: | 5/30/2025 |

O:\2024\24-5020.01 MARTHA RANDOLPH STEVENS PARK - LABARBA\DWG\24-5020C_C02 MLLW 5-29-2025.DWG

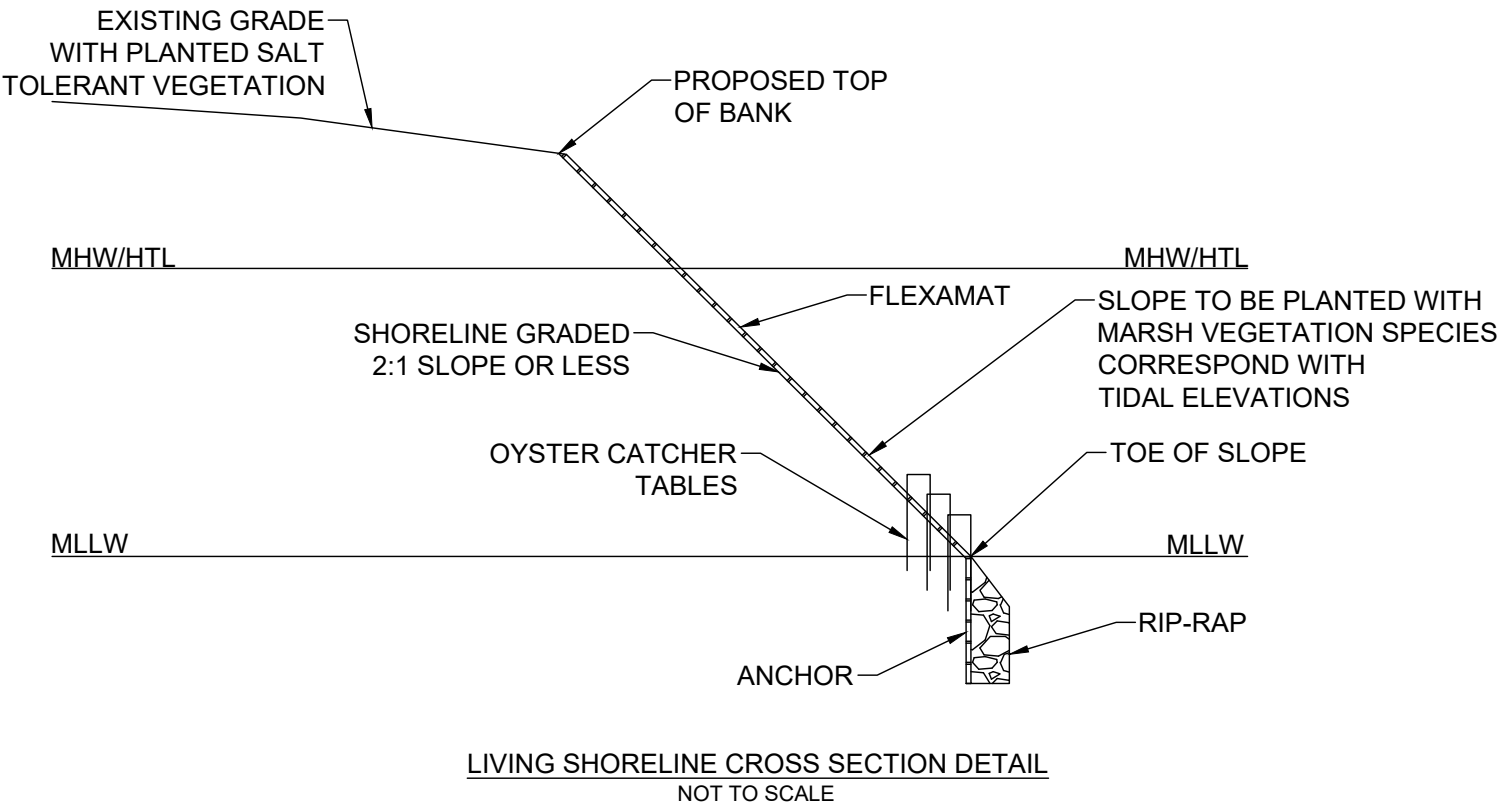

OYSTER CATCHER TABLE
PLAN VIEW

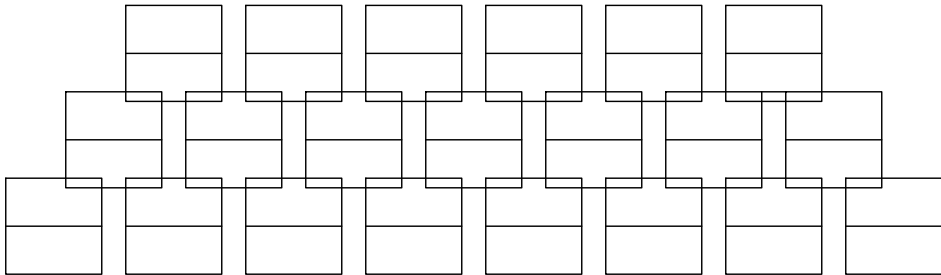

OYSTER CATCHER TABLE
PROFILE VIEW

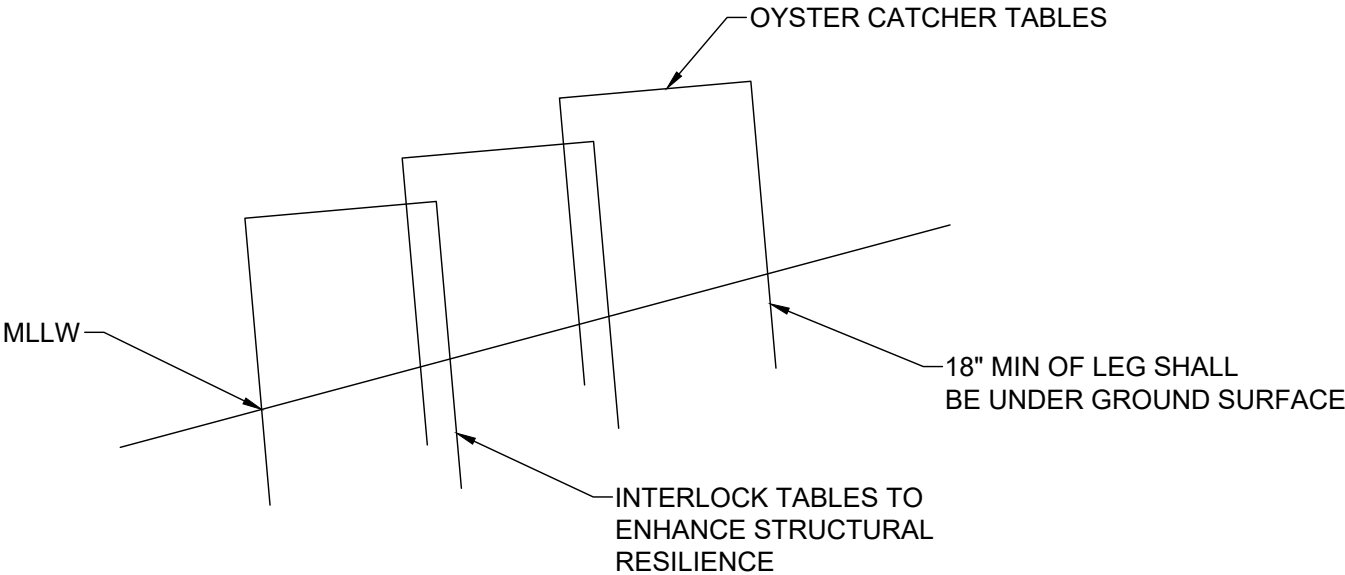

OYSTER CATCHER TABLE
TOP VIEW

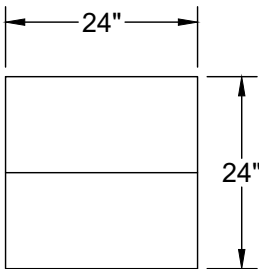

OYSTER CATCHER TABLE
SIDE VIEW

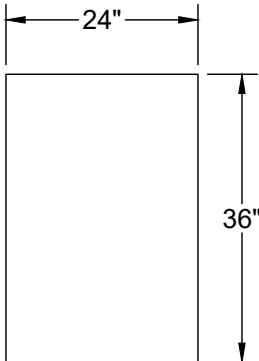



EMC ENGINEERING SERVICES, INC.

1111 Glymco Parkway
Bldg. #2, Suite 400
Brunswick, GA 31525
Ph: (912) 265-7636
Fax: (912) 233-4580
www.emc-eng.com

ALBANY • ATLANTA • AUGUSTA • BRUNSWICK • COLUMBUS
GREENVILLE • SAVANNAH • STATESBORO • THOMASTON

LIVING SHORELINE DETAIL

MARTHA RANDOLPH STEVEN PARK
1359 G.M. DISTRICT
LIBERTY COUNTY, GEORGIA
Prepared for:
THE SEABROOK VILLAGE FOUNDATION, INC



| | |
|--------------|-----------|
| PROJECT NO.: | 24-5020 |
| DRAWN BY: | KLC |
| DESIGNED BY: | KLC |
| SURVEYED BY: | JKL |
| SURVEY DATE: | 4/10/2024 |
| CHECKED BY: | ABM |
| SCALE: | N/A |
| DATE: | 6/2/2025 |