

### EAST COAST TERMINAL PERMIT CMPC #765 AMENDMENT

SHEET NAME:  
VICINITY MAP

APPLICANT:  
EAST COAST TERMINALS LLC

LOCATION: SAVANNAH (CHATHAM), GA  
DATE: 7/28/2021  
JOB NUMBER: J - 25340.0000

SHEET: 1  
SCALE: 1"=4000'

**THOMAS & HUTTON**  
Engineering | Surveying | Planning | GIS | Consulting

50 Park of Commerce Way  
Savannah, GA 31405 • 912.234.5300

www.thomasandhutton.com

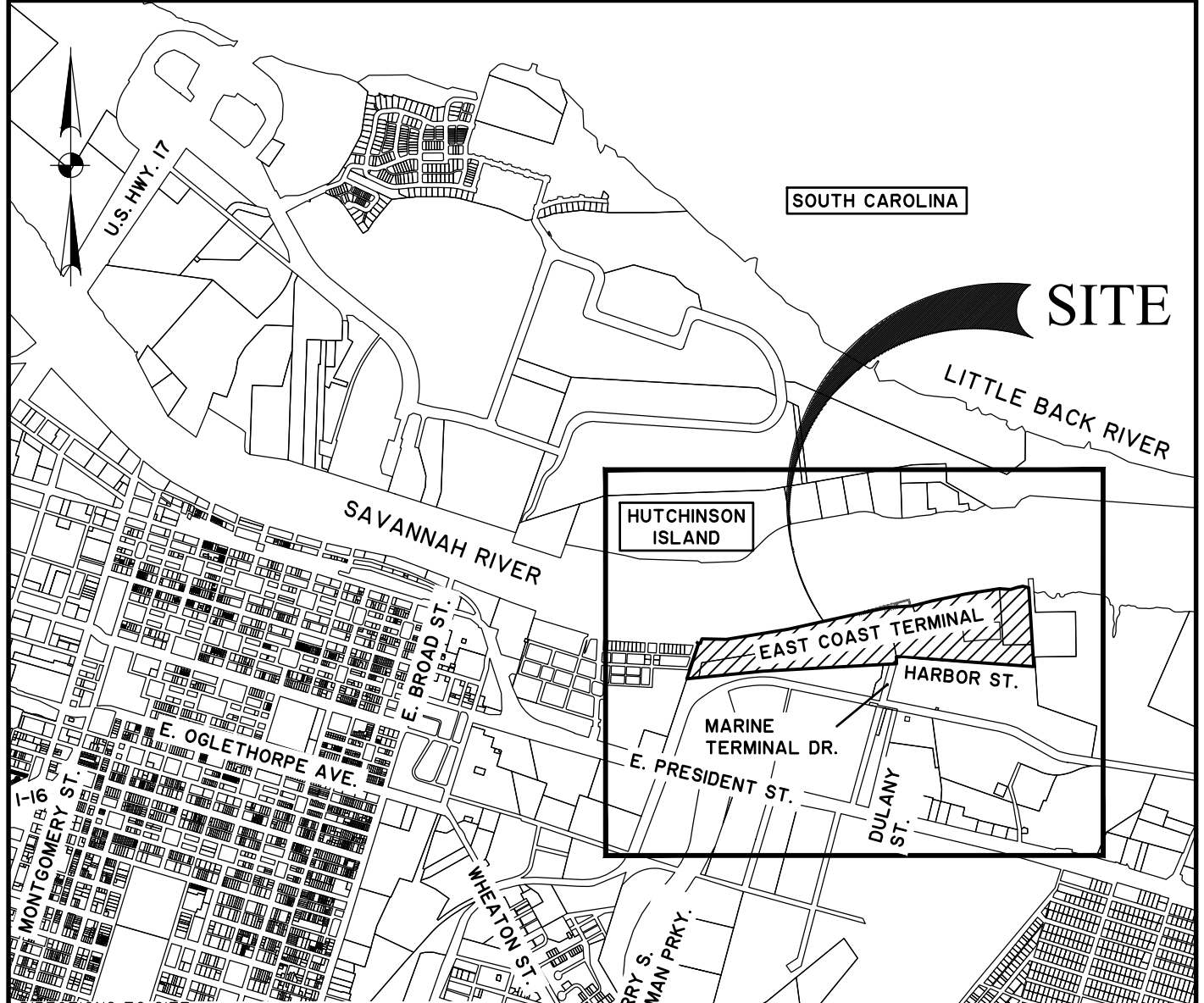

**DIRECTIONS TO SITE:**  
 STARTING ON I16 EASTBOUND TOWARD SAVANNAH. TAKE EXIT 167B FOR MONTGOMERY STREET TOWARD SAVANNAH/CIVIC CENTER/DOWNTOWN FOR .3 MILES. MERGE ONTO MONTGOMERY STREET FOR 300 FEET AND THEN TURN RIGHT ONTO WEST LIBERTY STREET. CONTINUE FOR 0.7 MILES THEN MAKE TURN LEFT ONTO EAST BROAD STREET. TRAVEL 0.2 MILES AND TURN RIGHT ONTO EAST PRESIDENT STREET. GO 1.2 MILES AND TURN LEFT ONTO DULANY STREET. PROCEED 0.2 MILES THEN TURN LEFT TOWARD MARINE TERMINAL DRIVE. TRAVEL 250 FEET TURN RIGHT ON MARINE TERMINAL DRIVE. PROCEED 0.1 MILES AND MAKE A RIGHT ONTO HARBOR STREET AND TRAVEL 0.2 MILES. THE SITE IS ON YOUR LEFT.



**GRAPHIC SCALE**

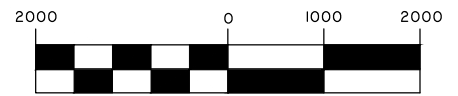

( IN FEET )  
 1 inch = 2000ft.

**EAST COAST TERMINAL PERMIT CMPC #765 AMENDMENT**

SHEET NAME:  
**LOCATION MAP**

APPLICANT:  
**EAST COAST TERMINALS LLC**

LOCATION: SAVANNAH (CHATHAM), GA  
 DATE: 7/28/2021  
 JOB NUMBER: J - 25340.0000

SHEET: 2  
 SCALE: 1"=2000'



682 Johnnie Dodds Blvd. • Suite 100  
 Mt. Pleasant, SC 29464 • 843.849.0200

[www.thomasandhutton.com](http://www.thomasandhutton.com)



Z:\25340\25340.0000\Engineering\Drawings\Permit\Amendment\25340.0000 04a Site Plan.dwg - Jul 28, 2021 - 8:08:11 AM

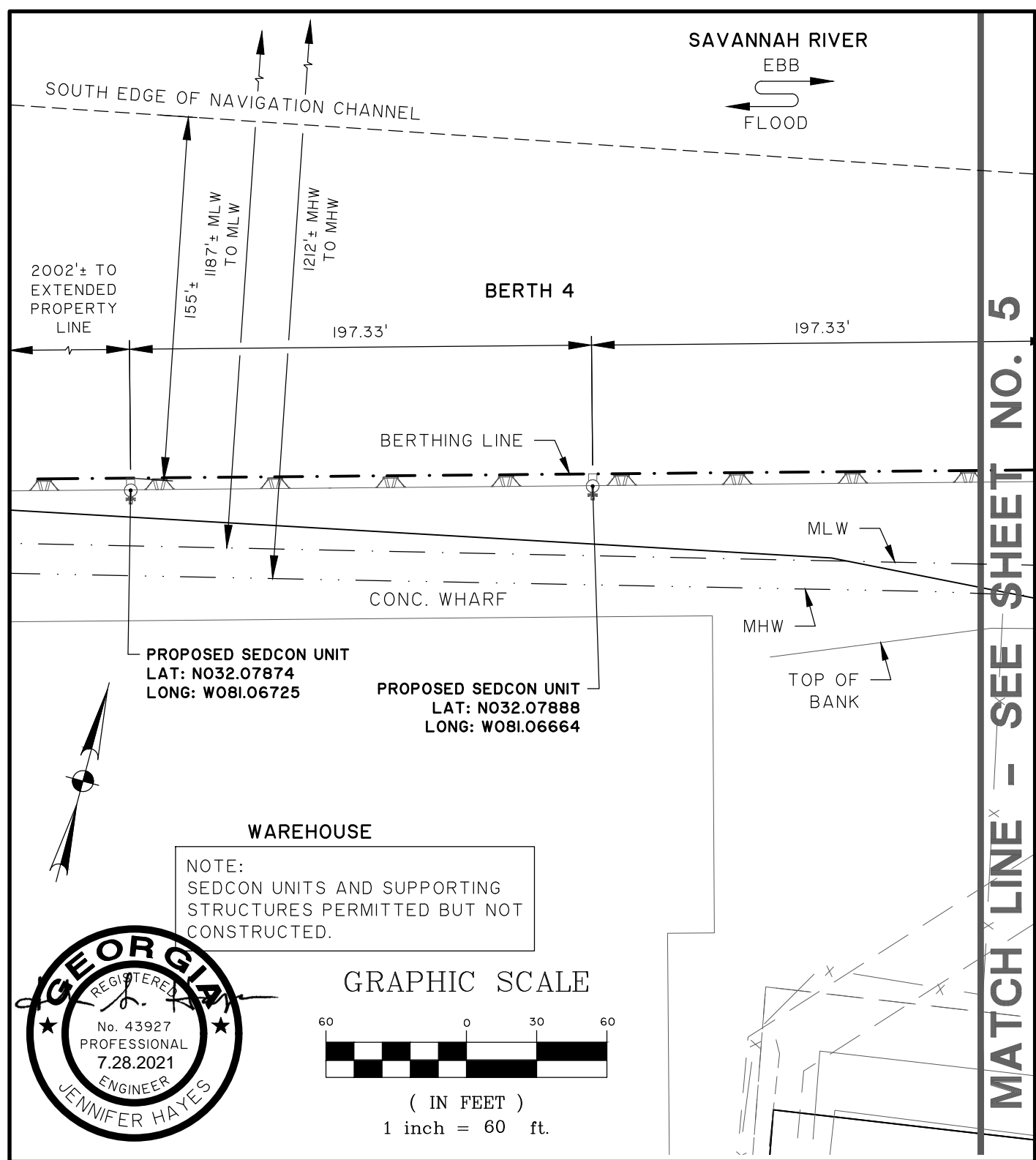

**EAST COAST TERMINAL PERMIT CMPC #765 AMENDMENT**

SHEET NAME:  
SITE PLAN

APPLICANT:  
EAST COAST TERMINALS LLC

LOCATION: SAVANNAH (CHATHAM), GA  
DATE: 7/28/2021  
JOB NUMBER: J - 25340.0000

SHEET: 4  
SCALE: 1" = 60'



682 Johnnie Dodds Blvd. • Suite 100  
Mt. Pleasant, SC 29464 • 843.849.0200

www.thomasandhutton.com

MATCH LINE - SEE SHEET NO. 4

MATCH LINE - SEE SHEET NO. 6

SAVANNAH RIVER

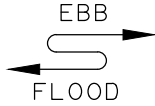

SOUTH EDGE OF NAVIGATION CHANNEL

BERTH 4

200'

236.94'

NEW 3' WIDE CATWALK

BERTHING LINE

CONC. WHARF

PROPOSED SEDCON UNIT  
LAT: N032.07902  
LONG: W081.06602

PROPOSED SEDCON UNIT  
W/SUPPORT PLATFORM  
LAT: N032.07916  
LONG: W081.06540

MLW

TOP OF BANK

MHW

NOTE:  
SEDCON UNITS AND SUPPORTING  
STRUCTURES PERMITTED BUT NOT  
CONSTRUCTED.

GRAPHIC SCALE

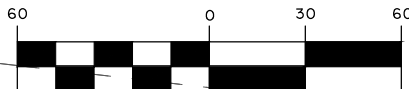

( IN FEET )

1 inch = 60 ft.



EAST COAST TERMINAL PERMIT CMPC #765 AMENDMENT

SHEET NAME:  
SITE PLAN

APPLICANT:  
EAST COAST TERMINALS LLC

LOCATION: SAVANNAH (CHATHAM), GA  
DATE: 7/28/2021  
JOB NUMBER: J - 25340.0000

SHEET: 5  
SCALE: 1" = 60'



682 Johnnie Dodds Blvd. • Suite 100  
Mt. Pleasant, SC 29464 • 843.849.0200

www.thomasandhutton.com

MATCH LINE - SEE SHEET NO. 5

MATCH LINE - SEE SHEET NO. 7

SAVANNAH RIVER

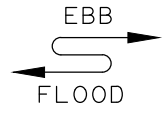

NOTE:  
SEDCON UNITS, SUPPORTING  
STRUCTURES AND CATWALKS  
PERMITTED BUT NOT CONSTRUCTED.  
NONE OF THE EXISTING CATWALKS  
HAVE BEEN REMOVED.

SOUTH EDGE OF NAVIGATION CHANNEL

BERTH 2

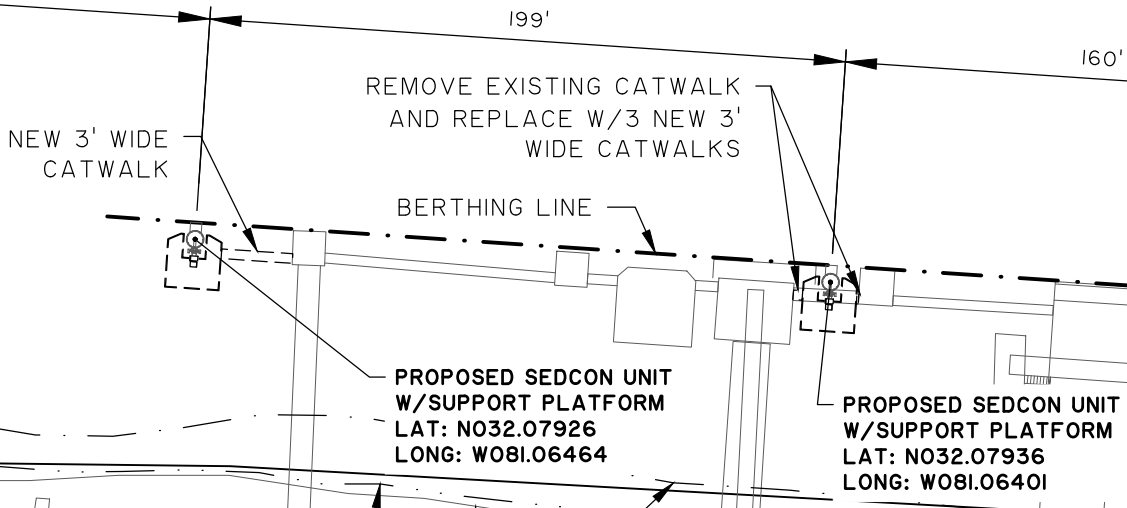

MHW  
MLW  
TOP OF BANK



GRAPHIC SCALE

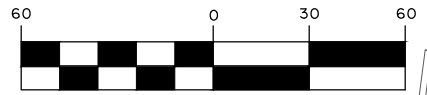

( IN FEET )  
1 inch = 60 ft.

EAST COAST TERMINAL PERMIT CMPC #765 AMENDMENT

SHEET NAME:  
SITE PLAN  
APPLICANT:  
EAST COAST TERMINALS LLC  
LOCATION: SAVANNAH (CHATHAM), GA  
DATE: 7/28/2021  
JOB NUMBER: J - 25340.0000

SHEET: 6  
SCALE: 1" = 60'



682 Johnnie Dodds Blvd. • Suite 100  
Mt. Pleasant, SC 29464 • 843.849.0200  
www.thomasandhutton.com



NOTES:  
 1. SEDCON UNITS, SUPPORTING STRUCTURES AND CATWALKS PERMITTED BUT NOT CONSTRUCTED. NONE OF THE EXISTING CATWALKS HAVE BEEN REMOVED.  
 2. THE AMENDMENT IS FOR THE NEW BREASTING DOLPHIN AND ASSOCIATED CATWALKS.



MATCH LINE -- SEE SHEET NO. 6

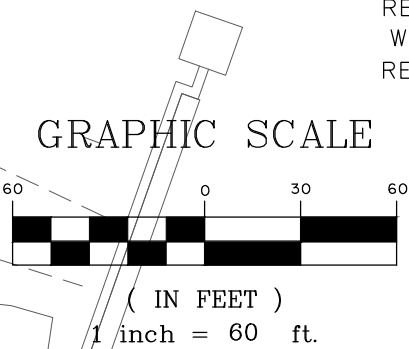
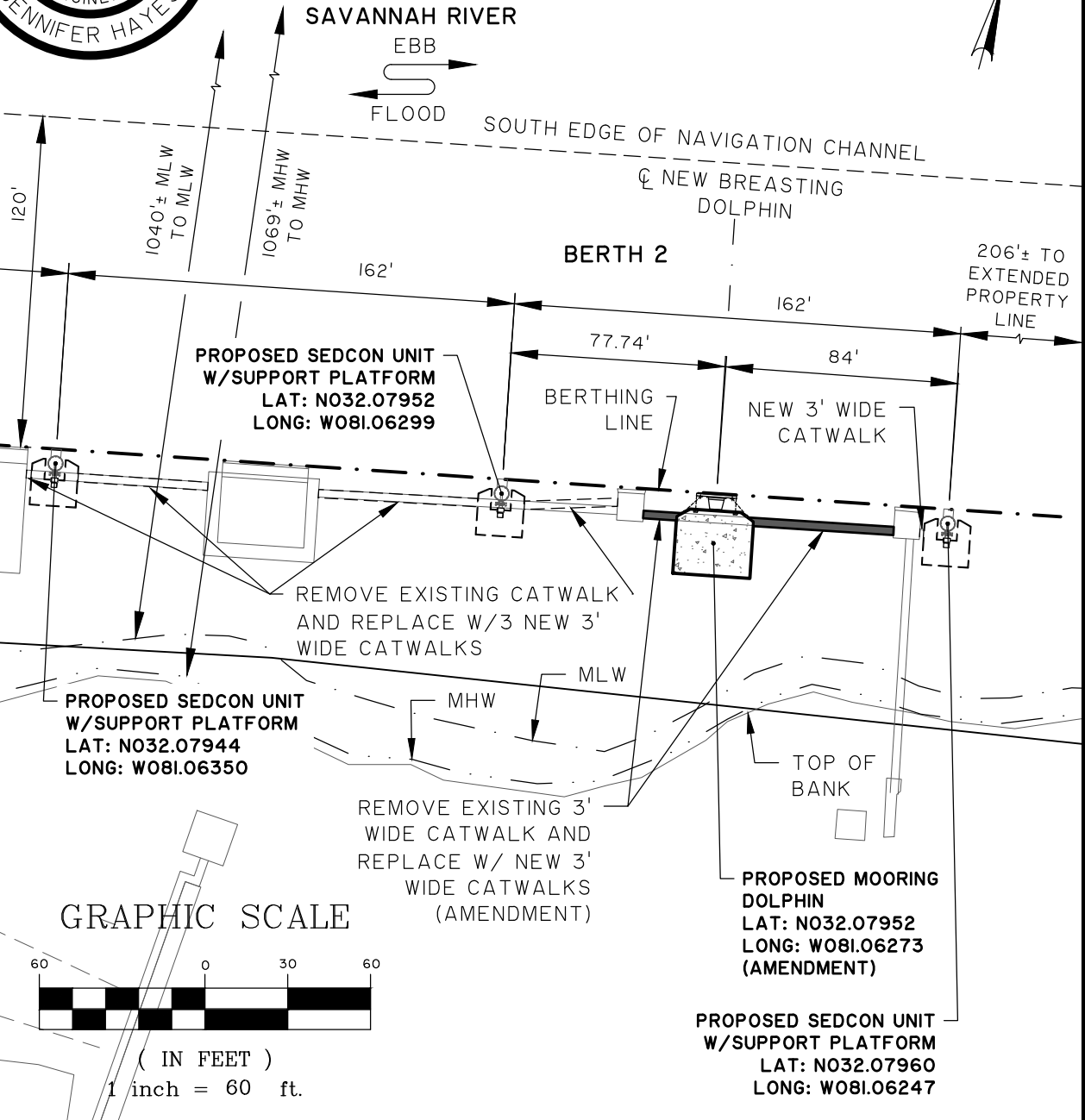

**EAST COAST TERMINAL PERMIT CMPC #765 AMENDMENT**

SHEET NAME:  
 SITE PLAN  
 APPLICANT:  
 EAST COAST TERMINALS LLC  
 LOCATION: SAVANNAH (CHATHAM), GA  
 DATE: 7/28/2021  
 JOB NUMBER: J - 25340.0000

SHEET: 7  
 SCALE: 1" = 60'



682 Johnnie Dodds Blvd. • Suite 100  
 Mt. Pleasant, SC 29464 • 843.849.0200  
 www.thomasandhutton.com

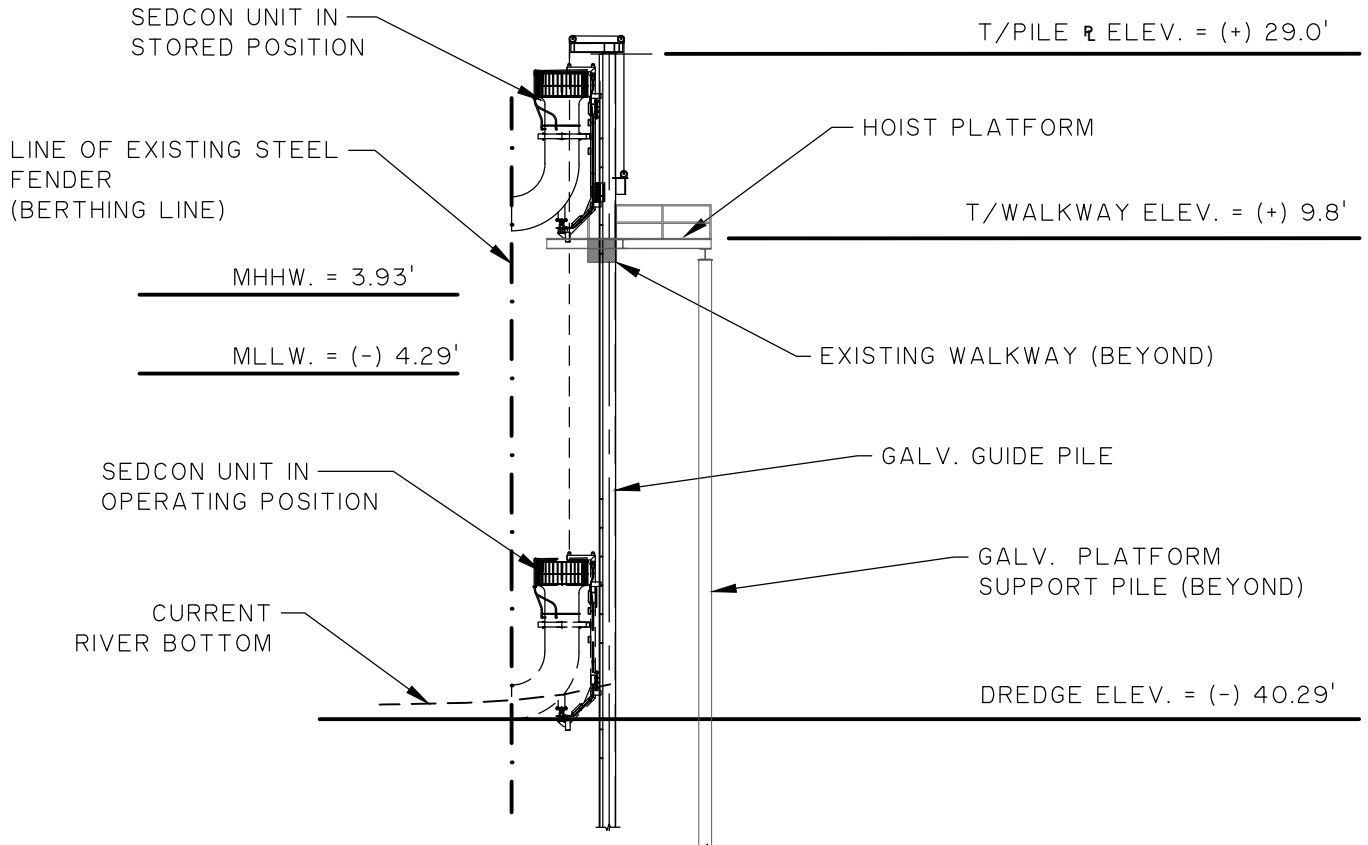

PERMITTED BUT NOT CONSTRUCTED



GRAPHIC SCALE

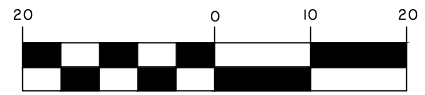

( IN FEET )  
1 inch = 20 ft.

EAST COAST TERMINAL PERMIT CMPC #765 AMENDMENT

SHEET NAME:  
BERTH 2 CROSS SECTION  
APPLICANT:  
EAST COAST TERMINALS LLC  
LOCATION: SAVANNAH (CHATHAM), GA  
DATE: 7/28/2021  
JOB NUMBER: J - 25340.0000

SHEET: 8  
SCALE: 1" = 20'



682 Johnnie Dodds Blvd. • Suite 100  
Mt. Pleasant, SC 29464 • 843.849.0200  
www.thomasandhutton.com

Z:\25340\25340.0000\Engineering\Drawings\Permit\Amendment\25340.0000.05a Sections.dwg - Jul 28, 2021 - 8:23:48 AM

SEDCON UNIT IS REMOVED  
WHEN NOT IN USE.

LINE OF EXISTING RUBBER  
FENDER SYSTEM  
(BERTHING LINE)

EXISTING CONC. DECK

TOP DOCK ELEV. = (+) 9.0'

MHHW. = 3.93'

MLLW. = (-) 4.29'

EXISTING CONC. PILE  
CAP (BEYOND)

SEDCON UNIT IN  
OPERATING POSITION

GALV. GUIDE PILE

EXIST. 18" CONC. PILING

CURRENT  
RIVER BOTTOM

DREDGE ELEV. = (-) 40.29'

PERMITTED BUT NOT CONSTRUCTED

GRAPHIC SCALE

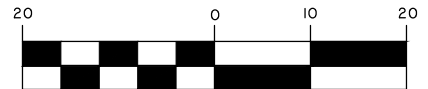

( IN FEET )  
1 inch = 20 ft.



**EAST COAST TERMINAL PERMIT CMPC #765 AMENDMENT**

SHEET NAME:

**BERTH 4 CROSS SECTION**

APPLICANT:

**EAST COAST TERMINALS LLC**

LOCATION: SAVANNAH (CHATHAM), GA

DATE: 7/28/2021

JOB NUMBER: J - 25340.0000

SHEET: 9

SCALE: 1" = 20'



682 Johnnie Dodds Blvd. • Suite 100  
Mt. Pleasant, SC 29464 • 843.849.0200

www.thomasandhutton.com

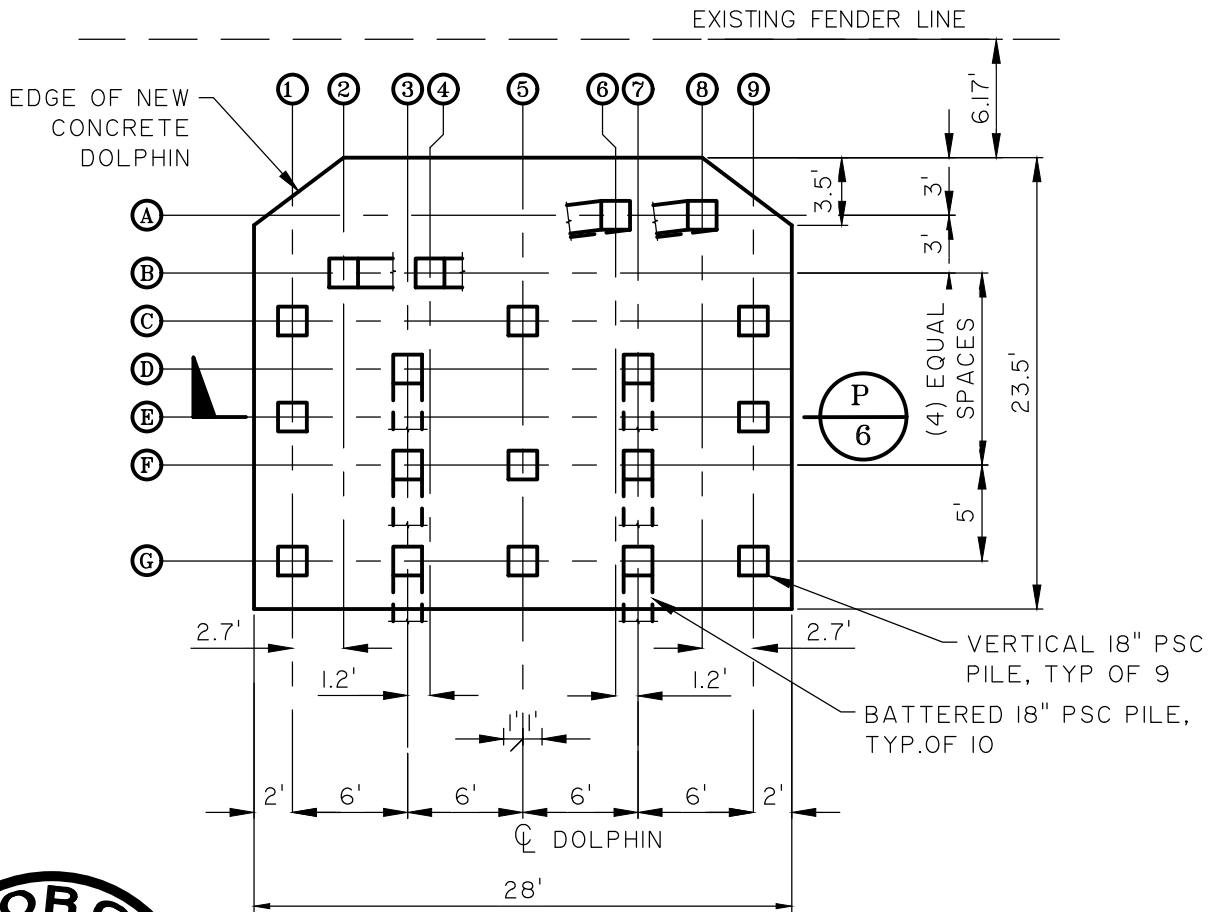

EAST COAST TERMINAL PERMIT CMPC #765 AMENDMENT

SHEET NAME:

DOLPHIN PLAN

APPLICANT:

EAST COAST TERMINALS LLC

LOCATION: SAVANNAH (CHATHAM), GA

DATE: 7/28/2021

JOB NUMBER: J - 25340.0000

SHEET: 10

SCALE: 1" = 10'



682 Johnnie Dodds Blvd. • Suite 100  
Mt. Pleasant, SC 29464 • 843.849.0200

www.thomasandhutton.com

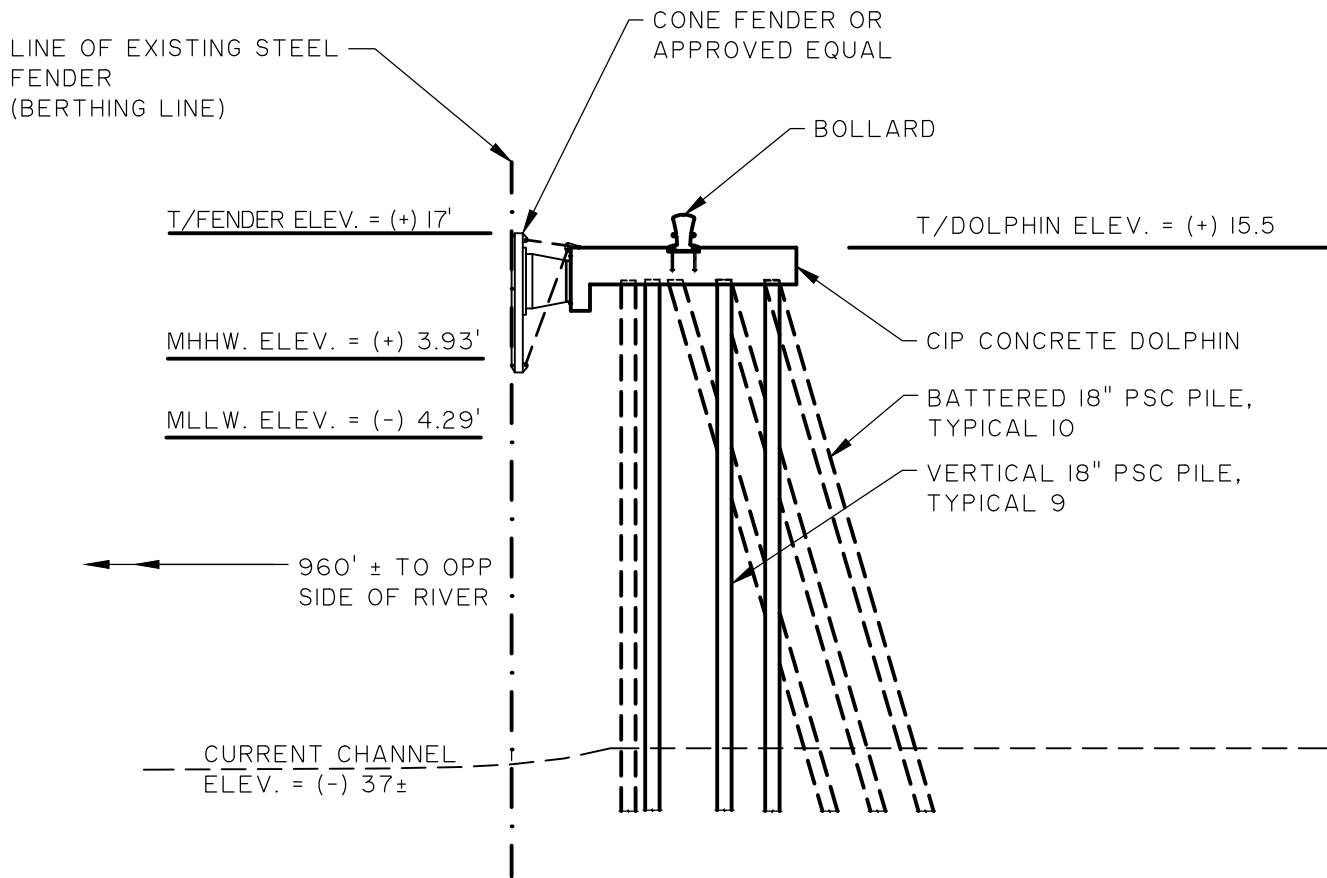

GRAPHIC SCALE

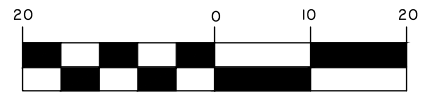

( IN FEET )  
1 inch = 20 ft.

EAST COAST TERMINAL PERMIT CMPC #765 AMENDMENT

SHEET NAME:  
DOLPHIN CROSS SECTION  
APPLICANT:  
EAST COAST TERMINALS LLC  
LOCATION: SAVANNAH (CHATHAM), GA  
DATE: 7/28/2021  
JOB NUMBER: J - 25340.0000

SHEET: 11  
SCALE: 1" = 20'



682 Johnnie Dodds Blvd. • Suite 100  
Mt. Pleasant, SC 29464 • 843.849.0200

www.thomasandhutton.com